

7/18/95 LATE A.M.
7/19/95 10:30

PERMIT

03-318389

SEWAGE DISPOSAL SYSTEM

DEPARTMENT OF HEALTH AND MENTAL HYGIENE

P 50746

A 38137A

DISTRICT 3rd

HOWARD COUNTY HEALTH DEPARTMENT

BUREAU OF ENVIRONMENTAL HEALTH

~~XXXXXXX~~ 313-2640

DATE 6-22-95

DATE SYSTEM APPROVED 7/19/95

INSPECTOR M. R. Pinkin

INDEXED

J. A. Smith & Company, Inc.

IS PERMITTED TO INSTALL ALTER

ADDRESS 5918 Hunt Club Road, Elkridge, MD 21227

PHONE 796-7532

SUBDIVISION Meadowood LOT 79 ROAD 1352 Crows Foot Road

PROPERTY OWNER Debora Snovell

ADDRESS _____

SEPTIC TANK CAPACITY 1250 GALLONS

NUMBER OF BEDROOMS 4

180 SQUARE FEET PER BEDROOM

LINEAR FEET OF TRENCH REQUIRED 180

TRENCHES - Trench to be 2 feet wide. Inlet 4 feet below original grade. Bottom maximum depth 8 feet below original grade. Effective area begins at 4 feet below original grade. 4 feet of stone below distribution pipe.

LOCATION - Beginning at the back right lot corner, place the distribution box 120 feet down the right (301.00') lot line and 220 feet off the same lot line as seen when facing the lot from Crows Foot Road. Run trenches along contour towards the right (301.00') lot line.

NOTES - No trench to exceed 100 feet in length. Provide 6" - 8" diameter cleanout and cap to grade or above on septic tank. OK 1/17/95 DKS

PLANS APPROVED BY Donna K. Soe/Ron Pinkley

DATE 07/06/94

COVER NO WORK UNTIL INSPECTED AND APPROVED

NEITHER THE HOWARD COUNTY COUNCIL NOR THE HEALTH DEPARTMENT IS RESPONSIBLE FOR THE SUCCESSFUL OPERATION OF ANY SYSTEM

NOTE: CLEANOUT REQUIRED EVERY 70 FEET OF SEWER LINE AND/OR AT 90° SWEEPS IN LINES FROM HOUSE TO DRAIN FIELDS, 90° ELBOWS NOT ACCEPTABLE.

NOTE: ALL PARTS OF SEPTIC SYSTEMS (I.E. TANK, DISTRIBUTION BOX TRENCHES) TO BE 100 FEET FROM WELL (UNLESS OTHERWISE SPECIFICALLY AUTHORIZED)

NOTE: IF DEEP TRENCH(ES) ARE USED CALL FOR INSPECTION BEFORE AND AFTER PLACING GRAVEL IN TRENCH(ES)

NOTE: NO DRY WELL SHALL EXCEED 15 FOOT IN DIAMETER NO ABSORPTION TRENCH TO EXCEED 100 FEET IN LENGTH

NOTE: ALL PIPE FROM HOUSE TO SEPTIC TANK MUST BE CAST IRON OR SCHEDULE 35/40 PVC OR ABS

PERMIT VOID AFTER TWO YEARS

NOTE: INSTALL STAND PIPE ON SEPTIC TANK AND DRY WELL STAND PIPES MUST BE 6 INCHES IN DIAMETER CAST IRON, CONCRETE OR TERRA COTTA OR PVA OR ABS ACCEPTED. IF TOP OF SEPTIC TANK IS DEEPER THAN 3 FEET, MANHOLE TO GRADE REQUIRED.

NOTE: DISTRIBUTION BOXES MUST HAVE BAFFLES

***INSTALLER IS RESPONSIBLE FOR OBTAINING FINAL APPROVAL ON THIS PERMIT**

A
38137A

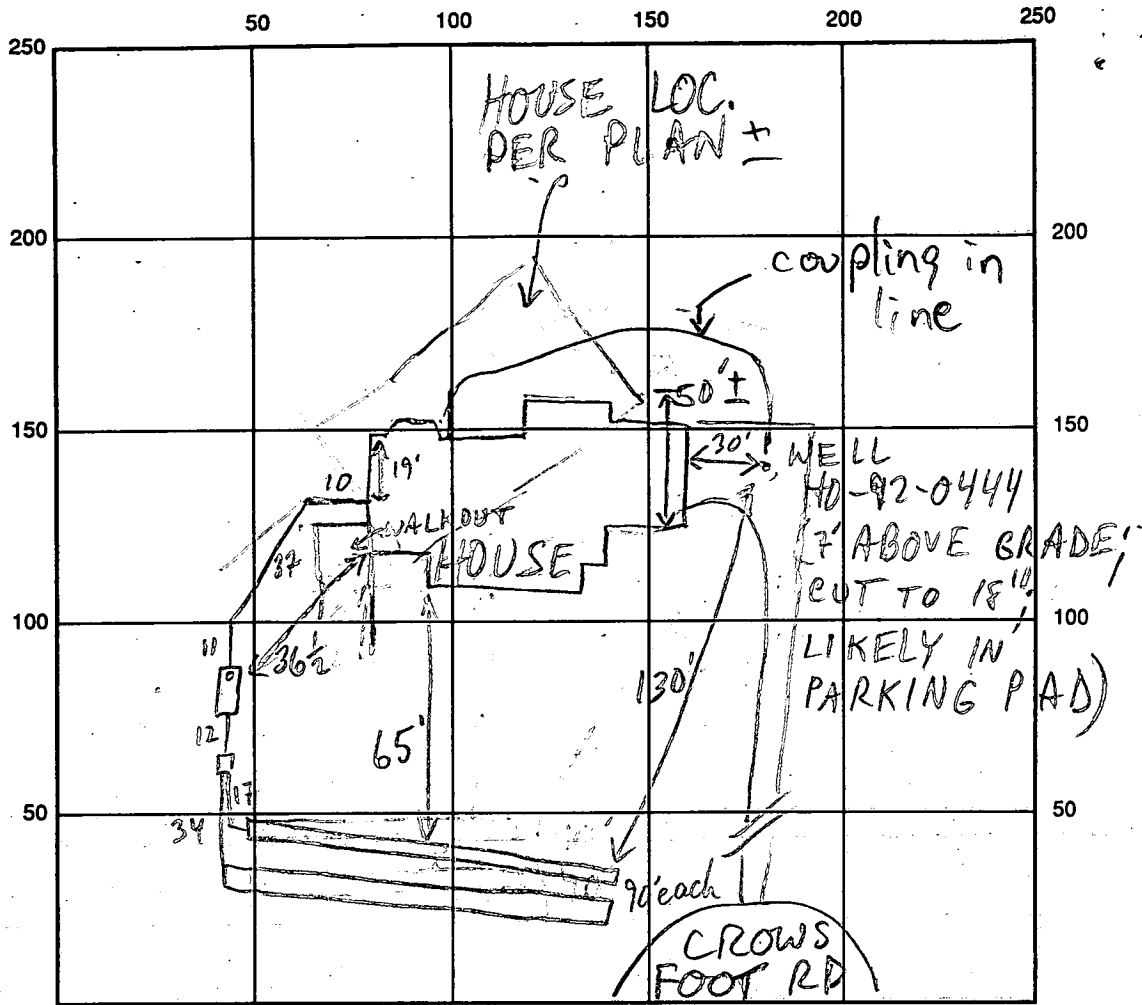

INDICATE NORTH - NAME ADJOINING ROADWAY AS BASE LINE

SEPTIC TANK LEVEL 1250 GAL - OK CLEANOUTS OK - S.T.
 DISTRIBUTION BOX LEVEL OK - BAFFLE IN
 DRAIN FIELD/TITLE DEPTH 8 1/2 FT. TRENCH WIDTH 2 1/2 FT. INLET DEPTH 4 1/2 FT.
 EFFECTIVE GRAVEL DEPTH 4 1/2 FT. TOTAL LENGTH 2 @ 90± FT.
 NUMBER OF TRENCHES 2 ONE SIDEWALL/BOTTOM AREA _____ SQ. FT.
 DRYWALL INSIDE DIAMETER _____ FT. EFFECTIVE DEPTH BELOW INLET _____ FT.

REMARKS: 7/18/95 HOUSE SEEMS TO HAVE ROTATED ~45° FROM LOC ON PLAN, LAND SLID DOWNHILL ~15'. INSTALLER MEASURED OFF OF HOUSE TO LOCATE D.B., BARELY SUFF AREA DOWNHILL FOR 2 REPAIRS, D.B. 25'± DOWNHILL, BUT HI ENUF ELEV. FOR REPAIRS UPHILL. OK TO STONE FIRST TRENCH. T/C TO OWNER TO CONFIRM ADJ. ALSO ADVISED WELL PROTECTION MR 7/19/95 #1 STONE #2 TRENCH (MID)

DATE SYSTEM APPROVED 7/19/95 INSPECTOR M. Riffkin

7/19/95 #2 GAVE FINAL OK TO COVER VIA T/C MR

OWNER: KELLY SHOVELL
 4581 NEW CUT RD.
 ELLICOTT CITY, MO. 21043
 410-461-5208

Approved Septic System Plan
 Howard County Health Department

ZEPP
 297-89

Paul M. Mullen
 Signature

1-12-95
 Date

SEPTIC TANK
 DISTRIBUTION BOX

EX. WELL: EXISTING GR. = 532.0
 FIN. GR. = 527.0

INV. OF SEWER FROM HOUSE = 518.50
 SEPTIC TANK EX. GR. = 520.00
 USE 1300901 FIN. GR. = 519.50

INV. IN = 518.00
 INV. OUT = 517.70

DISTRIBUTION BOX: EX. GR. = 516.00
 FIN. GR. = 516.00
 INV. IN = 512.00
 INV. OUT = 511.90

TRENCHES TO BE 2' WIDE
 INLET 4' BELOW ORIGINAL GRADE
 BOTTOM MAX 8' BELOW ORIGINAL GR.
 4' OF STONE BELOW DISTRIBUTION BOX

USE 180' L.T. OF TRENCH FOR 10' R.
 PLACE TABUCH ON OUTSIDE
 PROP. 2 TRENCHES @ 89 L.F. Ea

MAINTAIN 1-2% grade 10' prior to ST.

KEY
 EX. GR. = (510)
 FIN. GR. = 512
 DRAINAGE FLOW: →

PLAN

SCALE 1"=100'

LOT 79
 1352 CROWS FOOT ROAD
 MEADOWOOD

SECT 2 AR. 4
 3RD ELECT DISTR. HO. CO., MO.
 SCALE 1"=100' 11-25-94
 PLAT REF 1306 T.M. 10, F-94-76

CROWS FOOT
 ROAD
 (30' R/W)

