

C 1 3960
 SEQUENCE NO. (WRA USE ONLY)
 (THIS NUMBER IS TO BE PUNCHED IN COLUMNS 3-6 ON ALL CARDS)

STATE OF MARYLAND
 WATER RESOURCES ADMINISTRATION
 TAWES STATE OFFICE BLDG., ANNAPOLIS, MD. 21401
 WELL COMPLETION REPORT

THIS REPORT MUST BE SUBMITTED WITHIN 30 DAYS AFTER WELL COMPLETION
 FILL IN THIS FORM COMPLETELY
 COUNTY NUMBER

DATE RECEIVED (WRA USE ONLY) 5/4/78
 DATE WELL COMPLETED 5/4/78
 DEPTH OF WELL 22 (TO NEAREST FOOT) 26
 PERMIT NO. FROM "PERMIT TO DRILL WELL" HO-79-2104
 28 29 30 31 32 33/34 35 36 37
 DRILLERS IDENTIFICATION NO.

OWNER LAST NAME FIRST NAME
 STREET OR RFD POST OFFICE

WELL LOG

STATE THE KIND OF FORMATIONS PENETRATED, THEIR COLOR, DEPTH, THICKNESS AND IF WATER BEARING

DESCRIPTION (USE ADDITIONAL SHEETS IF NECESSARY)	FEET		CHECK IF WATER BEARING
	FROM	TO	
Light Brown Silt	0	2	
Light Brown Silt	2	8	
Brown Silt	8	26	
Mica	35	37	
Brown Silt	37	40	
Mica	40	41	
Brown Silt	41	40	
Mica	41	40	

GROUTING RECORD

WELL HAS BEEN GROUTED (CIRCLE APPROPRIATE BOX) YES NO

TYPE OF GROUTING MATERIAL (CIRCLE BOX)
 CEMENT BENTONITE CLAY

NO. OF BAGS 7 NO. OF POUNDS 700
 GALLONS OF WATER 35

DEPTH OF GROUT SEAL (TO NEAREST FOOT)
 FROM 0 FT. TO 28 FT.

PUMPING TEST

HOURS PUMPED (TO NEAREST HOUR) 2
 PUMPING RATE (GALLONS PER MINUTE TO NEAREST GALLON) 4
 METHOD USED TO MEASURE PUMPING RATE Bucket

WATER LEVEL: (DISTANCE FROM LAND SURFACE)
 BEFORE PUMPING 20 (NEAREST FOOT)
 WHEN PUMPING 17 (NEAREST FOOT)

TYPE OF PUMP USED (CIRCLE APPROPRIATE BOX)
 AIR PISTON TURBINE
 CENTRIFUGAL ROTARY OTHER (DESCRIBE BELOW)
 JET SUBMERSIBLE

CASING RECORD

INSERT APPROPRIATE CODE BELOW

STEEL CONCRETE
 PLASTIC OTHER

MAIN CASING TYPE 3
 NOMINAL DIAMETER TOP (MAIN) CASING (NEAREST INCH) 4
 TOTAL DEPTH OF MAIN CASING (NEAREST FOOT) 28

PUMP INSTALLED

TYPE OF PUMP (WRITE APPROPRIATE LETTER IN BOX - SEE ABOVE: A, C, J, P, R, S, T, O)

DRILLER WILL INSTALL PUMP (CIRCLE APPROPRIATE BOX) YES NO

CAPACITY:
 GALLONS PER MINUTE (TO NEAREST GALLON) 31 35
 PUMP HORSE POWER 37 41
 PUMP COLUMN LENGTH (NEAREST FOOT) 43 47

CASING HEIGHT (CIRCLE APPROPRIATE BOX AND ENTER CASING HEIGHT)
 ABOVE } LAND SURFACE (NEAREST FOOT)
 BELOW } 49 50 51

OTHER CASING (IF USED)

DIAMETER (INCH) DEPTH (FEET) FROM TO

SCREEN RECORD

SCREEN TYPE OR OPEN HOLE

INSERT APPROPRIATE CODE BELOW

STEEL BRASS OR BRONZE OPEN HOLE
 PLASTIC OTHER

DEPTH (NEAREST WHOLE FOOT)

FROM 8 TO 21
 FROM 23 TO 36
 FROM 38 TO 51

SLOT SIZE 1, 2, 3

CIRCLE APPROPRIATE BOXES

A WELL WAS ABANDONED AND SEALED WHEN THIS WELL WAS COMPLETED

E ELECTRIC LOG OBTAINED

P TEST WELL CONVERTED TO PRODUCTION WELL

DIAMETER OF SCREEN 56 (NEAREST INCH) FROM 60 TO

GRAVEL PACK

IF WELL DRILLED WAS A FLOWING WELL CIRCLE BOX 68

I HEREBY CERTIFY THAT I HAVE COMPLIED WITH ALL CONDITIONS STATED ON THE ABOVE-CAPTIONED "PERMIT TO DRILL WELL" AND THAT INFORMATION CONTAINED IN THIS REPORT IS TRUE, ACCURATE, AND COMPLETE TO THE BEST OF MY KNOWLEDGE, INFORMATION AND BELIEF.

DRILLERS NAME L.F. EASTERN
 SIGNATURE L.F. Eastern

WRA USE ONLY (NOT TO BE FILLED IN BY DRILLER) (E.R.O.S.)

TELESCOPE CASING LOG INDICATOR OTHER DATA AVAILABLE 74 75 76

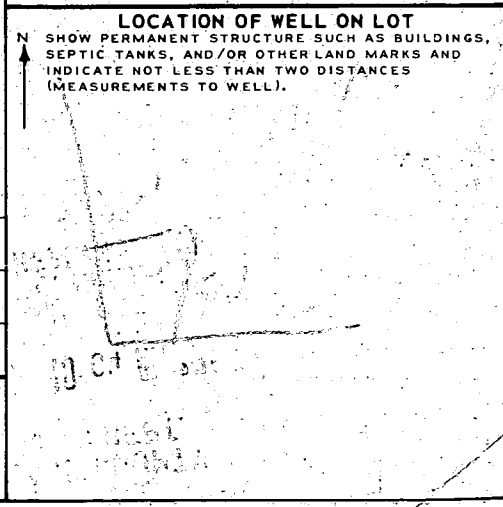

STATE OF MARYLAND WATER RESOURCES ADMINISTRATION TAWES STATE OFFICE BLDG., ANNAPOLIS, MARYLAND 21401 APPLICATION FOR PERMIT TO DRILL WELL

WRA PERMIT NUMBER 140-73-2704 FILL IN THIS FORM COMPLETELY

DATE RECEIVED (WRA USE ONLY) 5/4/78 9:30 A.M.

OWNER: Howard, 502 Linnards Ave, Catonsville, Md 21228

DRILLER INFORMATION: DATE 1/18, LICENSE NUMBER 42, SIGNATURE [Handwritten]

LOCATION OF WELL: COUNTY Howard, NEAREST TOWN West Friendship, MILES FROM TOWN 3

WELL INFORMATION: MAXIMUM PUMPING RATE 5, AVERAGE DAILY QUANTITY NEEDED 600, USE FOR WATER: M (Municipal Water Supply)

DIRECTION FROM TOWN: NEAR WHAT ROAD Rt 32, ON WHICH SIDE OF ROAD EAST, DISTANCE FROM ROAD 1/4

APPROXIMATE DEPTH OF WELL 150 FEET, APPROXIMATE DIAMETER OF WELL 6 INCH, METHOD OF DRILLING USED: AIR-ROTARY, REPLACEMENT OR DEEPEINED WELLS: N

DRAW A SKETCH BELOW SHOWING LOCATION OF WELL IN RELATION TO NEARBY TOWNS, ROADS AND STREAMS... 160 ft. deep, 30 ft. casing, 7 bags cement, 28 ft. open hole. (4 gallons a minute)

NOT TO BE FILLED IN BY DRILLER (WRA USE ONLY): APPROPRIATION PERMIT NUMBER, FORCE, CONDITIONS

BOX NUMBER: 8101, 540, NORTH COORDINATE 5051000, EAST COORDINATE 0512000, ELEVATION AT WELL HEAD (FEET) 65666768

HEALTH DEPARTMENT APPROVAL: HOWARD, APPROVED BY Donald W. Monaghan, Sanitarian

SPECIAL CONDITIONS 8-63 (WRA USE ONLY): A 26188, HEALTH

ROY EMORY DEV
LOT 13 B

SEPTIC TANK: 3 BEDROOM, 1000 GALLON
4 BEDROOM, 1250 GALLON

DRY WELL TO HAVE 120 SQUARE FEET OF SIDEWALL AREA PER BEDROOM.

DRY WELL INLET TO BE max. 4 FEET BELOW ORIGINAL GRADE.

DRY WELL BOTTOM (MAXIMUM DEPTH) TO BE 12 FEET BELOW ORIGINAL GRADE.

PLACE THE DRY WELL 195 FEET FROM THE LEFT LOT LINE AND 170 FEET FROM THE

BACK LOT LINE AS SEEN WHEN FACING THE LOT FROM THE ~~ROAD~~ FRONT LOT LINE

(NOTE THE FRONT LOT LINE IS 813.42' LONG & RUNS N 50° 36' 55" W
THE BACK LOT LINE IS 460.23' LONG & RUNS S 58° 23' 06" E

Address: 1427 Route 32

Howard County Health Dept.
P. O. Box 476
Ellicott City, Maryland 21043

owner: Edward Weston
502 Seminole Ave.
Baltimore, Md. 21228
747-6368

BLDG. PERMIT SIGNED
AND RETURNED 5/18/78
Serial No. 35802

ROY EMORY
LOT 13 B