

u/12/96

PERMIT

SEWAGE DISPOSAL SYSTEM

DEPARTMENT OF HEALTH AND MENTAL HYGIENE

04-329856

P 57308
56352
A 14797

DISTRICT 4th

DATE 10/07/96

HOWARD COUNTY HEALTH DEPARTMENT

BUREAU OF ENVIRONMENTAL HEALTH

~~XXXXXX~~ 313-2640

DATE SYSTEM APPROVED 11/12/96

INSPECTOR CW

INDEXED

South Carroll Backhoe, Inc. IS PERMITTED TO INSTALL ALTER

ADDRESS 4410 Salem Bottom Road, Westminster, Maryland 21157 PHONE 875-4197

SUBDIVISION Togans Property LOT _____ ROAD 3657 Daisy Road

PROPERTY OWNER William D. Bianco

ADDRESS _____

SEPTIC TANK CAPACITY 1000 GALLONS

NUMBER OF BEDROOMS 3

180 SQUARE FEET PER BEDROOM

LINEAR FEET OF TRENCH REQUIRED 108

TRENCHES - Trench to be 2 feet wide. Inlet 3 feet below original grade. Bottom maximum depth 8 feet below original grade. Effective area begins at 3 feet below original grade. 5 feet of stone below distribution pipe.

LOCATION - Place distribution box 133 feet from left front property corner (intersection of 371.80' front and 268.20' left lot line) and 80 feet from front lot line as viewed from Daisy Road. Install trenches on contour toward front lot line.

NOTES - No trench to exceed 100 feet in length. Provide 6" - 8" diameter cleanout and cap to grade or above on septic tank. OK 10/30/96 DKS

PLANS APPROVED BY Ronald J. Pinkley DATE 10/25/96

COVER NO WORK UNTIL INSPECTED AND APPROVED

NEITHER THE HOWARD COUNTY COUNCIL NOR THE HEALTH DEPARTMENT IS RESPONSIBLE FOR THE SUCCESSFUL OPERATION OF ANY SYSTEM

NOTE: CLEANOUT REQUIRED EVERY 70 FEET OF SEWER LINE AND/OR AT 90° SWEEPS IN LINES FROM HOUSE TO DRAIN FIELDS, 90° ELBOWS NOT ACCEPTABLE.

NOTE: ALL PARTS OF SEPTIC SYSTEMS (I.E. TANK, DISTRIBUTION BOX TRENCHES) TO BE 100 FEET FROM WELL (UNLESS OTHERWISE SPECIFICALLY AUTHORIZED)

NOTE: IF DEEP TRENCH(ES) ARE USED CALL FOR INSPECTION BEFORE AND AFTER PLACING GRAVEL IN TRENCH(ES)

NOTE: NO DRY WELL SHALL EXCEED 15 FOOT IN DIAMETER NO ABSORPTION TRENCH TO EXCEED 100 FEET IN LENGTH

NOTE: ALL PIPE FROM HOUSE TO SEPTIC TANK MUST BE CAST IRON OR SCHEDULE 35/40 PVC OR ABS

PERMIT VOID AFTER TWO YEARS

NOTE: INSTALL STAND PIPE ON SEPTIC TANK AND DRY WELL STAND PIPES MUST BE 6 INCHES IN DIAMETER CAST IRON. CONCRETE OR TERRA COTTA OR PVA OR ABS ACCEPTED. IF TOP OF SEPTIC TANK IS DEEPER THAN 3 FEET. MANHOLE TO GRADE REQUIRED.

NOTE: DISTRIBUTION BOXES MUST HAVE BAFFLES

***INSTALLER IS RESPONSIBLE FOR OBTAINING FINAL APPROVAL ON THIS PERMIT**

A 56352

WPI
 B. FULTON
 PO BOX 273
 REISTERSTOWN
 2136

well No 94-0811

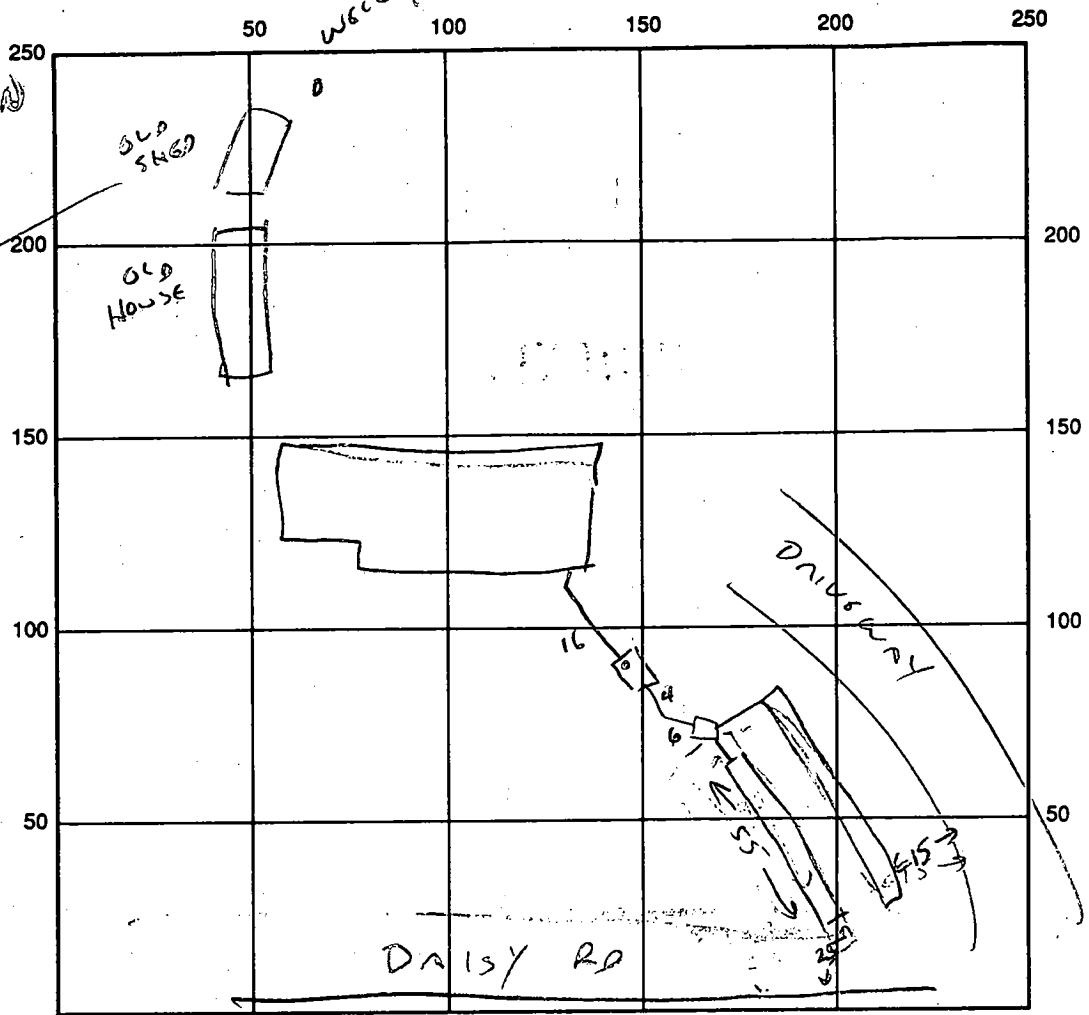

SEPTIC TANK LEVEL 1000 GAL. CLEANOUTS ST ✓
 DISTRIBUTION BOX LEVEL ✓
 DRAIN FIELD/TITLE DEPTH 8 FT. TRENCH WIDTH 2 FT. INLET DEPTH 3 FT.
 EFFECTIVE GRAVEL DEPTH 5 FT. TOTAL LENGTH 110 FT.
 NUMBER OF TRENCHES 2 @ 55' ONE SIDEWALL/BOTTOM AREA 550 SQ. FT.
 DRYWALL INSIDE DIAMETER — FT. EFFECTIVE DEPTH BELOW INLET — FT.
 ABSORBENT AREA — SQ. FT.

REMARKS: 3. TRENCHES FILLED & COVERED BEFORE INSPECTION.
OBSERVATION PIPE LEFT TO CONFIRM DEPTH / SOILS OK. 11/12/96 (CW)

DATE SYSTEM APPROVED 11/12/96 INSPECTOR CW

12/18/95

APPLICATION

PERCOLATION TESTING

A 56352

HOWARD COUNTY HEALTH DEPARTMENT
BUREAU OF ENVIRONMENTAL HEALTH
3525-H ELLICOTT MILLS DRIVE/ELLICOTT CITY, MARYLAND 21043
TELEPHONE: 313-2640

*PERGULGW OK
PREVIOUSLY APPROVED LOT OF RECORD
UNPLUMBED EXISTING HOUSE - NO KNOWN WELL OR SEPTIC
APPLICANT PROPOSES NEW SEPTIC AREA FOR ENHANCED HOUSE SITE.*

P _____
DISTRICT _____
DATE 11-29-95

TO: THE COUNTY HEALTH OFFICER
ELLICOTT CITY, MARYLAND

I HEREBY APPLY FOR THE NECESSARY TEST PRIOR TO APPLICATION FOR PERMIT TO CONSTRUCT (OR RECONSTRUCT) A SEWAGE DISPOSAL SYSTEM.

PROPERTY OWNER Elna & James Tognas estate

ADDRESS 3657 Daisy Road Woodbine, MD 21797 PHONE _____

AGENT OR PROSPECTIVE BUYER William D. Bianco

ADDRESS 15800 Carrs Mill Road Woodbine PHONE 442-1815

PROPERTY LOCATION:

SUBDIVISION _____ LOT NO. _____

ROAD AND DESCRIPTION 3657 Daisy Road Woodbine, MD 21797

TAX MAP 20 PARCEL # 82

SIZE OF LOT 1.050 acre TYPE BLDG. Single family dwelling
(SINGLE FAMILY DWELLING OR COMMERCIAL)

THE SYSTEM INSTALLED UNDER THIS APPLICATION IS ACCEPTABLE ONLY UNTIL PUBLIC FACILITIES BECOME AVAILABLE. I FULLY UNDERSTAND THE

FEE CONNECTED WITH THE FILING OF THIS PERC. TEST APPLICATION IS NON-REFUNDABLE UNDER ANY CIRCUMSTANCES. I ALSO AGREE TO

COMPLY WITH ALL M.O.S.H.A. REQUIREMENTS IN TESTING THIS LOT. Thomas L. Bianco
(SIGNATURE OF APPLICANT)

APPROVED BY _____ FOR _____ DATE _____

DISAPPROVED BY _____ FOR _____ DATE _____

HOLD PENDING FURTHER TESTS _____

REASONS FOR REJECTION OR HOLDING _____

PERCOLATION TEST PLAT/PRELIMINARY PLAT - TITLE OR I.D. # _____ DATE _____

SITE DEVELOPMENT PLAN/FINAL PLAT - TITLE OR I.D. # _____ DATE _____

THIS IS NOT A PERMIT

A 56352

COUNTY #

3637 Daisy Road

SOIL PROFILE

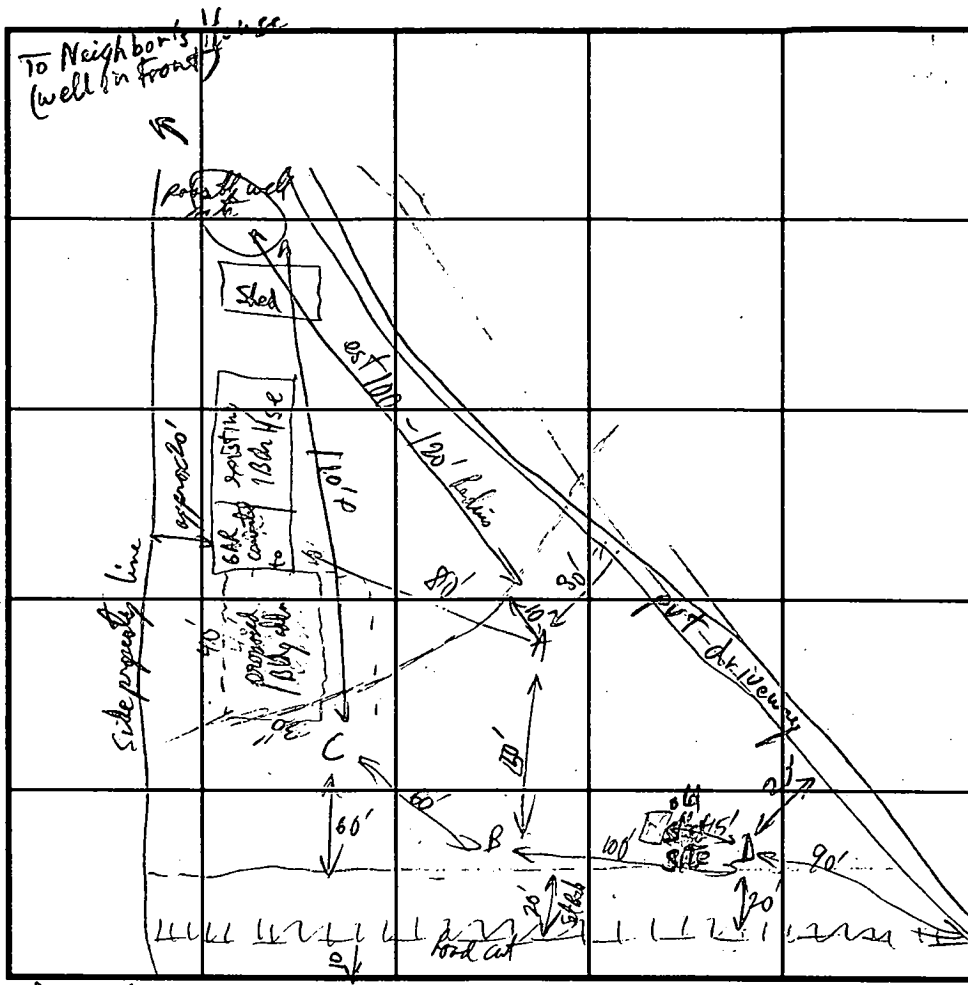

SOIL PROFILE

0'

yellow silt

3-4'

Reddish silt-L

Neutral brown - Red Brown

Reddish (soft) micaceous

12'

Daisy Rd INDICATE NORTH - NAME ADJOINING ROADWAY AS BASE LINE.

DATE	TEST NO.	DEPTH	PRE-WET		TEST - 1" DROP		TIME
			START	STOP	START	STOP	
12/18/95	D	12' 5"	11:31:30	11:34:30	11:34:30	11:39:00	4 1/2 hrs

REMARKS: Soil water factory below 3' approx. - Limit will be demarcation of available area for proposed house & odds - per future plot submitted!

TYPE OF SOIL: Cherty - glauca

TESTED BY: R. J. [unclear] ALSO PRESENT: Leg Hornemay, Tom Blasen, Mike Pherson

TRENCH DESIGN DATA: AVERAGE PERCOLATION TIME _____ TRENCH WIDTH _____

INLET DEPTH _____ MAXIMUM BOTTOM DEPTH _____ SQ. FT./BEDROOM _____

APPLICATION

PERCOLATION TESTING

Report
A 14999
P _____

HOWARD COUNTY HEALTH DEPARTMENT
BUREAU OF ENVIRONMENTAL HEALTH
3525-H ELLICOTT MILLS DRIVE/ELLICOTT CITY, MARYLAND 21043
TELEPHONE: 313-2640

DISTRICT _____
DATE 10/28/93

TO: THE COUNTY HEALTH OFFICER
ELLICOTT CITY, MARYLAND

I HEREBY APPLY FOR THE NECESSARY TEST PRIOR TO APPLICATION FOR PERMIT TO CONSTRUCT (OR RECONSTRUCT) A SEWAGE DISPOSAL SYSTEM.

PROPERTY OWNER Elva + James Torgans

ADDRESS 3657 Daisy Road, Woodbine MD PHONE 21997

AGENT OR PROSPECTIVE BUYER _____

ADDRESS _____ PHONE _____

PROPERTY LOCATION:

SUBDIVISION NA 3657 Daisy Road - Lot of Record LOT NO. NA

ROAD AND DESCRIPTION on E/ Daisy Road 0.3mi N/ Jennings Chapel Road

TAX MAP 20 PARCEL # 82

BLDG. PERMIT SIGNED
AND RETURNED 7/16/96
Serial # 64811-SFD 5Bn
(SINGLE FAMILY DWELLING OR COMMERCIAL)

SIZE OF LOT _____ TYPE BLDG. _____

THE SYSTEM INSTALLED UNDER THIS APPLICATION IS ACCEPTABLE ONLY UNTIL PUBLIC FACILITIES BECOME AVAILABLE. I FULLY UNDERSTAND THE FEE CONNECTED WITH THE FILING OF THIS PERC TEST APPLICATION IS NON-REFUNDABLE UNDER ANY CIRCUMSTANCES. I ALSO AGREE TO COMPLY WITH ALL M.O.S.H.A. REQUIREMENTS IN TESTING THIS LOT. DAVID ARNOLD
(SIGNATURE OF APPLICANT)

APPROVED BY _____ FOR _____ DATE _____

DISAPPROVED BY _____ FOR _____ DATE _____

HOLD PENDING FURTHER TESTS _____

REASONS FOR REJECTION OR HOLDING _____

PERCOLATION TEST PLAT/PRELIMINARY PLAT - TITLE OR I.D. # _____ DATE _____

SITE DEVELOPMENT PLAN/FINAL PLAT - TITLE OR I.D. # _____ DATE _____

THIS IS NOT A PERMIT

APPLICATION

A 14797

SEWAGE DISPOSAL TESTING

P _____

MARYLAND STATE DEPARTMENT OF HEALTH

HOWARD COUNTY

ELLICOTT CITY

DISTRICT 4

Septic Tank - 750 gal.

3 Dry Well - 4 1/4 sq ft sidewall area to begin below inlet pipe. Inlet pipe to be 12 ft below original grade. Max depth permitted for Dry Well below orig. grade is 12 ft.

DATE 9/10/69

Place Dry Well 186 ft from edge of bank along Daisy Rd + 37 ft from left side line as seen when facing from Daisy Rd.

VOLD
OUT DATED

CONTRACTOR -
BUD ARNOLD
ADVISED

NEW TESTS REQUIRED
9/20/69
Weller

TO: THE COUNTY HEALTH OFFICER
ELLICOTT CITY, MARYLAND

I, HEREBY, APPLY FOR THE NECESSARY TESTS IN ORDER TO CONSTRUCT (OR RECONSTRUCT) A SEWAGE DISPOSAL SYSTEM.

PROPERTY OWNER Elva & James Togans

ADDRESS Iowa St., Washington, D. C.

Any questions call:
PHONE Roger Myers
489-4687

PROPERTY LOCATION:

SUBDIVISION _____

LOT NO. _____

ROAD AND DESCRIPTION Daisy Road - 1 1/10 mile
1 1/10 mile So. of Daisy Garage on Daisy Rd.
(Use Rt. 144 end) left side on steep bank

OCCUPANT _____

PHONE _____

PERSON TO CONSTRUCT SYSTEM _____

ADDRESS _____

PHONE _____

SIZE OF LOT 1.050 acres

TYPE BLDG. _____

3
NUMBER OF BEDROOMS

IF NOT SINGLE RESIDENCE DESCRIBE _____

(Single Family Dwllg.)

SIGNATURE OF APPLICANT Roger E. Myers

APPROVED BY Dr. Manahan

FOR Dry Well

(KIND OF SYSTEM)

DATE 9/23/69

REJECTED BY _____

FOR _____

(KIND OF SYSTEM)

DATE _____

HOLD PENDING FURTHER TESTS _____

DATE _____

REASONS FOR REJECTION OR HOLDING _____

THIS IS NOT A PERMIT

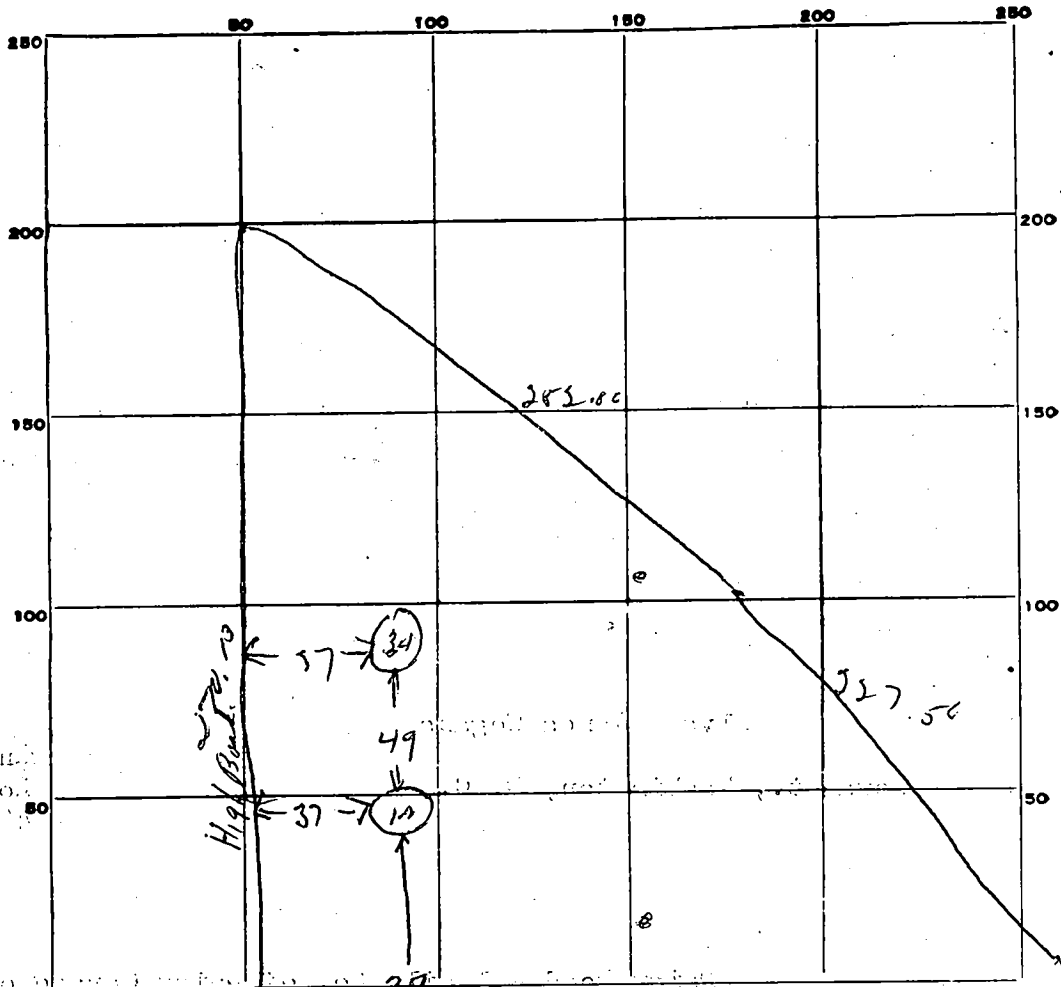

Daisy Rd

DATE	TEST NO.	DEPTH	PRE-WET		TEST - 1" DROP		TIME
			START	STOP	START	STOP	
9-23-68	1	4 1/2 ft	10 47	10 58	10 58	11 21	23 min
	2	12 ft	10 47	10 50	10 50	10 55	5 min
	3	4 ft	10 50	10 52	10 52	10 56	4 min
	4	12 ft	10 50	11 00	11 00	11 24	24 min

SOIL AUGER FINDING _____

TESTED BY *Dump*

REMARKS _____

C1 79-1 SEQUENCE NO. (MDE USE ONLY)

STATE OF MARYLAND WELL COMPLETION REPORT

THIS REPORT MUST BE SUBMITTED WITHIN 45 DAYS AFTER WELL IS COMPLETED.

(THIS NUMBER IS TO BE PUNCHED IN COLS. 3-6 ON ALL CARDS)

FILL IN THIS FORM COMPLETELY PLEASE PRINT OR TYPE

COUNTY NUMBER 13-A 56352

ST/CO USE ONLY DATE RECEIVED

DATE WELL COMPLETED

Depth of Well

PERMIT NO. FROM "PERMIT TO DRILL WELL"

OWNER Bianco William STREET OR RFD 3657 Daisy Road TOWN WOODBINE, MD

WELL LOG Not required for driven wells

GROUTING RECORD

C 3 PUMPING TEST

STATE THE KIND OF FORMATIONS PENETRATED, THEIR COLOR, DEPTH, THICKNESS AND IF WATER BEARING

WELL HAS BEEN GROUTED (Circle Appropriate Box) TYPE OF GROUTING MATERIAL (Circle one)

HOURS PUMPED (nearest hour)

DESCRIPTION (Use additional sheets if needed)	FEET		check if water bearing
	FROM	TO	
TOP SOIL	0	3	
BROWN SHAL	6	50	
BROWN white SANDSTONE	51	100	
GOT water at			85

CEMENT C M BENTONITE CLAY B C NO. OF BAGS 8 NO. OF POUNDS 732 GALLONS OF WATER 48 DEPTH OF GROUT SEAL (to nearest foot) from 0 ft. to 60 ft.

PUMPING RATE (gal. per min.) 10 WATER LEVEL (distance from land surface) BEFORE PUMPING 50 WHEN PUMPING 70

CASING RECORD casing types insert appropriate code below

METHOD USED TO MEASURE PUMPING RATE Submersible

MAIN CASING TYPE Nominal diameter top (main) casing (nearest inch) Total depth of main casing (nearest foot)

TYPE OF PUMP USED (for test) air piston turbine centrifugal rotary other (describe below) jet submersible

OTHER CASING (if used) diameter inch depth (feet) from to

PUMP INSTALLED DRILLER WILL INSTALL PUMP (CIRCLE) (YES OR NO)

NUMBER OF UNSUCCESSFUL WELLS: 0

SCREEN RECORD screen type or open hole insert appropriate code below

IF DRILLER INSTALLS PUMP, THIS SECTION MUST BE COMPLETED FOR ALL WELLS. TYPE OF PUMP INSTALLED PLACE (A,C,J,P,R,S,T,O) IN BOX 29

WELL HYDROFRACTURED YES NO

C 2 DEPTH (nearest ft.)

PUMP HORSE POWER PUMP COLUMN LENGTH (nearest ft.)

CIRCLE APPROPRIATE LETTER A A WELL WAS ABANDONED AND SEALED WHEN THIS WELL WAS COMPLETED E ELECTRIC LOG OBTAINED P TEST WELL CONVERTED TO PRODUCTION WELL

1	2	3	4	5	6	7	8	9	10	11	12	13	14	15	16	17	18	19	20	21
23	24	25	26	27	28	29	30	31	32	33	34	35	36	37	38	39	40	41	42	43
45	46	47	48	49	50	51	52	53	54	55	56	57	58	59	60	61	62	63	64	65

CAPACITY: GALLONS PER MINUTE (to nearest gallon) PUMP HORSE POWER PUMP COLUMN LENGTH (nearest ft.) CASING HEIGHT (circle appropriate box and enter casing height) LAND SURFACE (nearest foot)

I HEREBY CERTIFY THAT THIS WELL HAS BEEN CONSTRUCTED IN ACCORDANCE WITH COMAR 26.04.04 "WELL CONSTRUCTION" AND IN CONFORMANCE WITH ALL CONDITIONS STATED IN THE ABOVE CAPTIONED PERMIT, AND THAT THE INFORMATION PRESENTED HEREIN IS ACCURATE AND COMPLETE TO THE BEST OF MY KNOWLEDGE.

SLOT SIZE 1 2 3 DIAMETER OF SCREEN (NEAREST INCH)

LOCATION OF WELL ON LOT SHOW PERMANENT STRUCTURE SUCH AS BUILDING, SEPTIC TANKS, AND /OR LANDMARKS AND INDICATE NOT LESS THAN TWO DISTANCES (MEASUREMENTS TO WELL)

TYPE MWD/MSD/MGD DRILLERS LIC. NO. 410

GRAVEL PACK IF WELL DRILLED WAS FLOWING WELL INSERT F IN BOX 68

DRILLER SIGNATURE (MUST MATCH SIGNATURE ON APPLICATION)

DRILLERS SIGNATURE (MUST MATCH SIGNATURE ON APPLICATION)

MDE USE ONLY (NOT TO BE FILLED IN BY DRILLER) T (E.R.O.S.) W Q

LIC. NO.

LIC. NO.

TELESCOPE CASING LOG INDICATOR OTHER DATA

SITE SUPERVISOR (sign. of driller or journeyman responsible for sitework if different from permittee)

SITE SUPERVISOR (sign. of driller or journeyman responsible for sitework if different from permittee)

TELESCOPE CASING LOG INDICATOR OTHER DATA

COUNTY

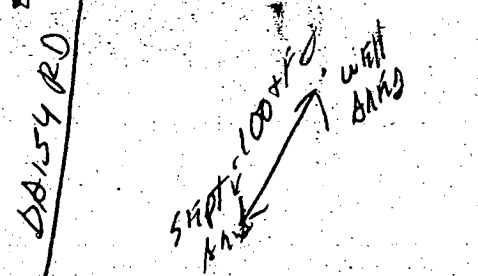

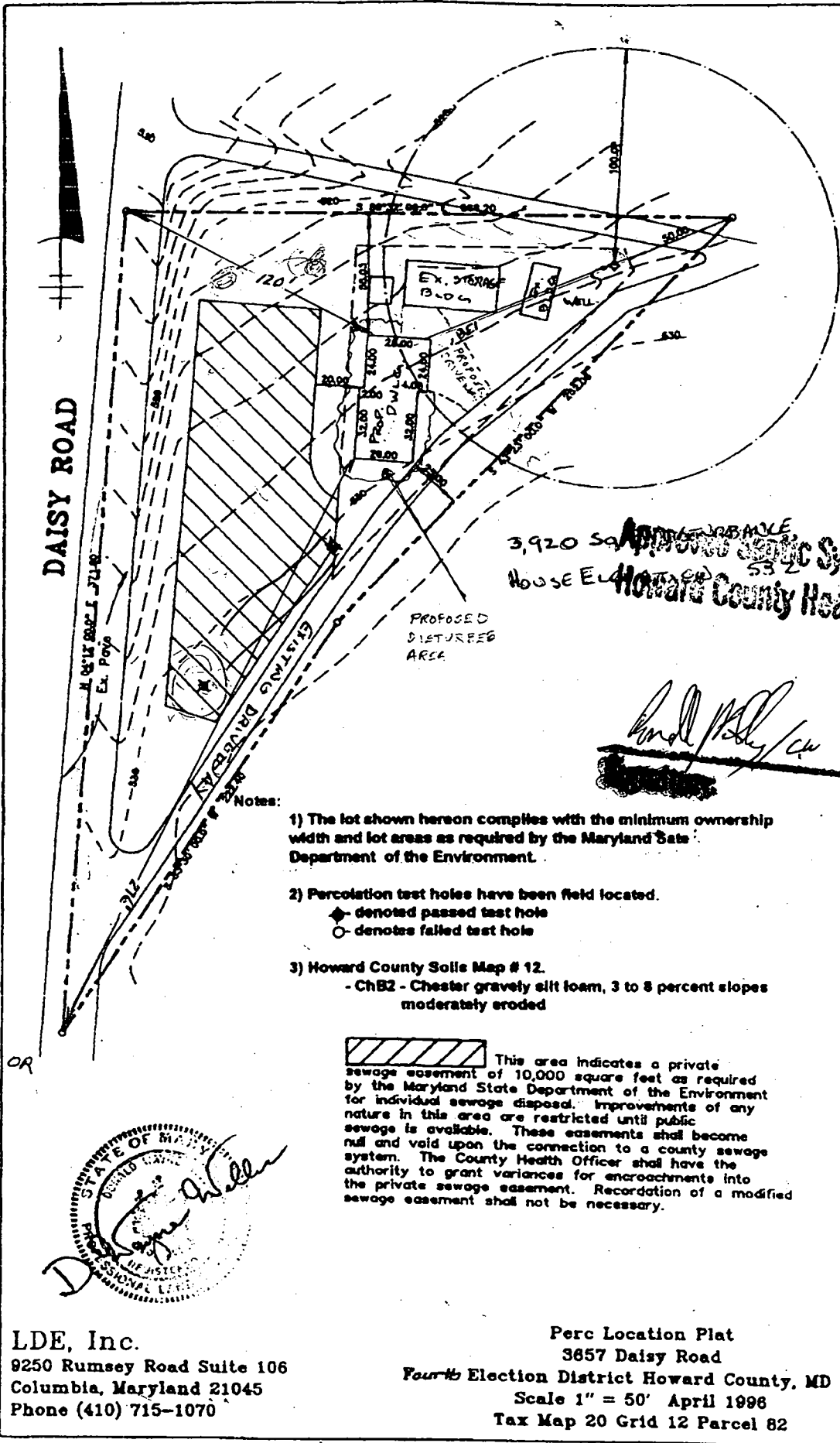

3,920 SQ. FT. APPROXIMATE
 HOUSE ELEVATION 53.2
Approved Septic System Plan
Howard County Health Department

[Signature]
 [Redacted]

7/11/96
 Date
 [Redacted]

Notes:

- 1) The lot shown hereon complies with the minimum ownership width and lot area as required by the Maryland State Department of the Environment.
- 2) Percolation test holes have been field located.
 ◆ - denotes passed test hole
 ○ - denotes failed test hole
- 3) Howard County Soils Map # 12.
 - ChB2 - Chester gravely silt loam, 3 to 8 percent slopes moderately eroded



This area indicates a private sewage easement of 10,000 square feet as required by the Maryland State Department of the Environment for individual sewage disposal. Improvements of any nature in this area are restricted until public sewage is available. These easements shall become null and void upon the connection to a county sewage system. The County Health Officer shall have the authority to grant variances for encroachments into the private sewage easement. Recordation of a modified sewage easement shall not be necessary.

5/9/96

WAYNE WELER OR
 BRUCE BURTON
 AT LOE

OLD LOT &
 RECORD,
 ENGINEER
 HAS NO ADDITIONAL
 INFO.

OWNER REQUESTS
 REPORTS SOA
 ADJUSTMENT REAL
 IN DECEMBER
 WILL CALL BACK
 WITH ADDITIONAL
 INFO. [Signature]

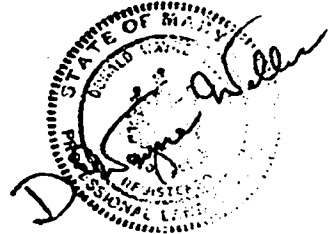

LDE, Inc.
 9250 Rumsey Road Suite 106
 Columbia, Maryland 21045
 Phone (410) 715-1070

Perc Location Plat
 3657 Daisy Road
 Fourth Election District Howard County, MD
 Scale 1" = 50' April 1996
 Tax Map 20 Grid 12 Parcel 82

File is with Perc Cert Plat being sent
 for signature 7/11/96 [Signature]

DAISY ROAD

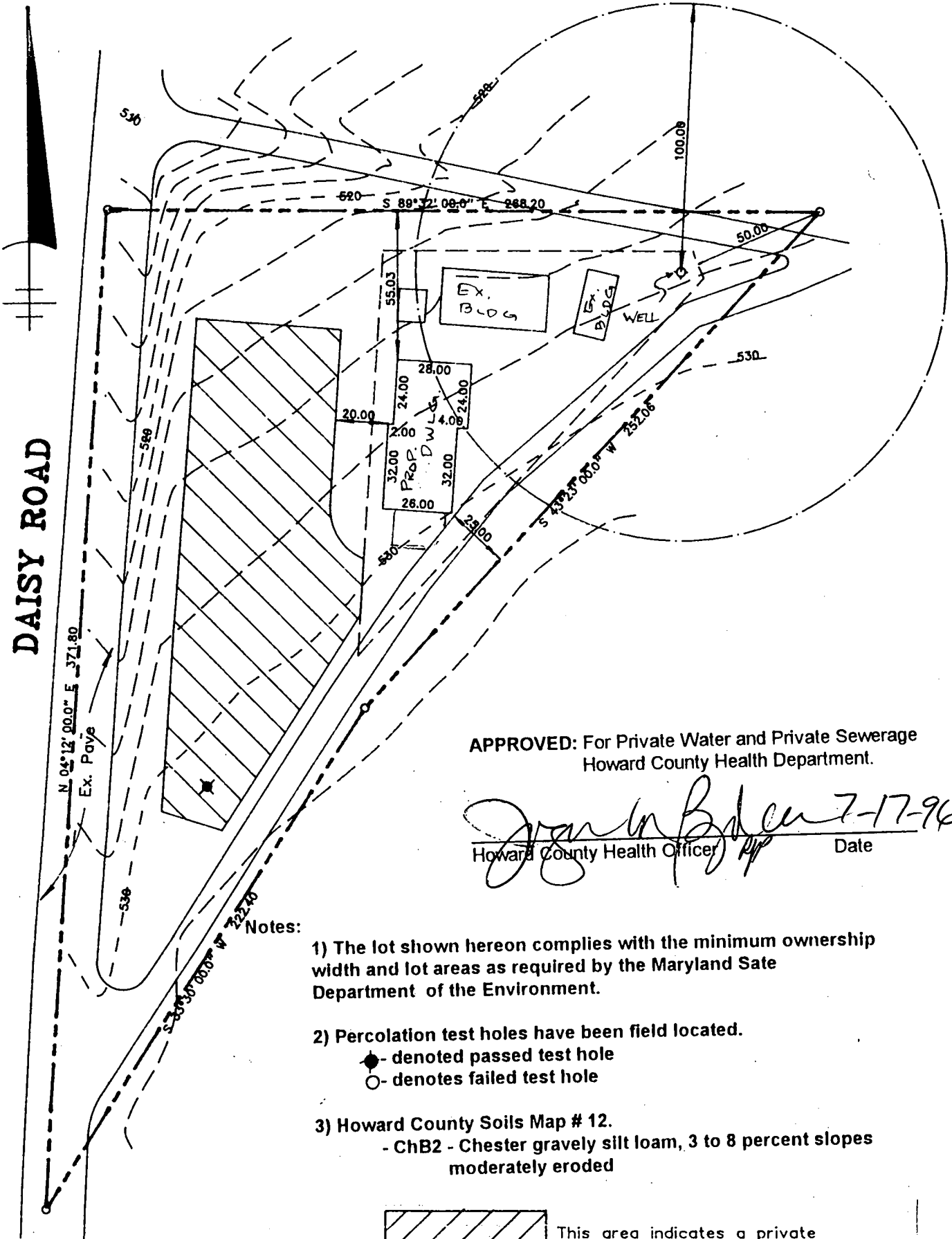

APPROVED: For Private Water and Private Sewerage
Howard County Health Department.

John W. Baker 7-17-96
Howard County Health Officer Date

Notes:

- 1) The lot shown hereon complies with the minimum ownership width and lot areas as required by the Maryland State Department of the Environment.
- 2) Percolation test holes have been field located.
 - denoted passed test hole
 - denotes failed test hole
- 3) Howard County Soils Map # 12.
 - ChB2 - Chester gravely silt loam, 3 to 8 percent slopes moderately eroded

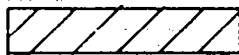

This area indicates a private sewage easement of 10,000 square feet as required by the Maryland State Department of the Environment for individual sewage disposal. Improvements of any nature in this area are restricted until public sewage is available. These easements shall become null and void upon the connection to a county sewage system. The County Health Officer shall have the authority to grant variances for encroachments into the private sewage easement. Recordation of a modified sewage easement shall not be necessary.



LDE, Inc.
9250 Rumsey Road Suite 106
Columbia, Maryland 21045
Phone (410) 715-1070

Perc Location Plat
3657 Daisy Road
Fourth Election District Howard County, MD
Scale 1" = 50' April 1996
Tax Map 20 Grid 12 Parcel 82

DAISY ROAD

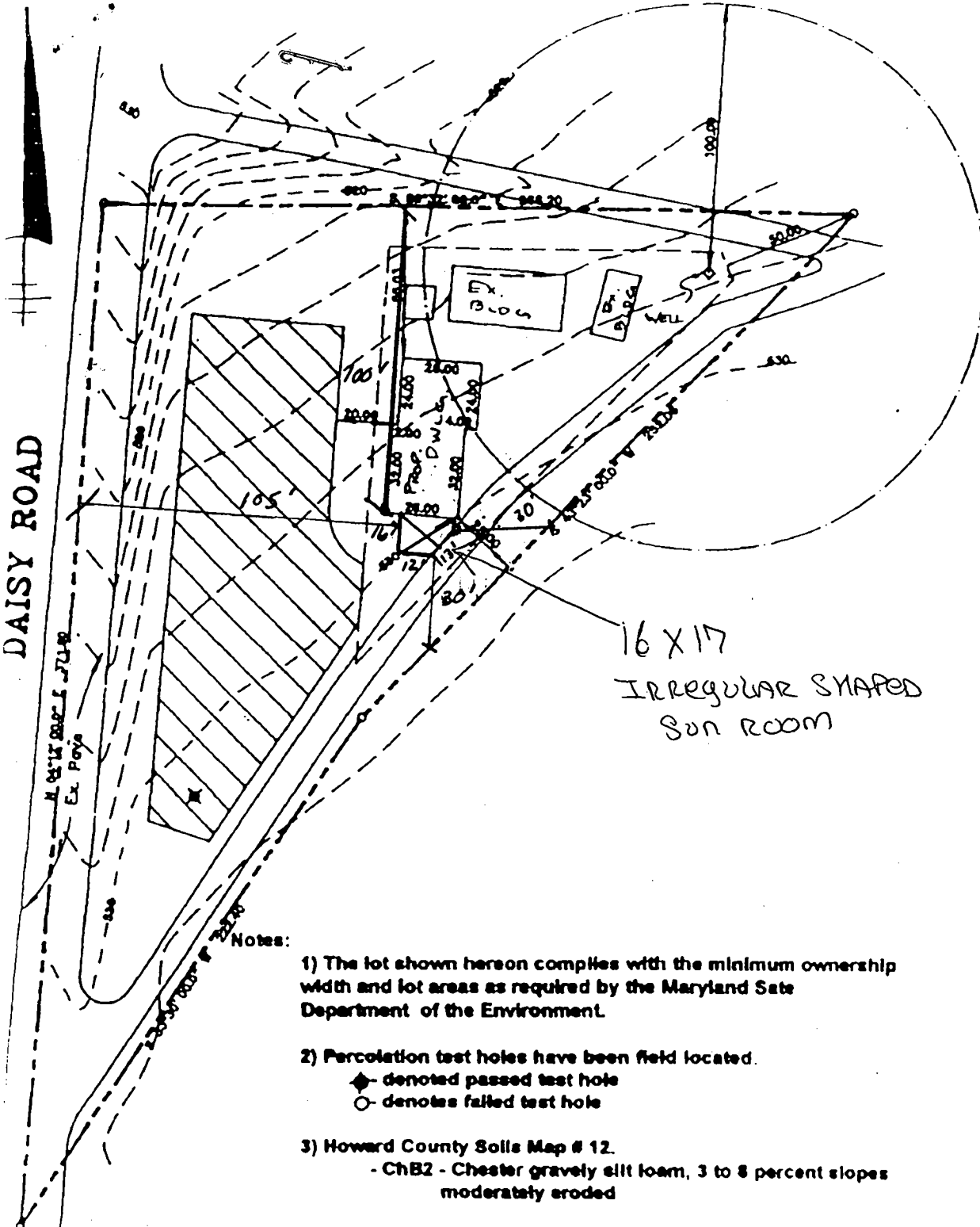

16 X 17
IRREGULAR SHAPED
SUN ROOM

B00128140
2/6/00
shown sunroom
will be < 20' to
plated SBA but
no impact to
existing septic
& no impact
on future
repairs.
A. W. M.

Notes:

- 1) The lot shown hereon complies with the minimum ownership width and lot areas as required by the Maryland State Department of the Environment.
- 2) Percolation test holes have been field located.
 - ◆ denoted passed test hole
 - denotes failed test hole
- 3) Howard County Soils Map # 12.
 - ChB2 - Chester gravely silt loam, 3 to 8 percent slopes moderately eroded

 This area indicates a private sewage easement of 10,000 square feet as required by the Maryland State Department of the Environment for individual sewage disposal. Improvements of any nature in this area are restricted until public sewage is available. These easements shall become null and void upon the connection to a county sewage system. The County Health Officer shall have the authority to grant variances for encroachments into the private sewage easement. Recordation of a modified sewage easement shall not be necessary.

