

# PERMIT

SEWAGE DISPOSAL SYSTEM

DEPARTMENT OF HEALTH AND MENTAL HYGIENE

P 50882

A Repair

DISTRICT \_\_\_\_\_

DATE 9/19/95

DATE SYSTEM APPROVED 9/19/95

INSPECTOR M. Ritkin

HOWARD COUNTY HEALTH DEPARTMENT  
BUREAU OF ENVIRONMENTAL HEALTH  
461-9933

INDEXED

Circle Plumbing

IS PERMITTED TO INSTALL \_\_\_\_\_ ALTER \_\_\_\_\_

ADDRESS 1237 Ten Oaks Rd 21227 PHONE 242-1233

SUBDIVISION \_\_\_\_\_ LOT \_\_\_\_\_ ROAD \_\_\_\_\_

PROPERTY OWNER Lynn Brunning 465-2648

ADDRESS 2609 N. Rogers Ave 21043

SEPTIC TANK CAPACITY 1000 GALLONS

NUMBER OF BEDROOMS 3

\_\_\_\_\_ SQUARE FEET PER BEDROOM

LINEAR FEET OF TRENCH REQUIRED \_\_\_\_\_

PLANS APPROVED BY \_\_\_\_\_ DATE \_\_\_\_\_

COVER NO WORK UNTIL INSPECTED AND APPROVED

NEITHER THE HOWARD COUNTY COUNCIL NOR THE HEALTH DEPARTMENT IS RESPONSIBLE FOR THE SUCCESSFUL OPERATION OF ANY SYSTEM

NOTE: CLEANOUT REQUIRED EVERY 70 FEET OF SEWER LINE AND/OR AT 90° SWEEPS IN LINES FROM HOUSE TO DRAIN FIELDS, 90° ELBOWS NOT ACCEPTABLE.

NOTE: ALL PARTS OF SEPTIC SYSTEMS (I.E. TANK, DISTRIBUTION BOX TRENCHES) TO BE 100 FEET FROM WELL (UNLESS OTHERWISE SPECIFICALLY AUTHORIZED)

NOTE: IF DEEP TRENCH(ES) ARE USED CALL FOR INSPECTION BEFORE AND AFTER PLACING GRAVEL IN TRENCH(ES)

NOTE: NO DRY WELL SHALL EXCEED 15 FOOT IN DIAMETER NO ABSORPTION TRENCH TO EXCEED 100 FEET IN LENGTH

NOTE: ALL PIPE FROM HOUSE TO SEPTIC TANK MUST BE CAST IRON OR SCHEDULE 35/40 PVC OR ABS

PERMIT VOID AFTER TWO YEARS

NOTE: INSTALL STAND PIPE ON SEPTIC TANK AND DRY WELL STAND PIPES MUST BE 6 INCHES IN DIAMETER CAST IRON. CONCRETE OR TERRA COTTA OR PVA OR ABS ACCEPTED. IF TOP OF SEPTIC TANK IS DEEPER THAN 3 FEET. MANHOLE TO GRADE REQUIRED.

NOTE: DISTRIBUTION BOXES MUST HAVE BAFFLES

**\*INSTALLER IS RESPONSIBLE FOR OBTAINING FINAL APPROVAL ON THIS PERMIT**

P  
A  
50882

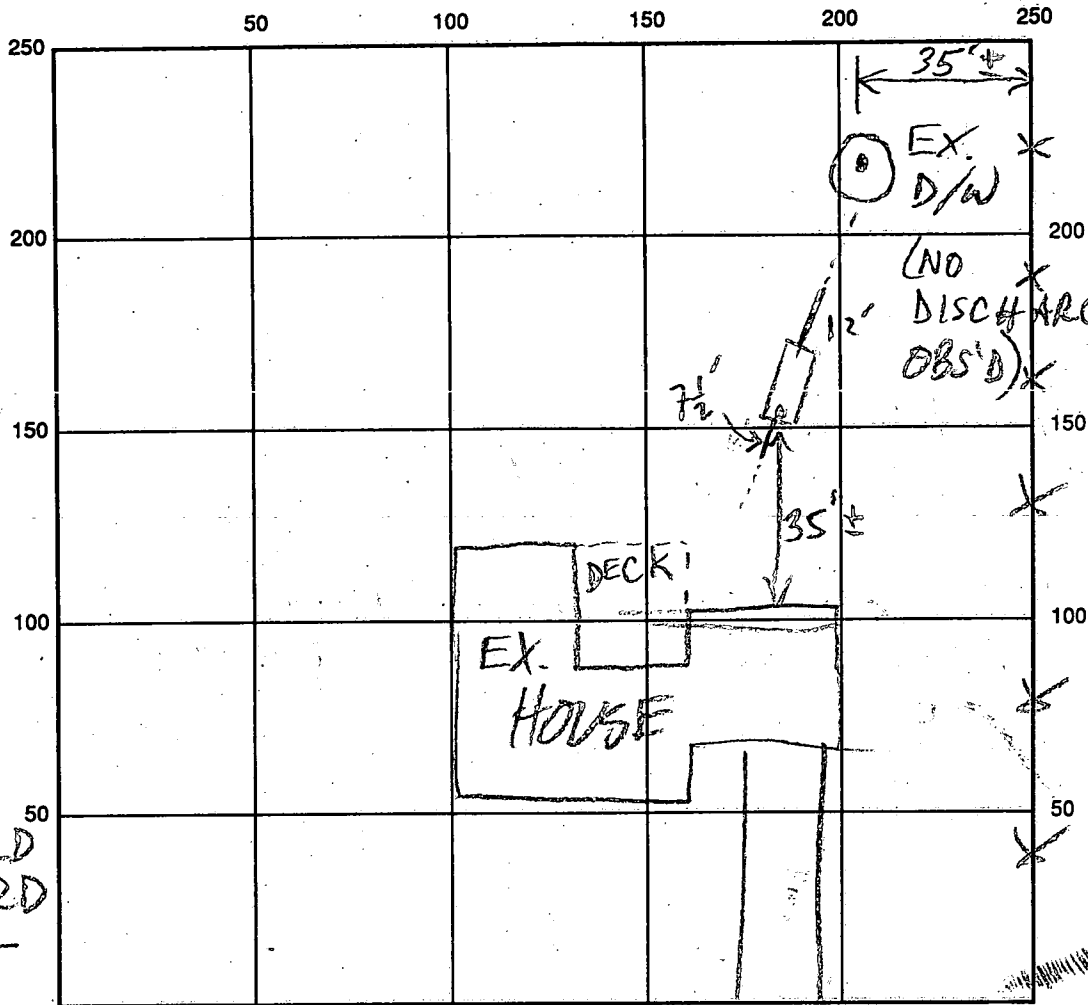

INDICATE NORTH - NAME ADJOINING ROADWAY AS BASE LINE

N. ROGERS AVE

SEPTIC TANK LEVEL 1000 GAL - OK

CLEANOUTS S.T. - OK

DISTRIBUTION BOX LEVEL     

DRAIN FIELD/TITLE DEPTH      FT.

TRENCH WIDTH      FT.

INLET DEPTH      FT.

EFFECTIVE GRAVEL DEPTH      FT.

TOTAL LENGTH      FT.

NUMBER OF TRENCHES     

ONE SIDEWALL/BOTTOM AREA      SQ. FT.

DRYWALL INSIDE DIAMETER      FT.

EFFECTIVE DEPTH BELOW INLET      FT.

ABSORBENT AREA      SQ. FT.

REMARKS:

9/19/95 S.T. OK TO COVER MR

DATE SYSTEM APPROVED

9/19/95

INSPECTOR

M. Ripkin

REGION \_\_\_\_\_

AREA \_\_\_\_\_ RATING \_\_\_\_\_

ACKNOWLEDGMENT AND CONTROLS	DATE

Howard County Department of Health  
BUREAU OF ENVIRONMENTAL HEALTH

RECORD OF INVESTIGATION

DISPOSITION	DATE

LOCATION 2609 North Rogers Ave, Ellicott City, MD ZIP \_\_\_\_\_

OWNER  OCCUPANT  ADDRESS \_\_\_\_\_ PHONE \_\_\_\_\_

COMPLAINANT R. Pinkley ADDRESS Howard County Health Dept PHONE 313-2670

REASON FOR INVESTIGATION While evaluating Next door property (2605) for septic repair, I noticed a small pipe discharging water to ground from rear house wall. This was probable sump pump effluent, but could be washer. The area ponded in backyard and passed First (continued below)

RECEIVED BY R.P. DATE 3/15/96 ASSIGNED TO \_\_\_\_\_ DATE \_\_\_\_\_

DATE OF INVESTIGATION \_\_\_\_\_ TIME \_\_\_\_\_ WEATHER \_\_\_\_\_

REPORT thru an area of young new green grass with many water puddles, then to an area surrounding a clean out pipe (septic dry well or septic tank) with black and dark brown appearance suggestive of sewage seepage over a prolonged period of time. Since this lot (@ 2609) is down slope and adjacent to a lot (2605) with known high water table problems, it seems reasonable the 2609 property's septic is also failing because of high surface water loading directly near their septic system. Closer inspection of problem on a drier day is recommended. RPK 3/15/96

3/26/96 NO ONE HOME; S.T. C/O VISIBLE FROM ROAD, NO HIGH GRASS OR DISCHARGE OBSERVABLE @ C/O, BUT SOME LIQUID COULD BE OBS'D @ END OF DRIVEWAY IN BACK YARD (20-30' FROM S.T. C/O) MR

"DARK"

3/26/96 T/C <sup>MSG.</sup> TO OWNER REGARDING ABOVE - REQUESTED SITE MTG. OR PERMISSION TO ENTER REAR YARD MR

3/27/96 T/C W/ OWNER, WHO CLAIMS NO DISCHARGE, BUT IS WILLING TO MEET @ SITE; I ADVISED HER OF EVENTS RE: H<sub>2</sub>O TABLE NEXT DOOR; INSP SET FOR 3/28/96 3:30

3/28/96 INSP REACHED TO 3/29/96 3:30 MR

DATE SUBMITTED \_\_\_\_\_ SANITARIAN \_\_\_\_\_

REGION \_\_\_\_\_

AREA \_\_\_\_\_ RATING \_\_\_\_\_

ACKNOWLEDGMENT AND CONTROLS	DATE

Howard County Department of Health  
BUREAU OF ENVIRONMENTAL HEALTH

DISPOSITION	DATE

RECORD OF INVESTIGATION

LOCATION 2609 North Rogers Ave, Ellicott City, MD ZIP \_\_\_\_\_

OWNER  OCCUPANT  ADDRESS \_\_\_\_\_ PHONE \_\_\_\_\_

COMPLAINANT R. Pinkley ADDRESS Howard County Health Dept PHONE 313-2640

REASON FOR INVESTIGATION While evaluating next door property (2605) for septic repair, I noticed a small pipe discharging water to ground from rear house wall. This was probable sump pump effluent, but could be washwater. The area ponded in backyard and passed First CODES (continued below)

RECEIVED BY R.P. DATE 3/15/96 ASSIGNED TO \_\_\_\_\_ DATE \_\_\_\_\_

DATE OF INVESTIGATION \_\_\_\_\_ TIME \_\_\_\_\_ WEATHER \_\_\_\_\_

REPORT Thru an area of young new green grass with many water puddles, then to an area surrounding a clean out pipe (septic dry well or septic tank) with black and dark brown appearance suggestive of sewage seepage over a prolonged period of time. Since this lot (@ 2609) is downslope and adjacent to a lot (2605) with known high water table problems, it seems reasonable the 2609 property's septic is also failing because of high surface water loading directly near their septic system. Closer inspection of problem on a drier day is recommended. Monthly 3/15/96

3/26/96 NO ONE HOME; S.T. C/O VISIBLE FROM ROAD, NO HIGH GRASS OR DISCHARGE OBSERVABLE @ C/O, BUT SOME LIQUID COULD BE OBS'D @ END OF DRIVEWAY IN BACK YARD (20-30' FROM S.T. C/O) MR

3/26/96 T/C <sup>MSC.</sup> TO OWNER REGARDING ABOVE - REQUESTED SITE MTG. OR PERMISSION TO ENTER REAR YARD MR

3/27/96 T/C W/ OWNER, WHO CLAIMS NO DISCHARGE; BUT IS WILLING TO MEET @ SITE; I ADVISED HER OF EVENTS.

RE: H<sub>2</sub>O TABLE NEXT DOOR - INSP SET FOR 3/28/96 3:30

3/28/96 INSP RESCHED TO 3/29/96 3:30 PM

DATE SUBMITTED \_\_\_\_\_ SANITARIAN \_\_\_\_\_

3/29/96 3/15/96 R. Pinkley



REGION \_\_\_\_\_

AREA \_\_\_\_\_ RATING \_\_\_\_\_

ACKNOWLEDGMENT AND CONTROLS	DATE

Howard County Department of Health  
BUREAU OF ENVIRONMENTAL HEALTH

DISPOSITION	DATE

RECORD OF INVESTIGATION

Page 2

LOCATION 2609 N. Rogers Ave ZIP \_\_\_\_\_

OWNER  OCCUPANT  ADDRESS \_\_\_\_\_ PHONE \_\_\_\_\_

COMPLAINANT \_\_\_\_\_ ADDRESS \_\_\_\_\_ PHONE \_\_\_\_\_

REASON FOR INVESTIGATION \_\_\_\_\_

RECEIVED BY \_\_\_\_\_ DATE \_\_\_\_\_ ASSIGNED TO R Ankley CODES \_\_\_\_\_ DATE 3/29/96

DATE OF INVESTIGATION 3/29/96 TIME 3:30 PM WEATHER Cloudy, Rained earlier & previous day

REPORT 3/29/96 - A met owner and we discussed water runoff over front of her property. She explained septic tank had been replaced this past year (water level in septic tank were at Normal levels). The pipe in back lot had been redirected along rear of house to storm water drainage easement along south property line. It no longer drains in vicinity of septic tank or drywell; drywell has waterline about 4ft below surface (ie 26 feet below ceiling of drywell) which is consistent with ground water observations on neighboring. Surface is dried up around back of lot, especially septic area and appears to have been ponded surface water previously. No evidence of sewage and No Sewage odors. Owner was instructed that as long as she keeps sump water from basement away from septic area, she should have no further problems with health department on this matter. 3/29/96

DATE SUBMITTED 3/29/96 SANITARIAN [Signature]

REGION \_\_\_\_\_

AREA \_\_\_\_\_ RATING \_\_\_\_\_

ACKNOWLEDGMENT AND CONTROLS	DATE

Howard County Department of Health  
BUREAU OF ENVIRONMENTAL HEALTH

DISPOSITION	DATE

RECORD OF INVESTIGATION

Page 2

LOCATION 2609 N. Rogers Ave ZIP \_\_\_\_\_

OWNER  OCCUPANT  ADDRESS \_\_\_\_\_ PHONE \_\_\_\_\_

COMPLAINANT \_\_\_\_\_ ADDRESS \_\_\_\_\_ PHONE \_\_\_\_\_

REASON FOR INVESTIGATION \_\_\_\_\_

RECEIVED BY \_\_\_\_\_ DATE \_\_\_\_\_ ASSIGNED TO R Ankley DATE 3/29/96

DATE OF INVESTIGATION 3/29/96 TIME 3:30 PM WEATHER Cloudy, Rained earlier + previous day

REPORT 3/29/96 - A met owner and we discussed water runoff over front of her property. She explained septic tank had been replaced this past year (water level in septic tank were at Normal levels). The pipe in back lot had been redirected along rear of house to storm water drainage easement along south property line. It no longer drains in vicinity of septic tank or drywell; drywell has waterline about 4ft below surface (ie 2 1/2 feet below ceiling of drywell) which is consistent with ground water observations on Neighboring. Surface is dried up around back of lot, especially septic area and appears to have been ponded surface water previously. - No evidence of sewage and No Sewage odors. Owner was in strudelt that as long as she keeps sump water from basement away from septic area, she should have no further problems with Health department on this matter. 3/29/96

DATE SUBMITTED 3/29/96 SANITARIAN [Signature]