

9/13/95
1-2pm
9/20/95
complete

PERMIT

SEWAGE DISPOSAL SYSTEM

DEPARTMENT OF HEALTH AND MENTAL HYGIENE

INDEXED

HOWARD COUNTY HEALTH DEPARTMENT

BUREAU OF ENVIRONMENTAL HEALTH

~~XXXXXX~~ 313-2640

04-311027

P 50806B

A REPAIR

DISTRICT _____

DATE 8/1/95

DATE SYSTEM APPROVED 9/20/95

INSPECTOR DKS

Herman Sirk IS PERMITTED TO INSTALL _____ ALTER X

ADDRESS 2555 Jennings Chapel Road, Woodbine, Maryland 21797 PHONE 489-4724

SUBDIVISION _____ LOT _____ ROAD 3336 Hipsley Mill Road

PROPERTY OWNER Kim Mayfield

ADDRESS 3336 Hipsley Mill Road
Woodbine, Maryland 21797

SEPTIC TANK CAPACITY existing GALLONS

NUMBER OF BEDROOMS 3

125 SQUARE FEET PER BEDROOM

LINEAR FEET OF TRENCH REQUIRED 75'

REPAIR - PURPOSE - SEPTIC SYSTEM HAS FAILED.

9/2/95 Call for inspection when ground is opened so sanitarian can recommend repair. 07/27/95

Run a 75' trench inlet at 3' bottom at 8' with 5 foot of stone.

Place trench 100' from existing well and appx. 10' off edge of garden,
run on contour toward the right lot line as seen when facing
the lot from Hipsley Mill Rd. Do not have to use existing drywell.

PLANS APPROVED BY _____ DATE _____

COVER NO WORK UNTIL INSPECTED AND APPROVED

NEITHER THE HOWARD COUNTY COUNCIL NOR THE HEALTH DEPARTMENT IS RESPONSIBLE FOR THE SUCCESSFUL OPERATION OF ANY SYSTEM

NOTE: CLEANOUT REQUIRED EVERY 70 FEET OF SEWER LINE AND/OR AT 90° SWEEPS IN LINES FROM HOUSE TO DRAIN FIELDS, 90° ELBOWS NOT ACCEPTABLE.

NOTE: ALL PARTS OF SEPTIC SYSTEMS (I.E. TANK, DISTRIBUTION BOX TRENCHES) TO BE 100 FEET FROM WELL (UNLESS OTHERWISE SPECIFICALLY AUTHORIZED)

NOTE: IF DEEP TRENCH(ES) ARE USED CALL FOR INSPECTION BEFORE AND AFTER PLACING GRAVEL IN TRENCH(ES)

NOTE: NO DRY WELL SHALL EXCEED 15 FOOT IN DIAMETER NO ABSORPTION TRENCH TO EXCEED 100 FEET IN LENGTH

NOTE: ALL PIPE FROM HOUSE TO SEPTIC TANK MUST BE CAST IRON OR SCHEDULE 35/40 PVC OR ABS

PERMIT VOID AFTER TWO YEARS

NOTE: INSTALL STAND PIPE ON SEPTIC TANK AND DRY WELL STAND PIPES MUST BE 6 INCHES IN DIAMETER CAST IRON, CONCRETE OR TERRA COTTA OR PVA OR ABS ACCEPTED. IF TOP OF SEPTIC TANK IS DEEPER THAN 3 FEET. MANHOLE TO GRADE REQUIRED.

NOTE: DISTRIBUTION BOXES MUST HAVE BAFFLES

***INSTALLER IS RESPONSIBLE FOR OBTAINING FINAL APPROVAL ON THIS PERMIT**

P50806B

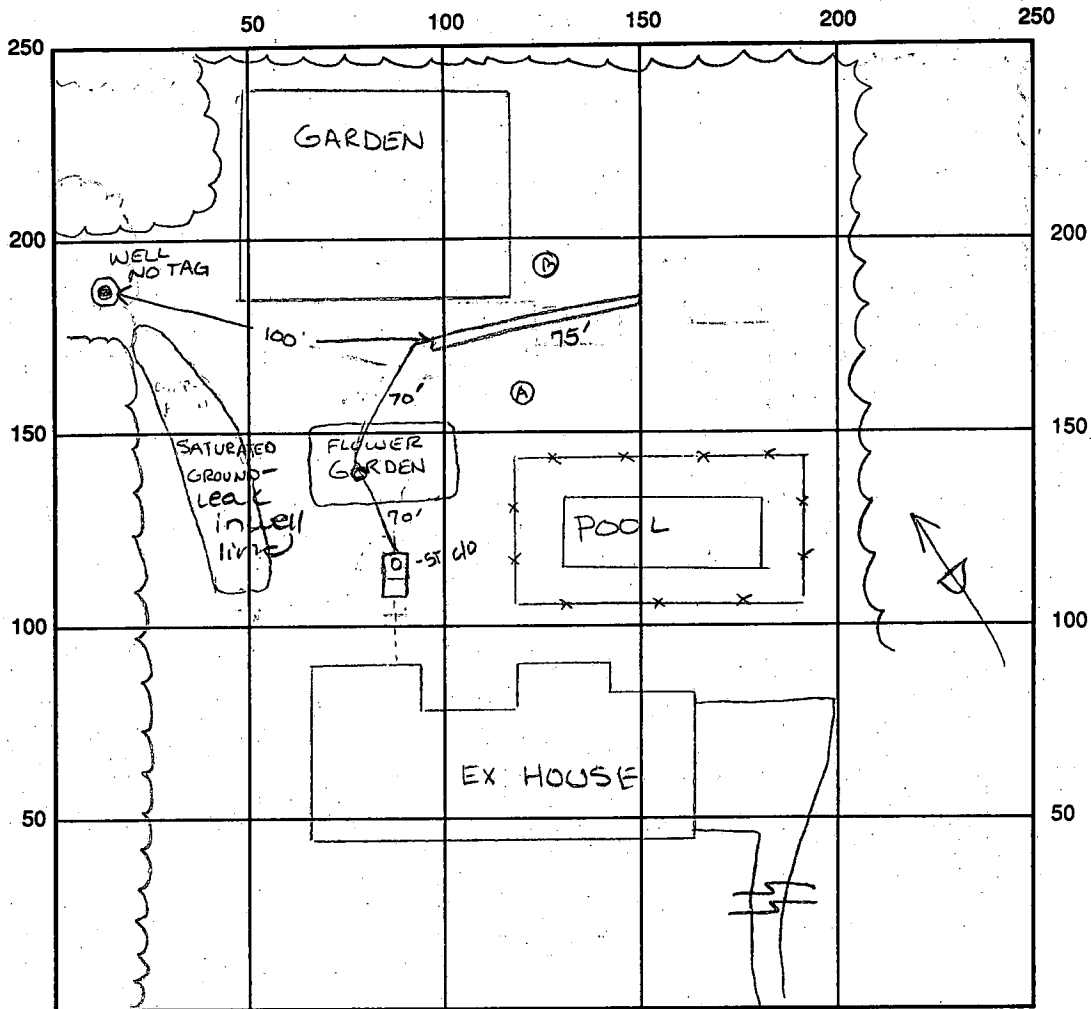

INDICATE NORTH - NAME ADJOINING ROADWAY AS BASE LINE Hipsley Mill Rd.

SEPTIC TANK LEVEL Existing CLEANOUTS one on st., one in line

DISTRIBUTION BOX LEVEL N/A

DRAIN FIELD/TITLE DEPTH 8 FT. TRENCH WIDTH 2 FT. INLET DEPTH 3 FT.

EFFECTIVE GRAVEL DEPTH 5 FT. TOTAL LENGTH 75 FT.

NUMBER OF TRENCHES 1 ONE SIDEWALL/AREA 375 SQ. FT.

DRYWALL INSIDE DIAMETER — FT. EFFECTIVE DEPTH BELOW INLET — FT.

ABSORBENT AREA 375 SQ. FT.

REMARKS: 9/18/95 OK to store trench and continue. DKS

9/20/95 FINAL - OK to cover all work. DKS

DATE SYSTEM APPROVED 9/20/95 INSPECTOR DOWNER

(A) -
55090 shale to 15'
FAIL

(B)
yellow
brn cl
2
2090
saprotite
orange brn
Solum
7
reddish pink
Si Solum
50% shale
35

75'