

8/29/95
ASAP
(open trench)

PERMIT

SEWAGE DISPOSAL SYSTEM

DEPARTMENT OF HEALTH AND MENTAL HYGIENE

04-324382

P 50806A
P 35246
A REPAIR

HOWARD COUNTY HEALTH DEPARTMENT

BUREAU OF ENVIRONMENTAL HEALTH

~~XXXXXXXXX~~ 313-2640

INDEXED

DISTRICT _____

DATE 8/1/95

DATE SYSTEM APPROVED 8/29/95

INSPECTOR *R. Hinkley*

Herman Sirk _____ IS PERMITTED TO INSTALL _____ ALTER

ADDRESS 2555 Jennings Chapel Road, Woodbine, Maryland 21797 PHONE 489-4724

SUBDIVISION _____ LOT _____ ROAD ~~14975~~ 14925 Old Frederick Road

PROPERTY OWNER Kenney
14979 Old Frederick Road

ADDRESS _____

SEPTIC TANK CAPACITY _____ GALLONS

NUMBER OF BEDROOMS 3

180 SQUARE FEET PER BEDROOM

LINEAR FEET OF TRENCH REQUIRED 90

180
x 3
540
90

REPAIR - PURPOSE - SEPTIC SYSTEM HAS FAILED.

Call for inspection when ground is opened so sanitarian can recommend repair. 07/27/95

Install one 90 Ft Long Trench, 2Ft wide, inlet at 4 Ft, Max Bottom 20 Ft, 6Ft
stone fill. Disconnect from old Repair Trench. *RPP 8/21/95*

PLANS APPROVED BY *R. Hinkley* DATE 8/21/95

COVER NO WORK UNTIL INSPECTED AND APPROVED

NEITHER THE HOWARD COUNTY COUNCIL NOR THE HEALTH DEPARTMENT IS RESPONSIBLE FOR THE SUCCESSFUL OPERATION OF ANY SYSTEM

NOTE: CLEANOUT REQUIRED EVERY 70 FEET OF SEWER LINE AND/OR AT 90° SWEEPS IN LINES FROM HOUSE TO DRAIN FIELDS, 90° ELBOWS NOT ACCEPTABLE.

NOTE: ALL PARTS OF SEPTIC SYSTEMS (I.E. TANK, DISTRIBUTION BOX TRENCHES) TO BE 100 FEET FROM WELL (UNLESS OTHERWISE SPECIFICALLY AUTHORIZED)

NOTE: IF DEEP TRENCH(ES) ARE USED CALL FOR INSPECTION BEFORE AND AFTER PLACING GRAVEL IN TRENCH(ES)

NOTE: NO DRY WELL SHALL EXCEED 15 FOOT IN DIAMETER NO ABSORPTION TRENCH TO EXCEED 100 FEET IN LENGTH

NOTE: ALL PIPE FROM HOUSE TO SEPTIC TANK MUST BE CAST IRON OR SCHEDULE 35/40 PVC OR ABS

PERMIT VOID AFTER TWO YEARS

NOTE: INSTALL STAND PIPE ON SEPTIC TANK AND DRY WELL STAND PIPES MUST BE 6 INCHES IN DIAMETER CAST IRON. CONCRETE OR TERRA COTTA OR PVA OR ABS ACCEPTED. IF TOP OF SEPTIC TANK IS DEEPER THAN 3 FEET. MANHOLE TO GRADE REQUIRED.

NOTE: DISTRIBUTION BOXES MUST HAVE BAFFLES

***INSTALLER IS RESPONSIBLE FOR OBTAINING FINAL APPROVAL ON THIS PERMIT**

A 50806A

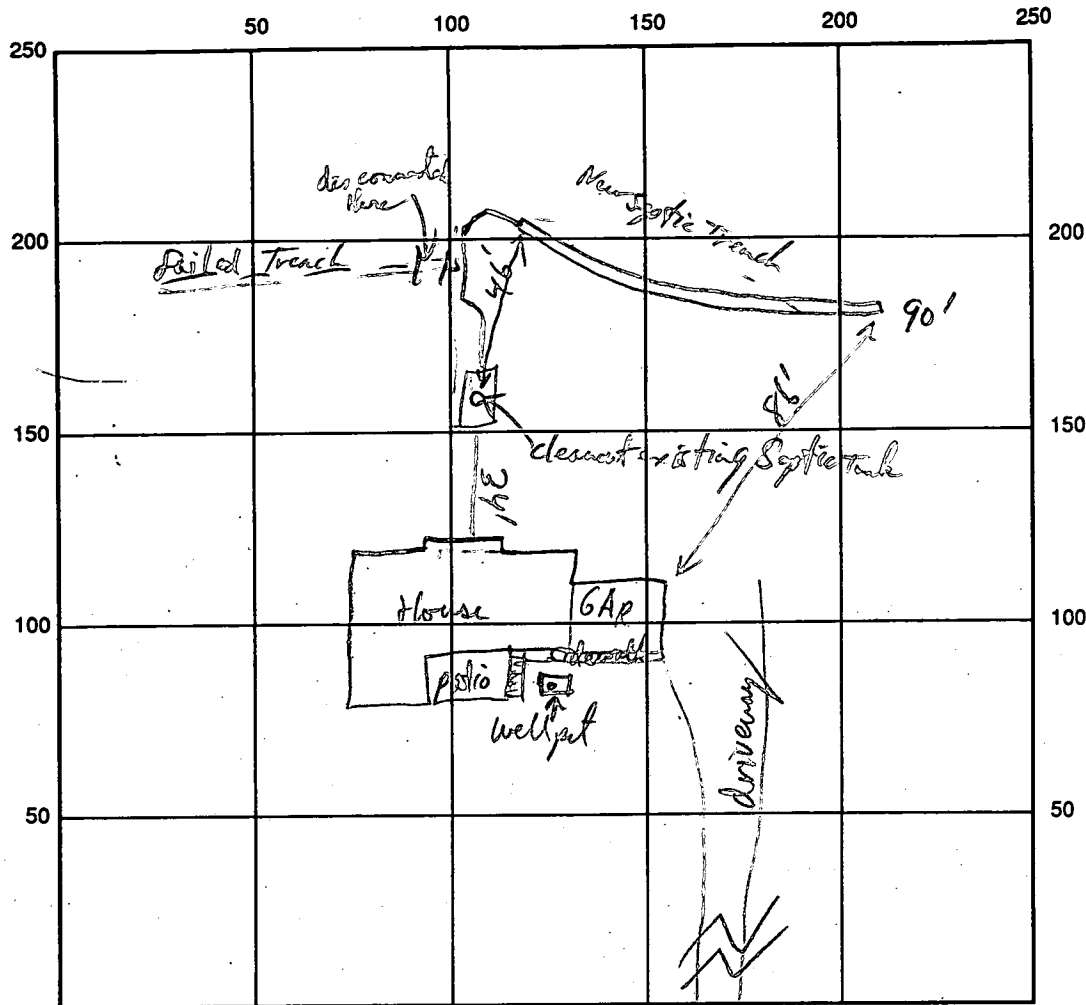

$$\begin{array}{r} .90 \\ 6 \overline{) 540} \\ \underline{540} \\ 0 \end{array}$$

Old Fred Rd INDICATE NORTH - NAME ADJOINING ROADWAY AS BASE LINE

SEPTIC TANK LEVEL existing 1000gal CLEANOUTS exist ST
 DISTRIBUTION BOX LEVEL NA
 DRAIN FIELD/TITLE DEPTH 10' FT. TRENCH WIDTH 2 FT. INLET DEPTH 4 FT.
 EFFECTIVE GRAVEL DEPTH 6 FT. TOTAL LENGTH 90 FT.
 NUMBER OF TRENCHES one ONE SIDEWALL/BOTTOM AREA _____ SQ. FT.
 DRYWALL INSIDE DIAMETER _____ FT. EFFECTIVE DEPTH BELOW INLET _____ FT.
 ABSORBENT AREA _____ SQ. FT.

REMARKS: OK to finish gravel filling Trench, then OK to cover. PJP 8/29/95

DATE SYSTEM APPROVED 8/29/95 INSPECTOR RJ Paribley

4/16/85
4/18/85
930

AM.
ASAP.
2 Grapes
trench + final lot

PERMIT

4-18-85
approved
Sabel

P 35246
A REPAIR

SEWAGE DISPOSAL SYSTEM

MARYLAND STATE DEPARTMENT OF HEALTH

HOWARD COUNTY
BUREAU OF ENVIRONMENTAL HEALTH
992-2330

ELLICOTT CITY
DISTRICT _____
DATE 4/4/85

INDEXED

Arnold Septic Tank Service IS PERMITTED TO INSTALL _____ ALTER X

ADDRESS Jacobs Road, Mt. Airy, Maryland 21771 PHONE 795-7873

SUBDIVISION _____ ROAD 14979 Old Frederick LOT _____

PROPERTY OWNER Joan Newmann

ADDRESS 14975 14979 Old Frederick Road
Woodbine, Maryland 21797

IF GARBAGE GRINDER IS USED INCREASE SEPTIC TANK CAPACITY BY 50% AND ABSORPTION AREA BY 22%.

GARBAGE GRINDER? YES _____ NO X

SEPTIC TANK CAPACITY 1000 GALLONS NUMBER OF BEDROOMS 3

REPAIR - CALL FOR INSPECTION WHEN GROUND IS OPENED UP SO SANITARIAN CAN RECOMMEND

REPAIR.

4/16/85 - IF NEEDED 1000 GAL TANK
TRENCH - 10 FT DEEP 6 FT STONE
INLET 4 FT BELOW GRADE EXAMINE
(80 LONG 6 FT STONE 2 FT WIDE)
PLACE 75 FT BEHIND HOUSE
MAKE IT 80 FT LONG IF NOT CONNECTED TO

PLANS APPROVED BY Craig Williams DATE 4/3/85

COVER NO WORK UNTIL INSPECTED AND APPROVED. OLD DRAIN FIELD

NEITHER THE HOWARD COUNTY COUNCIL NOR THE HEALTH DEPARTMENT IS RESPONSIBLE FOR THE SUCCESSFUL OPERATION OF ANY SYSTEM.

NOTE: IF TRENCH IS USED CALL FOR INSPECTION BEFORE AND AFTER PLACING GRAVEL IN TRENCH.

NOTE: NO DRY WELL SHALL EXCEED 15 FOOT IN DIAMETER. NO ABSORPTION TRENCH TO EXCEED 100 FEET IN LENGTH.

NOTE: ALL PIPE FROM HOUSE TO SEPTIC TANK MUST BE CAST IRON OR SCHEDULE 40 PVC OR ABS.

PERMIT VOID AFTER THREE YEARS.

NOTE: INSTALL STAND PIPE ON SEPTIC TANK AND DRY WELL. STAND PIPES MUST BE 6 INCHES IN DIAMETER. CAST IRON, CONCRETE OR TERRA COTTA, OR PVC OR ABS ACCEPTED. IF TOP OF SEPTIC TANK IS DEEPER THAN 3 FEET MANHOLE TO GRADE REQUIRED.

***INSTALLER IS RESPONSIBLE FOR OBTAINING FINAL APROVAL ON THIS PERMIT**

*CALL 992-2330 FOR INSPECTION OF SEPTIC SYSTEMS.

EH - 2-1082

P 35246

①
 BROWN CLAY
 BROWN & REDDISH SAND LOAM

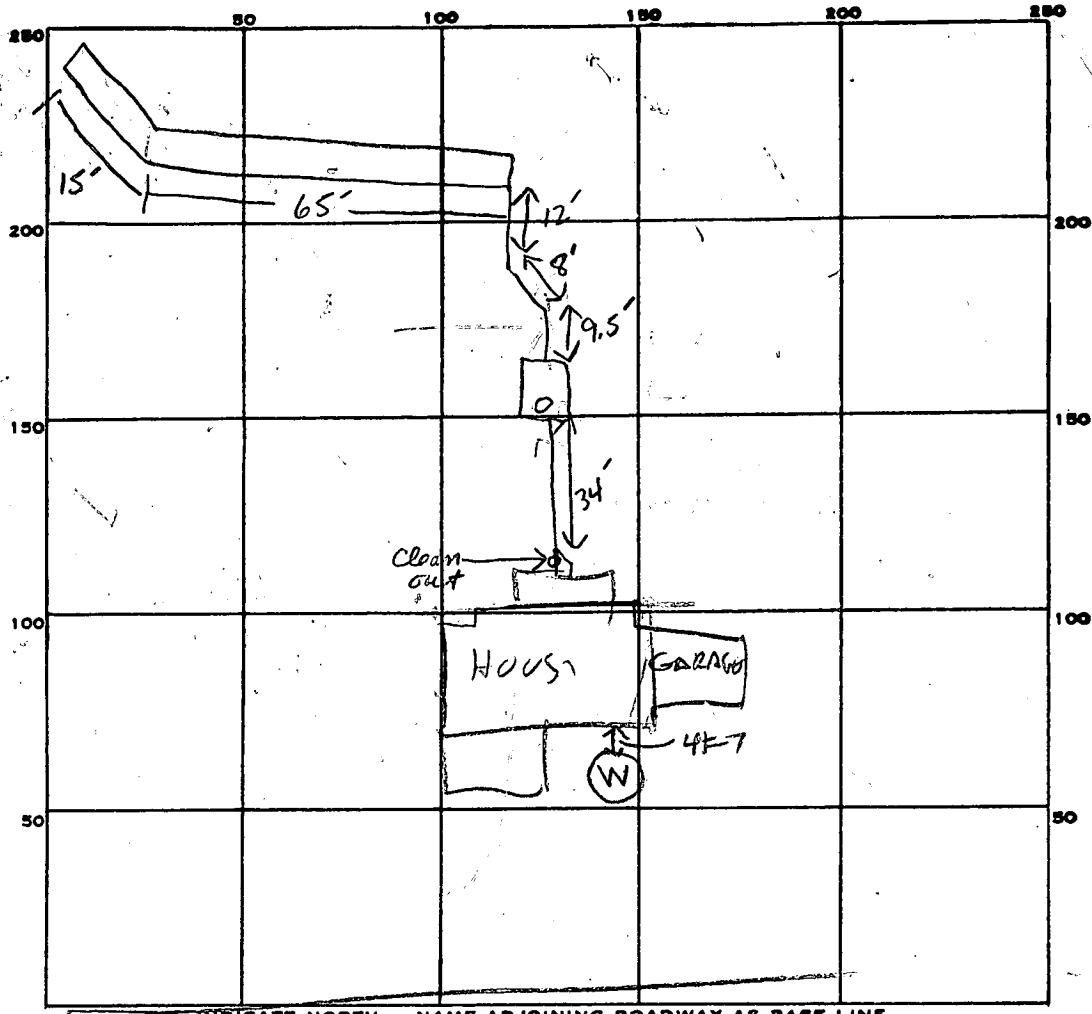

INDICATE NORTH - NAME ADJOINING ROADWAY AS BASE LINE.

ROUTE 699

65
 6

 390

PERMIT CARD

SEPTIC TANK, LEVEL 1000 CLEANOUTS ST + INLINE

DISTRIBUTION BOX, LEVEL N/A

TILE FIELD, DEPTH 10 FT. TRENCH WIDTH 2 FT. INLET 4"

GRAVEL DEPTH 6 FEET TOTAL LENGTH 80 FT.

NUMBER OF TRENCHES 1 TOTAL BOTTOM AREA 480 sq ft

SEEPAGE PITS, INSIDE DIAMETER — FT. DEPTH BELOW INLET — FT.

ABSORBENT AREA 480 SQ. FT.

REMARKS	4/15/85	15	8.5	1033	1036	1036	1045	9
		IV	LOOKS OK					

4-18-85 OK TO COVER WORK

DATE SYSTEM APPROVED 4-18-85 INSPECTOR Stabel