

7/13/95 ASAP

PERMIT

SEWAGE DISPOSAL SYSTEM

DEPARTMENT OF HEALTH AND MENTAL HYGIENE

05-342589

P 50671

A REPAIR

DISTRICT _____

DATE 4-24-95

HOWARD COUNTY HEALTH DEPARTMENT

BUREAU OF ENVIRONMENTAL HEALTH

461-9933

DATE SYSTEM APPROVED 4/17/95

INSPECTOR *[Signature]*

INDEXED

Jenkins Brothers IS PERMITTED TO INSTALL _____ ALTER

ADDRESS 7670 Smith's Private Road, Sykesville, Maryland 21784 PHONE 461-9282

SUBDIVISION _____ LOT _____ ROAD _____

PROPERTY OWNER Linda Pachoca

ADDRESS 6540 Harland Mill Road Clarksville, MD 21029

SEPTIC TANK CAPACITY 2000 GALLONS *existing is 2000 - No New Tank Necessary 4/13/95 use exist S.T. (750 or 1000 gal est) and add one 1500 gal S.T. in series*

NUMBER OF BEDROOMS 8 *(or 100 gal/person x 15 resident = 1500 gal/day capacity)*

180 SQUARE FEET PER BEDROOM x 8 = 1440 sqft *or 1500 ÷ 1.19 gal/sqft = 1260 sqft*

LINEAR FEET OF TRENCH REQUIRED 288

PURPOSE - System is failing. Intent is to repair system and expand as necessary.

to support the requirements for an expansion to an 8 bedroom group home.

Call for inspection when ground is opened so sanitarian can recommend repair.

Install 3 second 1500 gal septic tank in series, OK to pass thru existing dry well use a "T" Baffle at outlet pipe. Install 3 Trench on Contour (100' each ±).

Use 5' stone fill below inlet - inlet at 2' or 3' below original grade & bottom @ 7' or 8' respectively

PLANS APPROVED BY *Ronald J. Kelly* DATE 4/13/95

COVER NO WORK UNTIL INSPECTED AND APPROVED *Note: Sewer opened S.T.*

NEITHER THE HOWARD COUNTY COUNCIL NOR THE HEALTH DEPARTMENT IS RESPONSIBLE FOR THE SUCCESSFUL OPERATION OF ANY SYSTEM

NOTE: CLEANOUT REQUIRED EVERY 70 FEET OF SEWER LINE AND/OR AT 90° SWEEPS IN LINES FROM HOUSE TO DRAIN FIELDS, 90° ELBOWS NOT ACCEPTABLE.

NOTE: ALL PARTS OF SEPTIC SYSTEMS (I.E. TANK, DISTRIBUTION BOX TRENCHES) TO BE 100 FEET FROM WELL (UNLESS OTHERWISE SPECIFICALLY AUTHORIZED)

NOTE: IF DEEP TRENCH(ES) ARE USED CALL FOR INSPECTION BEFORE AND AFTER PLACING GRAVEL IN TRENCH(ES)

NOTE: NO DRY WELL SHALL EXCEED 15 FOOT IN DIAMETER NO ABSORPTION TRENCH TO EXCEED 100 FEET IN LENGTH

NOTE: ALL PIPE FROM HOUSE TO SEPTIC TANK MUST BE CAST IRON OR SCHEDULE 35/40 PVC OR ABS

PERMIT VOID AFTER TWO YEARS

NOTE: INSTALL STAND PIPE ON SEPTIC TANK AND DRY WELL STAND PIPES MUST BE 6 INCHES IN DIAMETER CAST IRON. CONCRETE OR TERRA COTTA OR PVA OR ABS ACCEPTED. IF TOP OF SEPTIC TANK IS DEEPER THAN 3 FEET. MANHOLE TO GRADE REQUIRED.

NOTE: DISTRIBUTION BOXES MUST HAVE BAFFLES

*INSTALLER IS RESPONSIBLE FOR OBTAINING FINAL APPROVAL ON THIS PERMIT

50671

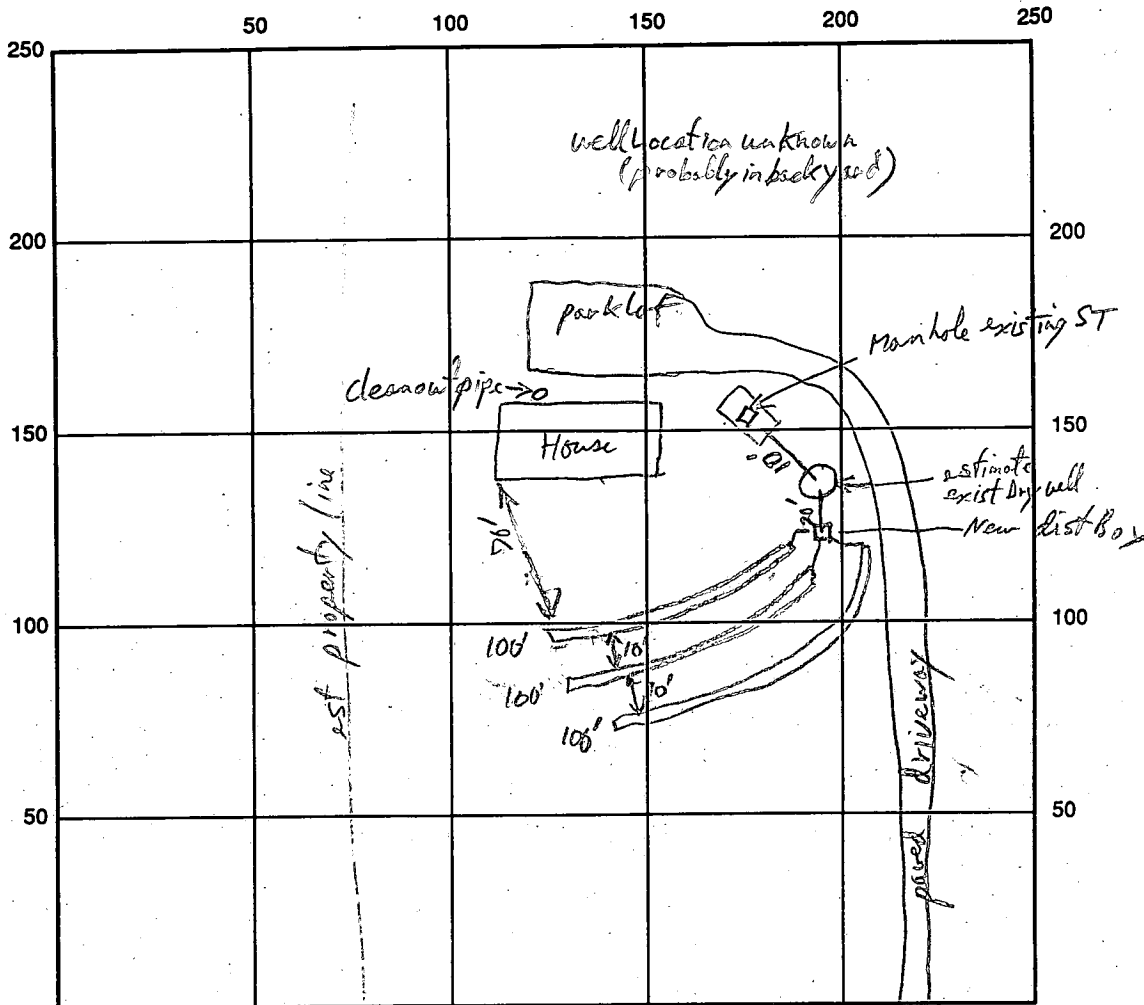

INDICATE NORTH - NAME ADJOINING ROADWAY AS BASE LINE
Hawland Mill Rd

SEPTIC TANK LEVEL 2000 gal existing ST. CLEANOUTS manhole at ST.
 DISTRIBUTION BOX LEVEL 6" (excavated with ST & house)

DRAIN FIELD/TITLE DEPTH 8 FT. TRENCH WIDTH 2 FT. INLET DEPTH 3 FT.
 EFFECTIVE GRAVEL DEPTH 5 FT. TOTAL LENGTH 100/100/100 FT.
 NUMBER OF TRENCHES 3 ONE SIDEWALL/BOTTOM AREA 1500 SQ. FT.
 DRYWALL INSIDE DIAMETER _____ FT. EFFECTIVE DEPTH BELOW INLET _____ FT.
 ABSORBENT AREA _____ SQ. FT.

REMARKS: System already covered - Drawing per installer Description RP. 4/17/95

DATE SYSTEM APPROVED RP 4/17/95 INSPECTOR Paul Kelly

From: Ron Pinkley 4/13/95
Memo: to the file

sad to Craig Williams

RE: Septic Repair for 6540 Haviland Mill Rd.

Mrs Pachocha called to clarify pricing, etc on

septic - after some discussion of what you had discussed

with Jenkins and what sizing Jenkins' Permit + Pricing was based

and discuss pro + cons. She affirmed her choice of putting

in enough septic system now to accommodate an eight Bedroom

Facility. I did a quick calculation based 125 sqft/Bed

= 1000 sqft total ÷ 5 ft stone depth = 200 LF of trench

as the minimum but told you would need to confirm this change.

also it assumed add a second septic to give 2000 gal capacity.

She was to call later today or Monday to let us know which choice

of 3 size of system she was finally going to select, so that

we all would be in agreement.

5 minutes later Jenkins called to tell me he'd

(over)

Measure the exist septic tank and discovered
it was 2000 gallon capacity already, so no need for
a second tank (keeping his cost estimate at \$2000).

He also said his discussion with Mrs Pachacha
was to go ahead and install the 300 linear ft
of trench as original permit indicates. He knows to
call you Monday to confirm size of system we all agree on.

Note: Physical exam of ends of septic tank are consistent with a
2000 gallon hand built septic tank with a poured-in place lid,
and square trench - inside inlet Baffle is corroded
but still functional iron 6" diam "T" Baffle with
an air vent pipe in Manhole riser. Open ends demonstrate
approx. 2000 gallon Septic Capacity, Contractor (Jenkins) repaired
connection pipe between S.T. and Dry well and installed three
one hundred foot long Trench connected by a distribution tank
to end of dry well (which is in series with the septic tank)

4/17/95 J. Pally

APPLICATION

PERCOLATION TESTING

A _____

P _____

HOWARD COUNTY HEALTH DEPARTMENT
BUREAU OF ENVIRONMENTAL HEALTH
3525-H ELLICOTT MILLS DRIVE/ELLICOTT CITY, MARYLAND 21043
TELEPHONE: 313-2640

DISTRICT _____

DATE _____

TO: THE COUNTY HEALTH OFFICER
ELLICOTT CITY, MARYLAND

I HEREBY APPLY FOR THE NECESSARY TEST PRIOR TO APPLICATION FOR PERMIT TO CONSTRUCT (OR RECONSTRUCT) A SEWAGE DISPOSAL SYSTEM.

PROPERTY OWNER _____

ADDRESS _____ PHONE _____

AGENT OR PROSPECTIVE BUYER Linda Pachoca — Home is used as a Nursing Home for

ADDRESS 36540 Haviland Mill Rd 15 residents (current 5 beds - Plan P Rdo)
PHONE _____

PROPERTY LOCATION:

SUBDIVISION _____ LOT NO. _____

ROAD AND DESCRIPTION _____

TAX MAP _____ PARCEL # _____

SIZE OF LOT _____ TYPE BLDG. _____
(SINGLE FAMILY DWELLING OR COMMERCIAL)

THE SYSTEM INSTALLED UNDER THIS APPLICATION IS ACCEPTABLE ONLY UNTIL PUBLIC FACILITIES BECOME AVAILABLE. I FULLY UNDERSTAND THE FEE CONNECTED WITH THE FILING OF THIS PERC TEST APPLICATION IS NON-REFUNDABLE UNDER ANY CIRCUMSTANCES. I ALSO AGREE TO COMPLY WITH ALL M.O.S.H.A. REQUIREMENTS IN TESTING THIS LOT.

(SIGNATURE OF APPLICANT)

APPROVED BY _____ FOR _____ DATE _____

DISAPPROVED BY _____ FOR _____ DATE _____

HOLD PENDING FURTHER TESTS _____

REASONS FOR REJECTION OR HOLDING _____

PERCOLATION TEST PLAT/PRELIMINARY PLAT - TITLE OR I.D. # _____ DATE _____

SITE DEVELOPMENT PLAN/FINAL PLAT - TITLE OR I.D. # _____ DATE _____

THIS IS NOT A PERMIT

Repair & Addn
COUNTY #

SOIL PROFILE

0'
2" top soil
1' all
18" bank Run hL
Red mica hl
5' Red mica L
-SL
10-20% co str mica
Sandy loam fragments
11'

old A
hor.

B

Same as
A

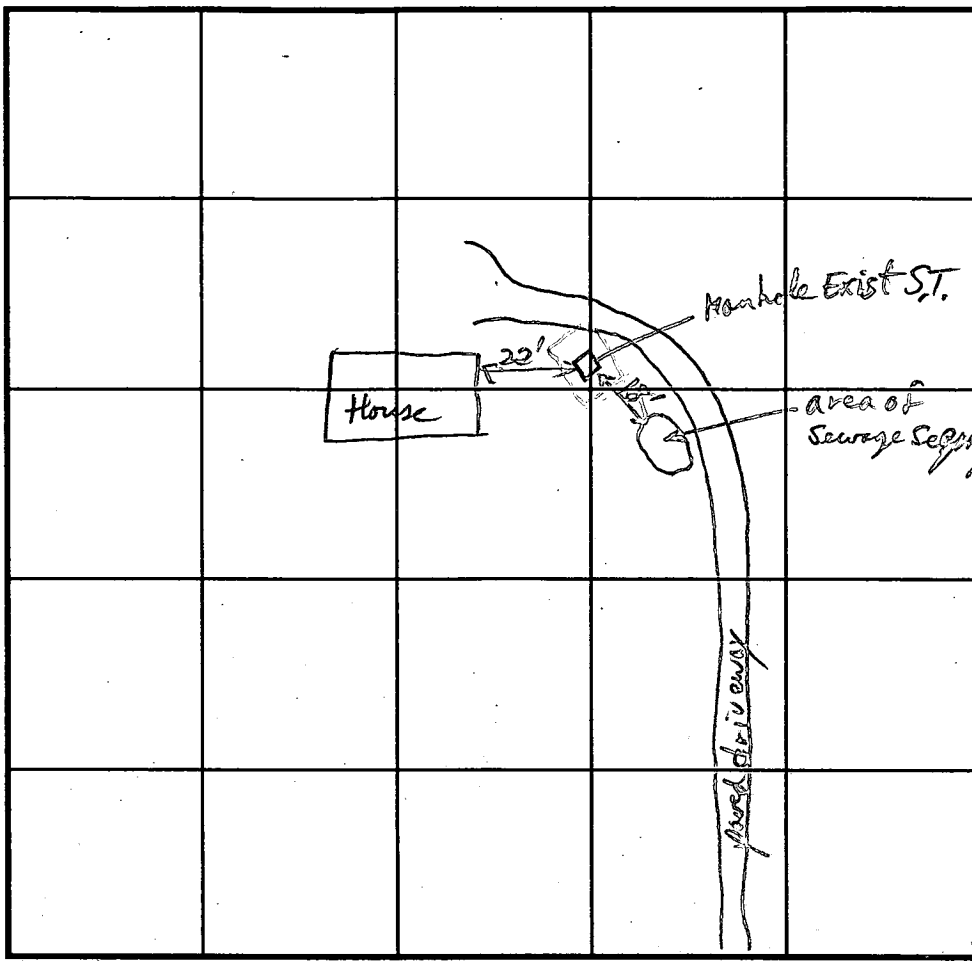

SOIL PROFILE

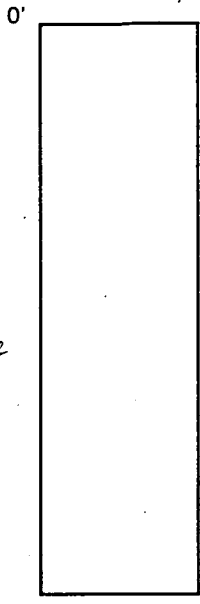

Mill Rd INDICATE NORTH - NAME ADJOINING ROADWAY AS BASE LINE.

DATE	TEST NO.	DEPTH	PRE-WET		TEST - 1" DROP		TIME	
			START	STOP	START	STOP		
4/13/95	A	4'	9:55:20	10:00	10:00	10:07:00	7 min	
		11'						
	B	48'	6'	10:12:00	10:13:40	10:13:40	10:16:40	3 min

REMARKS: Soils OK any depth. - House is a 5 bed - soon to be 8 bed Nursing Home with 15 residents (per Jenkins)

TYPE OF SOIL: Glenelg - Chester loam

TESTED BY: R. P. [Signature] ALSO PRESENT: Jenkins

TRENCH DESIGN DATA: AVERAGE PERCOLATION TIME: 4.5 min TRENCH WIDTH: 2'

INLET DEPTH: 2' MAXIMUM BOTTOM DEPTH: 7' SQ. FT./BEDROOM: 180

Mrs Pachosa
6540 Harland Hill Rd
Clarksville, Md 21029
301-596-9323

4-10-95
Needs to be repaired
See below

Home for the Elderly
now decreased for 8

461-9282

~~400~~-799-0315

She would like
to expand to 15

Also pls. check into
the water system

4-10-95

Attention: BRIAN Streaker (seen 3:30 P.M.)

The information above is
for a customer who runs home for the
elderly she plans to expand to 15
in the future. The existing system is
saturated (running out). CRAIG Williams
said that we could repair the system
for the present capacity out we should
consult you to see if we should
repair for 8 bedrooms. She presently
has 5 bedrooms. Please contact me at
501-233-1111 as a favor is being done.

Check on
4/17/95

4/13/95
← check up after meeting →

Gene H. Reed
410-233-1111

~~SEPTIC & WELL~~
SHELTERED HOME
REPLACEMENT WELL SITE INSPECTION

~~FOR SENIOR ASSISTED HOUSING~~

OWNER LINDA PACHOCHA

DATE REQUESTED 8/89

ADDRESS 6540 HAVILAND MILL ROAD

DRILLER _____

WELL TAG# _____

COUNTY# _____

LOCATION DIAGRAM

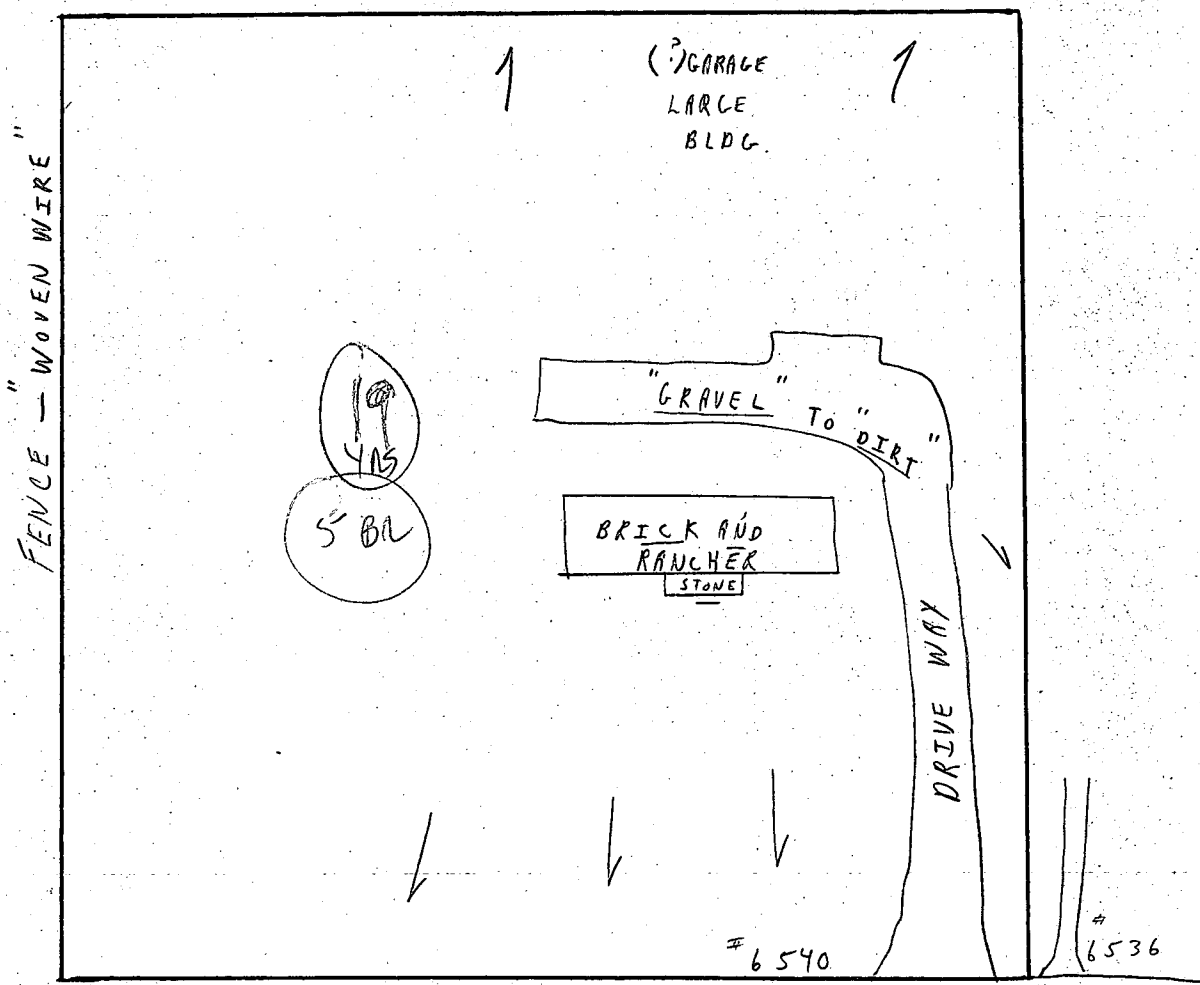

COMMENTS: 8/11/89 HOME - VACANT ; REAL ESTATE SIGN - SOLD
AT FRONT ; UNABLE TO FIND A SEPTIC SYSTEM OR WATER WELL
C.B.D.

(OWNER REPORTS WELL 10' FROM BACK DOOR, SEPTIC TANK TO LEFT OF THAT) CW1

6540 HAVILAND MILL

June 1, 1989

Craig Williams, Director,
Water & Sewer Program,
Bureau of Environmental Health
3525 Ellicott Mills Dr. Suite H.
Ellicott City, Md. 21043

Dear Mr. Williams,

I am applying to the Maryland Office on Aging under Section 11, Chapter 14.11.07, Article 70B of the Annotated Code of Maryland for a certificate to operate a Senior Assisted Housing Group Home. That facility will be located at 6540 Haviland Mill Road, Clarksville. This property is currently owned by Katherine Hern.

The tax account number is shown as 342570. The property had a new well drilled within the past three years. The property contains 5 bedrooms and the intended occupancy at this time will be five people.

I need a letter of opinion from your office stating that the water and sewer facilities at the above property are sufficient for the number of people stated above.

Please send reply to Linda Pachoca, 7637 Ridge Road, Hanover, Md 21076.

Sincerely

Linda Pachoca

Linda Pachoca

NOT A RECENT WELL
PER PREVIOUS OWNER - KATHY HERN

Seen 8/1/89
C.B.E.

HOWARD COUNTY HEALTH DEPARTMENT

JOYCE M. BOYD, M.D., M.R.H.
COUNTY HEALTH OFFICER



Bureau of Environmental Health
3525 Ellicott Mills Drive
Ellicott City, Maryland 21043

Director - 461-9956
Water & Sewerage, Permits - 461-9933
Community Environmental Health - 461-9944
Technical Services - 461-9955

August 11, 1989

Ms. Linda Pachocha
7637 Ridge Road
Hanover, Maryland 21076

RE: Senior Assisted Group Home
6540 Haviland Mill Road
Clarksville, Maryland

Dear Ms. Pachoca:

This is to advise that this office has no objection to conversion of the above referenced property to a senior assisted group home.

A site inspection conducted August 1, 1989 revealed no visual indication of a current problem with the well or septic system. This review does not constitute a prediction of future operation.

It is recommended that a satisfactory water sample result be obtained prior to final occupancy approval. Should an addition to the current structure be proposed, more formal evaluation of septic capacity would be required.

If you have any questions relative to this matter, please call me at 461-9933.

Very truly yours,

Craig Williams, Director
Water and Sewerage Program

CW:JR

cc: Diane Perry, In-Home Services Coordinator
Department of Citizen Services
Office On Aging

File

Craig Williams, Director
Bureau of Environmental Health
3525 Ellicott Mills Drive, Suite H
Ellicott City, Md 21043

April 3, 1996

Dear Mr. Williams,

I am applying to the Maryland Office on Aging to become a Senior Assisted living Facility (Group Sheltered Housing) under Section 11, Chapter 14.11.07, Article 70 B of the Annotated Code of Maryland. This facility will be located at 6542 Harland Mill Road, Clarksville, Md 21029. This property was previously owned by James W. and Lavon Baumgardner. The house contains 4 bedrooms and the intended occupancy at this time will be 5. I need a letter of opinion from your office stating that the water and/or sewer facilities at the above property are sufficient for the number of people stated above. If and when approved, this will become my third group home for the elderly, and will be called Hillcrest House. The first 2 are Hilltop House (next to this one) at 6540 Harland Mill Road, and the other, Hillside House, at 5502 Harris Farm Road, also in Clarksville.

Thank you very much for your cooperation regarding this matter. If you have further questions regarding this request, I can be reached at (301) 596-9323 (Hilltop House) until I get the telephone installed at 6542 Harland Mill Rd.

Sincerely yours,

Linda Pachoca

6542 Harland Mill Rd.

Clarksville, Md 21029



MDE

MARYLAND DEPARTMENT OF THE ENVIRONMENT

2500 Broening Highway • Baltimore Maryland 21224
(410) 631-3000 • 1-800-633-6101 • <http://www.mde.state.md.us>

Parris N. Glendening
Governor

Jane T. Nishida
Secretary

December 4, 1997

LINDA PACHOCA
2938 JESSUP ROAD
JESSUP, MD 20794

RE: State Water Appropriation
Permit No. HO97G022(01)
First Permit

Dear Permittee:

Enclosed is your State Water Appropriation Permit. The permittee is responsible for complying with all permit conditions. Accordingly, you are advised to carefully read the Permit and become thoroughly familiar with its requirements. PLEASE NOTE THAT IF THE WATER IS NOT PUT TO USE WITHIN TWO (2) YEARS, THE PERMIT WILL EXPIRE.

If you have any questions, please contact this office at (410)631-3591.

Sincerely,

MARK T. FILAR
Water Rights Division

cc: HOWARD COUNTY HEALTH DEPARTMENT

NOV 11 1997
11 11 AM '97
MDE