

10/12/94
ASAP

PERMIT

SEWAGE DISPOSAL SYSTEM

DEPARTMENT OF HEALTH AND MENTAL HYGIENE

P 50345

A REPAIR

DISTRICT _____

DATE 10/07/94

HOWARD COUNTY HEALTH DEPARTMENT

BUREAU OF ENVIRONMENTAL HEALTH

~~461-9933~~ 313-2640

DATE SYSTEM APPROVED 10-12-94

INDEXED

INSPECTOR Am

Jenkins Brothers IS PERMITTED TO INSTALL _____ ALTER X

ADDRESS 7670 Smith's Private Road Sykesville, Maryland 21784 PHONE 465-6646

SUBDIVISION Shipley Farm LOT _____ ROAD 12195 Route 99

PROPERTY OWNER Mr. Russell Shipley

ADDRESS 12195 Route 99
Marriottsville, Maryland 21104

SEPTIC TANK CAPACITY _____ GALLONS

NUMBER OF BEDROOMS 3

125 SQUARE FEET PER BEDROOM

LINEAR FEET OF TRENCH REQUIRED 63

125
3
375
62
61375
86
15

REPAIR - PURPOSE - DRAINFIELDS HAVE FAILED.

Call for inspection when ground is opened so sanitarian can recommend repair. 10/11/94

10-12-94 Dig trench 63' long w/ 12' of stone max bottom depth
of 11'. Run trench along existing driveway toward
RT 99.

PLANS APPROVED BY _____ DATE _____

COVER NO WORK UNTIL INSPECTED AND APPROVED

NEITHER THE HOWARD COUNTY COUNCIL NOR THE HEALTH DEPARTMENT IS RESPONSIBLE FOR THE SUCCESSFUL OPERATION OF ANY SYSTEM

NOTE: CLEANOUT REQUIRED EVERY 70 FEET OF SEWER LINE AND/OR AT 90° SWEEPS IN LINES FROM HOUSE TO DRAIN FIELDS, 90° ELBOWS NOT ACCEPTABLE.

NOTE: ALL PARTS OF SEPTIC SYSTEMS (I.E. TANK, DISTRIBUTION BOX TRENCHES) TO BE 100 FEET FROM WELL (UNLESS OTHERWISE SPECIFICALLY AUTHORIZED)

NOTE: IF DEEP TRENCH(ES) ARE USED CALL FOR INSPECTION BEFORE AND AFTER PLACING GRAVEL IN TRENCH(ES)

NOTE: NO DRY WELL SHALL EXCEED 15 FOOT IN DIAMETER NO ABSORPTION TRENCH TO EXCEED 100 FEET IN LENGTH

NOTE: ALL PIPE FROM HOUSE TO SEPTIC TANK MUST BE CAST IRON OR SCHEDULE 35/40 PVC OR ABS

PERMIT VOID AFTER TWO YEARS

NOTE: INSTALL STAND PIPE ON SEPTIC TANK AND DRY WELL STAND PIPES MUST BE 6 INCHES IN DIAMETER CAST IRON. CONCRETE OR TERRA COTTA OR PVA OR ABS ACCEPTED. IF TOP OF SEPTIC TANK IS DEEPER THAN 3 FEET. MANHOLE TO GRADE REQUIRED.

NOTE: DISTRIBUTION BOXES MUST HAVE BAFFLES

***INSTALLER IS RESPONSIBLE FOR OBTAINING FINAL APPROVAL ON THIS PERMIT**

P
50345

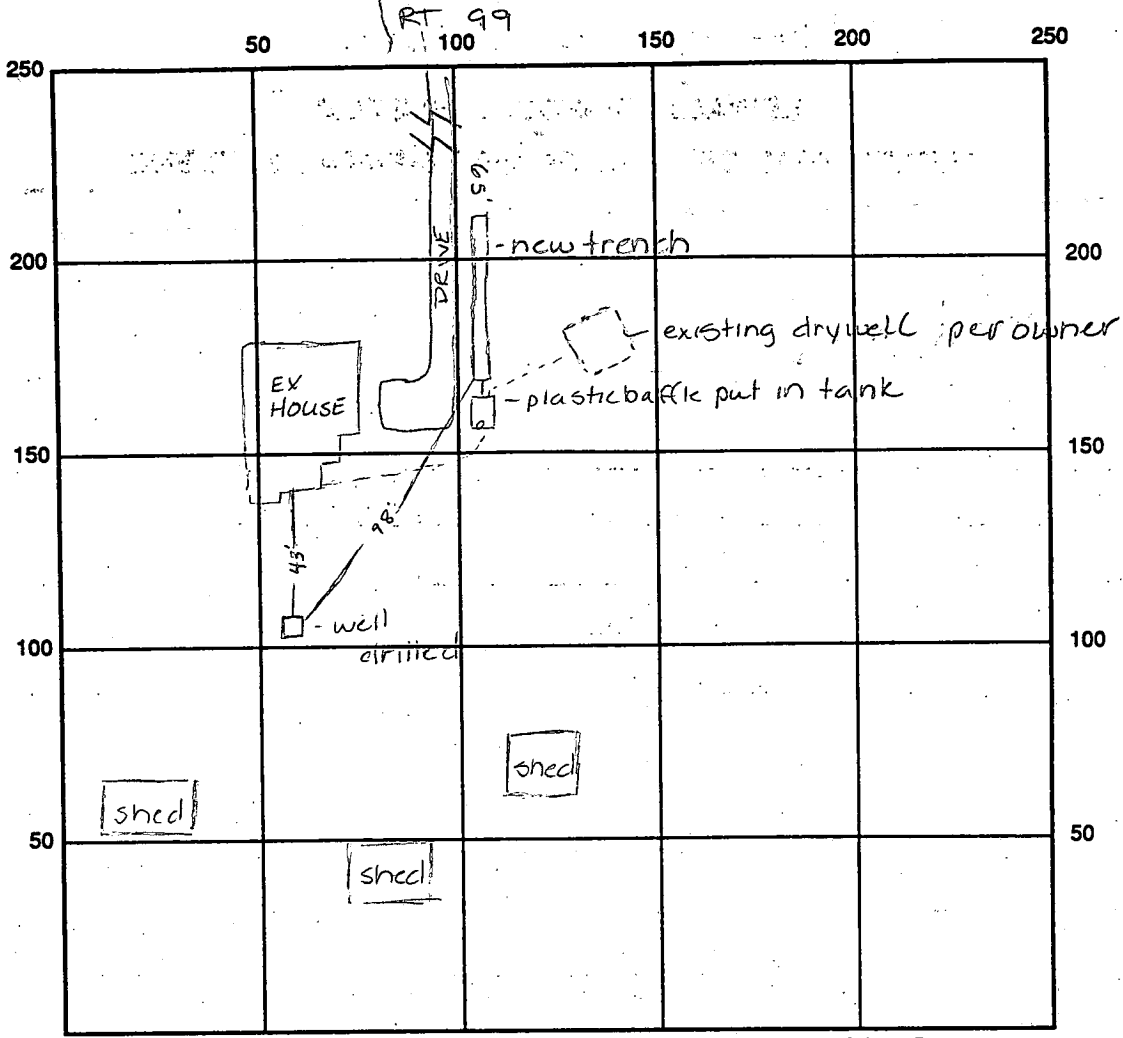

INDICATE NORTH - NAME ADJOINING ROADWAY AS BASE LINE

SEPTIC TANK LEVEL N/A CLEANOUTS existing

DISTRIBUTION BOX LEVEL N/A

DRAIN FIELD/TITLE DEPTH 11' FT. TRENCH WIDTH 2 1/2' FT. INLET DEPTH beginning - 3'
end - 5' FT.

EFFECTIVE GRAVEL DEPTH AV 66 FT. TOTAL LENGTH 65' FT.

NUMBER OF TRENCHES _____ ONE SIDEWALL/BOTTOM AREA _____ SQ. FT.

DRYWALL INSIDE DIAMETER _____ FT. EFFECTIVE DEPTH BELOW INLET _____ FT.

ABSORBENT AREA _____ SQ. FT.

REMARKS: 10-12-94 OK to cover all work final - materials on site
10' of trench left to fill w/ stone Auw

DATE SYSTEM APPROVED 10-12-94 INSPECTOR Amy M. McOan