

9-16-94
C-O am

PERMIT

SEWAGE DISPOSAL SYSTEM

DEPARTMENT OF HEALTH AND MENTAL HYGIENE

P 50291A

A REPAIR

DISTRICT _____

DATE 9/23/94

DATE SYSTEM APPROVED 9/16/94

INSPECTOR C. B. S.

02-201747

HOWARD COUNTY HEALTH DEPARTMENT

BUREAU OF ENVIRONMENTAL HEALTH
~~X161988X~~ 313-2640

INDEXED

Jenkins Brothers IS PERMITTED TO INSTALL _____ ALTER X

ADDRESS 7670 Smith's Private Road, Sykesville, Maryland PHONE 461-9282

SUBDIVISION _____ LOT _____ ROAD 10496 Balto. National Pike

PROPERTY OWNER Mrs. Collins
10496 Baltimore National Pike

ADDRESS _____

SEPTIC TANK CAPACITY 1000 GALLONS

NUMBER OF BEDROOMS 3

_____ SQUARE FEET PER BEDROOM

LINEAR FEET OF TRENCH REQUIRED _____

REPAIR - PURPOSE - DRYWELL FULL.

Call for inspection when ground is opened so sanitarian can recommend repair. 09/14/94

"See track"

PLANS APPROVED BY CBS for C.W. DATE 9/16/94

COVER NO WORK UNTIL INSPECTED AND APPROVED

NEITHER THE HOWARD COUNTY COUNCIL NOR THE HEALTH DEPARTMENT IS RESPONSIBLE FOR THE SUCCESSFUL OPERATION OF ANY SYSTEM

NOTE: CLEANOUT REQUIRED EVERY 70 FEET OF SEWER LINE AND/OR AT 90° SWEEPS IN LINES FROM HOUSE TO DRAIN FIELDS, 90° ELBOWS NOT ACCEPTABLE.

NOTE: ALL PARTS OF SEPTIC SYSTEMS (I.E. TANK, DISTRIBUTION BOX TRENCHES) TO BE 100 FEET FROM WELL (UNLESS OTHERWISE SPECIFICALLY AUTHORIZED)

NOTE: IF DEEP TRENCH(ES) ARE USED CALL FOR INSPECTION BEFORE AND AFTER PLACING GRAVEL IN TRENCH(ES)

NOTE: NO DRY WELL SHALL EXCEED 15 FOOT IN DIAMETER NO ABSORPTION TRENCH TO EXCEED 100 FEET IN LENGTH

NOTE: ALL PIPE FROM HOUSE TO SEPTIC TANK MUST BE CAST IRON OR SCHEDULE 35/40 PVC OR ABS

PERMIT VOID AFTER TWO YEARS

NOTE: INSTALL STAND PIPE ON SEPTIC TANK AND DRY WELL STAND PIPES MUST BE 6 INCHES IN DIAMETER CAST IRON. CONCRETE OR TERRA COTTA OR PVA OR ABS ACCEPTED. IF TOP OF SEPTIC TANK IS DEEPER THAN 3 FEET. MANHOLE TO GRADE REQUIRED.

NOTE: DISTRIBUTION BOXES MUST HAVE BAFFLES

***INSTALLER IS RESPONSIBLE FOR OBTAINING FINAL APPROVAL ON THIS PERMIT**

P
50291A

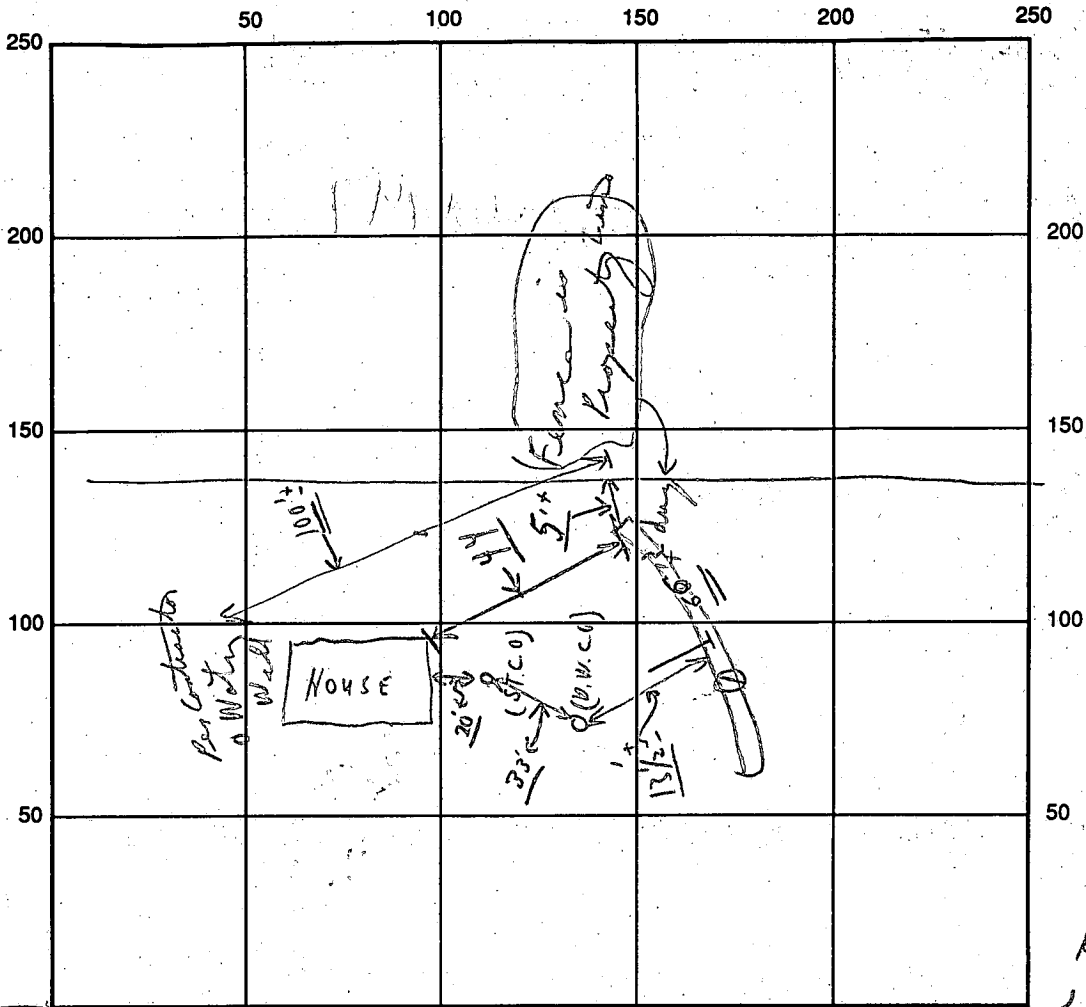

INDICATE NORTH - NAME ADJOINING ROADWAY AS BASE LINE

SEPTIC TANK LEVEL NEW 1000 GAL ~~EXIST~~ Cemetery Lane
CLEANOUTS MANHOLE ON S.T.; EX

DISTRIBUTION BOX LEVEL (coming off septic dry well)

DRAIN FIELD/TILE DEPTH 9 1/2 FT. TRENCH WIDTH 2 1/2 FT. INLET DEPTH 3 1/2 FT.

EFFECTIVE GRAVEL DEPTH 6 FT. TOTAL LENGTH 66 FT.

NUMBER OF TRENCHES 1 ONE SIDEWALL/BOTTOM AREA 396 SQ. FT.

DRYWALL INSIDE DIAMETER ~ FT. EFFECTIVE DEPTH BELOW INLET ~ FT.

ABSORBENT AREA 396 SQ. FT.

REMARKS: Partial P.M. 9/16 ok to continue on trench; ok to leave end
& area where pipe comes off dry well. chp
9/16 later - Final ok to cover as finish; material
on site to complete job; chp

10/17/94 EX. METAL TANK COLLAPSED; NEW 1000-GAL S.T.
INSTALLED (JENKINS) IN SAME LOCATION w/MANHOLE - NO INSP OPP. - OK COVER

DATE SYSTEM APPROVED 9/16/94 INSPECTOR Charles B. Stueck