

9/2/94 ASAP  
Early  
+  
H.C.P.M.

# PERMIT

## SEWAGE DISPOSAL SYSTEM

### DEPARTMENT OF HEALTH AND MENTAL HYGIENE

(Early A.M.C.O.)  
9/19 P.C.O. → C.B.D.  
P 50262D  
A REPAIR

HOWARD COUNTY HEALTH DEPARTMENT

BUREAU OF ENVIRONMENTAL HEALTH

~~XXXX-XXXX~~ 313-2640

top 12 de 436595

INDEXED

DISTRICT \_\_\_\_\_

DATE 9/8/94

DATE SYSTEM APPROVED 9/19/94

INSPECTOR C.B.D.

FYOCK (INSTALL D.W. 9/19/94 CW)

Jenkins Brothers

IS PERMITTED TO INSTALL \_\_\_\_\_ ALTER X

ADDRESS 7670 Smith's Private Road, Sykesville, Maryland 21784 PHONE 461-9282

SUBDIVISION \_\_\_\_\_ LOT \_\_\_\_\_ ROAD 10656 Shaker Drive

PROPERTY OWNER Marie Ramos  
ADDRESS 10656 Shaker Drive  
Columbia, Maryland

SEPTIC TANK CAPACITY 1000 GALLONS ✓

(House is located near Allview Estates - Public Water is Available; but, not Public Sewer per Jean Reed - 08/30/94) ✓

NUMBER OF BEDROOMS 3 ✓

375 SQUARE FEET PER BEDROOM

LINEAR FEET OF TRENCH REQUIRED (12' X 13')  
DRY WELL .50'

REPAIR - PURPOSE - SEPTIC SYSTEM HAS FAILED. 9/2/94 TO KEEP GRAVITY FLOW'S

Call for inspection when ground is opened so sanitarian can recommend repair. 08/30/94

Repair to new dry well - due to slope + limited repair area

Inlet 2' below original grade and maximum

depth 10'; (8' effective depth times (12' X 13') 400'

ft. effective; 20'± from septic tank + 25' from

prod. ctd. E see back T' (HOLD-ON-D.WELL-RINGS) 5

PLANS APPROVED BY C.B.D. for C.W. in field pits DATE 9/2/94

COVER NO WORK UNTIL INSPECTED AND APPROVED

NEITHER THE HOWARD COUNTY COUNCIL NOR THE HEALTH DEPARTMENT IS RESPONSIBLE FOR THE SUCCESSFUL OPERATION OF ANY SYSTEM

NOTE: CLEANOUT REQUIRED EVERY 70 FEET OF SEWER LINE AND/OR AT 90° SWEEPS IN LINES FROM HOUSE TO DRAIN FIELDS, 90° ELBOWS NOT ACCEPTABLE.

NOTE: ALL PARTS OF SEPTIC SYSTEMS (I.E. TANK, DISTRIBUTION BOX TRENCHES) TO BE 100 FEET FROM WELL (UNLESS OTHERWISE SPECIFICALLY AUTHORIZED)

NOTE: IF DEEP TRENCH(ES) ARE USED CALL FOR INSPECTION BEFORE AND AFTER PLACING GRAVEL IN TRENCH(ES)

NOTE: NO DRY WELL SHALL EXCEED 15 FOOT IN DIAMETER NO ABSORPTION TRENCH TO EXCEED 100 FEET IN LENGTH

NOTE: ALL PIPE FROM HOUSE TO SEPTIC TANK MUST BE CAST IRON OR SCHEDULE 35/40 PVC OR ABS

PERMIT VOID AFTER TWO YEARS

NOTE: INSTALL STAND PIPE ON SEPTIC TANK AND DRY WELL STAND PIPES MUST BE 6 INCHES IN DIAMETER CAST IRON. CONCRETE OR TERRA COTTA OR PVA OR ABS ACCEPTED. IF TOP OF SEPTIC TANK IS DEEPER THAN 3 FEET. MANHOLE TO GRADE REQUIRED.

NOTE: DISTRIBUTION BOXES MUST HAVE BAFFLES

\*INSTALLER IS RESPONSIBLE FOR OBTAINING FINAL APPROVAL ON THIS PERMIT

P50262D

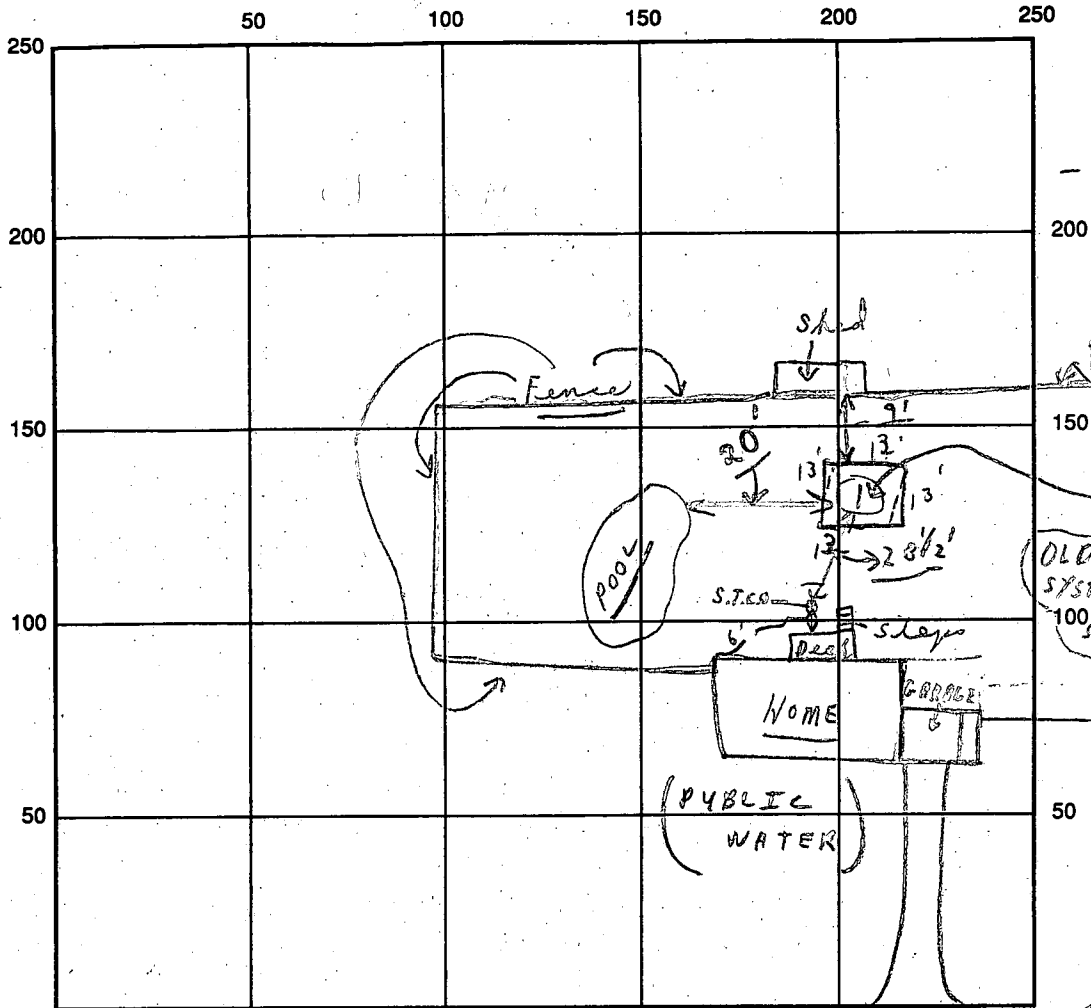

INDICATE NORTH - NAME ADJOINING ROADWAY AS BASE LINE

SEPTIC TANK LEVEL Existing CLEANOUTS Existing (To RY, 29) D.W. (To be)

DISTRIBUTION BOX LEVEL (To be decided)

DRAIN FIELD/TITLE DEPTH 11 FT. TRENCH WIDTH      FT. { INLET DEPTH 2 FT. }  
 { DRY WELL

EFFECTIVE GRAVEL DEPTH      FT. TOTAL LENGTH      FT.

NUMBER OF TRENCHES      ONE SIDEWALL/BOTTOM AREA      SQ. FT.

DRYWALL INSIDE DIAMETER 4 (13 x 13) 52 FT. { EFFECTIVE DEPTH BELOW INLET 8 FT. }

ABSORBENT AREA 416 SQ. FT. 2' x 10'

REMARKS: Repairs on 9/2/94 - (1) Dry Well - limited repairs area in  
seas used + allow. HOLD FOR A CALL END 9/19/94 Partial  
no top yet for Dry Well; ch. Finish - later 9/19/94 (1:00's)  
Dry Well top on colored; material on site to  
finish ch.

DATE SYSTEM APPROVED 9/19/94 INSPECTOR Charles Bryan Street