

4/20/94 DATE AM

PERMIT

SEWAGE DISPOSAL SYSTEM

DEPARTMENT OF HEALTH AND MENTAL HYGIENE

P 50049K

A REPAIR

DISTRICT _____

DATE 5/27/94

HOWARD COUNTY HEALTH DEPARTMENT
BUREAU OF ENVIRONMENTAL HEALTH
~~XXXXXXXX~~ 313-2640

~~03-282553~~
03-282554

DATE SYSTEM APPROVED 4/20/94

INDEXED

INSPECTOR [Signature]

Jack Fyock Septic Services IS PERMITTED TO INSTALL _____ ALTER X

ADDRESS _____ PHONE 988-9270

SUBDIVISION Green Henge LOT 9 ROAD 2914 Evergreen Way

PROPERTY OWNER Holland
2914 Evergreen Way

ADDRESS _____

SEPTIC TANK CAPACITY 1250 GALLONS

NUMBER OF BEDROOMS 4

125 SQUARE FEET PER BEDROOM

LINEAR FEET OF TRENCH REQUIRED 70

REPAIR - PURPOSE - Septic System Has Failed (Drywell)

Call for inspection when ground is opened so sanitarian can recommend repair - 04/18/94

Install 70 ft of trench, 2' wide, 11' deep, in lot @ 3', 8 ft stone fill.

PLANS APPROVED BY _____ DATE _____

COVER NO WORK UNTIL INSPECTED AND APPROVED

NEITHER THE HOWARD COUNTY COUNCIL NOR THE HEALTH DEPARTMENT IS RESPONSIBLE FOR THE SUCCESSFUL OPERATION OF ANY SYSTEM

NOTE: CLEANOUT REQUIRED EVERY 70 FEET OF SEWER LINE AND/OR AT 90° SWEEPS IN LINES FROM HOUSE TO DRAIN FIELDS, 90° ELBOWS NOT ACCEPTABLE.

NOTE: ALL PARTS OF SEPTIC SYSTEMS (I.E. TANK, DISTRIBUTION BOX TRENCHES) TO BE 100 FEET FROM WELL (UNLESS OTHERWISE SPECIFICALLY AUTHORIZED)

NOTE: IF DEEP TRENCH(ES) ARE USED CALL FOR INSPECTION BEFORE AND AFTER PLACING GRAVEL IN TRENCH(ES)

NOTE: NO DRY WELL SHALL EXCEED 15 FOOT IN DIAMETER NO ABSORPTION TRENCH TO EXCEED 100 FEET IN LENGTH

NOTE: ALL PIPE FROM HOUSE TO SEPTIC TANK MUST BE CAST IRON OR SCHEDULE 35/40 PVC OR ABS

PERMIT VOID AFTER TWO YEARS

NOTE: INSTALL STAND PIPE ON SEPTIC TANK AND DRY WELL STAND PIPES MUST BE 6 INCHES IN DIAMETER CAST IRON. CONCRETE OR TERRA COTTA OR PVA OR ABS ACCEPTED. IF TOP OF SEPTIC TANK IS DEEPER THAN 3 FEET. MANHOLE TO GRADE REQUIRED.

NOTE: DISTRIBUTION BOXES MUST HAVE BAFFLES

***INSTALLER IS RESPONSIBLE FOR OBTAINING FINAL APPROVAL ON THIS PERMIT**

P 50049K

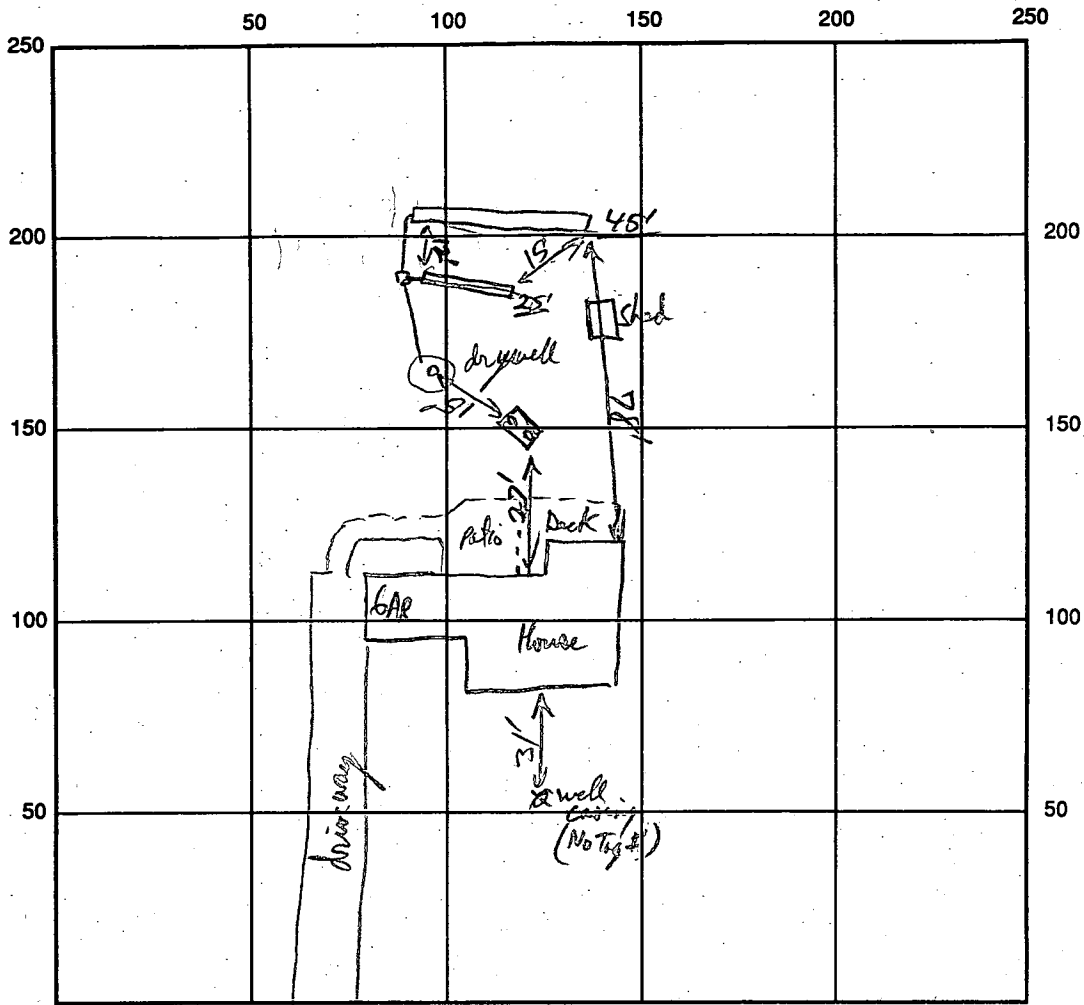

INDICATE NORTH - NAME ADJOINING ROADWAY AS BASE LINE

SEPTIC TANK LEVEL existing 100 gal CLEANOUTS New cleanout S.T. & D.W.

DISTRIBUTION BOX LEVEL ✓

DRAIN FIELD/TITLE DEPTH 11' FT. TRENCH WIDTH 2 FT. INLET DEPTH 3 FT.

EFFECTIVE GRAVEL DEPTH 8 FT. TOTAL LENGTH (1-25', 2-45') 70 FT.

NUMBER OF TRENCHES 1 ONE SIDEWALL/BOTTOM AREA 1560 SQ. FT.

DRYWALL INSIDE DIAMETER _____ FT. EFFECTIVE DEPTH BELOW INLET _____ FT.

ABSORBENT AREA _____ SQ. FT.

REMARKS: OK to finish the cover system 4/20/94 RJP

DATE SYSTEM APPROVED 4/20/94 INSPECTOR [Signature]