

C1 4535

SEQUENCE NO. (DENV USE ONLY)

STATE OF MARYLAND WELL COMPLETION REPORT

THIS REPORT MUST BE SUBMITTED WITHIN 45 DAYS AFTER WELL IS COMPLETED.

COUNTY NUMBER A 49764A

(THIS NUMBER IS TO BE PUNCHED IN C.O.S. 3-6 ON ALL CARDS)

ST/CO USE ONLY DATE Received

DATE WELL COMPLETED 902994

Depth of Well 365 (TO NEAREST FOOT)

PERMIT NO. FROM "PERMIT TO DRILL WELL" 70-94-0188

OWNER Carmen Associates last name Cortina Dr first name TOWN Highland SUBDIVISION Deer Track SECTION LOT 76

WELL LOG table with columns: DESCRIPTION (Use additional sheets if needed), FEET (FROM, TO), Check if water bearing. Includes handwritten entries: SAND, GRAY Mica Rock, 2 dry wells 400', 400' filled in with cement + drilling materials.

GROUTING RECORD: WELL HAS BEEN GROUTED (Y), TYPE OF GROUTING MATERIAL CEMENT BENTONITE CLAY, NO. OF BAGS 21, NO. OF POUNDS 1924, GALLONS OF WATER 126, DEPTH OF GROUT SEAL 65 ft.

CASING RECORD: casing types ST CO PL OT, MAIN CASING TYPE ST, Nominal diameter 6, Total depth 87.

OTHER CASING (if used) table with columns: diameter inch, depth from to.

SCREEN RECORD: screen type or open hole ST BR HO PL OT, DEPTH (nearest ft.) 80 85 365.

IN HARD ROCK AREAS, IDENTIFY SPECIFICALLY WHERE SATURATED FRACTURES WERE OBSERVED. WELL HYDROFRACTURED (Y).

CIRCLE APPROPRIATE LETTER: A WELL WAS ABANDONED AND SEALED WHEN THIS WELL WAS COMPLETED.

I HEREBY CERTIFY THAT THIS WELL HAS BEEN CONSTRUCTED IN ACCORDANCE WITH COMAR 26.04.04 "WELL CONSTRUCTION" AND IN CONFORMANCE WITH ALL CONDITIONS STATED IN THE ABOVE CAPTIONED PERMIT...

DRILLERS IDENT. NO. 24, DRILLERS SIGNATURE Joseph Mayron

SITE SUPERVISOR (sign. of driller or journeyman responsible for sitework if different from permittee)

GRAVEL PACK IF WELL DRILLED WAS FLOWING WELL INSERT F IN BOX 68. MDE USE ONLY (NOT TO BE FILLED IN BY DRILLER).

TELESCOPE CASING LOG INDICATOR OTHER DATA

PUMPING TEST: HOURS PUMPED 6, PUMPING RATE 1, METHOD USED TO MEASURE PUMPING RATE Bucket, WATER LEVEL 38, WHEN PUMPING 330, TYPE OF PUMP USED S submersible.

PUMP INSTALLED: DRILLER WILL INSTALL PUMP YES (NO), TYPE OF PUMP INSTALLED, CAPACITY: GALLONS PER MINUTE, PUMP HORSE POWER, PUMP COLUMN LENGTH, CASING HEIGHT.

LOCATION OF WELL ON LOT: SHOW PERMANENT STRUCTURE SUCH AS BUILDING, SEPTIC TANKS, AND/OR LANDMARKS AND INDICATE NOT LESS THAN TWO DISTANCES (MEASUREMENTS TO WELL). See attached Well location map.

B 1 06881 SEQUENCE NO. (DP USE ONLY)
1 2 3 4 5 6
(THIS NUMBER IS TO BE PUNCHED IN COLS. 3-6 ON ALL CARDS)

STATE OF MARYLAND
PERMIT TO DRILL WELL
please print or type

STATE PERMIT NUMBER
70 71 72 73 74 75 76 77 78 79
HD-94-0188
70 fill in this form completely 79

Date Received (APA) 08/01/94
OWNER INFORMATION
8 13
KARMAW ASSOCIATES
15 Last Name Owner First Name 34
BORTZ
36 Street or RFD 55
ELLICOTT CITY MD 21047
57 Town 70 State 72 Zip 76

B 3 LOCATION OF WELL
1 2
HOWARD
8 COUNTY 21
DEER FACK
23 SUBDIVISION 42
SECTION 44 46 LOT 16 48 50
HIGHLAND
52 NEAREST TOWN 71
MILES FROM TOWN (enter 0 if in town) 2 73 76 77 78 MI 78

DRILLER INFORMATION
Joseph L. Mayne 24
Driller's Name 77 License No. 80
Joseph L. Mayne Well Drilling
Firm Name
5512 Ridge RD, Mt. Airy 21771
Address
Joseph L. Mayne 8/1/94
Signature Date

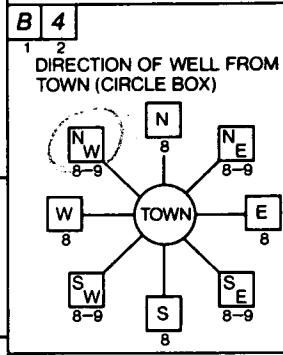

CORTINA Drive
11 NEAR WHAT ROAD 30
ON WHICH SIDE OF ROAD (CIRCLE APPROPRIATE BOX)
NORTH
WEST EAST
SOUTH
34 250 37
DISTANCE FROM ROAD
ENTER FT or MI FT 38 39

B 2 WELL INFORMATION
APPROX. PUMPING RATE (GAL. PER MIN.) 5
AVERAGE DAILY QUANTITY NEEDED (GAL. PER DAY) 500
14 20

USE FOR WATER (CIRCLE APPROPRIATE BOX)
D HOME (SINGLE OR DOUBLE HOUSEHOLD UNIT ONLY)
F FARMING (LIVESTOCK WATERING & AGRICULTURAL IRRIGATION)
I INDUSTRIAL, COMMERCIAL, STATE AND FEDERAL GOV. OTHER (REQUIRES APPROPRIATION PERMIT)
P PUBLIC OR PRIVATE WATER COMPANY (REQUIRES APPROPRIATION PERMIT AND STATE HEALTH DEPARTMENT APPROVAL)
T TEST, OBSERVATION, MONITORING (MAY REQUIRE APPROPRIATION PERMIT)

NOT TO BE FILLED IN BY DRILLER HEALTH DEPARTMENT APPROVAL
Howard A49764
COUNTY NAME COUNTY NO.
STATE SIGNATURE INSERT S
DATE ISSUED 08/26/94 EXP. DATE 8/26/95
43 48 CO SIGNATURE 41
NORTH GRID 49V 000 EAST GRID 0504 000
50 55 57 63

APPROXIMATE DEPTH OF WELL 265 FEET
24 28

APPROXIMATE DIAMETER OF WELL 6 NEAREST INCH

METHOD OF DRILLING (circle one)
BORED (or Augered) JETTED Jetted & DRIVEN
AIR-ROTARY AIR-Percussion ROTARY (Hydraulic Rotary)
CABLE REVERSE-ROTARY Drive-POINT
other

SHOW MAJOR FEATURES OF BOX & LOCATE WELL WITH AN X
SOURCES OF DRILLING WATER
1. well
2.
3.
WRITE THE BOX NUMBER FROM THE MAP HERE
E 8004
N 4908
000 000 x

9-29-94
4:30 GROUT
no insp made
AMM

REPLACEMENT OR DEEPEMED WELLS (CIRCLE APPROPRIATE BOX)
N THIS WELL WILL NOT REPLACE AN EXISTING WELL
Y THIS WELL WILL REPLACE A WELL THAT WILL BE ABANDONED AND SEALED
S THIS WELL WILL REPLACE A WELL THAT WILL BE USED AS A STANDBY
D THIS WELL WILL DEEPEM AN EXISTING WELL
PERMIT NUMBER OF WELL TO BE REPLACED OR DEEPEMED (IF AVAILABLE) 41 52

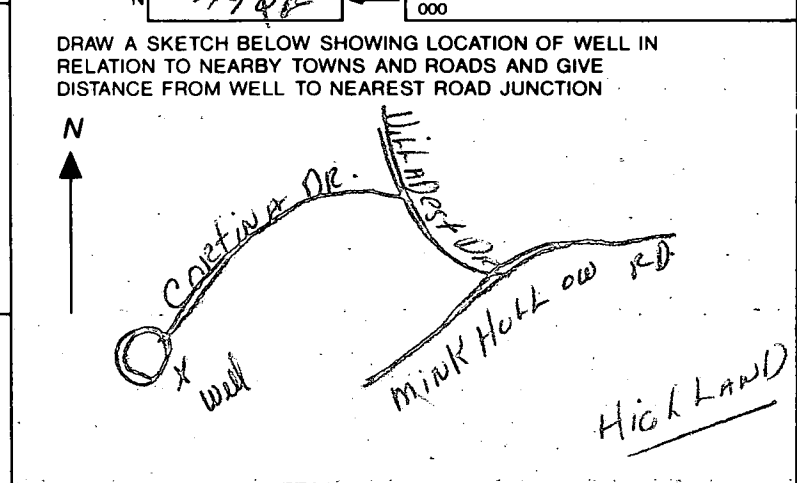

Not to be filled in by driller (OEP USE ONLY)
APPROX. PERMIT NUMBER 54 GAP 63
FORCE RP WRITE INITIALS IN BOX PERMIT No. HD-94-0188
67 68 70 71 72 73 74 75 76 77 78 79

SPECIAL CONDITIONS

FIELD DATA SHEET
HOWARD COUNTY WELL YIELD TEST

Well Permit No. HO - 94-0188
 Location of property (road) Cortina Dr
 Subdivision Deer Track Lot 16 Block Plat Sec.
 Well Driller J. Mayhe Owner Carmen Assoc.

Depth of well 365'
 Distance of measuring point (M.P.) above ground 2'
 Static water level (S.W.L.) below M.P. 38'

I. High rate pumping -- reservoir drawdown

Time pump started 8:00 Pumping rate 20 gpm.
 Total time 40 min. to reach pumping water level 330 ft. below M.P.

II. Recovery pump test data - observations to be recorded every 15 minutes

TIME (in 15 minute intervals)	WATER LEVEL below M.P.	PUMPING RATE time to fill 5/1 gallon bucket	FLOW METER READING (if used)	CALCULATED FLOW (gallons per minute)
8:15	168	3 sec.	N/A	20 gpm.
8:30	290	3		20
8:40	330	4		15
8:55	328	60		1
9:10	328	60		1
9:25	328	60		1
9:40	328	60		1
9:55	328	60		1
10:10	328	60		1
10:25	328	60		1
10:40	328	60		1
10:55	328	60		1
11:10	328	60		1
11:25	328	60		1
11:40	328	60		1
11:55	328	60		1
12:10	327	60		1
12:25	327	60		1
12:40	327	60		1
12:55	327	60		1
1:10	327	60		1
1:25	327	60		1
1:40	327	60		1
1:55	327	60		1
HD-224 2:10	327	60		1
2:25	327	60	Over	1 →

11-29-95
afternoon

HOWARD COUNTY HEALTH DEPARTMENT
Bureau of Environmental Health
3525-H Ellicott Mills Drive
Ellicott City, MD 21043
461-9933

APPLICATION FOR PITLESS ADAPTER, WELL PUMP AND PRESSURE TANK INSTALLATION

New Installation _____
Replacement _____

Receipt # _____
Date _____

Name of Installer Cumberland Co Inc.

Telephone 301-(854-6838)

License Number 249
Certified Well Pump Installer _____

Well Driller _____ Registered Plumber

Name of Property Owner Homayoon Mortazavi
Subdivision Deer Track Lot # 16
Site Address 6761 Cortina Drive

Telephone _____
Well Tag # HO-94-0188

- | Pump | Motor | Pitless Adapter |
|---|---------------------|------------------|
| 1. Type | 1. Horsepower _____ | 1. Make _____ |
| a. Deep well jet _____ | 2. RPM _____ | 2. Model # _____ |
| b. Shallow well jet _____ | 3. Voltage _____ | 3. Depth _____ |
| c. Submersible _____ | a. 110 _____ | |
| 2. Make _____ | b. 220 _____ | |
| 3. Model # _____ | | |
| 4. Capacity _____ GPM | | |
| 5. Pump exceeds well capacity Yes _____ No _____ | | |
| 6. If Yes, is low pressure cutoff switch installed? Yes _____ No _____ | | |
| 7. What methods are used to protect the pump and electrical wiring from vibrations? Torque arrestors _____ Cable guards _____ Other _____ | | |

- | Tank | Piping | Well data |
|---------------------------------|--|---|
| 1. Capacity _____ | 1. Type _____ | 1. Depth _____ ft. |
| 2. Pressure relief valve? _____ | 2. Size _____ | 2. Yield _____ GPM |
| | 3. NSF and/or BOCA Code approved _____ | 3. Static water level _____ ft. |
| | 4. Depth of supply line _____ | 4. Will water supply be disinfected by installer? _____ |

*pitless adapter OK at 4 ft.
OK Code Rpp 12/1/95*

* *Note - still using old one piece well caps*

I understand that it is my responsibility to notify the Howard County Health Department when the installation is ready for inspection (otherwise this permit is null and void).

All information given above is true to the best of my knowledge.

Signature of Applicant: _____

Date: _____

Note: A sticker indicating approval/status of the installation will be placed on the well casing at the time of the inspection.

POINTS AND BOUNDS

SYMBOL	BEARING & DISTANCE
T	577°48'50"E 53.02'
U	569°18'14"E 40.21'
V	N42°44'04"E 72.77'
W	S24°58'41"E 19.08'
X	N59°17'24"E 82.31'
Y	N42°02'02"W 16.16'
Z	N00°03'25"W 30.44'
AA	S84°01'57"E 36.90'
BB	N73°52'43"E 18.98'
CC	N37°34'13"E 23.68'
DD	N47°36'05"E 69.63'
EE	N65°08'52"E 49.90'
FF	S49°22'55"W 66.91'
GG	S36°31'15"W 161.91'
HH	S24°24'27"E 47.72'
II	S80°49'19"E 32.51'
JJ	N80°46'29"E 35.66'
KK	S26°50'49"E 54.28'
LL	S58°54'36"E 73.35'

CORTINA DRIVE

*well site OK
no steel
8/22/94
8/26/94
L69*

*DRIVEWAY
PER
BUREAU
MR
9/30/94*

L69

L710

N 552.5
168.407
MET

1" = 1
PIPE

N 552.500
168.402.35
MET

LOT 2
SCHROYER PROPERTY
PLAT No. 4117

STONE FOUND

1 1/2" IRON PIPE FOUND
(0.37' SE)
TO TITLE

MARYLAND STATE
GRID NORTH
160.00'

(202)

LOT 16
61,529 Sq.Ft.

LOT 17
61,598 Sq.Ft.

SHEET

STONE FOUND

25' WETLAND BUFFER

WETLANDS

EXISTING L
25' WETLAND 100-YEAR FT

