

#30. per
fill out in
triplicate

Boundary plat prepared by Reg. Engr.
4-12' Labeled
100 ft. apart
3-12' Labeled 50'

APPLICATION

A 20176

STATE OF MARYLAND - DEPARTMENT OF HEALTH AND MENTAL HYGIENE
HOWARD COUNTY HEALTH DEPARTMENT
ENVIRONMENTAL HEALTH SERVICES
P. O. BOX 476, ELLICOTT CITY, MARYLAND 21043
TELEPHONE: 465-3000, EXT. 356

surety
must be
submitted
P
DISTRICT 6th
DATE 6/18/74

7/5/74
9:30
Etha COULD NOT FIND
OR NO ONE SHOWED

Septic Tank - 1000 gal.
Dry Well - Dig pit. 14 ft. sq. - set black
top for 12' diameter + fill in rest of pit with
gravel. Dry Well to be 4 ft deep below
original grade. + inlet to Dry Well to be 4 ft below original
grade.
Please dig Well 236' from light green plastic storm pipe or foot of
white pipe near right sidewalk.

TO: THE COUNTY HEALTH OFFICER
ELLICOTT CITY, MARYLAND

I, HEREBY, APPLY FOR THE NECESSARY TEST IN ORDER TO CONSTRUCT (OR RECONSTRUCT) A SEWAGE DISPOSAL SYSTEM.

PROPERTY OWNER Vermeer Sales & Service, Inc.
ADDRESS 7281 Wash. Blvd. Balto. Md. 21227 PHONE 796-5434

PROPERTY LOCATION:
SUBDIVISION I. Dunkler 5/D LOT NO. #4

ROAD AND DESCRIPTION Cooney lane app. 1/2 mile from the intersection of Rt. 32 and
Dorsery run Rd (have plat for drawing)
SIZE OF LOT 5.909 acres TYPE BLDG. 60 x 100 metal NUMBER OF BEDROOMS 8 employees
IF NOT SINGLE RESIDENCE DESCRIBE Dealership for light ind. const. equip.

THE SYSTEM INSTALLED UNDER THIS APPLICATION IS ACCEPTABLE ONLY UNTIL PUBLIC FACILITIES BECOME AVAILABLE.

SIGNATURE OF APPLICANT John L. Vre, Jr.
APPROVED BY [Signature] FOR [Signature] DATE 11-1-74
REJECTED BY _____ FOR _____ DATE _____
HOLD PENDING FURTHER TESTS Frommelt DATE 7-12-74
REASONS FOR REJECTION OR HOLDING _____ BLDG. PERMIT SIGNED AND RETURNED 7/4/75

THIS IS NOT A PERMIT

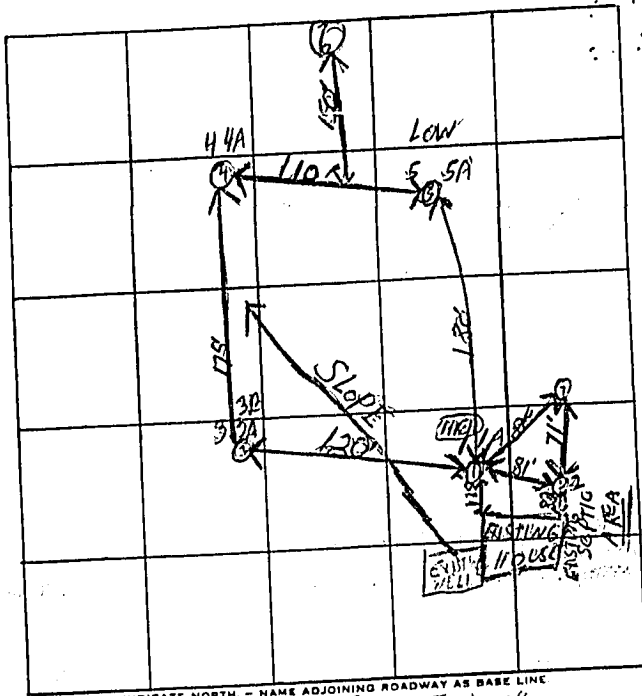

INDICATE NORTH - NAME ADJOINING ROADWAY AS BASE LINE

PRIVATE RIGHT OF WAY

DATE	TEST NO.	DEPTH	PRE-WET		TEST - 1" DROP		TIME
			START	STOP	START	STOP	
↑	1 (H2O)	11 1/2'	220	230	230	1.21 2.30	31
	1A	5'	220	235	235	255	20
	2	12'	VISUAL	CLAY	TOP 5'	REST SANDY GRAVEL	
	3	10'	WATER AT		10'		
7/11/74	3A	4 1/2'	245	NO	NO WATER	316	31
	4	4 1/2'	301	304	304	313	9
	4A	11 1/2'	301		333	4.08	32
	Low 5	4'	321	227	327	341	14
	5A	10 1/2'	WATER AT		10 1/2'		
↓	6	11 1/2'	CLAY	ALL	11R	1W4	

318-81
1/2" drop in 15 min

REMARKS Water at 10-10 1/2' below 3 and 5A - clay mixed in sandy gravel

TYPE OF SOIL SANDY GRAVEL

TESTED BY 1152-1112 ALSO PRESENT: _____

A 20176

Vernon
7/29/74

8/6/74
10a m

~~8/6/74~~
~~10a m~~
~~849350~~

~~849350~~

~~7/29~~ ~~849350~~

23' deep
shovel more to 9';
Red clay fr. 9'
just getting into white
sand; 4:29 5 gal

8-6-24
~~8-6-24~~
A - 20' clay
B - 20' clay
C - 25' clay to 22'
white sand 22-25'
W.W.Z. & D.M.

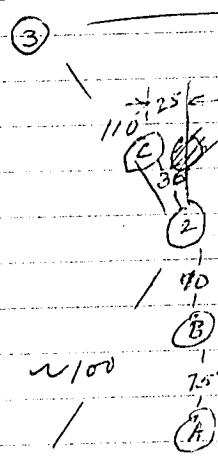

20' deep
alternate white clay
red clay, sand layers

18' deep
pure white sand
fr. 9'
5 gal @ 4:09; on
after 22 sec.; LOOSE
DIRT

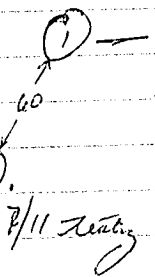

236' fr. light gr.
plastic sand pipe at first fr. 7/11 testing
of bot, and fr. 20' fr. white
pipe nr. night's bot line.

20' deep
fr 13-20' - alternating sand
& white clay layers on north
end, pure white sand south end
5 gal @ 4:05; oil @ 4:08
hole had started caving

W.W.Z.

John Voas
Vernon Sales Service

Dirt road opposite end of Dorey Run Rd. off Rt. 32