

11/16/94
AM
11/22/94
Auger

PERMIT

File

[11/21(2) P.C.O. 2
C.B.]

SEWAGE DISPOSAL SYSTEM

DEPARTMENT OF HEALTH AND MENTAL HYGIENE

P 50401

A 50043

DISTRICT 4th

DATE 11/16/94

DATE SYSTEM APPROVED 11/22/94

INSPECTOR C.B.

HOWARD COUNTY HEALTH DEPARTMENT
BUREAU OF ENVIRONMENTAL HEALTH
461-9933 313-2640

~~XXXXXXXXXX~~
INDEXED

John W. Hidey, Jr.

IS PERMITTED TO INSTALL ALTER

ADDRESS 9303 Dogwood Road, Baltimore, Maryland 21244 PHONE 944-0423

SUBDIVISION J. A. Smith Property LOT ROAD 14822 Burntwoods Road

PROPERTY OWNER J. Alvin Smith (Walnut Springs Nursery)

ADDRESS

SEPTIC TANK CAPACITY 1250 GALLONS

NUMBER OF BEDROOMS 4

180 SQUARE FEET PER BEDROOM

LINEAR FEET OF TRENCH REQUIRED 180

BLDG. PERMIT SIGNED
AND RETURNED 2/8/95
Serial # 58068.
Inground pool.

TRENCHES - Trench to be 2 feet wide. Inlet 3 feet below original grade. Bottom maximum depth 7 feet below original grade. Effective area begins at 3 feet below original grade. 4 feet of stone below distribution pipe.

LOCATION - See Perc Plat For Approved SDA Locations. Install trenches in highest part of SDA First. Call for open trench inspection prior to gravel filling trench.

NOTES - No trench to exceed 100 feet in length. Provide 6" - 8" diameter cleanout and cap to grade or above on septic tank. OK 11/17/94 OCS

PLANS APPROVED BY Ronald J. Pinkley DATE 08/17/94

COVER NO WORK UNTIL INSPECTED AND APPROVED

NEITHER THE HOWARD COUNTY COUNCIL NOR THE HEALTH DEPARTMENT IS RESPONSIBLE FOR THE SUCCESSFUL OPERATION OF ANY SYSTEM

NOTE: CLEANOUT REQUIRED EVERY 70 FEET OF SEWER LINE AND/OR AT 90° SWEEPS IN LINES FROM HOUSE TO DRAIN FIELDS, 90° ELBOWS NOT ACCEPTABLE.

NOTE: ALL PARTS OF SEPTIC SYSTEMS (I.E. TANK, DISTRIBUTION BOX TRENCHES) TO BE 100 FEET FROM WELL (UNLESS OTHERWISE SPECIFICALLY AUTHORIZED)

NOTE: IF DEEP TRENCH(ES) ARE USED CALL FOR INSPECTION BEFORE AND AFTER PLACING GRAVEL IN TRENCH(ES)

NOTE: NO DRY WELL SHALL EXCEED 15 FOOT IN DIAMETER NO ABSORPTION TRENCH TO EXCEED 100 FEET IN LENGTH

NOTE: ALL PIPE FROM HOUSE TO SEPTIC TANK MUST BE CAST IRON OR SCHEDULE 35/40 PVC OR ABS

BLDG. PERMIT SIGNED
AND RETURNED 11/21/94
Serial # 57259

PERMIT VOID AFTER TWO YEARS

NOTE: INSTALL STAND PIPE ON SEPTIC TANK AND DRY WELL STAND PIPES MUST BE 6 INCHES IN DIAMETER CAST IRON, CONCRETE OR TERRA COTTA OR PVA OR ABS ACCEPTED. IF TOP OF SEPTIC TANK IS DEEPER THAN 3 FEET. MANHOLE TO GRADE REQUIRED. Interior alterations

NOTE: DISTRIBUTION BOXES MUST HAVE BAFFLES

*INSTALLER IS RESPONSIBLE FOR OBTAINING FINAL APPROVAL ON THIS PERMIT

A 50043

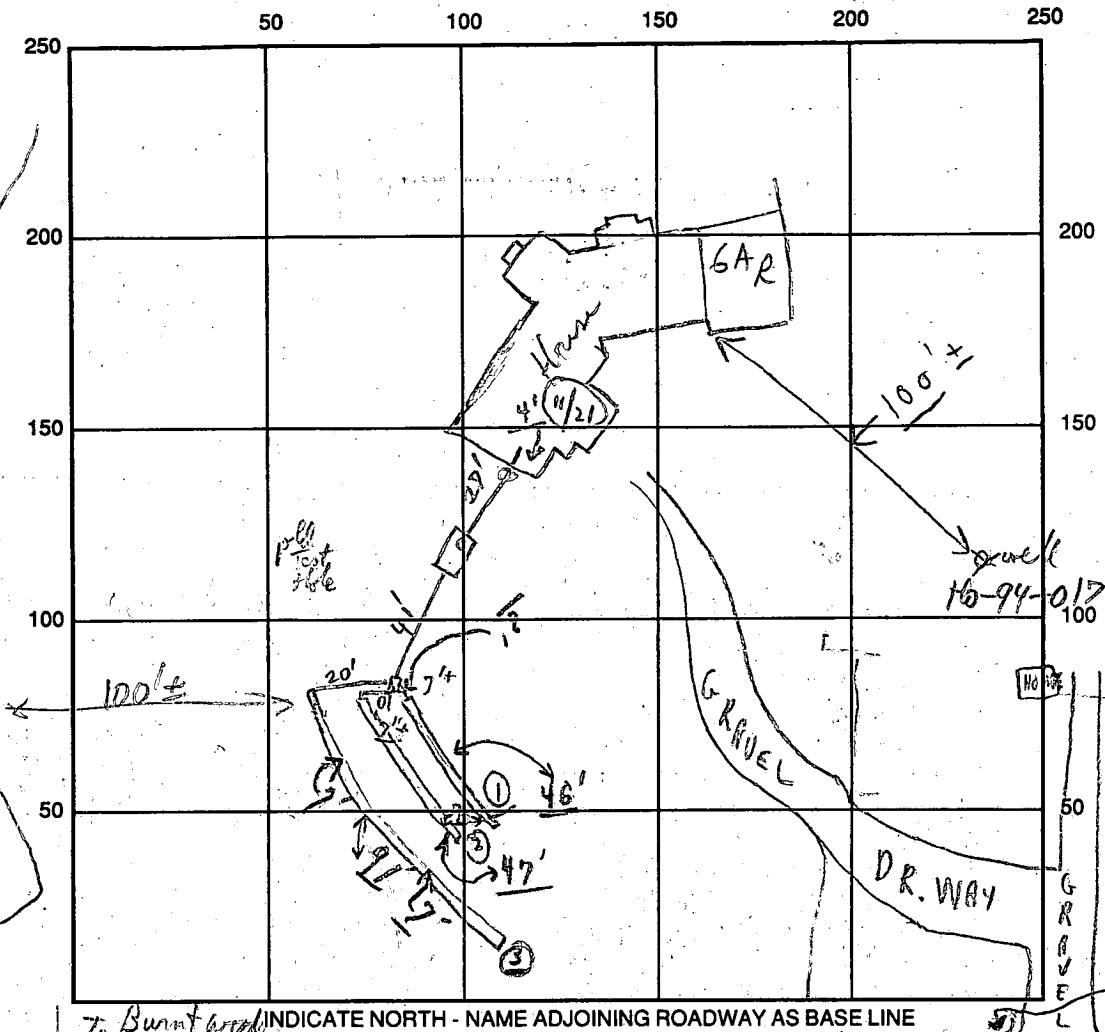

SEPTIC TANK LEVEL 1250 gal CLEANOUTS S.T. & Hse

DISTRIBUTION BOX LEVEL (Baffles in)

DRAIN FIELD/TITLE DEPTH 7 FT. TRENCH WIDTH 2 FT. INLET DEPTH 3 FT.

EFFECTIVE GRAVEL DEPTH 4 FT. TOTAL LENGTH $\frac{11}{21} \times 3 = 184$ FT.

NUMBER OF TRENCHES 3 ONE SIDEWALL/BOTTOM AREA 736 SQ. FT.

DRYWALL INSIDE DIAMETER — FT. EFFECTIVE DEPTH BELOW INLET — FT.

ABSORBENT AREA 736 SQ. FT.

REMARKS: 11/18 OK to cover ST & lines to dist. box, OK to continue digging trenches & gravel fill when finished digging - OK to cover middle section Nov. 18/11/94

ON 11/21/94 Trenches OK TO COVER AS FINISH-EXCEPT ENDS; SAME WITH 2 SHORT TRENCHES - PARTIAL OK 11/21/94 (P.M.) later Paved No changes; no one around OK 11/22/94 P.M. Final, ok to cover asphalt-material on 11/21/22 No W.P.I. OK 11/22/94 INSPECTOR Charles B. Stricker

DATE SYSTEM APPROVED 11/22/94 site. OK

APPLICATION

PERCOLATION TESTING

A 50043

P _____

HOWARD COUNTY HEALTH DEPARTMENT
BUREAU OF ENVIRONMENTAL HEALTH
3525-H ELLICOTT MILLS DRIVE/ELLICOTT CITY, MARYLAND 21043
TELEPHONE: 313-2640

DISTRICT _____

DATE 5/23/94

TO: THE COUNTY HEALTH OFFICER
ELLICOTT CITY, MARYLAND

I HEREBY APPLY FOR THE NECESSARY TEST PRIOR TO APPLICATION FOR PERMIT TO CONSTRUCT (OR RECONSTRUCT) A SEWAGE DISPOSAL SYSTEM.

PROPERTY OWNER J. ALVIN SMITH
Sent 2245 McKendree Road, W.F. (21794)
ADDRESS 14812 BURNT WOODS RD., GLENWOOD MD., 21738 PHONE (410) 442-2299 or (410) 489-4700

AGENT OR PROSPECTIVE BUYER HARRY G. PIRRUNG JR., PRESIDENT, T.W. BOYS CO. INC.
ADDRESS P.O. BOX 500 COOKSVILLE, MD. 21723 PHONE (301) 854-6659

PROPERTY LOCATION:

SUBDIVISION N/A LOT NO. N/A

ROAD AND DESCRIPTION INTERSECTION MD RT. 97 (EAST OF) & BURNT WOODS RD. (NORTH OF)

TAX MAP 14 PARCEL # 82

SIZE OF LOT 46.123 ACRES TYPE BLDG. SFD
(SINGLE FAMILY DWELLING OR COMMERCIAL)

BLDG. PERMIT SIGNED Approved
AND RETURNED 2/8/95 part
Serial # 58068

THE SYSTEM INSTALLED UNDER THIS APPLICATION IS ACCEPTABLE ONLY UNTIL PUBLIC FACILITIES BECOME AVAILABLE. I FULLY UNDERSTAND THE FEE CONNECTED WITH THE FILING OF THIS PERC TEST APPLICATION IS NON-REFUNDABLE UNDER ANY CIRCUMSTANCES. I ALSO AGREE TO COMPLY WITH ALL M.O.S.H.A. REQUIREMENTS IN TESTING THIS LOT.

Harry G. Pirrung Jr. - PERMIT
(SIGNATURE OF APPLICANT)

APPROVED BY _____ FOR _____ DATE _____

DISAPPROVED BY _____ FOR _____ DATE _____

HOLD PENDING FURTHER TESTS _____

REASONS FOR REJECTION OR HOLDING _____

PERCOLATION TEST PLAT/PRELIMINARY PLAT - TITLE OR I.D. # _____ DATE _____

SITE DEVELOPMENT PLAN/FINAL PLAT - TITLE OR I.D. # _____ DATE _____

THIS IS NOT A PERMIT

50043
COUNTY #

SOIL PROFILE D

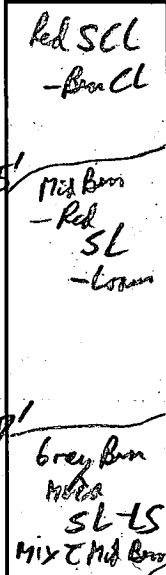
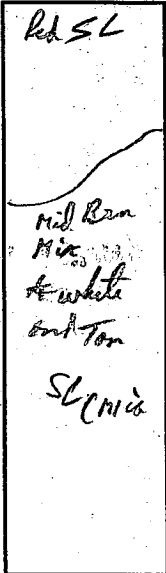
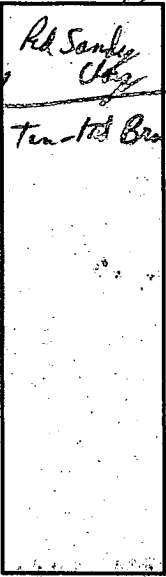

SOIL PROFILE 6

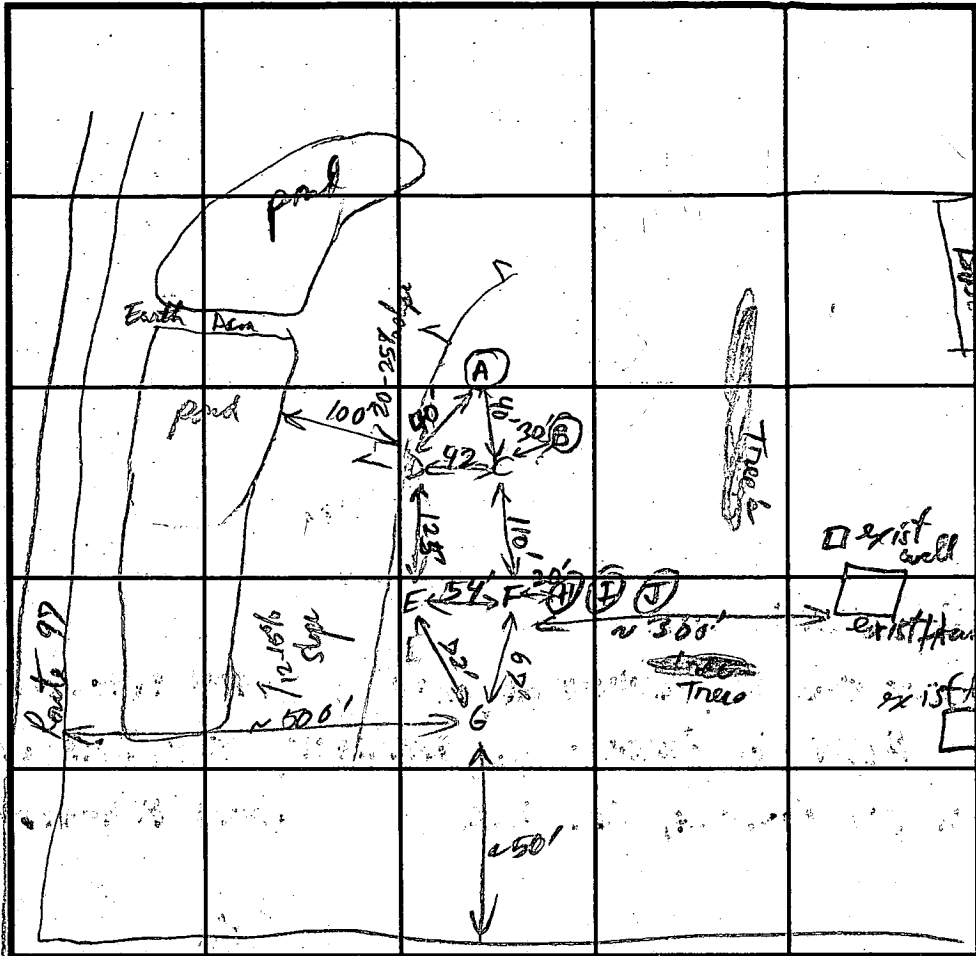
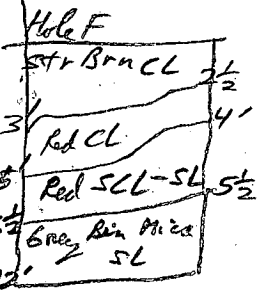
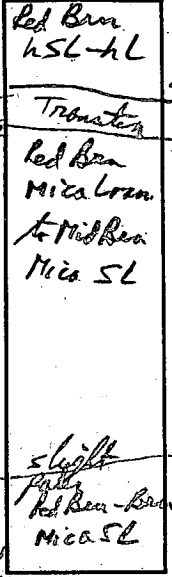

INDICATE NORTH - NAME ADJOINING ROADWAY AS BASE LINE. Burntwood

DATE	TEST NO.	DEPTH	PRE-WET		TEST - 1" DROP		TIME	
			START	STOP	START	STOP		
6/1/94	A	3'	Refusal	Rock @ 3'			Fail	
	B	6 1/2'		Rock @ 6 FT	Refusal @ 7 1/2'		Fail	
	C	4'	12:55:45	12:58:00	12:58:00	1:02:00	4 min	
	D	8'	12:56:30	12:57:40	12:57:40	12:59:40	2 min	
	D	11' 4 1/2'	1:00:30	1:02:00	1:02:00	1:05:00	2 1/2 min	
	E	11' 4 1/2'	1:11:50	1:16:00	1:16:00	1:20:50	5 min	
	F	12' 6 1/2'	1:11:00	1:15:30	1:15:30	1:23:00	7 1/2 min	
	G	12'	Not tested OK on depth or best below 2 1/2'					OK
	H, I	3 1/2'	Rock @ 3 1/2'				Fail	
	J	1 1/2'	Rock @ 1 1/2'				Fail	

REMARKS Only possible water could be 1/2" area / Mid Brn Mica SL @ 7' 4" @ Hole E
 TYPE OF SOIL Further limited by Rock @ A, B, H, I, J. - Red of area satisfactory
 TESTED BY R. J. Hubble ALSO PRESENT O. Kollerman, No South
 TRENCH DESIGN DATA: AVERAGE PERCOLATION TIME 6 min TRENCH WIDTH 2
 INLET DEPTH 2 1/2' MAXIMUM BOTTOM DEPTH 7' SQ. FT./BEDROOM 180

SCALE 1" = 50'

STING POND

Approved Septic System Plan Howard County Health Department

C. J. [Signature] 9/21/94

Date

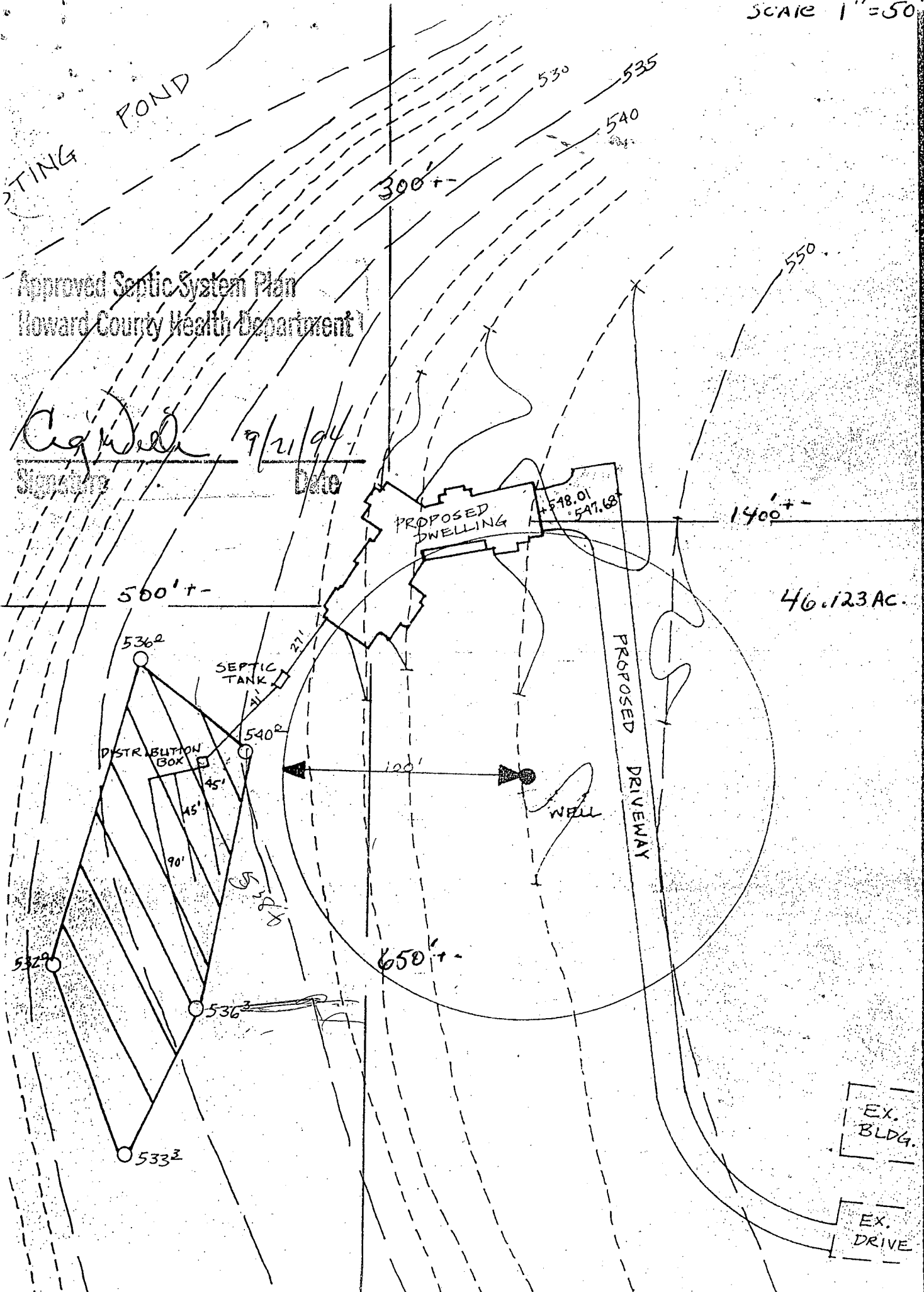

- EX. BLDG.
- EX. DRIVE

SETBACKS:	
REAR PL.	50'
SIDE PL.	30'
HOUSE	10'
SEPTIC	20'
WELL	10'

PRIVATE WELL
& SEPTIC

SITE PLAN

1" = 100'

SMITH PROPERTY
TAX MAP 14, PARCEL 82
4TH ELECTION DIST.
HOWARD COUNTY, MD

ROSEBAR

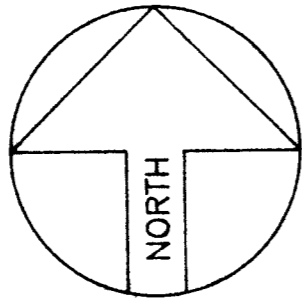

NOTE: A VACUUM BREAKER
WILL BE INSTALLED
ON JOB AS PER
CODE.

Approved
Howard County Health Department

Amy M. Miller 2/8/95
Signature Date

*BP58068 for pool had
no impact to existing
well or septic.*

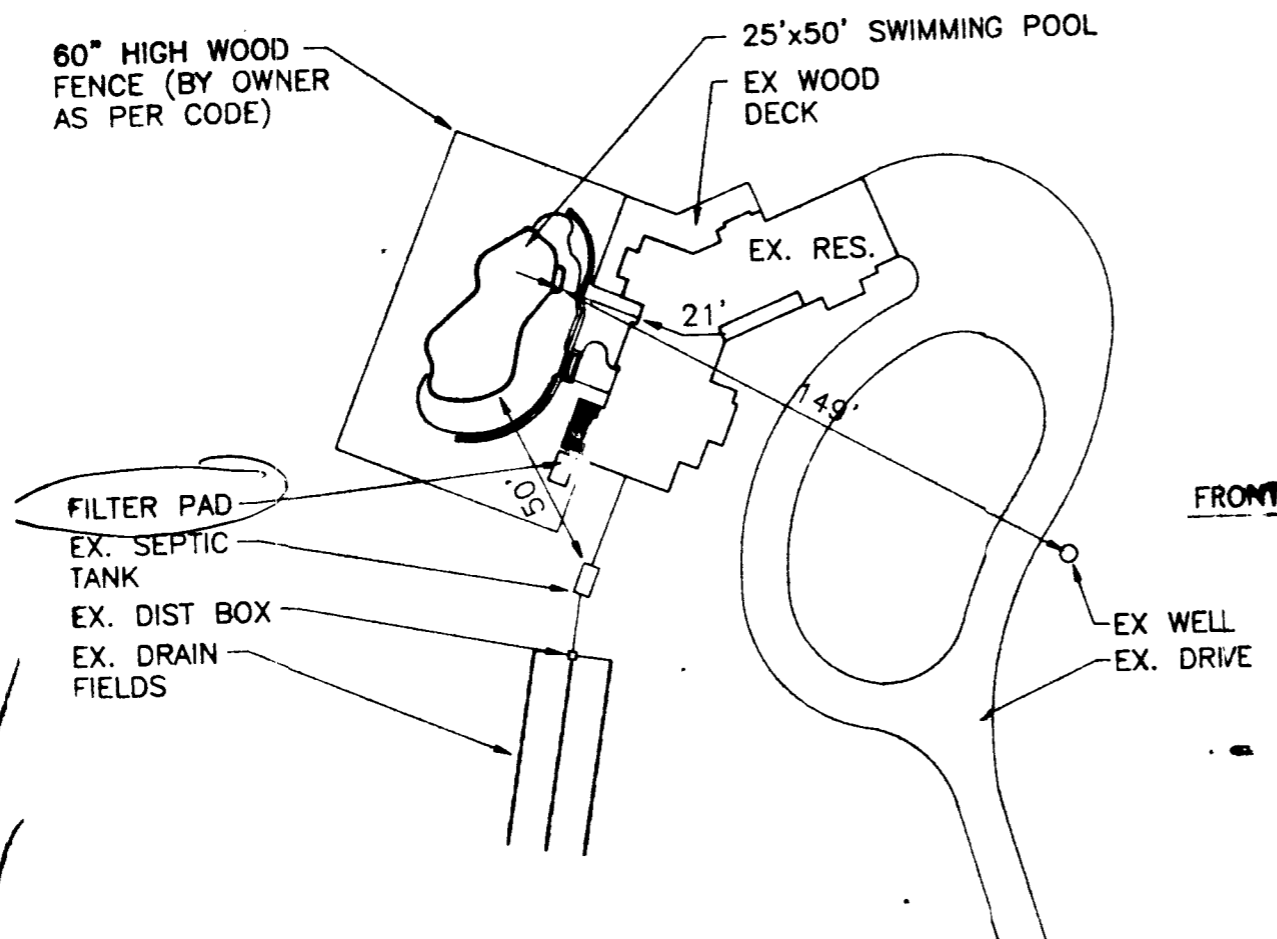
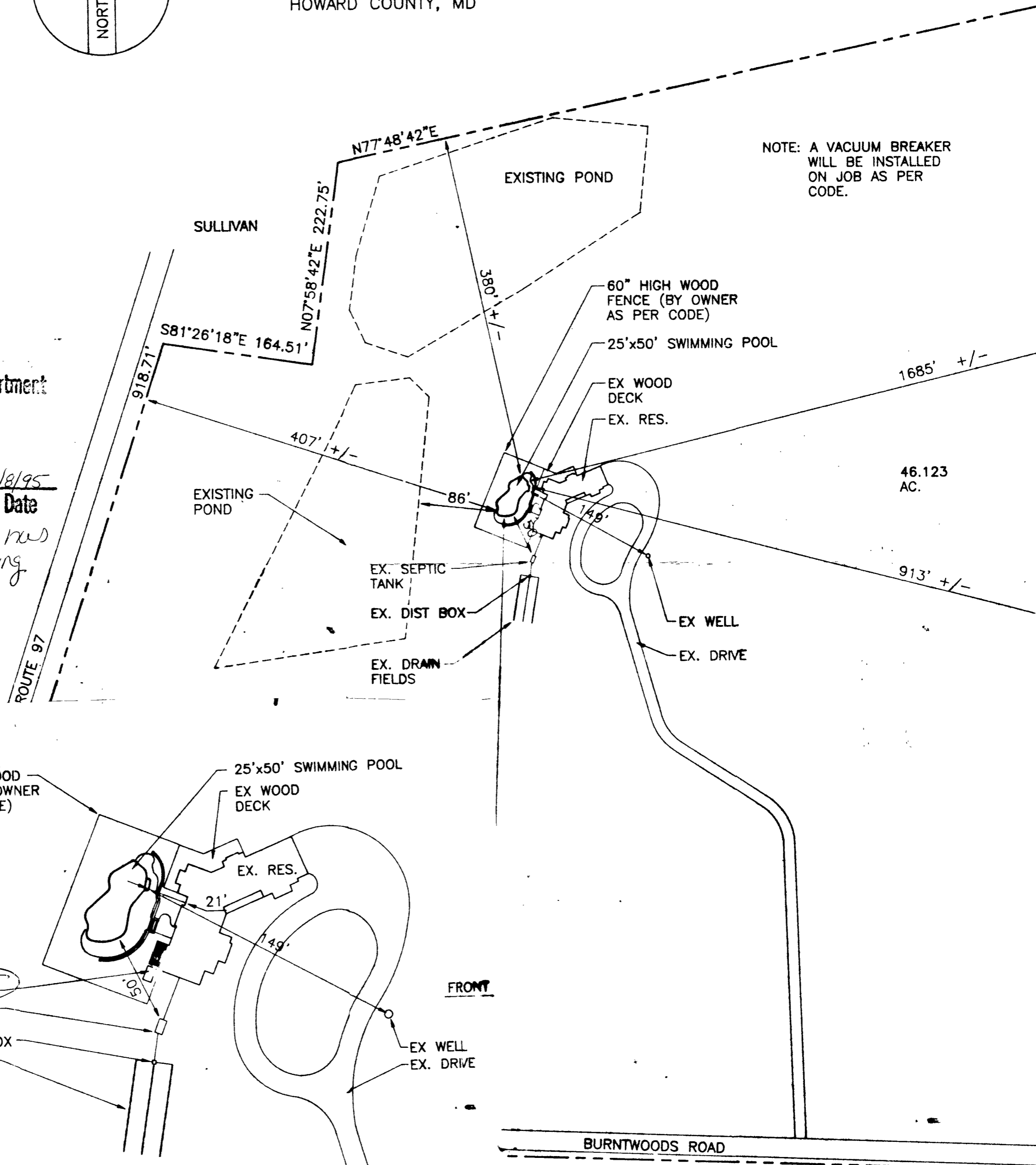

SITE PLAN ENLARGEMENT

1" = 50'

C1 4514

SEQUENCE NO. (DENV USE ONLY)

STATE OF MARYLAND WELL COMPLETION REPORT

THIS REPORT MUST BE SUBMITTED WITHIN 45 DAYS AFTER WELL IS COMPLETED.

(THIS NUMBER IS TO BE PUNCHED IN COLS. 3-6 ON ALL CARDS)

COUNTY NUMBER A 50043

ST/CC USE ONLY DATE RECEIVED

DATE WELL COMPLETED

Depth of Well 22 280 26 (TO NEAREST FOOT)

PERMIT NO. FROM "PERMIT TO DRILL WELL" #0-94-0172

OWNER Walnut Springs Nursery last name Burntwood Road first name Cooksville TOWN AC Smith Property SUBDIVISION SECTION LOT

WELL LOG Not required for driven wells STATE THE KIND OF FORMATIONS PENETRATED, THEIR COLOR, DEPTH, THICKNESS AND IF WATER BEARING

Table with columns: DESCRIPTION (Use additional sheets if needed), FEET (FROM, TO), Check if water bearing. Rows include Dirt, Soft Red & Br. Sand & Clay, Soft Br. Sand, Soft Br. Sandstone, Hard Br. & Blue Sandstone, Hard Blk. Sandstone, Hard Br. Sandstone, Hard Blk. Sandstone, Fracture line Red Clay, Hard Blk. Sandstone, Hard Br. Sandstone, Hard Blk. Sandstone, Hard Blue Schist, Hard Blk. Sandstone.

GROUTING RECORD WELL HAS BEEN GROUTED (Circle Appropriate Box) TYPE OF GROUTING MATERIAL CEMENT CM BENTONITE CLAY BC NO. OF BAGS 22 NO. OF POUNDS 2068 GALLONS OF WATER 132 DEPTH OF GROUT SEAL (to nearest foot) from 0 ft. to 39 ft.

CASING RECORD casing types insert appropriate code below ST CO STEEL CONCRETE PL OT PLASTIC OTHER

MAIN CASING TYPE Nominal diameter top (main) casing (nearest inch) Total depth of main casing (nearest foot) S T 6 41

OTHER CASING (if used) diameter inch depth (feet) from to

SCREEN RECORD screen type or open hole insert appropriate code below ST BR HO STEEL BRASS BRONZE HOLE PL OT PLASTIC OTHER

IN HARD ROCK AREAS, IDENTIFY SPECIFICALLY WHERE SATURATED FRACTURES WERE OBSERVED. WELL HYDROFRACTURED yes Y no N

CIRCLE APPROPRIATE LETTER A A WELL WAS ABANDONED AND SEALED WHEN THIS WELL WAS COMPLETED E ELECTRIC LOG OBTAINED P TEST WELL CONVERTED TO PRODUCTION WELL

I HEREBY CERTIFY THAT THIS WELL HAS BEEN CONSTRUCTED IN ACCORDANCE WITH COMAR 26.04.04 "WELL CONSTRUCTION" AND IN CONFORMANCE WITH ALL CONDITIONS STATED IN THE ABOVE CAPTIONED PERMIT, AND THAT THE INFORMATION PRESENTED HEREIN IS ACCURATE AND COMPLETE TO THE BEST OF MY KNOWLEDGE.

DRILLERS IDENT. NO. 296 RONALD L. KYKER

DRILLERS SIGNATURE (MUST MATCH SIGNATURE ON APPLICATION) Ronald Kyker SITE SUPERVISOR (sign of driller or journeyman responsible for sitework if different from permittee)

C2 DEPTH (nearest ft.) HO 280 41

GRAVEL PACK IF WELL DRILLED WAS FLOWING WELL INSERT F IN BOX 68

MDE USE ONLY (NOT TO BE FILLED IN BY DRILLER) T (E.R.O.S.) W Q 70 72 74 75 76 TELESCOPE CASING LOG INDICATOR OTHER DATA

C3 PUMPING TEST HOURS PUMPED (nearest hour) 3 PUMPING RATE (gal. per min. to nearest gal.) 10 METHOD USED TO MEASURE PUMPING RATE submersible WATER LEVEL (distance from land surface) BEFORE PUMPING 30 WHEN PUMPING 33 TYPE OF PUMP USED (for test) A air P piston T turbine C centrifugal R rotary O other (describe below) J jet S submersible

PUMP INSTALLED DRILLER WILL INSTALL PUMP YES NO IF DRILLER INSTALLS PUMP, THIS SECTION MUST BE COMPLETED FOR ALL WELLS EXCEPT HOME USE TYPE OF PUMP INSTALLED PLACE (A,C,J,P,R,S,T,O) IN BOX - SEE ABOVE: CAPACITY: GALLONS PER MINUTE (to nearest gallon) PUMP HORSE POWER PUMP COLUMN LENGTH (nearest ft.) CASING HEIGHT (circle appropriate box and enter casing height) + above - below LAND SURFACE 2 (nearest foot)

LOCATION OF WELL ON LOT SHOW PERMANENT STRUCTURE SUCH AS BUILDING, SEPTIC TANKS, AND/OR LANDMARKS AND INDICATE NOT LESS THAN TWO DISTANCES (MEASUREMENTS TO WELL) Burntwood Rd