

PERMIT

P. 15719

SEWAGE DISPOSAL SYSTEM

A.

MARYLAND STATE DEPARTMENT OF HEALTH

HOWARD COUNTY

ELLICOTT CITY

DISTRICT 2

DATE 2/18/71

INDEXED

*7/1/71
after 1 PM*

Richard Lowe IS PERMITTED TO INSTALL ALTER X

ADDRESS Ilchester Road, Ellicott City, Md. PHONE RI 7-7598

A SEWAGE DISPOSAL SYSTEM LOCATED AT _____

SUBDIVISION _____ ROAD Cook's Lane LOT _____

PROPERTY OWNER Leon Wilhide - Wilhide Flower Shop

ADDRESS _____

SPECIFICATIONS

DRAIN FIELD _____ DEPTH _____ FEET, BOTTOM AREA _____ SQ. FT.

SEEPAGE PITS _____ ABSORBENT SIDE-WALL AREA _____ SQ. FT.

SEPTIC TANK CAPACITY 1000 GALLONS

FOR GARBAGE GRINDER, INCREASE DISPOSAL AREA 22% & TANK CAPACITY 50%.

OTHER REPAIR - Go to flower shop - when ground is opened up call for

Sanitarian to inspect and recommend repair system.

Trench - 35 ft. long 6 1/2 ft. deep 6 ft. of gravel.

Call for inspection before and after gravel is

in the slots. R. Ture

PLANS APPROVED BY Palmer F. Wine DATE 2/18/71

FILL SEPTIC TANK AND DISTRIBUTION BOX WITH WATER BEFORE CALLING FOR AN INSPECTION. COVER NO WORK UNTIL INSPECTED AND APPROVED.

NEITHER THE HOWARD COUNTY COMMISSIONERS NOR THE HEALTH DEPARTMENT IS RESPONSIBLE FOR THE SUCCESSFUL OPERATION OF ANY SYSTEM.

DRY WELL - 300 sq. ft. absorbent sidewall area to begin below the inlet. Maximum depth permitted is 10 ft. below original grade. locate dry well 45 ft. in back of existing building as seen from Cook's Lane.

15719

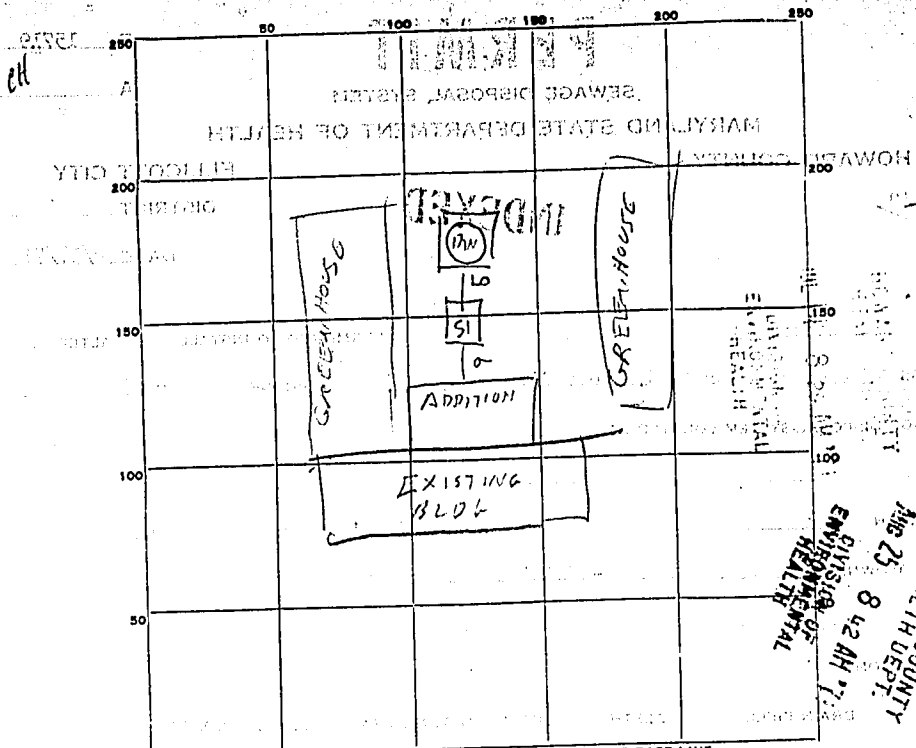

DIVISION OF ENVIRONMENTAL HEALTH
 HOWARD COUNTY HEALTH DEPT.
 AUG 25 8 42 AM '71

INDICATE NORTH - NAME ADJOINING ROADWAY AS BASE LINE.
 TO OLD COLUMBIAN COOK'S LANE

PERMIT CARD _____

SEPTIC TANK, LEVEL OK concrete 1000 CLEANOUTS OK

DISTRIBUTION BOX, LEVEL _____

TILE FIELD, DEPTH _____ FT. TRENCH WIDTH _____ FT.

GRAVEL DEPTH _____ IN. TOTAL LENGTH _____ FT.

NUMBER OF TRENCHES _____ TOTAL BOTTOM AREA _____

SEEPAGE PITS, INSIDE DIAMETER 8 FT. DEPTH BELOW INLET 3 FT.

ABSORBENT AREA 352 SQ. FT. counting stone

44
 352
 25

REMARKS 8/25/71 Mary Nell on lot 3 FT below grade
Perimeter of Driveway 44 FT 11/700 check for
B.P. OK no overflow &

DATE SYSTEM APPROVED 8/25/71 INSPECTOR Raymond Hodges