

9/17/81
230
7/2/81
C. J. [unclear]

PERMIT

P 31467
A Repair

SEWAGE DISPOSAL SYSTEM

MARYLAND STATE DEPARTMENT OF HEALTH

HOWARD COUNTY

04-324501

ELLICOTT CITY

DISTRICT 3rd

INDEX

DATE 7/2/81

Frank Green Bob Rhinehardt IS PERMITTED TO INSTALL _____ ALTER X

ADDRESS White Rock Road PHONE _____

SUBDIVISION _____ ROAD 468 Gauthier Road LOT _____

PROPERTY OWNER William Thomas

ADDRESS 468 Gauthier Road 489-4701

SPECIFICATIONS **BUILDING PERMIT SIGNED AND RETURNED**

53-05 800 53597 - AROH

- SEPTIC TANK CAPACITY _____ GALLONS
- DRAIN FIELD _____ DEPTH _____ FEET, BOTTOM AREA _____ SQ. FT.
- DEEP TRENCH _____ DEPTH _____ FEET, BOTTOM AREA _____ SQ. FT.
- SEEPAGE PITS _____ ABSORBENT SIDE-WALL AREA _____ SQ. FT.
- INLET PIPE _____ FT. BELOW ORIGINAL GRADE, MAXIMUM DEPTH _____ FT. BELOW ORIGINAL GRADE
- EFFECTIVE DEPTH AT _____ FT. BELOW ORIGINAL GRADE.
- LOCATE DISPOSAL AREA _____ FT. FROM _____ LOT LINE AND _____ FT. FROM _____ LOT LINE AS SEEN WHEN

FACING LOT FROM

Repair - Call for inspection when ground is opened up so sanitarian can recommend repair. New 1000 gal septic tank. Trenches 10 ft long - 7 ft deep with 5 ft of stone.

PLANS APPROVED BY Palmer F. Ware DATE July 2, 1981

COVER NO WORK UNTIL INSPECTED AND APPROVED.

NEITHER THE HOWARD COUNTY COUNCIL NOR THE HEALTH DEPARTMENT IS RESPONSIBLE FOR THE SUCCESSFUL OPERATION OF ANY SYSTEM.

- NOTE: IF TRENCH IS USED CALL FOR INSPECTION BEFORE PLACING GRAVEL IN TRENCH.
- NOTE: NO DRY WELL SHALL EXCEED 15 FOOT IN DIAMETER.
- NOTE: ALL PIPE FROM HOUSE TO DISPOSAL AREA MUST BE CAST IRON.
- PERMIT VOID AFTER THREE YEARS.
- NOTE: INSTALL STAND PIPE ON SEPTIC TANK AND DRY WELL. STAND PIPES MUST BE 6 INCHES IN DIAMETER. CAST IRON, CONCRETE OR TERRA COTTA ACCEPTED.

*INSTALLER IS RESPONSIBLE FOR OBTAINING FINAL APPROVAL ON THIS PERMIT.

AP 31467

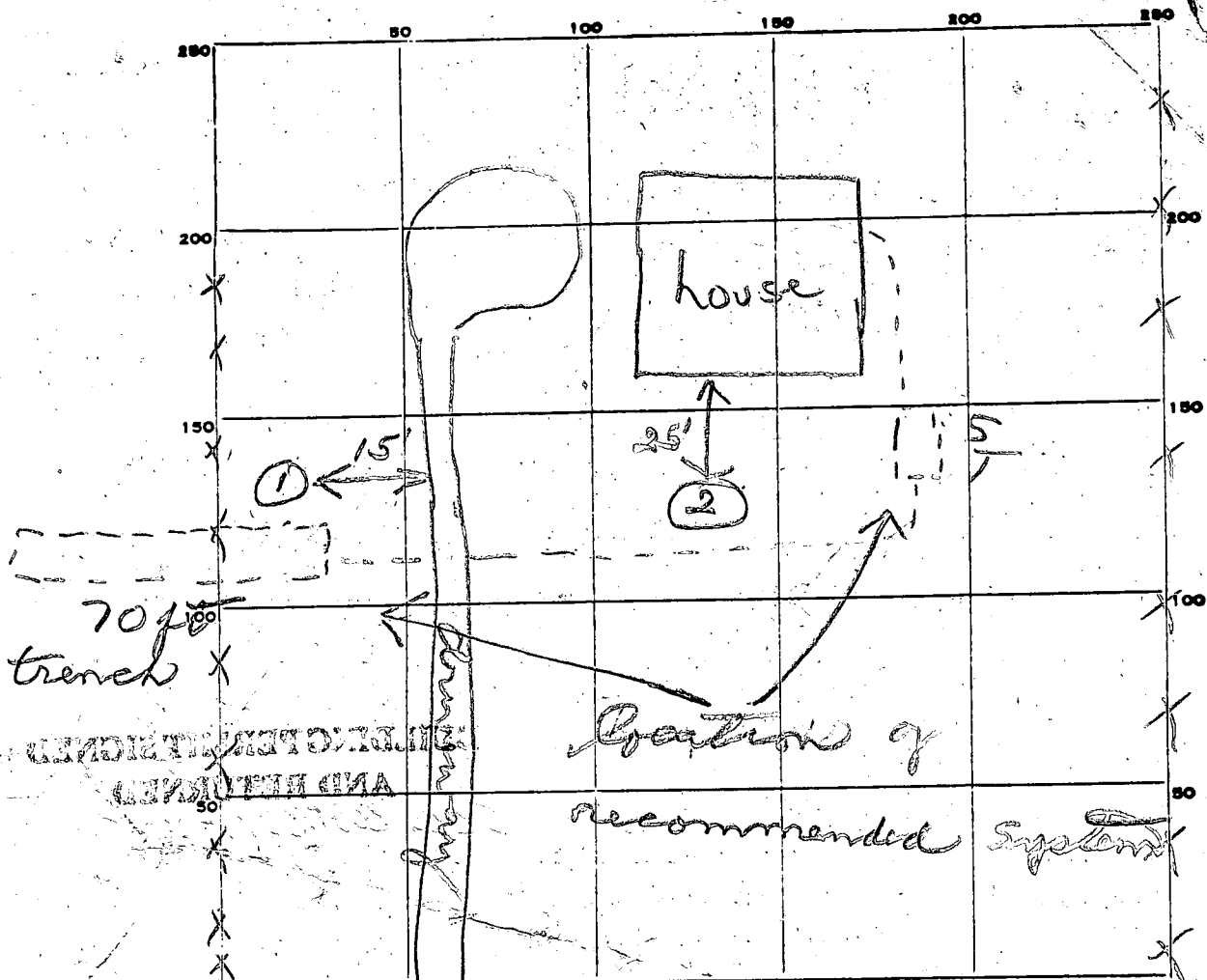

PERMIT CARD _____

SEPTIC TANK, LEVEL _____ CLEANOUTS _____

DISTRIBUTION BOX, LEVEL _____

TILE FIELD, DEPTH _____ FT. TRENCH WIDTH _____ FT.

GRAVEL DEPTH _____ IN. TOTAL LENGTH _____ FT.

NUMBER OF TRENCHES _____ TOTAL BOTTOM AREA _____

SEEPAGE PITS, INSIDE DIAMETER _____ FT. DEPTH BELOW INLET _____ FT.

ABSORBENT AREA _____ SQ. FT.

REMARKS 7/2/81 Trench to be dug in garden in fall.
 Plan # 5
 9/15/81 SEE YELLOW SHEET PAGE 2

DATE SYSTEM APPROVED _____ INSPECTOR _____

UNITED STATES POSTAL SERVICE
OFFICIAL BUSINESS

SENDER INSTRUCTIONS

Print your name, address, and ZIP CODE in the space below.

- Complete items 1, 2, and 3 on the reverse.
- Moistened gummed ends and attached to front of article if space permits. Otherwise affix to back of article.
- Endorse article "Return Receipt Requested" adjacent to number.

**RETURN
TO**



Howard County Health Dept
3716 Court Place
Ellicott City, Maryland 21043

(City, State, and ZIP Code)



PENALTY FOR PRIVATE
USE TO AVOID PAYMENT
OF POSTAGE, \$300

PERMIT

Approved 9/17/81
Stayed
P 31467
A (REPA)

SEWAGE DISPOSAL SYSTEM

MARYLAND STATE DEPARTMENT OF HEALTH

HOWARD COUNTY

ELLICOTT CITY

DISTRICT _____

DATE _____

FRANK GREEN & BOBRWEHART IS PERMITTED TO INSTALL _____ ALTER _____

ADDRESS _____ PHONE _____

SUBDIVISION _____ ROAD _____ LOT _____

PROPERTY OWNER WILSON NORRIS

ADDRESS 468 GAITHER RD

SPECIFICATIONS

SEPTIC TANK CAPACITY _____ GALLONS
DRAIN FIELD _____ DEPTH _____ FEET, BOTTOM AREA _____ SQ. FT.
DEEP TRENCH _____ DEPTH _____ FEET, BOTTOM AREA _____ SQ. FT.
SEEPAGE PITS _____ ABSORBENT SIDE-WALL AREA _____ SQ. FT.
INLET PIPE _____ FT. BELOW ORIGINAL GRADE. MAXIMUM DEPTH _____ FT. BELOW ORIGINAL GRADE
EFFECTIVE DEPTH AT _____ FT. BELOW ORIGINAL GRADE.
LOCATE DISPOSAL AREA _____ FT. FROM _____ LOT LINE AND _____ FT. FROM _____ LOT LINE AS SEEN WHEN
FACING LOT FROM

SEE PAGE 1

PLANS APPROVED BY _____ DATE _____

COVER NO WORK UNTIL INSPECTED AND APPROVED.

NEITHER THE HOWARD COUNTY COUNCIL NOR THE HEALTH DEPARTMENT IS RESPONSIBLE FOR THE SUCCESSFUL OPERATION OF ANY SYSTEM.

NOTE: IF TRENCH IS USED CALL FOR INSPECTION BEFORE PLACING GRAVEL IN TRENCH.

NOTE: NO DRY WELL SHALL EXCEED 15 FOOT IN DIAMETER.

NOTE: ALL PIPE FROM HOUSE TO DISPOSAL AREA MUST BE CAST IRON.

PERMIT VOID AFTER THREE YEARS.

NOTE: INSTALL STAND PIPE ON SEPTIC TANK AND DRY WELL. STAND PIPES MUST BE 6 INCHES IN DIAMETER. CAST IRON, CONCRETE OR TERRAZO ACCEPTED.

*INSTALLER IS RESPONSIBLE FOR OBTAINING FINAL APPROVAL ON THIS PERMIT.

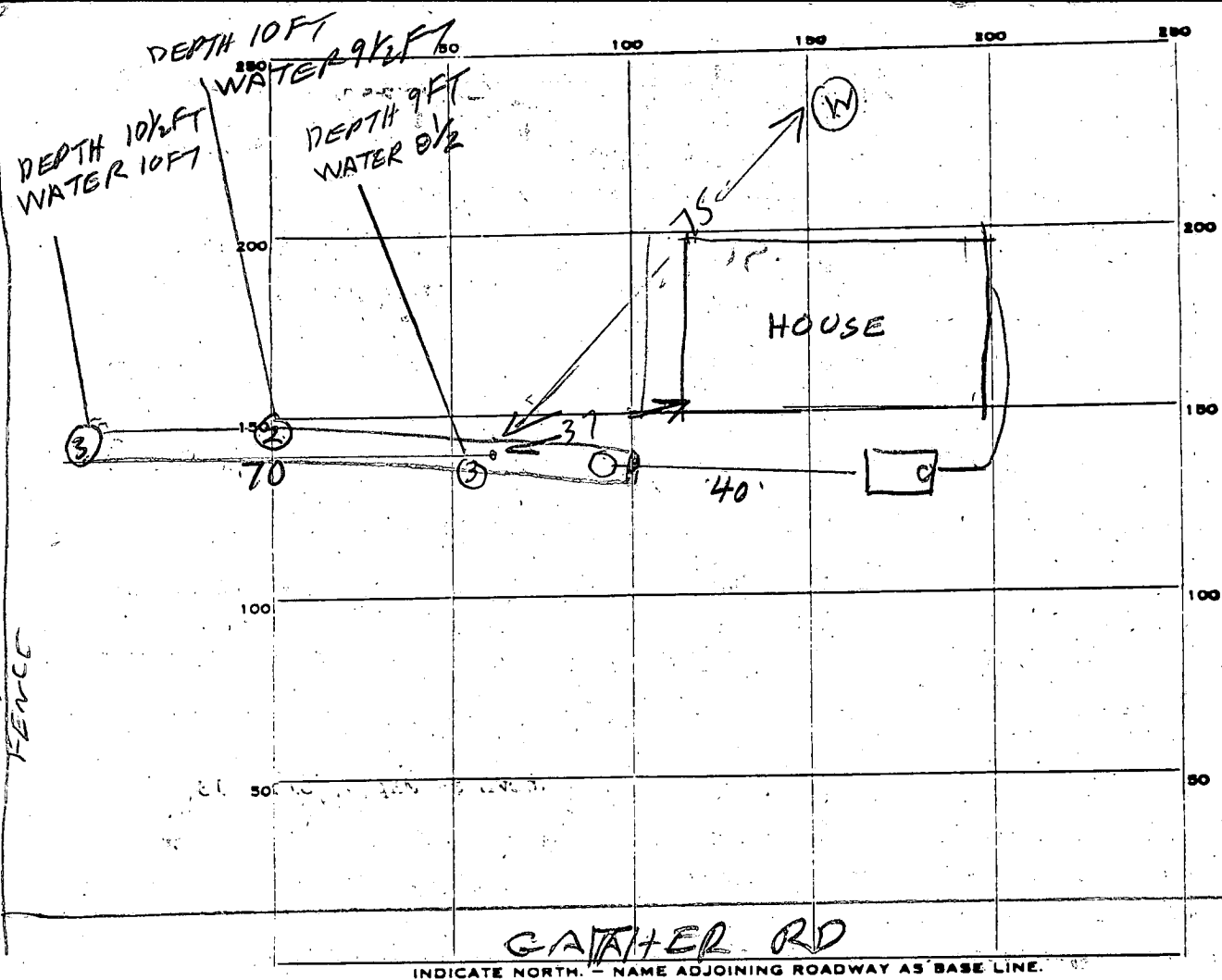

PERMIT CARD: _____

SEPTIC TANK, LEVEL OK 1000

CLEANOUTS OK

DISTRIBUTION BOX, LEVEL OK

TILE FIELD, DEPTH 9 - 10 1/2 FT. TRENCH WIDTH 2 FT.

GRAVEL DEPTH 4 IN. TOTAL LENGTH 70 FT.

NUMBER OF TRENCHES 1 TOTAL BOTTOM AREA 280

SEEPAGE PITS, INSIDE DIAMETER _____ FT. DEPTH BELOW INLET _____ FT.

ABSORBENT AREA 280 SQ. FT.

REMARKS 9/17/81 - POINT 1 - TOP 6 FT CLAY BOT 4 1/2 SANDY
POINT 2 - TOP 5 1/2 FT CLAY BOT 3 1/2 SANDY POINT 3 TOP 6 FT CLAY BOT
3 FT SANDY DISCUSSED WITH FS HE DECIDED TO BACK FILL
DITCH WITH 2 FT OF DIRT THEN ADD STONE & GRAVEL

OK TO COVER PIPE FROM TANK TO BOX & PART OF TANK

9/17/81 OK to cover all work. JS

DATE SYSTEM APPROVED 9/17/81

INSPECTOR Stayer

HOWARD COUNTY HEALTH DEPARTMENT

JOYCE M. BOYD, M.D., M.P.H.
DEPUTY STATE AND
COUNTY HEALTH OFFICER



BUREAU OF ENVIRONMENTAL HEALTH
P.O. Box 476
ELLCOT CITY, MARYLAND 21043
TELEPHONE: 992-2330

June 15, 1981

Mr. Wilson T. Norris
468 Gaither Road
Sykesville, Maryland 21784

Dear Mr. Norris:

On June 10, 1981, while investigating a complaint concerning a condition allegedly hazardous to health, Miss Rash inspected your property known as Map 4, Block 13, Parcel 29 located at 468 Gaither Road, Sykesville, Maryland.

During that inspection she observed sewage draining into a stream from your house.

At that time she met with Mrs. Norris and discussed the problem. She was informed that the Health Department had observed the problem, and that repair or replacement of your existing system would be necessary.

As the overflowing sewage into the stream creates a condition which is, or may be hazardous to the public health, you are hereby ordered to repair or replace the system within thirty (30) days of receipt of this letter. To abate this unhealthy nuisance you must:

1. Secure a permit to repair the system.
2. Have ground opened up for inspection so Sanitarian can recommend the repair system.
3. Have the system repaired, inspected and approved by the Health Department.

If you believe that the condition described above is not and could not be a hazard to health, or that the Health Department is not acting in compliance with pertinent laws and regulations, you may request a formal hearing before the Board of Health within ten (10) days of receipt of this letter. If you wish to discuss

*— Rachael, please ✓ status of possible loans, take
no enforcement action without ✓ with me
Dane*

Mr. William T. Norris

- 2 -

June 15, 1981

the evidence, the regulations, or your individual circumstances, you are encouraged to request a meeting with us by calling 992-2330 and scheduling an appointment.

If you fail to respond to or comply with this order, we will, through due process, secure a summons for you to appear at District Court for trial. Failure to appear for trial will result in a warrant being issued for your arrest.

The investigation of this complaint and the enforcement powers of the Health Department are set forth in Section 12 of the Howard County Code, a copy of which is available for your inspection at this office.

The policy of the Health Department is to cooperate with the citizens of the County in seeking solutions to public and environmental health problems. If voluntary compliance is not successful, we are required to take necessary action to protect the health and safety of our citizens. We hope you will agree that the corrective actions are reasonable, prudent, and in the best interests of all concerned.

In closing, may I restate our willingness to discuss the problem. Please feel free to contact us.

Very truly yours,

David J. O'Neill, Director
Community Hygiene Program

DJO'N/RMR:hs

Click here for a plain text ADA compliant screen.



Maryland Department of Assessments and Taxation
HOWARD COUNTY
 Real Property Data Search

[Go Back](#)
[View Map](#)
[New Search](#)
[Ground Rent](#)

Account Identifier: District - 04 Account Number - 324501

Owner Information

Owner Name: SERRANO DANIEL
 SERRANO DEBORAH A T/E
Use: RESIDENTIAL
Principal Residence: YES
Mailing Address: 468 GAITHER RD
 SYKESVILLE MD 21784-5821
Deed Reference: 1) / 2393/ 702
 2)

Location & Structure Information

Premises Address 468 GAITHER RD
 SYKESVILLE 21784
Legal Description 1.1 ACRES
 468 GAITHER RD

Map	Grid	Parcel	Sub District	Subdivision	Section	Block	Lot	Assesment Area	Plat No: Plat Ref:
4	13	29						2	

Special Tax Areas Town Ad Valorem Tax Class NO A/V, NO M/P, RURAL FIRE TAX

Primary Structure Built	Enclosed Area	Property Land Area	County Use
1920	732 SF	1.10 AC	
Stories	Basement	Type	Exterior Siding
1	YES		SIDING

Value Information

	Base Value	Phase-in Assessments			
		Value As Of 01/01/2005	Value As Of 07/01/2004	Value As Of 07/01/2005	Value As Of 07/01/2005
Land:	101,000	231,000			
Improvements:	36,400	24,180			
Total:	137,400	255,180	137,400	176,660	
Preferential Land:	0	0	0	0	

Transfer Information

Seller: NORRIS WILSON T AND WF
Type: IMPROVED ARMS-LENGTH
Date: 09/20/1991
Deed1: / 2393/ 702
Price: \$100,000
Deed2:
Seller:
Type:
Date:
Deed1:
Price:
Deed2:
Seller:
Type:
Date:
Deed1:
Price:
Deed2:

Exemption Information

Partial Exempt Assessments	Class	07/01/2004	07/01/2005
County	000	0	0
State	000	0	0
Municipal	000	0	0

Tax Exempt: NO
Exempt Class:

Special Tax Recapture:

* NONE *

558
RMR

FILE Sewage draining DATE REPORTED 5/19/81

PROPERTY OWNER Mr. Ted Norris (Wilson T. Norris)

P.O. ADDRESS 468 Gaither Road Sykesville, Md TELEPHONE 489-4701

DIRECTIONS TO PROPERTY Come off of 32 into Sykesville, left on Farsyth rd, right on Gaither rd. Second house from the bridge on the left.

INFORMANT Mr. Dewey Brke 854-6637
440 Gaither rd.
Sykesville, Maryland 21784

Mr. Norris' sewage is running from his property out onto Gaither Rd.

map 4, blk 13, parcel 29 E.O. 4
416/13 1.10 ac.

CONDITION FOUND sewage draining into stream through
underground pipe from house to Gaither Rd. 3:45 6/10/81

ACTION TAKEN Bill 33 6/12/81 RMR
30 days - Repair / replace order

FINAL DISPOSITION

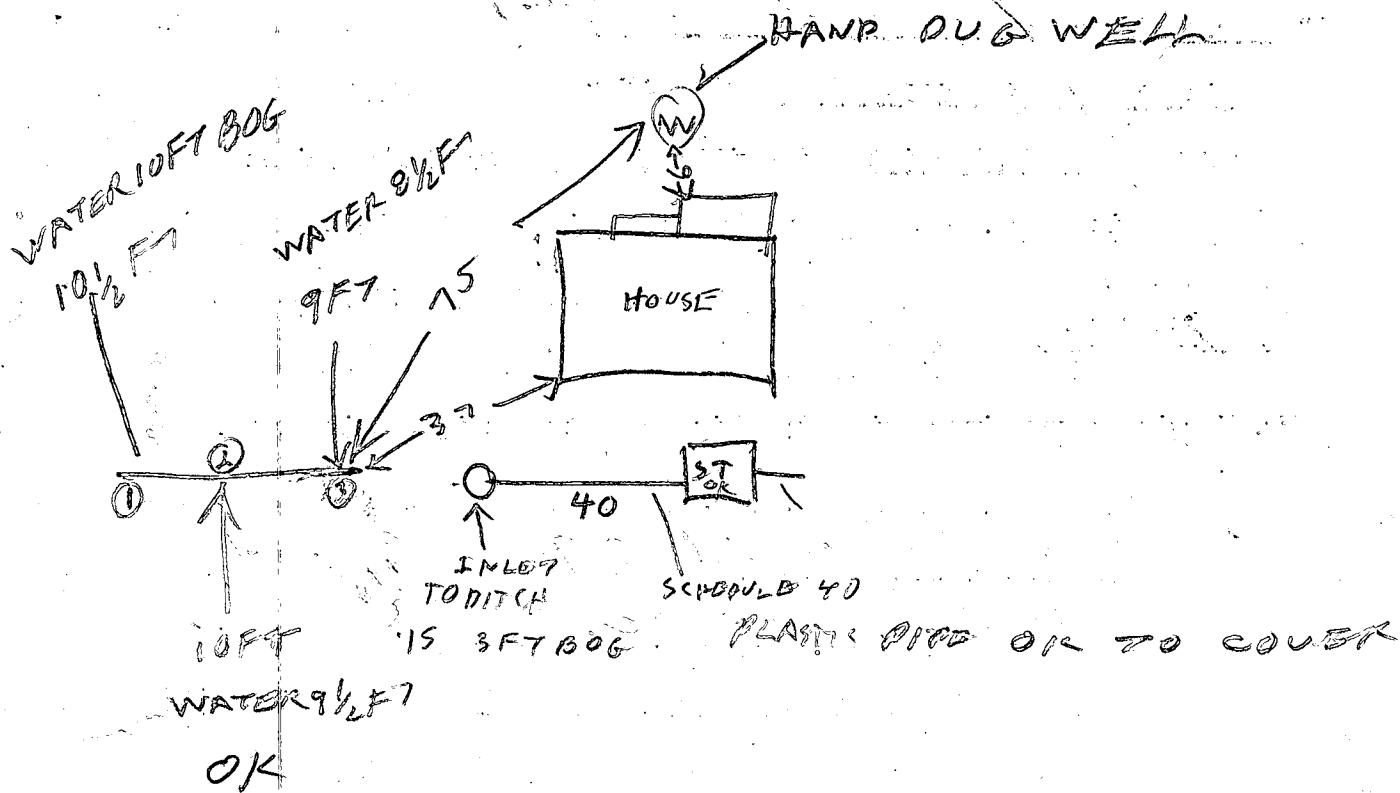

- POINT ① = TOP 6 FT CLAY BUT 4 1/2 FT SANDY
- POINT ② = TOP 5 1/2 FT CLAY BUT 3 1/2 FT SANDY
- POINT ③ = TOP 6 FT CLAY BUT 3 FT SANDY

9/16/81 CALLED F.S. HE SAID PUT 2 FT DIAT IN DITCH & THEN OUT IN STONE EVEN THOUGH IT WILL BE LESS THAN 5 FT OF STONE IN DITCH . ONLY 3-4 FT STONE

SEE PAGE ① & ② OF PERMIT

170' ±

APPROVED

WALK-THRU BUILDING PERMIT

BP# 800153597 PA# 31467

APP. SAN KDB DATE: 5/3/05

DESC. OF WORK: enclose existing patio - not getting close to well

265' ±

GRAVEL DRIVE

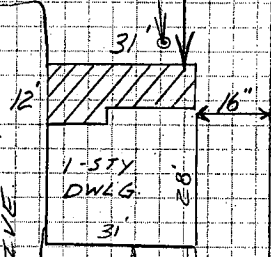

WELL

31'

12'

1-STY DWLG.

16'

28'

31'

SEPTIC

108' ±

120' ±

265' ±

1:40
SCALE.

Client: SERRANO # 36185

Date: 4-26-05

Designer: G

THIS DRAWING IS THE PROPERTY OF PATIO ENCLOSURES, INC. ALL RIGHTS RESERVED, DUPLICATION OF THIS DRAWING AND DESIGN IN ANY FORM IS NOT PERMITTED WITHOUT THE EXPRESSED WRITTEN CONSENT OF PATIO ENCLOSURES, INC.

Not to Scale
Conceptual Drawings Only

