

PERMIT

P 31343

A REPAIR

SEWAGE DISPOSAL SYSTEM

MARYLAND STATE DEPARTMENT OF HEALTH

HOWARD COUNTY

8/3/81

ELLICOTT CITY

DISTRICT 5th

DATE 4/27/81

ALO Contractors

IS PERMITTED TO INSTALL ALTER X

ADDRESS 13938 Highland, Maryland, Clarksville, Md. PHONE 596-9394

SUBDIVISION Riverside Estates ROAD 10735 Cleo's Court LOT 37, Blk. H

PROPERTY OWNER Bill Thomas home: 596-9518 work: Wash. D.C. 694-1223 Mrs. work: 820-712-3070 995-0771

ADDRESS 10735 Cleo's Court, Columbia, Md.

SPECIFICATIONS Please inform owner when repair perc is to be. S.S.

SEPTIC TANK CAPACITY _____ GALLONS.

DRAIN FIELD _____ DEPTH _____ FEET. BOTTOM AREA _____ SQ. FT.

DEEP TRENCH _____ DEPTH _____ FEET. BOTTOM AREA _____ SQ. FT.

SEEPAGE PITS _____ ABSORBENT SIDE-WALL AREA _____ SQ. FT.

INLET PIPE _____ FT. BELOW ORIGINAL GRADE. MAXIMUM DEPTH _____ FT. BELOW ORIGINAL GRADE.

EFFECTIVE DEPTH AT _____ FT. BELOW ORIGINAL GRADE.

LOCATE DISPOSAL AREA _____ FT. FROM _____ LOT LINE AND _____ FT. FROM _____ LOT LINE AS SEEN WHEN FACING LOT FROM _____

REPAIR - CALL FOR INSPECTION WHEN GROUND IS OPENED UP SO SANITARIAN CAN RECOMMEND REPAIR.

Drywell inlet @ 4 1/2' below grade; max depth 15' below grade & 60' diameter
in hole #6 per S.S. & S.K.

PLANS APPROVED BY Palmer F. Wine DATE April 27, 1981

COVER NO WORK UNTIL INSPECTED AND APPROVED.

NEITHER THE HOWARD COUNTY COUNCIL NOR THE HEALTH DEPARTMENT IS RESPONSIBLE FOR THE SUCCESSFUL OPERATION OF ANY SYSTEM.

NOTE: IF TRENCH IS USED CALL FOR INSPECTION BEFORE PLACING GRAVEL IN TRENCH.

NOTE: NO DRY WELL SHALL EXCEED 15 FOOT IN DIAMETER.

NOTE: ALL PIPE FROM HOUSE TO DISPOSAL AREA MUST BE CAST IRON.

PERMIT VOID AFTER THREE YEARS.

NOTE: INSTALL STAND PIPE ON SEPTIC TANK AND DRY WELL. STAND PIPES MUST BE 8 INCHES IN DIAMETER. CAST IRON, CONCRETE OR TERRA COTTA ACCEPTED.

*INSTALLER IS RESPONSIBLE FOR OBTAINING FINAL APPROVAL ON THIS PERMIT.

ON Public H₂O

A 31343

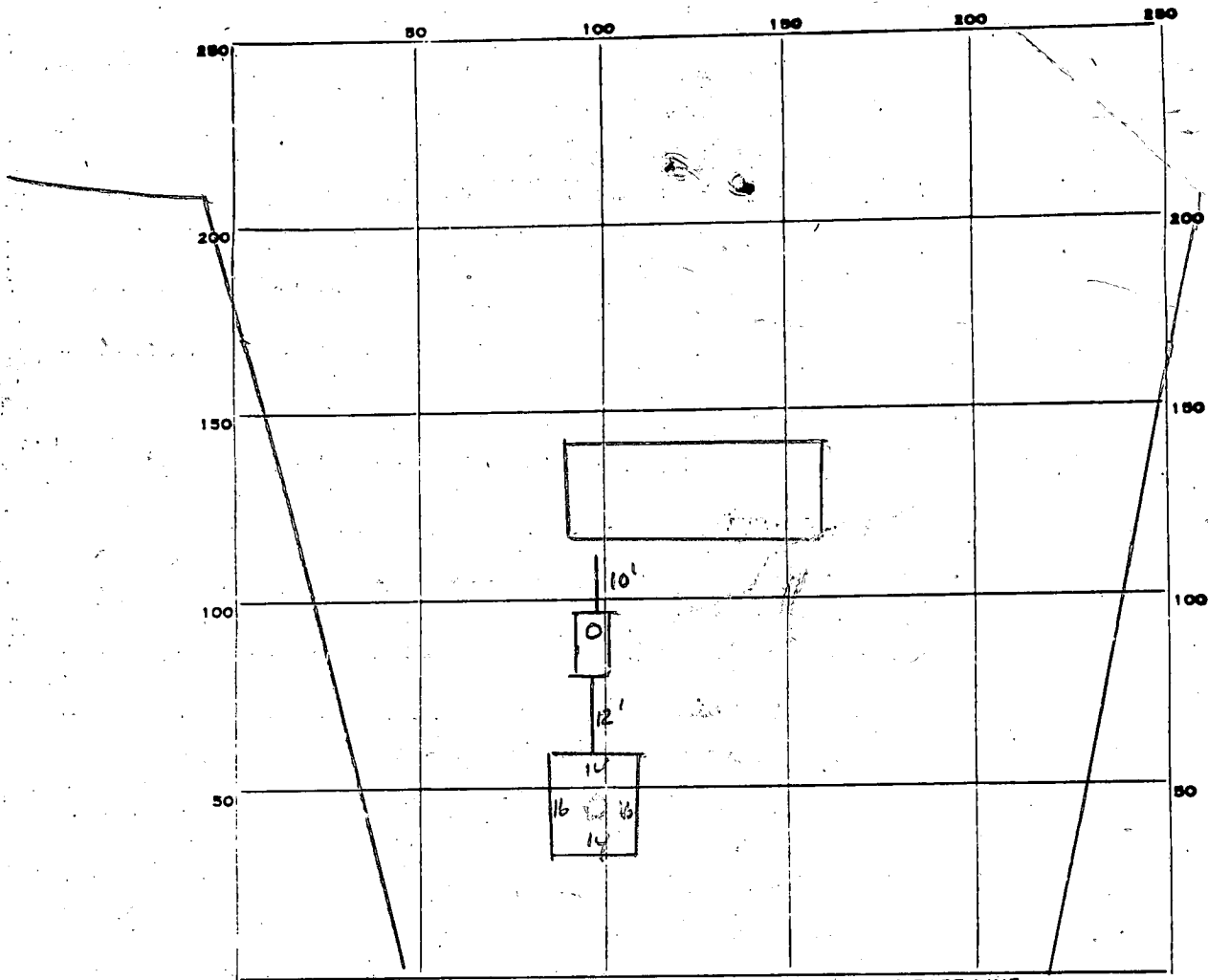

INDICATE NORTH. - NAME ADJOINING ROADWAY AS BASE LINE.

PERMIT CARD

SEPTIC TANK, LEVEL

CLEANOUTS ST | DW

DISTRIBUTION BOX, LEVEL _____

TILE FIELD, DEPTH _____ FT. TRENCH WIDTH _____ FT.

GRAVEL DEPTH _____ IN. TOTAL LENGTH _____ FT.

NUMBER OF TRENCHES _____ TOTAL BOTTOM AREA _____

SEEPAGE PITS, INSIDE DIAMETER 60' FT. ^{Effective} DEPTH BELOW INLET 8 1/2 FT. _{inlet 4 1/2} _{Depth 15'}

ABSORBENT AREA 510 SQ. FT.

REMARKS 7/27/81 OK to cover Tank on House sewer, need clean out on DW + House connection for final SR. 7/27/81 4:15 pm
 Come OK to cover work DW clean out not in place but at site. Need house connection for final check for DW clean out at about time SR

DATE SYSTEM APPROVED _____ INSPECTOR _____

4/30/81
9:30 P.M.

APPLICATION

SEWAGE DISPOSAL TESTING

STATE OF MARYLAND - DEPARTMENT OF HEALTH AND MENTAL HYGIENE

A REPAIR

P _____

HOWARD COUNTY HEALTH DEPARTMENT
ENVIRONMENTAL HEALTH SERVICES
P.O. BOX 476 ELLICOTT, MARYLAND 21043
TELEPHONE: 992-2330

DISTRICT 5th.

DATE 4/27/81

TO: THE COUNTY HEALTH OFFICER
ELLICOTT CITY, MARYLAND

I, HEREBY, APPLY FOR THE NECESSARY TEST IN ORDER TO CONSTRUCT (OR RECONSTRUCT) A SEWAGE DISPOSAL SYSTEM.

PROPERTY OWNER Bill Thomas

ADDRESS 10735 Cleo's Court, Columbia, Maryland PHONE _____

PROPERTY LOCATION:

SUBDIVISION Riverside Estates LOT NO. 37, Block H

ROAD AND DESCRIPTION 10735 Cleo's Court

SIZE OF LOT ? TYPE BLDG. Existing House

THE SYSTEM INSTALLED UNDER THIS APPLICATION IS ACCEPTABLE ONLY UNTIL PUBLIC FACILITIES BECOME AVAILABLE.

I FULLY UNDERSTAND THE FEE CONNECTED WITH THE FILING OF THIS PERC TEST APPLICATION IS NON-REFUNDABLE UNDER

ANY CIRCUMSTANCES.

SIGNATURE OF APPLICANT /s/ Robert L. Orndorff for Bill Thomas

APPROVED BY _____ FOR _____ DATE _____

REJECTED BY _____ FOR _____ DATE _____

HOLD PENDING FURTHER TESTS _____ DATE _____

REASONS FOR REJECTION OR HOLDING _____

THIS IS NOT A PERMIT

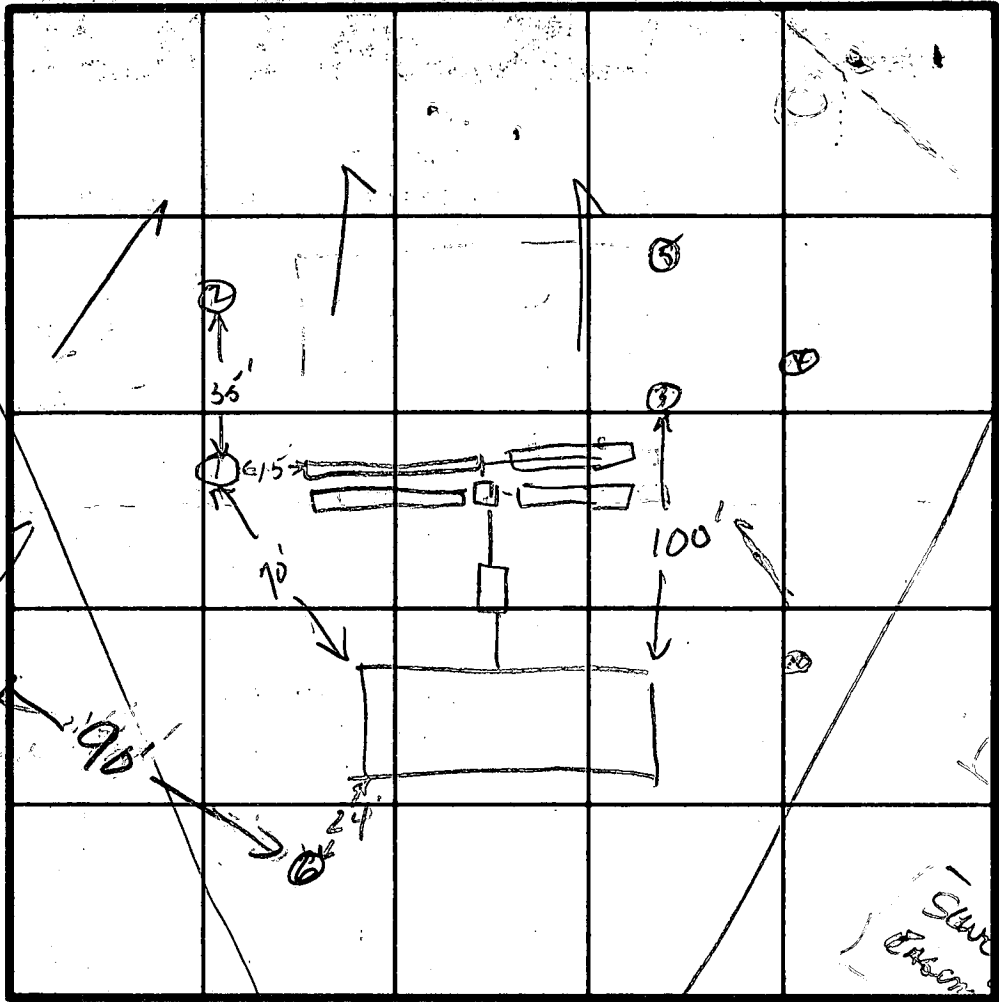

INDICATE NORTH - NAME ADJOINING ROADWAY AS BASE LINE.

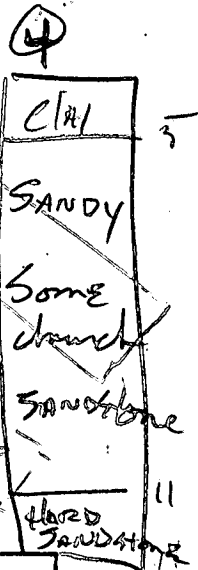

DATE	TEST NO.	DEPTH	PRE-WET		TEST - 1" DROP		TIME	
			START	STOP	START	STOP		
4/28/81	1	10'	Solid Rock		No prominent layer		Clay	
	2	1-7' Clay	7-9' Reddish-mica loam + clay mixed		9' solid white clay		Clay	
	3 S	4'	3:15	abort	3:35	little perl	Fail	
	SA	5'	3:38	abort	3:58	little perl	Fail	
	SB	6'	3:58	abort	4:18	1/4 in	Fail	
	3D	12'						
5/14/81	4 S	5'	2:26	3:26				
	D	11'						
	5	9'	Clay to 6 1/2'		Sand + clay to 9'		Clay	
	6 M	6 1/2'	3:08	3:13	3:13	3:23	Brown very sandy loam	
	D	18'	BROWN Very sandy loam are out 1' from					Clay Brown very sandy loam

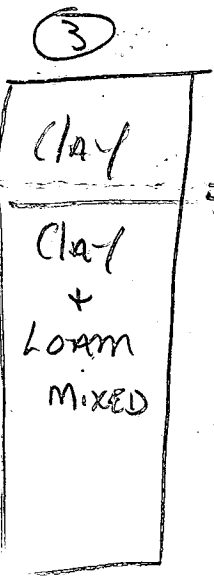

REMARKS: All systems of adjoining lots, Family of 4 children 18' 2 adults high water usage

TESTED BY: _____ ALSO PRESENT: 5/14/81 S. HALLIE Bunker

2/27/81/30

4/26/79
4/29/79 if possible
if not 4/30/79

File

P 29627
A 24272

PERMIT

SEWAGE DISPOSAL SYSTEM

MARYLAND STATE DEPARTMENT OF HEALTH*

HOWARD COUNTY

ELLICOTT CITY

DISTRICT 5th

INDEXED

DATE 3/28/79

5/1/79
5/3/79
Gene

Robert L. Orndorff

IS PERMITTED TO INSTALL ALTER

ADDRESS: 9401 5th Street, Laurel, Md. 20810

PHONE 725-4969

SUBDIVISION Riverside Estates

ROAD 10735 Cleo's Court

LOT 37, Block H

PROPERTY OWNER Stanley Halle bldg. (Wm. F. Thomas occupant 2/25/81)

ADDRESS _____

SPECIFICATIONS 4 bedrooms

SEPTIC TANK CAPACITY 1250 GALLONS

DRAIN FIELD _____ DEPTH _____ FEET, BOTTOM AREA _____ SQ. FT.

DEEP TRENCH _____ DEPTH _____ FEET, BOTTOM AREA _____ SQ. FT.

SEEPAGE PITS _____ ABSORBENT SIDE-WALL AREA _____ SQ. FT.

INLET PIPE _____ FT. BELOW ORIGINAL GRADE. MAXIMUM DEPTH _____ FT. BELOW ORIGINAL GRADE

EFFECTIVE DEPTH AT _____ FT. BELOW ORIGINAL GRADE.

LOCATE DISPOSAL AREA 285 FT. FROM front LOT LINE AND 120 FT. FROM right LOT LINE AS SEEN WHEN FACING LOT FROM the front.

Tile field to have 1 ft. of stone - be 3 ft. wide - 4 ft. deep - be 10 ft. apart

center-to-center and follow contour of ground. Distribution box to be used.

System to contain 130 sq. ft. per bedroom sidewall area.

PLANS APPROVED BY Robert T. Moorefield

DATE 7/21/77

COVER NO WORK UNTIL INSPECTED AND APPROVED.

NEITHER THE HOWARD COUNTY COUNCIL NOR THE HEALTH DEPARTMENT IS RESPONSIBLE FOR THE SUCCESSFUL OPERATION OF ANY SYSTEM.

NOTE: IF TRENCH IS USED CALL FOR INSPECTION BEFORE PLACING GRAVEL IN TRENCH.

NOTE: NO DRY WELL SHALL EXCEED 15 FOOT IN DIAMETER.

NOTE: ALL PIPE FROM HOUSE TO DISPOSAL AREA MUST BE CAST IRON.

PERMIT VOID AFTER THREE YEARS.

NOTE: INSTALL STAND PIPE ON SEPTIC TANK AND DRY WELL. STAND PIPES MUST BE 6 INCHES IN DIAMETER. CAST IRON, CONCRETE OR TERRA COTTA ACCEPTED.

***INSTALLER IS RESPONSIBLE FOR OBTAINING FINAL APPROVAL ON THIS PERMIT.**

493

A 24272

1 MAY 79

OK to backfill entire system except for trench ④. Call for final when gravel added to trench ④. (GUK)

SIDE VIEW

sanitary Y with 9/0

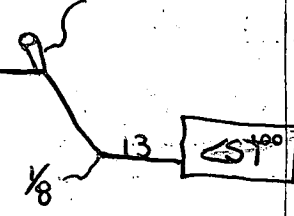

173
31520
173
-180 (80)
53
x3
640

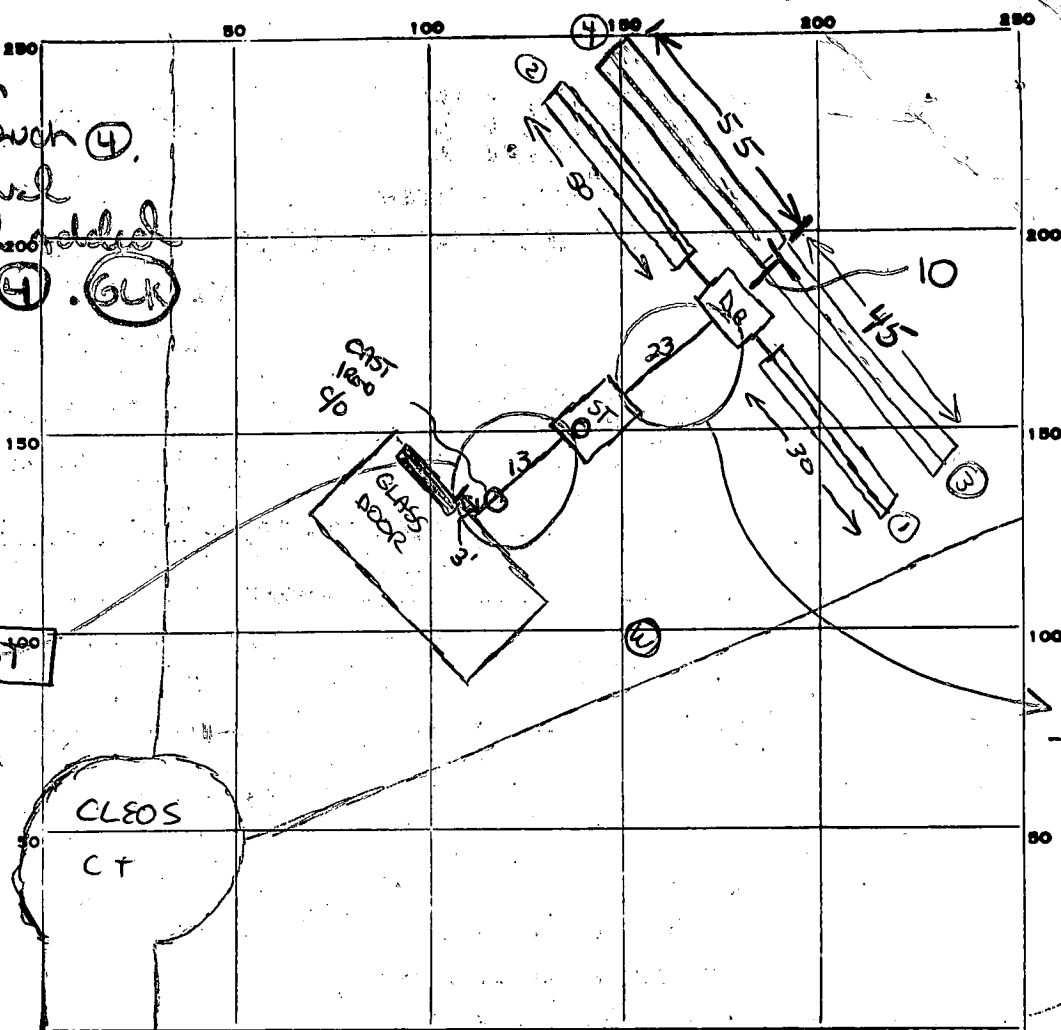

SIDE

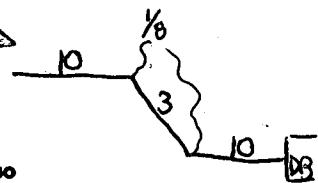

INDICATE NORTH. - NAME ADJOINING ROADWAY AS BASE LINE.

PERMIT CARD installer 4/27 5/1 5/3/79 ✓ at front window ST
4/26

SEPTIC TANK, LEVEL 1250 TAPERED CLEANOUTS ✓ terra cotta

DISTRIBUTION BOX, LEVEL 2x2x1 needs baffle ✓

TILE FIELD, DEPTH ① ② ③ ④ 4 4 4 4 FT. TRENCH WIDTH ① ② ③ ④ 3' 3' 3' 3' FT.

GRAVEL DEPTH ① ② ③ ④ 2 2 2 2 FT. TOTAL LENGTH ① ② ③ ④ 30-50-45-55 FT. 180 TOTAL

NUMBER OF TRENCHES 4 TOTAL BOTTOM AREA ±540

SEEPAGE PITS, INSIDE DIAMETER NA FT. DEPTH BELOW INLET — FT.

ABSORBENT AREA 1080 ± SQ. FT.

REMARKS 26 Apr. 79 No elevations or plat available. OK to gravel trenches ①+② being sure to "rough-up" bottoms. Call for next inspection when's All sewers are cemented & properly supported, distribution box filled with water to check for levelness, and when trenches ③+④ are excavated. (GUK)

27 Apr. 79 - OK to add gravel to trenches ①, ②, & ③ AND TO BACKFILL FROM house up to distribution box only. Call when remaining trench is excavated. (GUK) SEE ABOVE LEFT.

DATE SYSTEM APPROVED 5/3/79 INSPECTOR C.B. [Signature]

APPLICATION

A 24272

SEWAGE DISPOSAL TESTING

P _____

STATE OF MARYLAND - DEPARTMENT OF HEALTH AND MENTAL HYGIENE

HOWARD COUNTY HEALTH DEPARTMENT
ENVIRONMENTAL HEALTH SERVICES
P. O. BOX 476, ELLICOTT CITY, MARYLAND 21043
TELEPHONE: 465-5000, EXT. 356

DISTRICT 5th
DATE July 29, 1976

TO: THE COUNTY HEALTH OFFICER
ELLICOTT CITY, MARYLAND

I, HEREBY, APPLY FOR THE NECESSARY TEST IN ORDER TO CONSTRUCT (OR RECONSTRUCT) A SEWAGE DISPOSAL SYSTEM.

PROPERTY OWNER Residential Developers, Inc.
P. O. Box 700, Seabrook, Md., 20801 c/o William Miller
ADDRESS 17512 Bowie Mill Rd., Derwood, Md. 20855 PHONE 301-948-5115

PROPERTY LOCATION:

SUBDIVISION Riverside Estates LOT NO. 16 Block "E"

ROAD AND DESCRIPTION From Rt. 29, South of Rt. 32 1/2 mile, West on Vista Rd.,
3 blocks to Newberry Dr., left to job.

SIZE OF LOT one acre plus TYPE BLDG. 4 bedroom + -
NUMBER OF BEDROOMS

IF NOT SINGLE RESIDENCE DESCRIBE Single family dwelling

THE SYSTEM INSTALLED UNDER THIS APPLICATION IS ACCEPTABLE ONLY UNTIL PUBLIC FACILITIES BECOME AVAILABLE.

SIGNATURE OF APPLICANT _____

APPROVED BY _____ FOR _____ DATE _____
(KIND OF SYSTEM)

REJECTED BY _____ FOR _____ DATE _____
(KIND OF SYSTEM)

HOLD PENDING FURTHER TESTS _____ DATE _____

REASONS FOR REJECTION OR HOLDING _____

THIS IS NOT A PERMIT

④
 0
 4 | clay

 12 | less clay

⑤
 0
 clay/sand
 some clay
 ↓ decreasing
 12 ——— Hard —

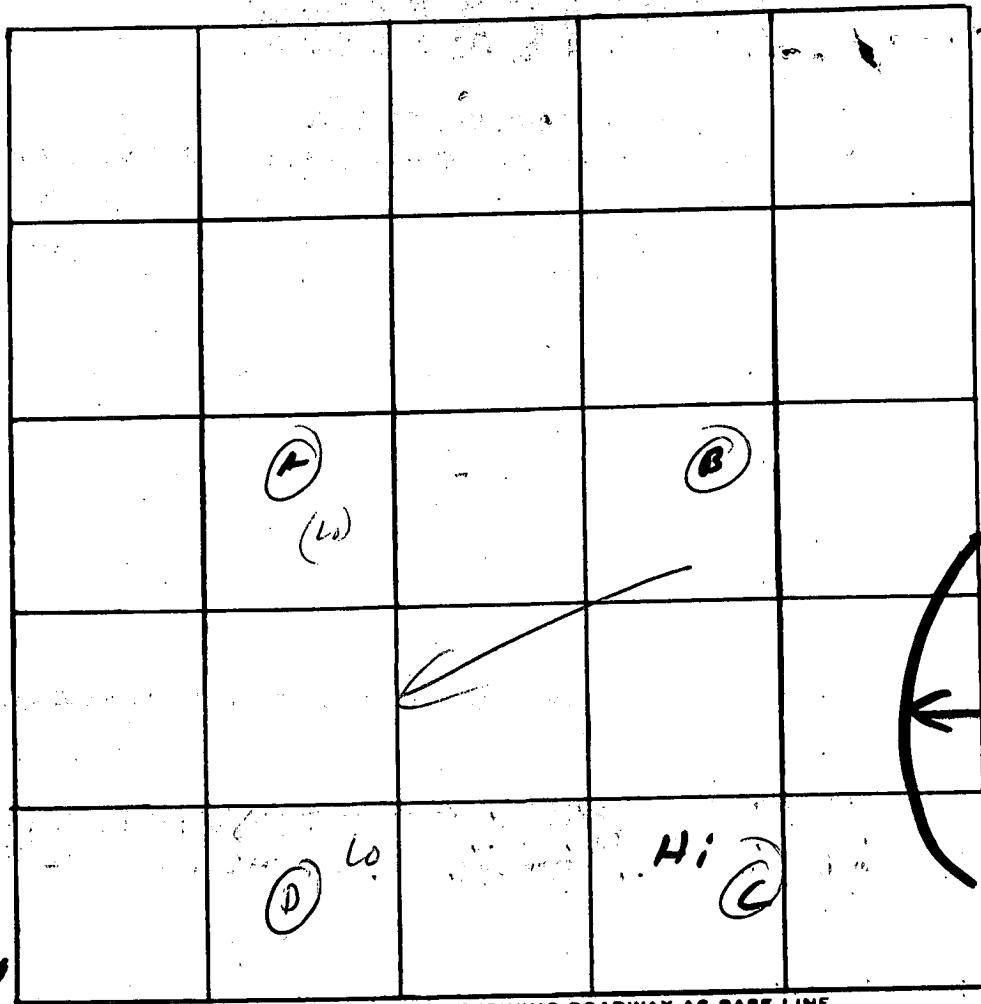

INDICATE NORTH. - NAME ADJOINING ROADWAY AS BASE LINE.

$\bar{t} = 12$

DATE	TEST NO.	DEPTH	PRE-WET		TEST - 1" DROP		TIME
			START	STOP	START	STOP	
11/10/76	A	4	2 ¹²	2 ¹²	2 ¹²	2 ²¹	9
	A ₁	12	2 ¹²	2 ²⁰	2 ²⁰	2 ⁴²	22
	B	12	vis	same			
	C	4	2 ³⁰	2 ³²	2 ³²	2 ³⁵	3
	C ₁	12	2 ³⁰	2 ³²	2 ³²	2 ³²	5
	D	3	1 ⁴⁴	1 ⁴⁸	1 ⁴⁸	1 ⁵⁷	9
	D ₁	12	1 ⁴⁵	1 ⁵⁰	1 ⁵⁰	2 ¹⁰	20

$\frac{68}{6}$

REMARKS _____

TYPE OF SOIL _____

TESTED BY R.M. ALSO PRESENT: Barth

B 1 6206 SEQUENCE NO. (WRA USE ONLY)

STATE OF MARYLAND
WATER RESOURCES ADMINISTRATION
TAWES STATE OFFICE BLDG., ANNAPOLIS, MARYLAND 21401

WRA PERMIT NUMBER
40-23-2942

APPLICATION FOR PERMIT TO DRILL WELL **FILL IN THIS FORM COMPLETELY**

DATE RECEIVED (WRA USE ONLY)
9/25/78
9:30 A.M.

OWNER
 COL 15 LAST NAME: Walter Stanley COL 34 FIRST NAME: Malcolm

STREET OR RFD
 COL 36: 9432 Annandale Rd COL 55: US 1

POST OFFICE
 COL 57: San Louis COL 76: MD 21001

B 1 CONTINUED **DRILLER INFORMATION**

1 2 3 (SEQ. NO.) 6

DATE: Aug 11, 1978 LICENSE NUMBER: 238

FIRST NAME: Joseph L. Mayne DRILLER LAST NAME: Mayne

SIGNATURE: Joseph L. Mayne

B 3 **LOCATION OF WELL**

1 2 3 (SEQ. NO.) 6

COUNTY: Howard (DO NOT ABBREVIATE COUNTY NAME) 21

SUBDIVISION: Remondito Estates 23 42

SECTION: 4 LOT: 27 44 46 48 50

NEAREST TOWN: Atholton 52

MILES FROM TOWN (ENTER 0 IF IN TOWN): 1.5 73 76 77 78

B 2 **WELL INFORMATION**

1 2 3 (SEQ. NO.) 6

MAXIMUM PUMPING RATE (GALLONS PER MINUTE): 5 8 12

AVERAGE DAILY QUANTITY NEEDED (GALLONS PER DAY): 750 14 20

USE FOR WATER (CIRCLE APPROPRIATE BOX)

HOME (SINGLE OR DOUBLE HOUSEHOLD UNIT ONLY)

FARMING, AGRICULTURE, IRRIGATION

INDUSTRIAL, COMMERCIAL, STATE AND FEDERAL GOVERNMENT.

MUNICIPAL WATER SUPPLY } MUST HAVE STATE HEALTH DEPT. APPROVAL

PRIVATE WATER COMPANY }

TEST

B 4 **DIRECTION FROM TOWN**
 (CIRCLE APPROPRIATE BOX)

1 2 3 (SEQ. NO.) 6

NORTH EAST N.E. NORTHEAST S.E. SOUTHEAST

SOUTH WEST N.W. NORTHWEST S.W. SOUTHWEST

NEAR WHAT ROAD: Close Court

ON WHICH SIDE OF ROAD (CIRCLE APPROPRIATE BOX): WEST 30

DISTANCE FROM ROAD (ENTER DISTANCE AND CIRCLE APPROPRIATE BOX): 113 34 37 38 39

APPROXIMATE DEPTH OF WELL: 180 FEET

APPROXIMATE DIAMETER OF WELL: 6 (NEAREST INCH)

METHOD OF DRILLING USED (CIRCLE APPROPRIATE METHOD)

BORED (OR AUGERED) JETTED DRIVEN

80-37 AIR-ROTARY AIR-PERCUSSION ROTARY (HYDRAULIC ROTARY)

CABLE REVERSE-ROTARY DRIVE-POINT

OTHER (DESCRIBE):

REPLACEMENT OR DEEPEMED WELLS (CIRCLE APPROPRIATE BOX)

THIS WELL WILL NOT REPLACE AN EXISTING WELL

THIS WELL WILL REPLACE A WELL THAT WILL BE ABANDONED AND SEALED

THIS WELL WILL REPLACE A WELL THAT WILL BE USED AS A STANDBY

THIS WELL WILL DEEPEM AN EXISTING WELL PERMIT NUMBER OF WELL TO BE REPLACED OR DEEPEMED (IF AVAILABLE):

NOT TO BE FILLED IN BY DRILLER (WRA USE ONLY)

APPROPRIATION PERMIT NUMBER: 54 ENGINEER REVIEW DISTRICT NO.: 63

FORCE: 67 WRITE INITIALS IN BOX: AS CONDITIONS: 70 71 72 73 74 75 76 77 78 79

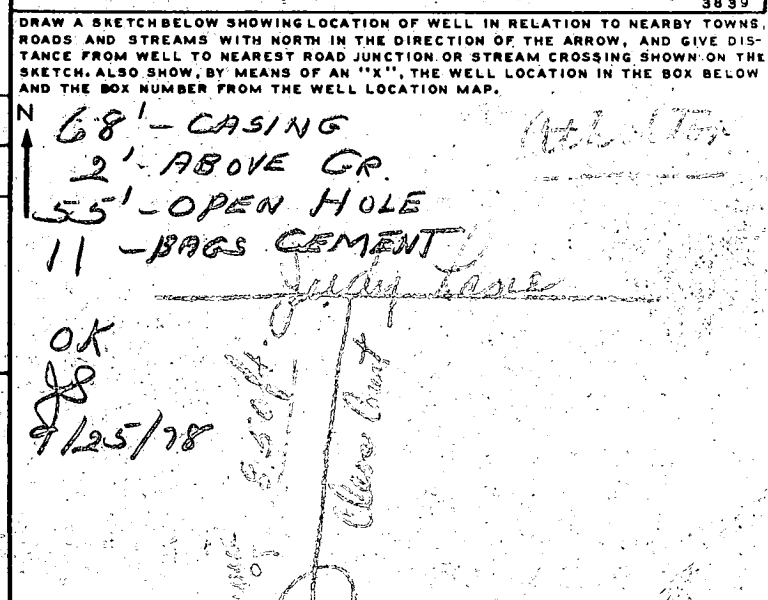

B 4 CONTINUED **HEALTH DEPARTMENT APPROVAL**

1 2 3 (SEQ. NO.) 6

DATE: 09/17/78 COUNTY NAME: Howard COUNTY NO.: W28713

APPROVED BY: Donald W. Monahan, Sanitarian

BOX NUMBER

E: 630

N: 480

NORTH COORDINATE: 50 51 52 53 54 55

EAST COORDINATE: 57 58 59 60 61 62 63

ELEVATION AT WELL HEAD (FEET): 65 66 67 68

B 5 SPECIAL CONDITIONS 8-63 (WRA USE ONLY)

1 2 3 (SEQ. NO.) 6

SITE INSPECTION SHEET

CALLED IN 8/8/94

OWNER: WM THOMAS 531-2428

DATE REQUESTED: 8/10/94 3:00

ADDRESS: 10735 CLEO'S CT 301-596-9518

DRILLER: _____

COLUMBIA MD 21044

WELL TAG # _____

COUNTY # _____

PROPOSAL: EXPERIENCING WATER QUALITY PROBLEMS - HAS PETITIONED

FOR EMERGENCY CONNECTION TO PUBLIC SUPPLY - NEEDS HEALTH DEPT COMMENT,

SEDIMENT & ODOR PROBLEMS

WILL PROVIDE DOCUMENTATION LOCATION DIAGRAM

AND HAVE PRIVATE LAB SAMPLE FOR BACT-NIT-TURB.

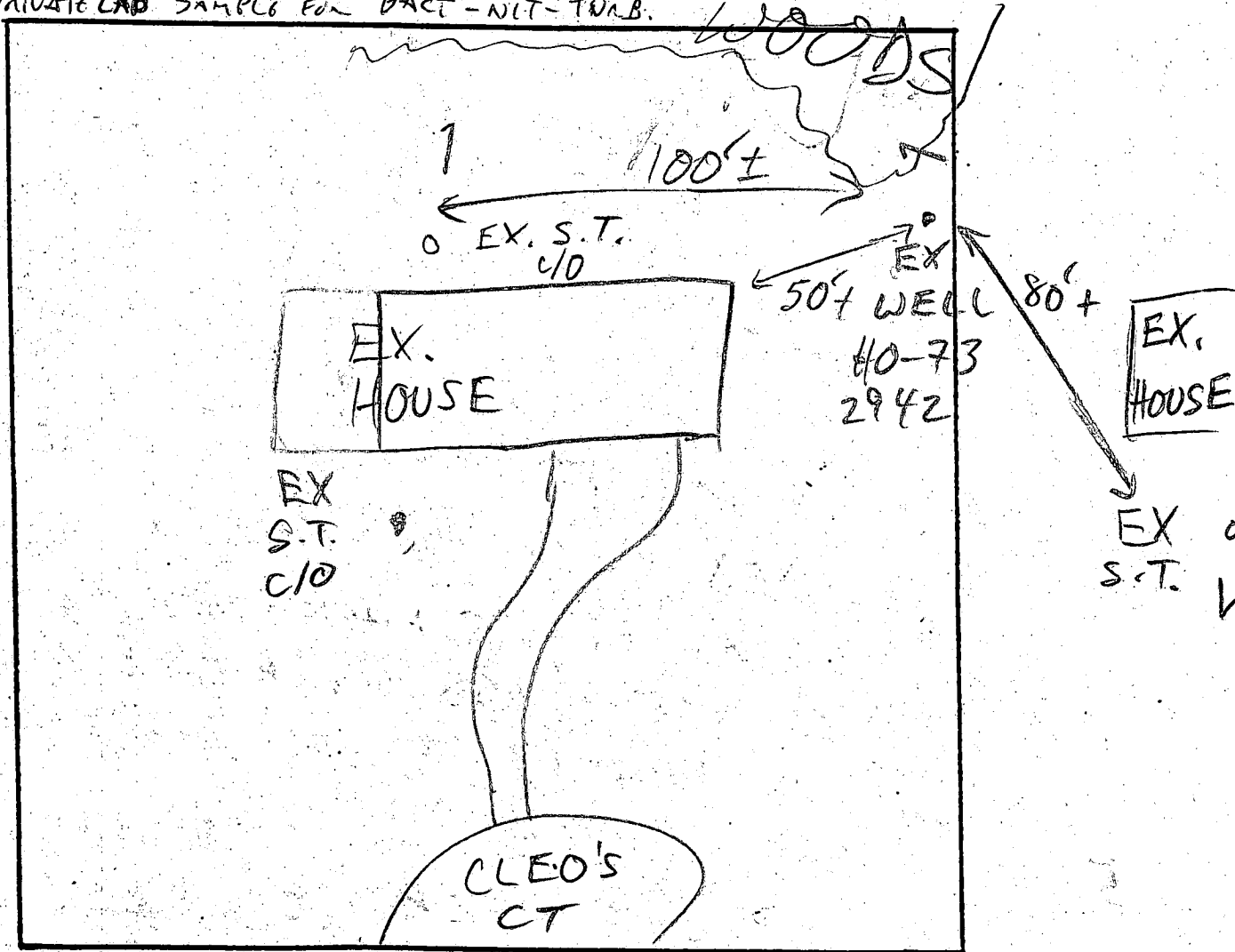

COMMENTS: 8/10/94 OWNER REPORTS ODOR PROBLEMS (~3 YEARS AGO)

@ SAME TIME AS BLASTING FOR NEW SEWER LINE FOR NEW SURD.

IN NEIGHBORHOOD; SEDIMENT PROBLEMS BEGAN ~2-2½ YEARS AGO.

NO H₂O QUALITY PROBLEMS AT ALL PRIOR TO BLASTING; OFFENSIVE

DATE: 8/8/94 ODOR IMMEDIATELY NOTICEABLE - INSPECTOR: IN GLASS OF HOT

WATER; ADVISED WATER SAMPLER (EXCELLO EXTERMINATING FOR

MARYLAND MEDICAL) TO TEST FOR
STANDARD ICOP RUN (BACT, TURB, NIT); ADVISED
OWNER TO DRINK AS MUCH BOTTLED AS POSS.; CAN
USE BOILED IF NEEDED, BUT PREFER NOT IF
SAMPLE RESULT SHOWS FECAL CONTAMINATION; ADVISED
OWNER THAT UPON SAMPLE RESULTS, MY RECOMMENDA-
TION IS FOR SUPPORT OF EMERGENCY CONN. TO
PUB. H₂O SUPPLY

M.R.

William F. Johnson

OWNER
RETURN 8/17/94

8/12/94 7.8 pH 0.94 Turb. 0.8 Nitrate
Acct: 215119

12/19/94 T/C w/OWNER: PUBLIC H₂O ^{LINE} TO BE ~~OPERATED~~
EXTENDED IN SPRING 1995; EX. WELL
TO TENTATIVELY BE MAINTAINED FOR
OUTDOOR USE; ~~MR~~ CHECK BACK IN 6 MOS.
FOR CONFIRMATION OF WELL MAINTENANCE MR

7/18/95 T/C w/OWNER: CO. WORK COMPLETE; HOUSE
CONN BY NEXT WEEK; WELL WILL BE
MAINTAINED FOR OUTDOOR PURPOSES ONLY MR

12/28/95 H₂O CONN COMPLETE; WELL BEING
MAINTAINED FOR OUTDOOR USE - OK
FILE CLOSED MR



HOWARD COUNTY HEALTH DEPARTMENT

Joyce M. Boyd, M.D., County Health Officer

August 12, 1994

Mr. William F. Thomas
10735 Cleos Court
Columbia, MD 21044

RE: Provision of Public Water
10735 Cleos Court
Riverside Estates, Lot 37

Dear Mr. Thomas,

This is to advise that the Howard County Health Department recommends provision of public water to the above-referenced property.

A site inspection was conducted on August 10, 1994. On that occasion, water from the on-site well was observed to be producing a clearly offensive hydrogen sulfide odor. Despite the presence of a filter, the problem has not been eliminated. Your testimony also indicated that sediment was also a problem, requiring replacement of a sediment filter once or twice monthly.

If public water is provided, then the existing well should be abandoned (filled and sealed). This well abandonment process can best be accomplished by a licensed well driller, who may perform the work without inspection; but, the driller must then file an abandonment report with this office. If this well abandonment is performed by any other private party, the work must be inspected and approved by a sanitarian from this office.

If you have any other questions, or if we can be of further assistance, please call me at 313-2640.

Very Truly Yours,

Mark E. Rifkin
Sanitarian
Water & Sewerage Program

MR

cc: Ronald Lepson, DPW
Charlotte Dryden, DPW
Ray Strucka, DPW
Jean Reed, DPW