

12/2/80  
12/5/80  
12/10/80  
12/11/80  
2 pm  
2 pm  
noon

approved 12/11/80  
Stayer

# PERMIT

P 3/053

SEWAGE DISPOSAL SYSTEM

A REPAIR

MARYLAND STATE DEPARTMENT OF HEALTH

HOWARD COUNTY

ELLICOTT CITY

DISTRICT \_\_\_\_\_

DATE 12/1/80

INDEXED

3C  
E  
216

M.D. Bennett Plumbing & Heating IS PERMITTED TO INSTALL  ALTER

ADDRESS 2218 Farringdon Road, Baltimore, Md. 21209 PHONE 486-7277

SUBDIVISION \_\_\_\_\_ ROAD 4380 Old Columbia Pike LOT \_\_\_\_\_

PROPERTY OWNER Michael Trias SPANISH STYLE HOUSE

ADDRESS 2 Truman Court, Baltimore, Maryland 21207

SPECIFICATIONS  
SEPTIC TANK CAPACITY 1000 GALLONS  
DRAIN FIELD DEPTH 4 FEET. BOTTOM AREA 360 SQ. FT.  
DEEP TRENCH DEPTH \_\_\_\_\_ FEET. BOTTOM AREA \_\_\_\_\_ SQ. FT.  
SEEPAGE PITS ABSORBENT SIDE-WALL AREA \_\_\_\_\_ SQ. FT.  
INLET PIPE 2 FT. BELOW ORIGINAL GRADE. MAXIMUM DEPTH 5 FT. BELOW ORIGINAL GRADE  
EFFECTIVE DEPTH AT 3 FT. BELOW ORIGINAL GRADE.

12/5/80 O.K. to install 2 separate septic systems. 360 sq ft of bottom area required in main system. 1800 sq ft of bottom area rigid in each water system.  
12/10/80 Total of 540 sq ft needed roughly 270 sq ft in each system O.K.

START LOCATE DISPOSAL AREA 50 FT. FROM BACK OF HOUSE LOT LINE AND 10 FT. FROM RIGHT LOT LINE AS SEEN WHEN

FACING LOT FROM OLD COLUMBIA RD

REPAIR - CALL FOR INSPECTION WHEN GROUND IS OPENED UP SO SANITARIAN CAN RECOMMEND

REPAIR. RUN TILE FIELD TOWARD THE

BACK OF THE LOT. A SEWAGE PUMP WILL BE  
NEEDED IF A BASEMENT TOILET IS INSTALLED IN

PLANS APPROVED BY Palmer F. Wine DATE 12/1/80

COVER NO WORK UNTIL INSPECTED AND APPROVED.

NEITHER THE HOWARD COUNTY COUNCIL NOR THE HEALTH DEPARTMENT IS RESPONSIBLE FOR THE SUCCESSFUL OPERATION OF ANY SYSTEM.

NOTE: IF TRENCH IS USED CALL FOR INSPECTION BEFORE PLACING GRAVEL IN TRENCH.

NOTE: NO DRY WELL SHALL EXCEED 15 FOOT IN DIAMETER.

NOTE: ALL PIPE FROM HOUSE TO DISPOSAL AREA MUST BE CAST IRON.

PERMIT VOID AFTER THREE YEARS.

NOTE: INSTALL STAND PIPE ON SEPTIC TANK AND DRY WELL. STAND PIPES MUST BE 6 INCHES IN DIAMETER. CAST IRON, CONCRETE OR TERRA COTTA ACCEPTED.

\*INSTALLER IS RESPONSIBLE FOR OBTAINING FINAL APPROVAL ON THIS PERMIT.

A 3/053

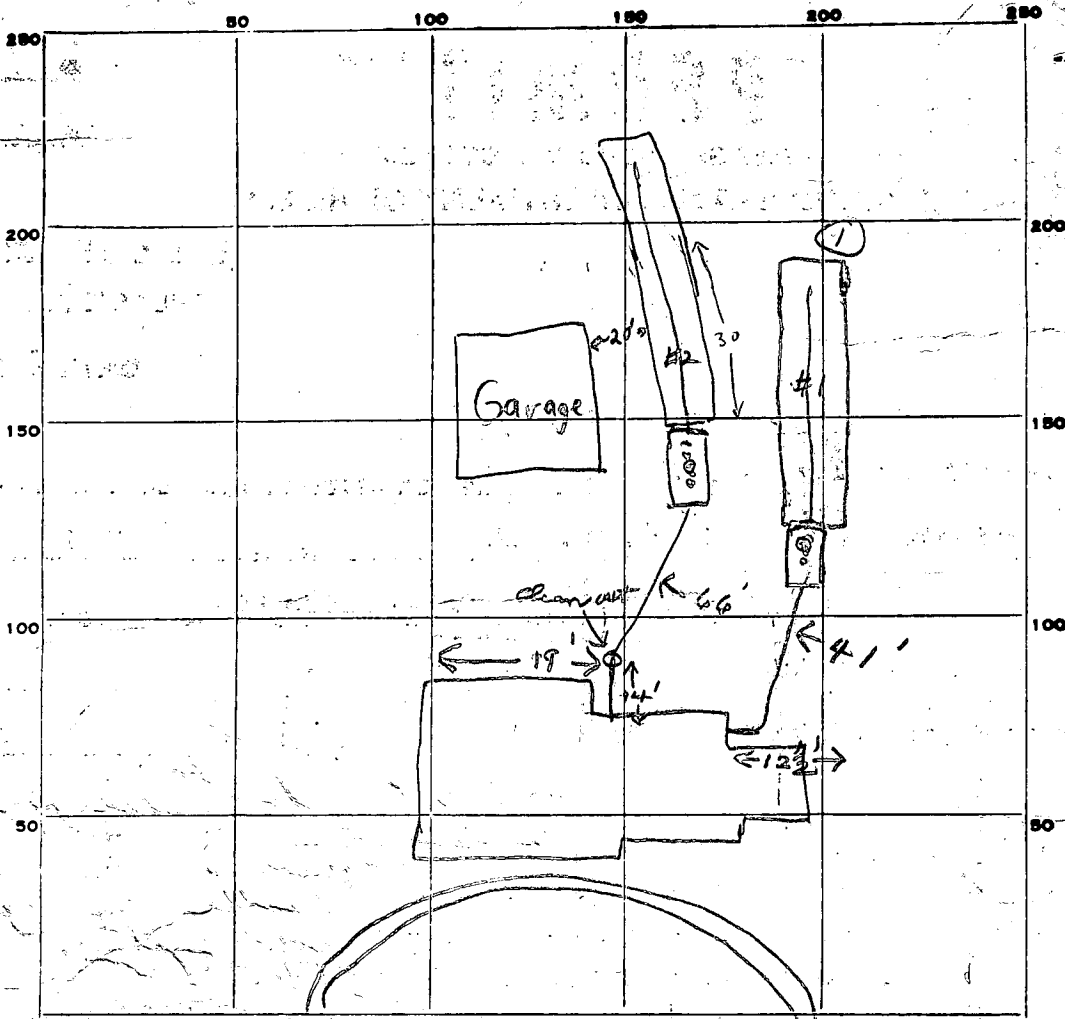

INDICATE NORTH - NAME ADJOINING ROADWAY AS BASE LINE.

020 Columbia Pike

PERMIT CARD

SEPTIC TANK, LEVEL

CLEANOUTS

ST ST  
✓ ✓

DISTRIBUTION BOX, LEVEL

TILE FIELD, DEPTH 05' 05' FT. TRENCH WIDTH 06' 06' FT.

GRAVEL DEPTH 3 FT. TOTAL LENGTH 036' 060' FT.

NUMBER OF TRENCHES 2 TOTAL BOTTOM AREA 5.76

SEEPAGE PITS, INSIDE DIAMETER \_\_\_\_\_ FT. DEPTH BELOW INLET \_\_\_\_\_ FT.

ABSORBENT AREA 576 SQ. FT.

REMARKS 12/2/80 SEE SEPARATE SHEET FOR RESULT OF VISUAL HOLE RH 12/5/80 O.K. to install separate septic tank & drain field for kitchen sink & laundry trays in basement F.S. section 12/9/80 OK to add gravel in no. #1 trench JB 12/10/80 a 30' of #2 trench is dug open, pipe in #1 trench, but pipe not yet covered gravel & paper. basement sewer installed & old base sewer cemented shut F.S. 12/11/80 OK to cover all work. JB

DATE SYSTEM APPROVED 12/11/80

INSPECTOR

Stayer

96  
60  
576

P 31053  
 TRIAS PROP  
 503  
 3  
 -5.6  
 9

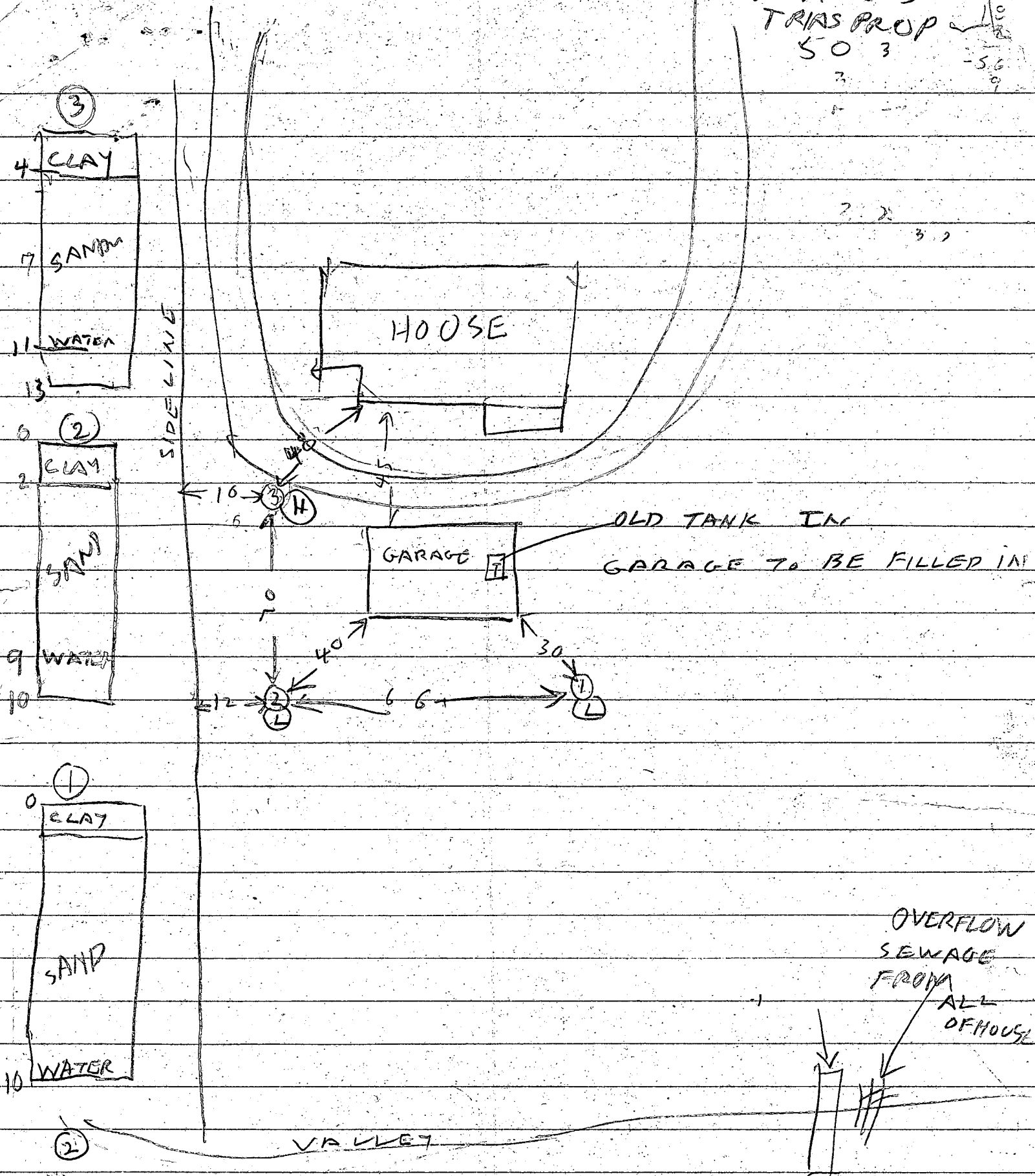

Test by  
 Raymond Hodges

also present Mr. TRIAS  
 Ways Rockland  
 (BACK HOE CO.)

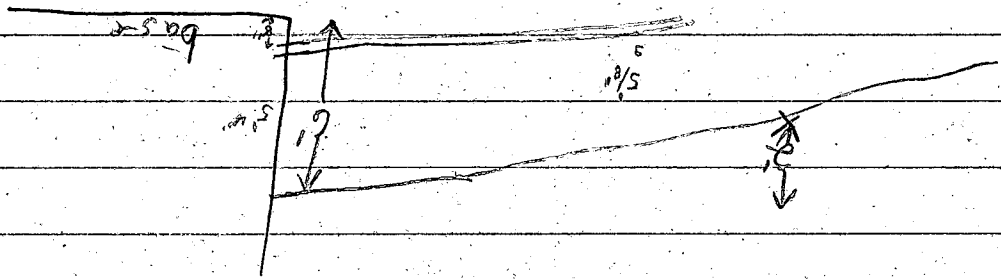

8  
20

January 6, 1981

Maryland National Mortgage Corporation  
P. O. Box 987  
Mail Stop - 020905  
Baltimore, Maryland 21203  
Attention: Ms. Jessica Maitzen

RE: Property -  
4380 Old Columbia Road

Dear Ms. Maitzen:

On December 11, 1980 representatives of this Department inspected and approved two septic systems on the referenced properties. The two systems were installed in order to abate two waste water overflows from separate portions of the plumbing system of the house.

The systems now meet all applicable State and local Health Codes.

Very truly yours,

Rachaelle M. Rash  
Community Hygiene Program

RMR:jr