

03-291-383

11/12/80 FILE APPROVED CBS

11/12/80 as soon as possible

# PERMIT

P 31019

A Repair

SEWAGE DISPOSAL SYSTEM

MARYLAND STATE DEPARTMENT OF HEALTH

HOWARD COUNTY

ELLICOTT CITY

DISTRICT 3rd

**INDEXED**

DATE 11/12/80

Jack Fyock IS PERMITTED TO INSTALL ALTER X

ADDRESS 13775 Triadelphia Road, Glenelg, Md. 21737 PHONE 988-9270

SUBDIVISION \_\_\_\_\_ ROAD 12785 Frederick Road LOT \_\_\_\_\_

PROPERTY OWNER Allen Van Sant third house past West Friendship Neighborhood Center on the left

ADDRESS \_\_\_\_\_

SPECIFICATIONS 3 bedrooms

SEPTIC TANK CAPACITY 1000 GALLONS

DRAIN FIELD \_\_\_\_\_ DEPTH \_\_\_\_\_ FEET, BOTTOM AREA \_\_\_\_\_ SQ. FT.

DEEP TRENCH \_\_\_\_\_ DEPTH \_\_\_\_\_ FEET, BOTTOM AREA \_\_\_\_\_ SQ. FT.

SEEPAGE PITS \_\_\_\_\_ ABSORBENT SIDE-WALL AREA \_\_\_\_\_ SQ. FT.

INLET PIPE \_\_\_\_\_ FT. BELOW ORIGINAL GRADE, MAXIMUM DEPTH \_\_\_\_\_ FT. BELOW ORIGINAL GRADE

EFFECTIVE DEPTH AT \_\_\_\_\_ FT. BELOW ORIGINAL GRADE.

LOCATE DISPOSAL AREA \_\_\_\_\_ FT. FROM \_\_\_\_\_ LOT LINE AND \_\_\_\_\_ FT. FROM \_\_\_\_\_ LOT LINE AS SEEN WHEN FACING LOT FROM

**REPAIR - Call for an appointment when ground is opened up and Sanitarian will**

**recommend the repair system. 15' x 15' dry well to be 20 ft. from right**

**side of house when looking at house from Route 144. Inlet to dry well to be 2 ft.**

**below original grade and maximum depth of 8 ft. only for dry well below original grade in area of perc hole (1 & 2).**

PLANS APPROVED BY Palmer F. Wine DATE 11/10/80

COVER NO WORK UNTIL INSPECTED AND APPROVED.

NEITHER THE HOWARD COUNTY COUNCIL NOR THE HEALTH DEPARTMENT IS RESPONSIBLE FOR THE SUCCESSFUL OPERATION OF ANY SYSTEM.

NOTE: IF TRENCH IS USED CALL FOR INSPECTION BEFORE PLACING GRAVEL IN TRENCH.

NOTE: NO DRY WELL SHALL EXCEED 16 FOOT IN DIAMETER.

NOTE: ALL PIPE FROM HOUSE TO DISPOSAL AREA MUST BE CAST IRON.

PERMIT VOID AFTER THREE YEARS.

NOTE: INSTALL STAND PIPE ON SEPTIC TANK AND DRY WELL. STAND PIPES MUST BE 6 INCHES IN DIAMETER. CAST IRON, CONCRETE OR TERRAZZO ACCEPTED.

**\*INSTALLER IS RESPONSIBLE FOR OBTAINING FINAL APPROVAL ON THIS PERMIT.**

A 31019

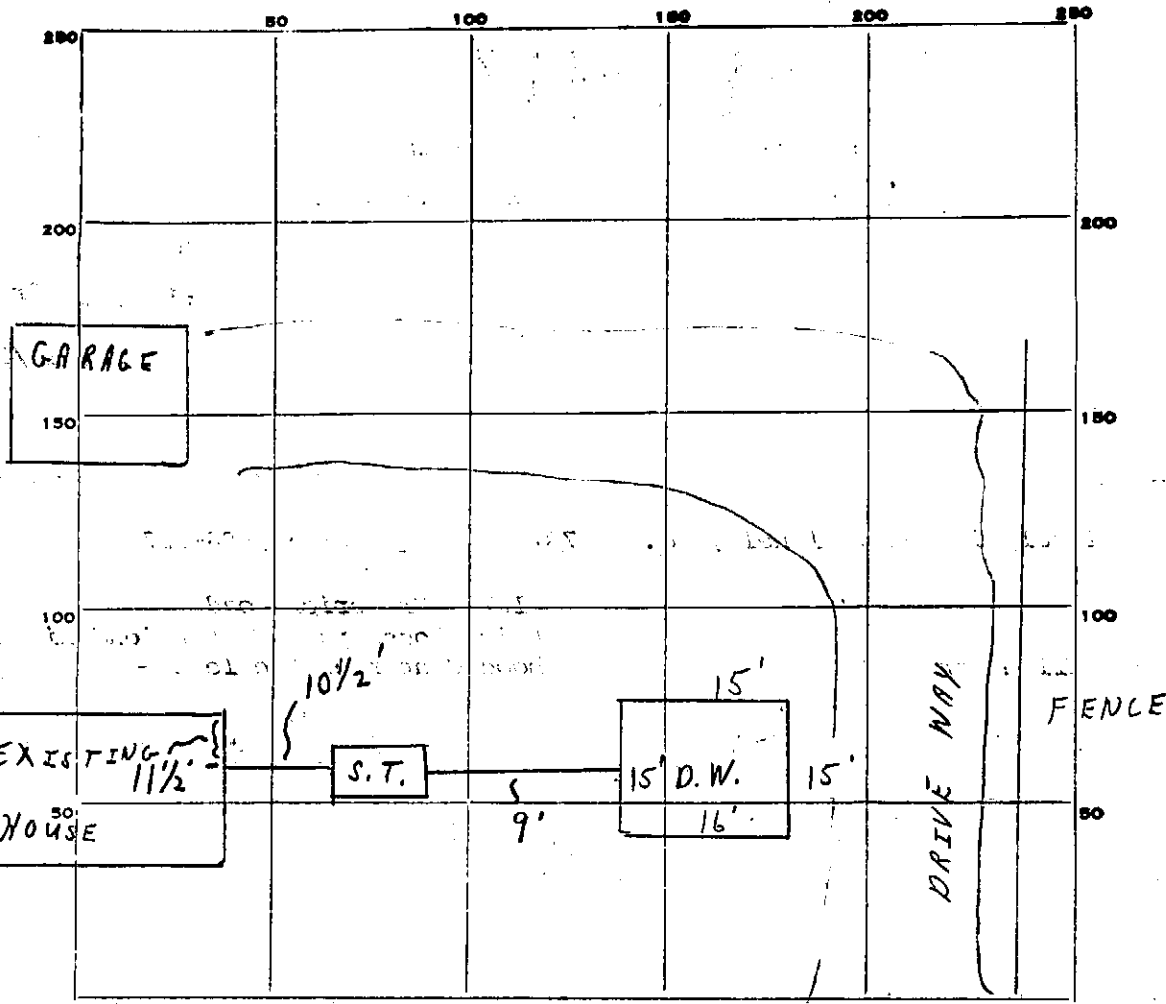

INDICATE NORTH. - NAME ADJOINING ROADWAY AS BASE LINE.  
RT. 144

PERMIT CARD  \_\_\_\_\_ S.T. D.W.

SEPTIC TANK, LEVEL  \_\_\_\_\_ CLEANOUTS T.C.  C.I.

DISTRIBUTION BOX, LEVEL \_\_\_\_\_

TILE FIELD, DEPTH \_\_\_\_\_ FT. TRENCH WIDTH \_\_\_\_\_ FT.

GRAVEL DEPTH \_\_\_\_\_ IN. TOTAL LENGTH \_\_\_\_\_ FT.

NUMBER OF TRENCHES \_\_\_\_\_ TOTAL BOTTOM AREA \_\_\_\_\_

SEEPAGE PITS, INSIDE DIAMETER 60 FT. DEPTH BELOW INLET 6' FT.

ABSORBENT AREA 360 SQ. FT.

REMARKS 11/12/80 SYSTEM COMPLETE.  
C.B.S.

11/12/80 INSPECTOR C. B. Steakes

Repair perc.  
11/10/80

# APPLICATION

SEWAGE DISPOSAL TESTING

STATE OF MARYLAND - DEPARTMENT OF HEALTH AND MENTAL HYGIENE

HOWARD COUNTY HEALTH DEPARTMENT  
ENVIRONMENTAL HEALTH SERVICES  
P.O. BOX 476 ELLICOTT, MARYLAND 21043  
TELEPHONE: 992-2330

Septic Tank { 1-3 Bedrooms 1000 gallons  
4 Bedrooms 1250 gallons  
15'x15' Dry Well. 3rd

Dry well to be 20' from  
right side of house when looking

DISTRICT \_\_\_\_\_

DATE 11/10/80

@ house from Rt. 144. Inlet to drywell to be  
2' below original grade and maximum depth of 8' only  
for drywell below original grade in area of perc hole (1+2).

TO: THE COUNTY HEALTH OFFICER  
ELLICOTT CITY, MARYLAND

I, HEREBY, APPLY FOR THE NECESSARY TEST IN ORDER TO CONSTRUCT (OR RECONSTRUCT) A SEWAGE DISPOSAL SYSTEM.

PROPERTY OWNER Allen Van Sant

ADDRESS \_\_\_\_\_ PHONE \_\_\_\_\_

PROPERTY LOCATION \_\_\_\_\_

SUBDIVISION \_\_\_\_\_ LOT NO. \_\_\_\_\_

ROAD AND DESCRIPTION 12785 Frederick Road (Route 144) - 3rd house on left beyond  
the West Friendship Neighborhood Center

SIZE OF LOT ? TYPE BLDG. Existing House with plumbing

THE SYSTEM INSTALLED UNDER THIS APPLICATION IS ACCEPTABLE ONLY UNTIL PUBLIC FACILITIES BECOME AVAILABLE.

I FULLY UNDERSTAND THE FEE CONNECTED WITH THE FILING OF THIS PERC TEST APPLICATION IS NON-REFUNDABLE UNDER

ANY CIRCUMSTANCES.

SIGNATURE OF APPLICANT /s/ Jack Fyock for Allen Van Sant

APPROVED BY C. B. Streater FOR Dry Well only DATE 11/10/80

REJECTED BY \_\_\_\_\_ FOR \_\_\_\_\_ DATE \_\_\_\_\_

HOLD PENDING FURTHER TESTS \_\_\_\_\_ DATE \_\_\_\_\_

REASONS FOR REJECTION OR HOLDING 11/10/80 Need to apply for repair permit  
for septic installation. C.B.S.

## THIS IS NOT A PERMIT

not

SOIL PROFILE

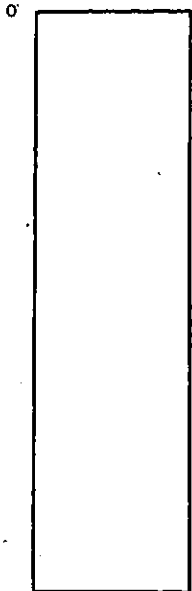

{ FIELD SHEET }

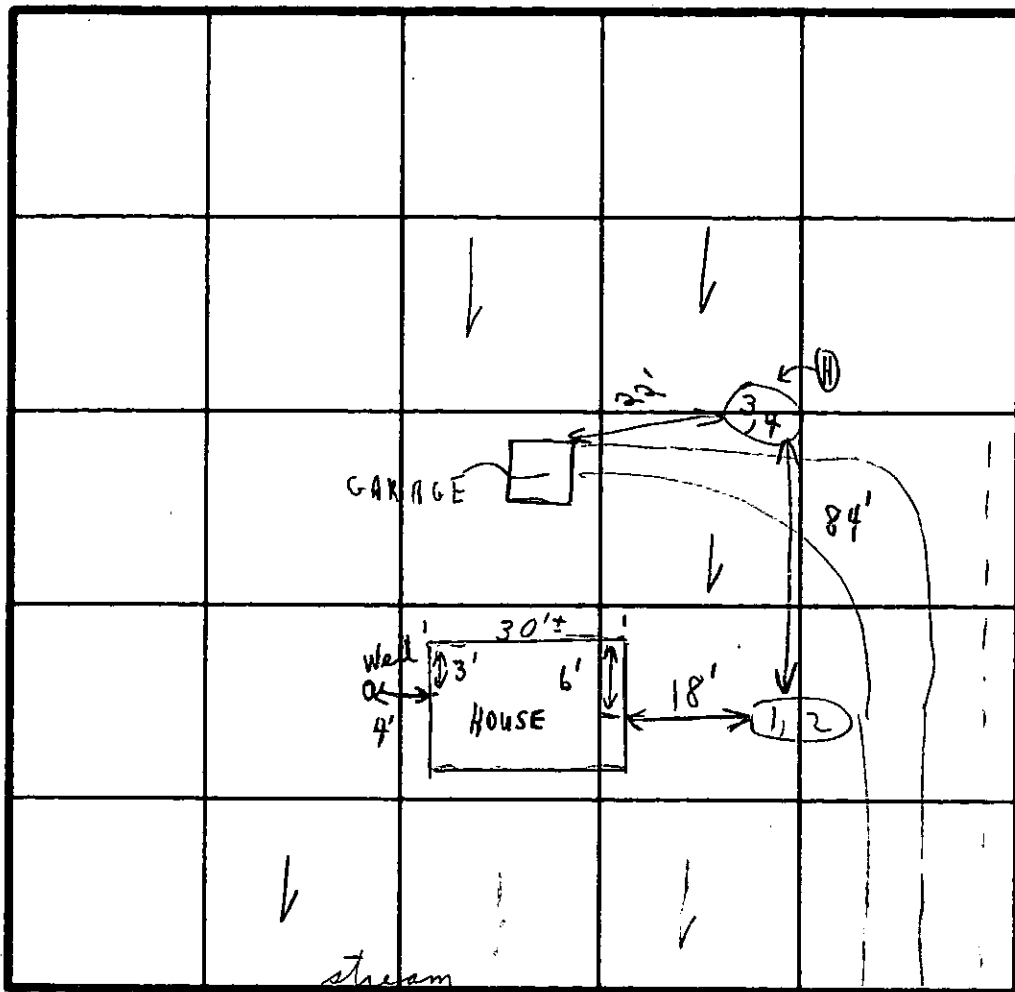

INDICATE NORTH - NAME ADJOINING ROADWAY AS BASE LINE.  
RT 144

SOIL PROFILE	DATE	TEST NO.	DEPTH	PRE-WET		TEST - 1" DROP		TIME
				START	STOP	START	STOP	
1' - 2 1/2' clay	11/10/90	1	3 1/2'	4:16	4:24	4:24	4:34	10m
LOAM 2'-11'		2	11 1/2'	: water :				
0-1' clayed		3	1 1/2'	4:22	4:24	4:24	4:28	4m
1/2' - 12' loam		4	12'	4:24	4:26	4:26	4:30	4m
		5	'					
		6	'	(NOT DUG)		limited space for repair		

(Use 1, 2)  
For Future Repair

Max depth + 8'

REMARKS: Repair of electrical system (P) outlet 2' below original grade (i) on electrical system may go to stream Dry Well 15 X 15 outlet 2'-8' (stays 3 1/2' off water)

TESTED BY: C, B, N, ALSO PRESENT: Mr. Van Sant, Mr. Jack Fyock Jr., SKIP