

10/10/89 ASAP

05-408849

# PERMIT

SEWAGE DISPOSAL SYSTEM

MARYLAND STATE DEPARTMENT OF HEALTH

**HOWARD COUNTY**  
BUREAU OF ENVIRONMENTAL HEALTH  
461-9933

## INDEXED

P 44952

A 39247

DISTRICT 5th

DATE 9/4/89

DATE SYSTEM APPROVED 10/10/89

INSPECTOR M. Rifkin

C. C. Cissel

IS PERMITTED TO INSTALL  ALTER

ADDRESS 14079 Brighton Dam Road, Clarksville, Maryland 21129 PHONE 854-2006

SUBDIVISION Westside ROAD 5930 ~~5370~~ Clifton Oaks Dr LOT 12

PROPERTY OWNER Mr. Jarone ~~Rao Group~~

ADDRESS \_\_\_\_\_

IF GARBAGE GRINDER IS USED INCREASE SEPTIC TANK CAPACITY BY 50% AND ABSORPTION AREA BY 22%.

GARBAGE GRINDER? YES \_\_\_\_\_ NO X

SEPTIC TANK CAPACITY 1250 GALLONS NUMBER OF BEDROOMS 4

TRENCHES - 180 sq. ft. per bedroom. Trench to be 3 feet wide. Inlet 3 feet below original grade. Bottom maximum depth 5 feet below original grade. Effective area begins at 3 feet below original grade. 2 feet of stone below distribution pipe.

LOCATION - Place the distribution box 115 feet down the right (678.82') lot line and 110 feet from the right lot line. Run trench(s) along contour in both directions.

NOTE - No trench to exceed 100 feet in length. Provide 6" - 8" diameter cleanout and cap to grade or above on septic tank. OKCW

PLANS APPROVED BY Sid Abel DATE 9/30/88

COVER NO WORK UNTIL INSPECTED AND APPROVED

NEITHER THE HOWARD COUNTY COUNCIL NOR THE HEALTH DEPARTMENT IS RESPONSIBLE FOR THE SUCCESSFUL OPERATION OF ANY SYSTEM

NOTE: CLEANOUT REQUIRED EVERY 70 FEET OF SEWER LINE AND/OR AT 90° SWEEPS IN LINES FROM HOUSE TO DRAIN FIELDS

NOTE: ALL PARTS OF SEPTIC SYSTEMS (I.E. TANK, DISTRIBUTION BOX, TRENCHES) TO BE 100 FEET FROM WELL (UNLESS OTHERWISE SPECIFICALLY AUTHORIZED)

NOTE: IF DEEP TRENCHES ARE USED CALL FOR INSPECTION BEFORE AND AFTER PLACING GRAVEL IN TRENCHES)

NOTE: NO DRY WELL SHALL EXCEED 15 FOOT IN DIAMETER NO ABSORPTION TRENCH TO EXCEED 100 FEET IN LENGTH.

NOTE: ALL PIPE FROM HOUSE TO SEPTIC TANK MUST BE CAST IRON OR SCHEDULE 40 PVC OR ABS

PERMIT VOID AFTER TWO YEARS

NOTE: INSTALL STAND PIPE ON SEPTIC TANK AND DRY WELL. STAND PIPES MUST BE 6 INCHES IN DIAMETER. CAST IRON, CONCRETE OR TERRA COTTA OR PVC OR ABS ACCEPTED. IF TOP OF SEPTIC TANK IS DEEPER THAN 3 FEET, MANHOLE TO GRADE REQUIRED

NOTE: DISTRIBUTION BOXES MUST HAVE BAFFLES

**\*INSTALLER IS RESPONSIBLE FOR OBTAINING FINAL APROVAL ON THIS PERMIT**

\*CALL 461-9933 FOR INSPECTION OF SEPTIC SYSTEMS.

A  
39247

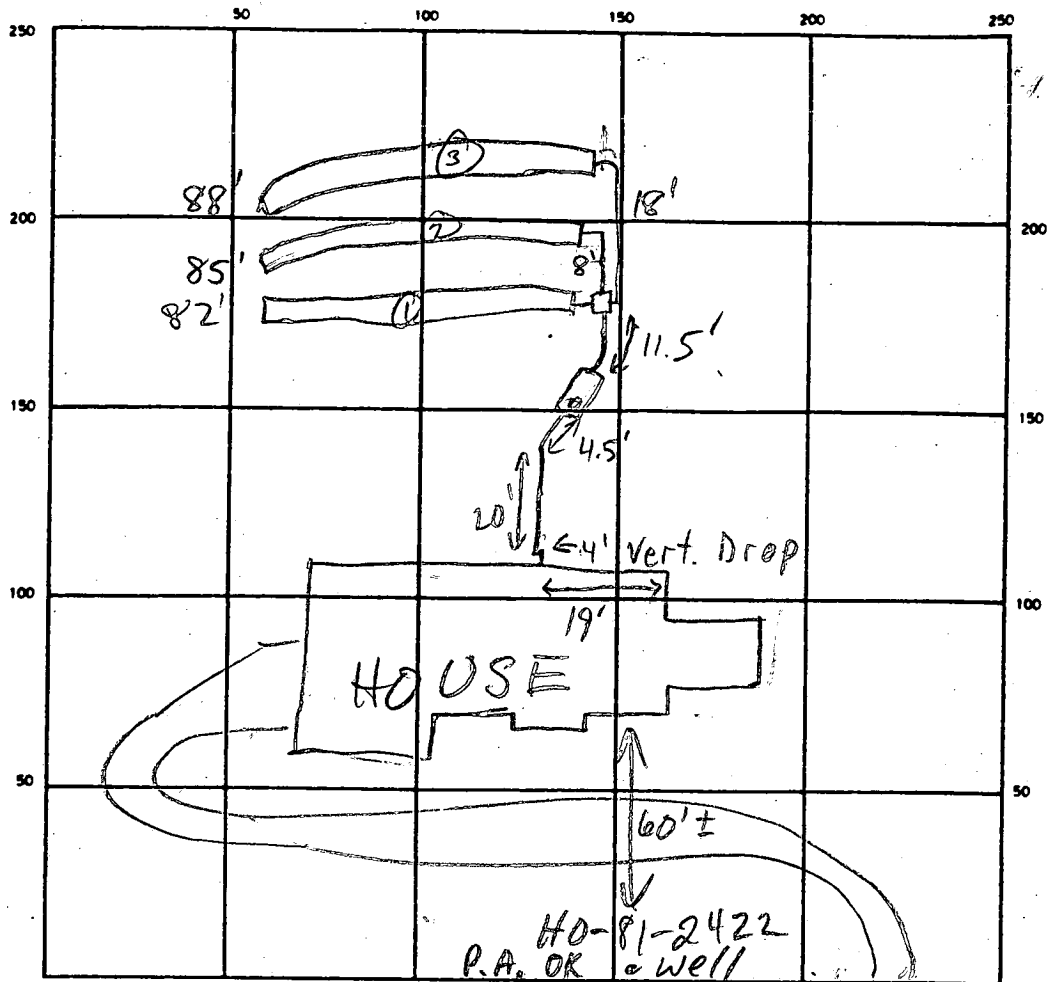

CLIFTON OAKS DR

SEPTIC TANK LEVEL 1500 GAL CLEANOUTS OK  
 DISTRIBUTION BOX LEVEL OK - BAFFLE IN  
 DRAIN FIELD/TILE FIELD DEPTH 5 FT. TRENCH WIDTH 3 FT. INLET DEPTH 3 FT.  
 EFFECTIVE GRAVEL DEPTH 2 FT. TOTAL LENGTH 82 85 88 FT. 253  
 NUMBER OF TRENCHES 3 ONE SIDEWALL/BOTTOM AREA 759 SQ. FT.  
 DRYWELL INSIDE DIAMETER — FT. EFFECTIVE DEPTH BELOW INLET — FT.  
 ABSORBENT AREA — SQ. FT.

REMARKS 10/10/89 ALL WORK OK TO COVER MR

DATE SYSTEM APPROVED 10/10/89 INSPECTOR M. R. F. Kin

