

8/9/83
11:02 A.M.

PERMIT

P 32778

SEWAGE DISPOSAL SYSTEM

A REPAIR

MARYLAND STATE DEPARTMENT OF HEALTH*

HOWARD COUNTY
BUREAU OF ENVIRONMENTAL HEALTH
992-2330

INDEXED
05-368200

ELLICOTT CITY
DISTRICT 5th.

DATE 5/17/83

COMPLETE 9/9/83 CBS.

Charles E. Stevens by Perry Leek IS PERMITTED TO INSTALL _____ ALTER X

ADDRESS 7609 Green Dell Lane, Highland, Maryland PHONE 854-3431

SUBDIVISION Green Wood Farms ROAD 7609 Green Dell Lane LOT 38

PROPERTY OWNER Charles E. Stevens

ADDRESS _____

IF GARBAGE GRINDER IS USED INCREASE SEPTIC TANK CAPACITY BY 50% AND ABSORPTION AREA BY 22%.

GARBAGE GRINDER? YES _____ NO _____

SEPTIC TANK CAPACITY _____ GALLONS NUMBER OF BEDROOMS _____

REPAIR - CALL FOR INSPECTION WHEN GROUND IS OPENED UP SO SANITARIAN CAN RECOMMEND REPAIR.

PLANS APPROVED BY Fred Frommelt DATE 5/17/83

COVER NO WORK UNTIL INSPECTED AND APPROVED.

NEITHER THE HOWARD COUNTY COUNCIL NOR THE HEALTH DEPARTMENT IS RESPONSIBLE FOR THE SUCCESSFUL OPERATION OF ANY SYSTEM.

NOTE: IF TRENCH IS USED CALL FOR INSPECTION BEFORE AND AFTER PLACING GRAVEL IN TRENCH.

NOTE: NO DRY WELL SHALL EXCEED 15 FOOT IN DIAMETER. NO ABSORPTION TRENCH TO EXCEED 100 FEET IN LENGTH.

NOTE: ALL PIPE FROM HOUSE TO SEPTIC TANK MUST BE CAST IRON OR SCHEDULE 40 PVC OR ABS.

PERMIT VOID AFTER THREE YEARS.

NOTE: INSTALL STAND PIPE ON SEPTIC TANK AND DRY WELL. STAND PIPES MUST BE 6 INCHES IN DIAMETER. CAST IRON, CONCRETE OR TERRA COTTA, OR PVC OR ABS ACCEPTED. IF TOP OF SEPTIC TANK IS DEEPER THAN 3 FEET MANHOLE TO GRADE REQUIRED.

***INSTALLER IS RESPONSIBLE FOR OBTAINING FINAL APPROVAL ON THIS PERMIT**

*CALL 992-2330 FOR INSPECTION OF SEPTIC SYSTEMS.

EH - 2-1082

AP32778

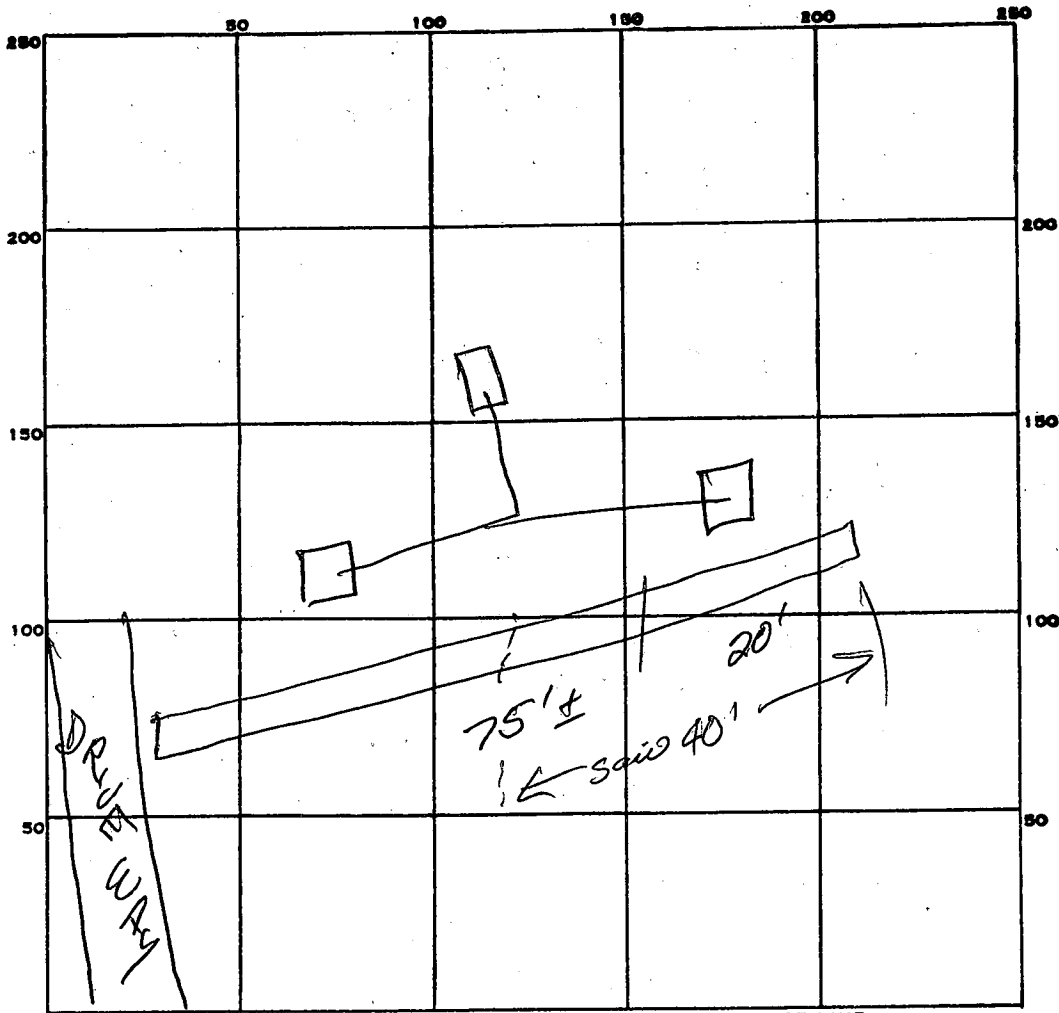

INDICATE NORTH. - NAME ADJOINING ROADWAY AS BASE LINE.

ROAD

PERMIT CARD ✓

SEPTIC TANK, LEVEL N/A CLEANOUTS N/A

DISTRIBUTION BOX, LEVEL NA

TILE FIELD, DEPTH _____ FT. TRENCH WIDTH _____ FT.

GRAVEL DEPTH _____ IN. TOTAL LENGTH _____ FT.

NUMBER OF TRENCHES _____ TOTAL BOTTOM AREA _____

SEEPAGE PITS, INSIDE DIAMETER _____ FT. DEPTH BELOW INLET _____ FT.

ABSORBENT AREA _____ SQ. FT.

REMARKS 9/9/83 Hole 16' deep most in bottom, instructed to go only 13' deep, inlet will be approx 5' off top of D.W (8" stone)

Saw 40' of trench, 20ft. @ Stone F.F. 9/9/83 Saw 54' ± 40'

To 13' deep - 14' to be cleaned out plus 21' more to be dug to 13' deep - Hold for owners certification.

NO ADDITIONAL INFO AS OF 7/27/95 - INDEX AS COMPLETE (CW)

DATE SYSTEM APPROVED 9/9/83 INSPECTOR CHARLES STAGGER (CW)

27 Sept 63 M/H

PERMIT

P 07488

A 05515

SEWAGE DISPOSAL SYSTEM

MARYLAND STATE DEPARTMENT OF HEALTH

HOWARD COUNTY

ELLICOTT CITY

DISTRICT 5

DATE 9-26-63

INDEXED

INDEXED

Hy and Loe

IS PERMITTED TO INSTALL ALTER

ADDRESS Latonville

PHONE _____

A SEWAGE DISPOSAL SYSTEM LOCATED AT _____

SUBDIVISION Greenwood Farms ROAD Shradell Lane LOT 38, sec 4

PROPERTY OWNER Charles Stephens

ADDRESS _____

SPECIFICATIONS

DRAIN FIELD _____ DEPTH _____ FEET, BOTTOM AREA _____ SQ. FT.

SEEPAGE PITS 2 ABSORBENT SIDE-WALL AREA 10' X 10' SQ. FT. below inlet

SEPTIC TANK CAPACITY 750 GALLONS

FOR GARBAGE GRINDER, INCREASE DISPOSAL AREA 22% & TANK CAPACITY 50%.

OTHER Locate system 56 ft. from front property line. Center

one dry well equal distance from side lines, other dry

well 36 ft. from first edge to edge

PLANS APPROVED BY J E Hennigan DATE 8-14-62

FILL SEPTIC TANK AND DISTRIBUTION BOX WITH WATER BEFORE CALLING FOR AN INSPECTION. COVER NO WORK UNTIL INSPECTED AND APPROVED.

NEITHER THE HOWARD COUNTY COMMISSIONERS NOR THE HEALTH DEPARTMENT IS RESPONSIBLE FOR THE SUCCESSFUL OPERATION OF ANY SYSTEM.

A 05515

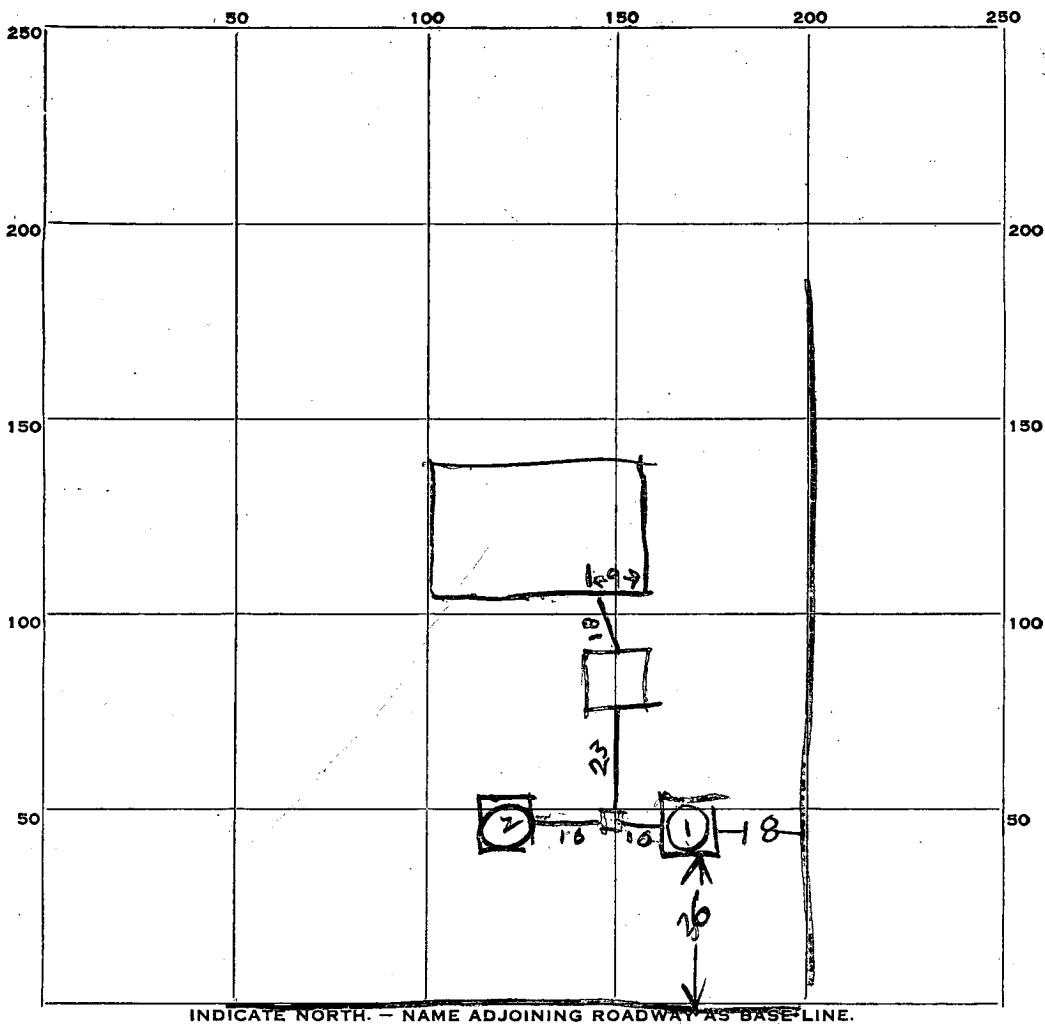

INDICATE NORTH. - NAME ADJOINING ROADWAY AS BASE LINE.

PERMIT CARD OK
 SEPTIC TANK, LEVEL OK 1000 concrete CLEANOUTS OK
 Tank is 5 ft below grade
 DISTRIBUTION BOX, LEVEL OK

TILE FIELD, DEPTH _____ FT. TRENCH WIDTH _____ FT.
 GRAVEL DEPTH _____ IN. TOTAL LENGTH _____ FT.
 NUMBER OF TRENCHES _____ TOTAL BOTTOM AREA _____
 SEEPAGE PITS, INSIDE DIAMETER _____ FT. DEPTH BELOW INLET _____ FT.

25
25
275
286
561

ABSORBENT AREA 561 SQ. FT. total both dry wells & distribution

REMARKS Dry Well #1 - Inlet is 5 ft deep below grade Depth below inlet is 11 ft. Diameter duct wall to duct wall is 8 ft 1 ft stone around outside of dry well 8X3.1X11 = 275 sq ft
Dry Well #2 Inlet is 5 ft deep below grade Depth below inlet is 11 ft. Diameter duct wall to duct wall is 8.5 ft 1 ft stone around outside of dry well 8.5X3.1X11 = 286 sq ft

DATE SYSTEM APPROVED 27 Sept 63 INSPECTOR Raymond Hodger

Dry Wells are some what smaller in area than called for but soil is excellent

Greenwood Farms

Lot 38, sec. 4

Boteler Rd. White Oak
Silver Spring Md.
Aug. 20, 1962

Howard County Health Dept.
Ellicott City, Md.

Dear Sir:

I recently had a perkalation
test made on my lot by
Mr. Ricketts, I would
like to know the results
so that I know what type
of sewage system to plan on.
Would you please send
me a copy of the recommendations.
My lot is in the Greenwood
Farms development, on
Green ~~Jebb~~ Lane, Lot No. 38.

Thank you

Respectfully yours

Jos. A. Horak

8-21-62

Copy sent
dms

in triplicate.

checked blanks.

\$15.00 payable to:

CITY HEALTH DEPT. - SANITATION

APPLICATION

SEWAGE DISPOSAL TESTING

A 05515

P _____

MARYLAND STATE DEPARTMENT OF HEALTH

HOWARD COUNTY

ELLICOTT CITY

DISTRICT 5

DATE 7/24/62

Two dry wells 10 ft in dia. by 10 ft. deep below the inlet located 156 ft. from the front property line. Center one dry well equi-distant from side property line; other dry well 30 ft from 1st. edge to edge.

750 gal septic Tank.

TO: THE COUNTY HEALTH OFFICER
ELLICOTT CITY, MARYLAND

I, HEREBY, APPLY FOR THE NECESSARY TESTS IN ORDER TO CONSTRUCT (OR RECONSTRUCT) A SEWAGE DISPOSAL SYSTEM.

PROPERTY OWNER: ~~Joseph Anthony Horak~~ *Charles Stevens* 4326 *Beantmont Circle*
~~Botelef Rd. White Oak~~ *Silver Spring*
ADDRESS: ~~Silver Spring, Maryland~~ PHONE MA 2-0232

PROPERTY LOCATION:

SUBDIVISION Greenwood Farms LOT NO. 38, sec. 4

ROAD AND DESCRIPTION S.E. side, Green Dell Lane. From Brown Ridge Rd. To Green Dell Lane Via Greenwood Dr. + Woodridge Lane.

OCCUPANT _____ PHONE _____

PERSON TO CONSTRUCT SYSTEM _____

ADDRESS _____ PHONE _____

SIZE OF LOT 43,771 sq. ft. TYPE BLDG. Single Residence, 3 bedrooms
NUMBER OF BEDROOMS

IF NOT SINGLE RESIDENCE DESCRIBE _____

SIGNATURE OF APPLICANT *Joseph A. Horak*

APPROVED BY *J. Henning* FOR *Don Mills* DATE 8-14-62
(KIND OF SYSTEM)

REJECTED BY _____ FOR _____ DATE _____
(KIND OF SYSTEM)

HOLD PENDING FURTHER TESTS 7-1-62/61 DATE _____

REASONS FOR REJECTION OR HOLDING 8-1-62 John's house times 2 runs - 10' dia. septic tank. Home owner provides at 9:10 appointment but later with bubbles - arrived after 10:00 AM.

THIS IS NOT A PERMIT

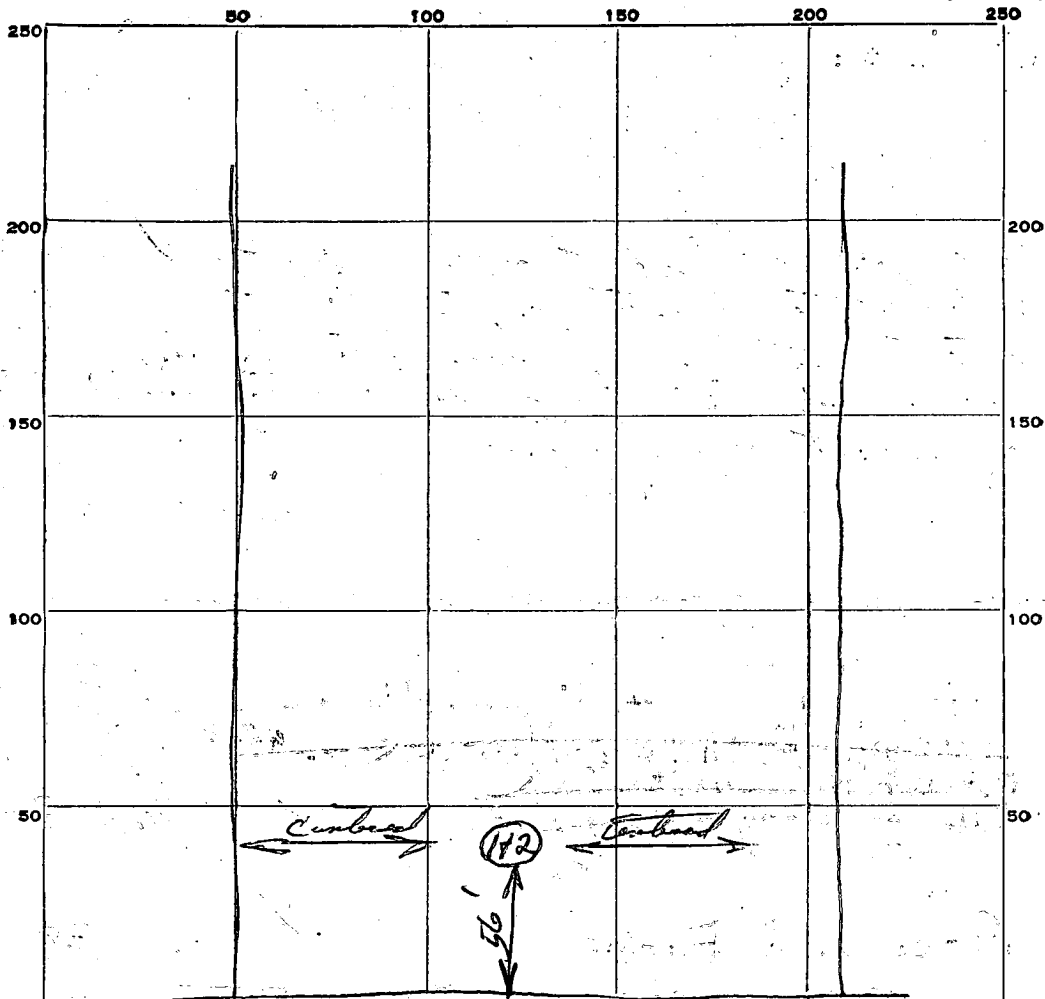

INDICATE NORTH. - NAME ADJOINING ROADWAY AS BASE LINE.

Green Dell Lane

| DATE | TEST NO. | DEPTH | PRE-WET | | TEST - 1" DROP | | TIME |
|---------|----------|-------|---------|------|----------------|------|--------|
| | | | START | STOP | START | STOP | |
| 8-14-62 | 1 | 10'7" | 1:20 | 1:21 | 1:21 | 1:23 | 27 min |
| 1 | 2 | 6'6" | 1:27 | | | | |
| | | | | | | | |
| | | | | | | | |
| | | | | | | | |
| | | | | | | | |
| | | | | | | | |
| | | | | | | | |
| | | | | | | | |

310
310
620

SOIL AUGER FINDING

TESTED BY

J.H.

REMARKS

8-14-62 - First ~~test~~ ~~at~~ not to good. - Need test 0+10ft dry wells
 8-14-62 *W.L. Kipke* milled 2 1/2 ft below
 surface

ALSO PRESENT

LOT NO.

38 sec 4