

5/11/83
NOID

approved
5-11-83
C Wilhoit

PERMIT

P 32734

A Repair

SEWAGE DISPOSAL SYSTEM

MARYLAND STATE DEPARTMENT OF HEALTH*

HOWARD COUNTY
BUREAU OF ENVIRONMENTAL HEALTH
992-2330

ELLCOTT CITY
DISTRICT 5th

INDEX

DATE 5/6/83

Jack Fyock IS PERMITTED TO INSTALL _____ ALTER X

ADDRESS 13775 Triadelphia Road, Glenelg, Md. 21737 PHONE 988-9270

SUBDIVISION Mooresfield ROAD 7417 Cherry Tree Drive LOT _____

PROPERTY OWNER Harry N. Bassett

ADDRESS 7417 Cherry Tree Drive, Fulton, Maryland 20759 Phone: 725-6731

IF GARBAGE GRINDER IS USED INCREASE SEPTIC TANK CAPACITY BY 50% AND ABSORPTION AREA BY 22%.

GARBAGE GRINDER? YES _____ NO _____

SEPTIC TANK CAPACITY _____ GALLONS NUMBER OF BEDROOMS 3

REPAIR - Call for an appointment when ground is opened up and Sanitarian will recommend the repair system.

ADD TRENCH w/ 466+ SQFT ABS AREA. 5-11-83 C Wilhoit

PLANS APPROVED BY Palmer F. Wine DATE 5/6/83

COVER NO WORK UNTIL INSPECTED AND APPROVED.

NEITHER THE HOWARD COUNTY COUNCIL NOR THE HEALTH DEPARTMENT IS RESPONSIBLE FOR THE SUCCESSFUL OPERATION OF ANY SYSTEM.

NOTE: IF TRENCH IS USED CALL FOR INSPECTION BEFORE AND AFTER PLACING GRAVEL IN TRENCH.

NOTE: NO DRY WELL SHALL EXCEED 15 FOOT IN DIAMETER. NO ABSORPTION TRENCH TO EXCEED 100 FEET IN LENGTH.

NOTE: ALL PIPE FROM HOUSE TO SEPTIC TANK MUST BE CAST IRON OR SCHEDULE 40 PVC OR ABS.

PERMIT VOID AFTER THREE YEARS.

NOTE: INSTALL STAND PIPE ON SEPTIC TANK AND DRY WELL. STAND PIPES MUST BE 6 INCHES IN DIAMETER. CAST IRON, CONCRETE OR TERRA COTTA, OR PVC OR ABS ACCEPTED. IF TOP OF SEPTIC TANK IS DEEPER THAN 3 FEET MANHOLE TO GRADE REQUIRED.

***INSTALLER IS RESPONSIBLE FOR OBTAINING FINAL APPROVAL ON THIS PERMIT**

*CALL 992-2330 FOR INSPECTION OF SEPTIC SYSTEMS.

EH - 2-1082

32734

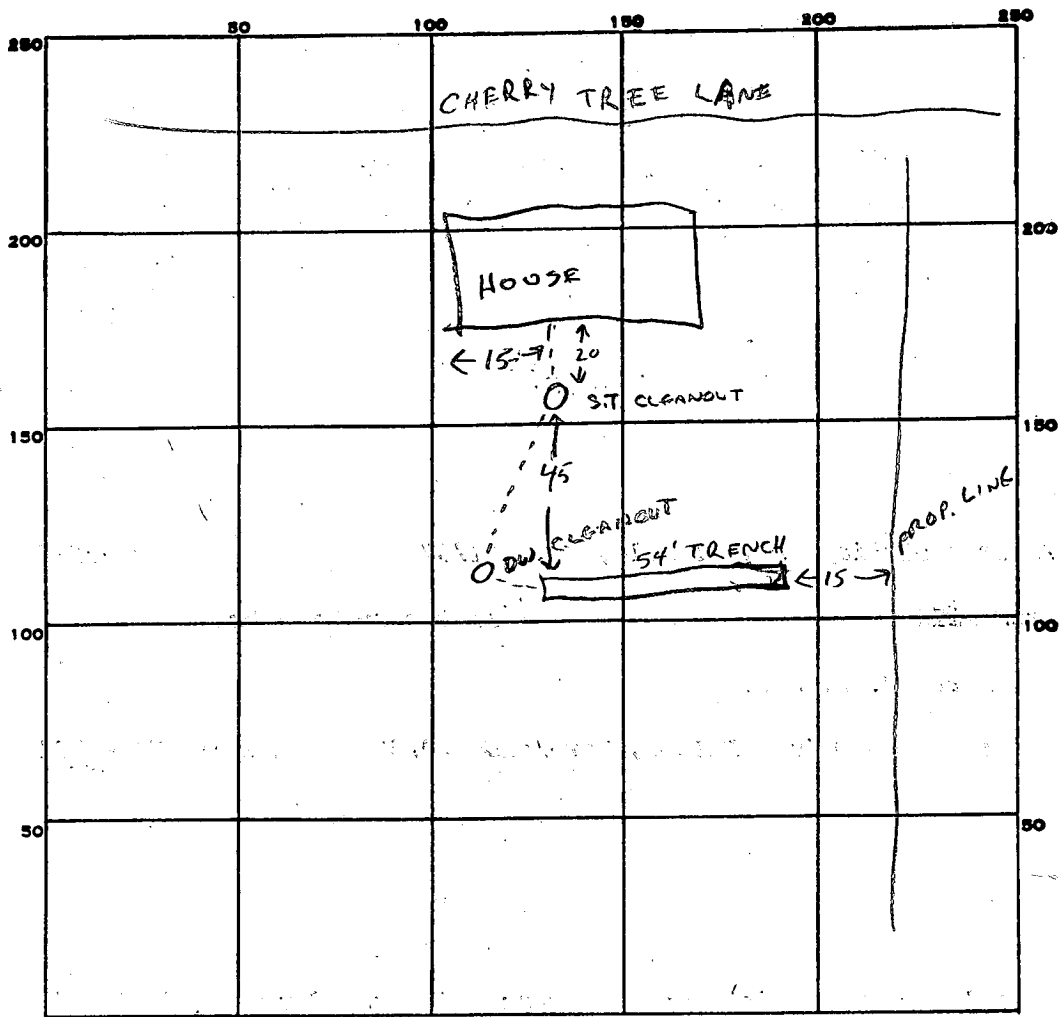

INDICATE NORTH. - NAME ADJOINING ROADWAY AS BASE LINE.

PERMIT CARD _____

SEPTIC TANK, LEVEL _____

CLEANOUTS DW ✓ ST ✓

DISTRIBUTION BOX, LEVEL _____

TILE FIELD, DEPTH 12-13 FT. TRENCH WIDTH 2 FT.

INLET 4-5

GRAVEL DEPTH 8 FT. TOTAL LENGTH 54 FT.

NUMBER OF TRENCHES 1 TOTAL BOTTOM AREA 432.59 SQ. FT.

+ EXISTING DRYWELL

SEEPAGE PITS, INSIDE DIAMETER _____ FT. DEPTH BELOW INLET _____ FT.

ABSORBENT AREA _____ SQ. FT.

REMARKS _____

SANDY SOIL, w/SOME CLAY MIX, CW

DATE SYSTEM APPROVED _____

5-11-83

INSPECTOR _____

C. Williams