

4/13/83
11:00 A.M. Final

ADDITIONAL
C 119/113

PERMIT

P 32644
A Repair

SEWAGE DISPOSAL SYSTEM

MARYLAND STATE DEPARTMENT OF HEALTH

HOWARD COUNTY
BUREAU OF ENVIRONMENTAL HEALTH
992-2330

02-249030
INDEX

ELLICOTT CITY
DISTRICT 2nd
DATE 4/11/83

Jenkins Brothers IS PERMITTED TO INSTALL _____ ALTER X

ADDRESS Route 144, Ellicott City, MD 21043 PHONE 465-6656

SUBDIVISION _____ ROAD 9581 Route 99 LOT _____

PROPERTY OWNER Tydings Phone: 465-1222

ADDRESS 9581 Route 99, Ellicott City, MD

IF GARBAGE GRINDER IS USED INCREASE SEPTIC TANK CAPACITY BY 50% AND ABSORPTION AREA BY 22%.

GARBAGE GRINDER? YES _____ NO

SEPTIC TANK CAPACITY 1000 GALLONS NUMBER OF BEDROOMS 3

REPAIR - CALL FOR INSPECTION WHEN GROUND IS OPENED UP SO SANITARIAN CAN RECOMMEND

4/13/83

REPAIR.

NEW TANK TO BE PLACED

REGISTERED OUT SIDE TANK

PLANS APPROVED BY Palmer F. Wine DATE April 11, 1983

COVER NO WORK UNTIL INSPECTED AND APPROVED.

NEITHER THE HOWARD COUNTY COUNCIL NOR THE HEALTH DEPARTMENT IS RESPONSIBLE FOR THE SUCCESSFUL OPERATION OF ANY SYSTEM.

NOTE: IF TRENCH IS USED CALL FOR INSPECTION BEFORE AND AFTER PLACING GRAVEL IN TRENCH.

NOTE: NO DRY WELL SHALL EXCEED 15 FOOT IN DIAMETER. NO ABSORPTION TRENCH TO EXCEED 100 FEET IN LENGTH.

NOTE: ALL PIPE FROM HOUSE TO SEPTIC TANK MUST BE CAST IRON OR SCHEDULE 40 PVC OR ABS.

PERMIT VOID AFTER THREE YEARS.

NOTE: INSTALL STAND PIPE ON SEPTIC TANK AND DRY WELL. STAND PIPES MUST BE 6 INCHES IN DIAMETER. CAST IRON, CONCRETE OR TERRA COTTA, OR PVC OR ABS ACCEPTED. IF TOP OF SEPTIC TANK IS DEEPER THAN 3 FEET MANHOLE TO GRADE REQUIRED.

***INSTALLER IS RESPONSIBLE FOR OBTAINING FINAL APROVAL ON THIS PERMIT**

*CALL 992-2330 FOR INSPECTION OF SEPTIC SYSTEMS.

EH - 2-1082

X 132644

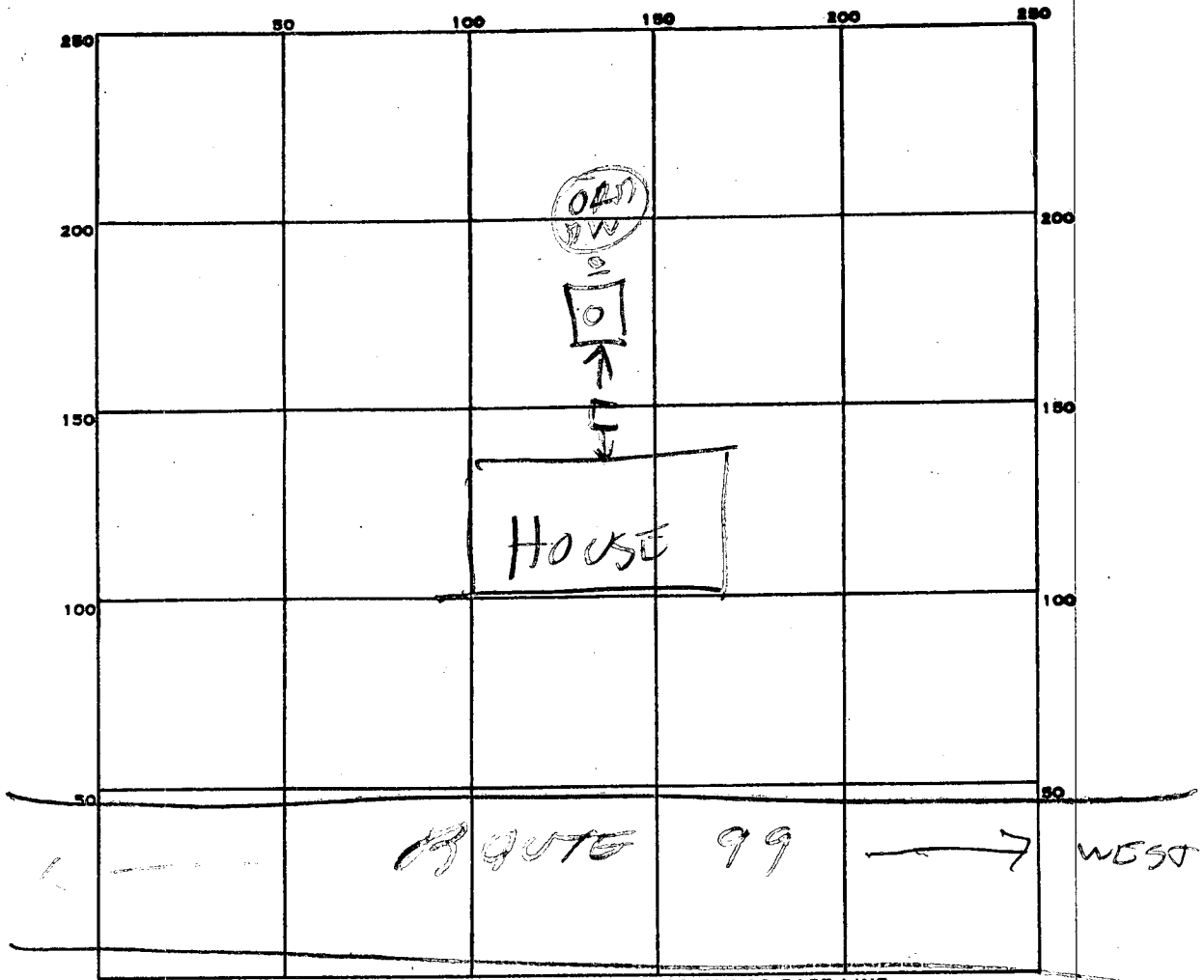

INDICATE NORTH. - NAME ADJOINING ROADWAY AS BASE LINE.

PERMIT CARD _____

SEPTIC TANK, LEVEL OK 1000 cement CLEANOUTS OK

DISTRIBUTION BOX, LEVEL TOP TANK 1 FT BELOW GRADE

TILE FIELD, DEPTH _____ FT. TRENCH WIDTH _____ FT.

GRAVEL DEPTH _____ IN. TOTAL LENGTH _____ FT.

NUMBER OF TRENCHES _____ TOTAL BOTTOM AREA _____

SEEPAGE PITS, INSIDE DIAMETER _____ FT. DEPTH BELOW INLET _____ FT.

ABSORBENT AREA _____ SQ. FT.

REMARKS OLD STEEL TANK RUSTED

OUT AFTER 17 YEARS

EXISTING DRY WELL OK

DATE SYSTEM APPROVED 4/13/03 INSPECTOR Raymond [Signature]

1/3/75

PERMIT

P 21052
A _____

SEWAGE DISPOSAL SYSTEM

MARYLAND STATE DEPARTMENT OF HEALTH

HOWARD COUNTY

ELLICOTT CITY

INDEXED

DISTRICT 2

DATE 1/3/75

Public Sewerage IS PERMITTED TO INSTALL ALTER 2

ADDRESS Elliot Park, Ellicott City, Md. PHONE 465-6446

A SEWAGE DISPOSAL SYSTEM LOCATED AT _____

SUBDIVISION _____ ROAD 9591 Old Frederick LOT _____
(see application for directions)

PROPERTY OWNER Tydings

ADDRESS _____

SPECIFICATIONS

DRAIN FIELD _____ DEPTH _____ FEET. BOTTOM AREA _____ SQ. FT.

SEEPAGE PITS _____ ABSORBENT SIDE-WALL AREA _____ SQ. FT.

SEPTIC TANK CAPACITY _____ GALLONS

FOR GARBAGE GRINDER, INCREASE DISPOSAL AREA 25% & TANK CAPACITY 50%.

OTHER REPAIR - Trench - 10 ft. deep - 5 ft. stone - 50 ft. long ending off of the
city wall (with 10 ft. buffer between) and running toward the back right-hand corner of
the lot at 9000 from the road.

PERMIT VOID AFTER THREE YEARS.

PLANS APPROVED BY R. Maccafield DATE 1/3/75

FILL SEPTIC TANK AND DISTRIBUTION BOX WITH WATER BEFORE CALLING FOR AN INSPECTION. COVER NO WORK UNTIL INSPECTED AND APPROVED.

NEITHER THE HOWARD COUNTY COMMISSIONERS NOR THE HEALTH DEPARTMENT IS RESPONSIBLE FOR THE SUCCESSFUL OPERATION OF ANY SYSTEM.

21052

21062

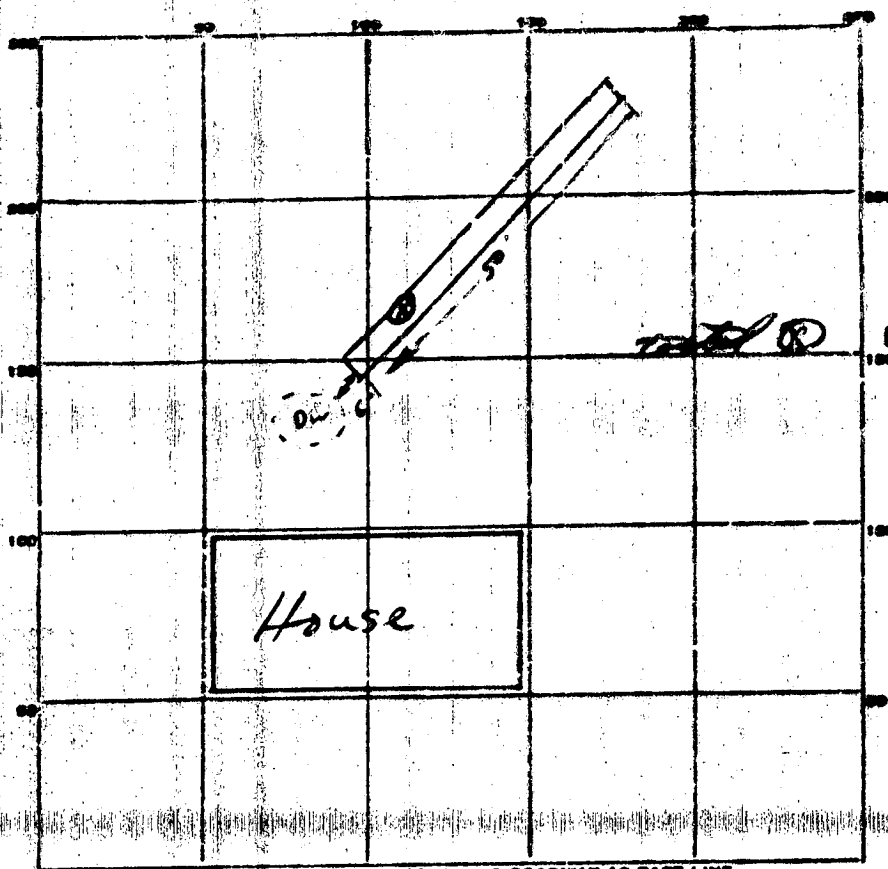

INDICATE NORTH - NAME ADJOINING ROADWAY AS BASE LINE

← 12 Rt 99 →

PERMIT CARD

EXISTING GROUND LEVEL _____

CLEARANCE _____

PROPOSED GROUND LEVEL _____

LE FIELD, DEPTH 10 FT. TRENCH WIDTH 2 FT.

GRAVEL DEPTH 5 FT. TOTAL LENGTH 50 FT.

NUMBER OF TRENCHES 1 TOTAL DESIGN AREA _____

DESIGN SITE INDEX NUMBER _____ FT. DEPTH BELOW INLET 5 FT.

ABSORBENT AREA 250 SQ. FT.

REMARKS _____

DATE SYSTEM APPROVED 1/3/78 INSPECTOR R. Wood