

Approved 11/18/82
Stayed P 32318

PERMIT

SEWAGE DISPOSAL SYSTEM

MARYLAND STATE DEPARTMENT OF HEALTH*

A Repair

HOWARD COUNTY
BUREAU OF ENVIRONMENTAL HEALTH
992-2330

ELLICOTT CITY
DISTRICT 4th

DATE 11/17/82

INDEX

James Gue _____ IS PERMITTED TO INSTALL _____ ALTER X

ADDRESS Route 2, Monrovia, Maryland 21770 PHONE 831-6228

SUBDIVISION _____ ROAD 3670 Route 97 LOT _____

PROPERTY OWNER Edgewood Farms, Inc.

ADDRESS 3670 Route 97, Glenwood, Maryland 21738 489-4365

IF GARBAGE GRINDER IS USED INCREASE SEPTIC TANK CAPACITY BY 50% AND ABSORPTION AREA BY 22%.

GARBAGE GRINDER? YES _____ NO _____

SEPTIC TANK CAPACITY _____ GALLONS NUMBER OF BEDROOMS _____

REPAIR - Call for an appointment when ground is opened up and Sanitarian will recommend the repair system.

Visual hole 14 ft deep - clay at top to 3'-4' ft, then
Sand, clay loam. Water table at 5 1/2 ft. approx 15 minutes
per 2nd inch. Old system located, 3 bedroom, (see sketch)
Recommend new septic tanks with trenches at
least 6.5 ft long - 10 ft deep with 6 1/2 ft of stone
11/18/82 JS

PLANS APPROVED BY Palmer F. Wine DATE 11/17/82

COVER NO WORK UNTIL INSPECTED AND APPROVED.

NEITHER THE HOWARD COUNTY COUNCIL NOR THE HEALTH DEPARTMENT IS RESPONSIBLE FOR THE SUCCESSFUL OPERATION OF ANY SYSTEM.

NOTE: IF TRENCH IS USED CALL FOR INSPECTION BEFORE AND AFTER PLACING GRAVEL IN TRENCH.

NOTE: NO DRY WELL SHALL EXCEED 15 FOOT IN DIAMETER. NO ABSORPTION TRENCH TO EXCEED 100 FEET IN LENGTH.

NOTE: ALL PIPE FROM HOUSE TO SEPTIC TANK MUST BE CAST IRON OR SCHEDULE 40 PVC OR ABS.

PERMIT VOID AFTER THREE YEARS.

NOTE: INSTALL STAND PIPE ON SEPTIC TANK AND DRY WELL. STAND PIPES MUST BE 6 INCHES IN DIAMETER. CAST IRON, CONCRETE OR TERRA COTTA, OR PVC OR ABS ACCEPTED. IF TOP OF SEPTIC TANK IS DEEPER THAN 3 FEET, MANHOLE TO GRADE REQUIRED.

***INSTALLER IS RESPONSIBLE FOR OBTAINING FINAL APPROVAL ON THIS PERMIT**

*CALL 992-2330 FOR INSPECTION OF SEPTIC SYSTEMS.

EH - 2-1082

32318

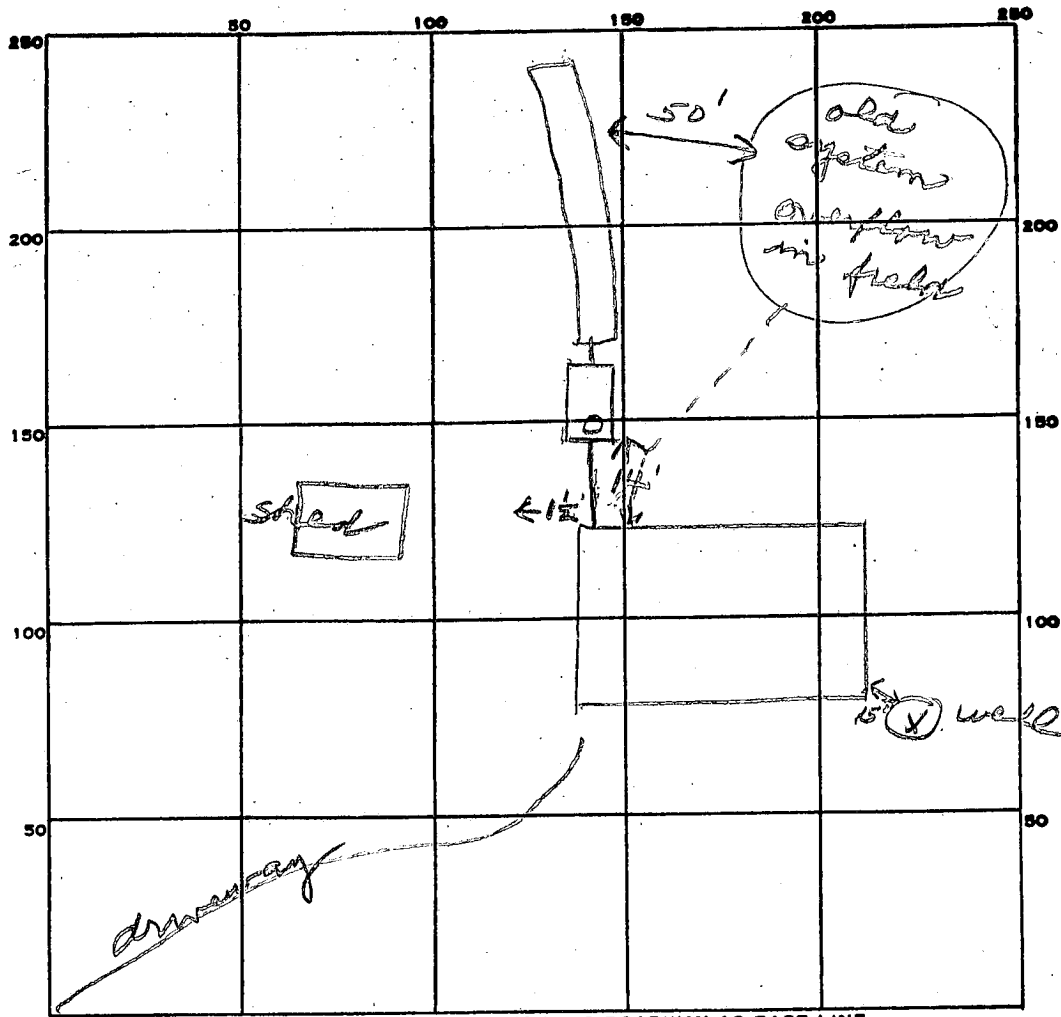

INDICATE NORTH. - NAME ADJOINING ROADWAY AS BASE LINE.

Rd 97

PERMIT CARD _____

SEPTIC TANK, LEVEL ✓ 1000 gal CLEANOUTS ST

DISTRIBUTION BOX, LEVEL _____

TILE FIELD, DEPTH 10 FT. TRENCH WIDTH 3 FT.

GRAVEL DEPTH 6 1/2 IN. TOTAL LENGTH 65 FT.

NUMBER OF TRENCHES 1 TOTAL BOTTOM AREA 422 +

SEEPAGE PITS, INSIDE DIAMETER _____ FT. DEPTH BELOW INLET _____ FT.

65
65

325
390

4225

ABSORBENT AREA 422 SQ. FT.

REMARKS 11/18/82 OK to add stone in trench. JS
11/18/82 OK to cover all work. JS

DATE SYSTEM APPROVED 11/18/82 INSPECTOR Stevens

10 A.M.

11-17-82.

Investigation of report of installation of a septic system without a permit (Illegal Installation) showed

upon arrival on site at Rt. 97 HOWARD CLARK PROPERTY, Edgewood Farm Inc.

- dirt spoil pile visible from road at end of house
- Bell telephone truck (tag # N 38150) operator informed me that several dump trucks of stone went into some driveway as house with spoil pile
- Back hoe & tractor tag # FA1701 with trailer tag # A39647 for hauling back hoe on site
- Tractor carrying sign JAMES L. GUE EXCAVATING - BACK hoe work, MONROVIA MD, 831-6228
- EXCAVATION existing for septic tank
- Trench dug with stone installed and perforated pipe installed, covered with red rosin paper
- Requested permit for job from JAMES GUE crew
I was informed there was none
- Requested JAMES GUE identify him self, of the three men on the job no one would answer, finally one of the crew requested my name to give to the owner to inform of my visit - I gave my business card

Before leaving the site I informed of need for permit and to stop work or legal action would be taken

Frommelt

PERMIT

P 32318

A REPAIR

SEWAGE DISPOSAL SYSTEM

MARYLAND STATE DEPARTMENT OF HEALTH*

HOWARD COUNTY

BUREAU OF ENVIRONMENTAL HEALTH
992-2330

ELLCOTT CITY

DISTRICT _____

DATE Nov. 17, 1982

James L. Gue

IS PERMITTED TO INSTALL _____ ALTER

ADDRESS Route 2, Monrovia, Md. 21770 PHONE 831-6228

SUBDIVISION _____ ROAD _____ LOT _____

PROPERTY OWNER _____

ADDRESS _____

IF GARBAGE GRINDER IS USED INCREASE SEPTIC TANK CAPACITY BY 50% AND ABSORPTION AREA BY 22%.

GARBAGE GRINDER? YES _____ NO _____

SEPTIC TANK CAPACITY _____ GALLONS NUMBER OF BEDROOMS _____

~~Permit secured after ditch dug with gravel and perforated pipe installed with paper over pipe & gravel, visible at end near excavation for septic tank. Open ground to a depth of 14' - 15' to expose soil to enable determination of length & depth of system to be installed. The securing of this permit ^{ex-} ~~ex-post-facto~~ in no way condones the illegal act of installing the septic system nor eliminated⁵ the Health Department from seeking legal action against you or the property owner. The permit is granted to eliminate any possible health hazard from occurring during possible legal action.~~

PLANS APPROVED BY Fred Frommelt DATE Nov. 17, 1982

COVER NO WORK UNTIL INSPECTED AND APPROVED.

NEITHER THE HOWARD COUNTY COUNCIL NOR THE HEALTH DEPARTMENT IS RESPONSIBLE FOR THE SUCCESSFUL OPERATION OF ANY SYSTEM.

NOTE: IF TRENCH IS USED CALL FOR INSPECTION BEFORE AND AFTER PLACING GRAVEL IN TRENCH.

NOTE: NO DRY WELL SHALL EXCEED 15 FOOT IN DIAMETER. NO ABSORPTION TRENCH TO EXCEED 100 FEET IN LENGTH.

NOTE: ALL PIPE FROM HOUSE TO SEPTIC TANK MUST BE CAST IRON OR SCHEDULE 40 PVC OR ABS.

PERMIT VOID AFTER THREE YEARS.

NOTE: INSTALL STAND PIPE ON SEPTIC TANK AND DRY WELL. STAND PIPES MUST BE 6 INCHES IN DIAMETER. CAST IRON, CONCRETE OR TERRA COTTA, OR PVC OR ABS ACCEPTED. IF TOP OF SEPTIC TANK IS DEEPER THAN 3 FEET MANHOLE TO GRADE REQUIRED.

***INSTALLER IS RESPONSIBLE FOR OBTAINING FINAL APPROVAL ON THIS PERMIT**

*CALL 992-2330 FOR INSPECTION OF SEPTIC SYSTEMS.

EH - 2-1082