

9/9/82

04-370387

PERMIT

approved 9/9/82
Staples P 32137

SEWAGE DISPOSAL SYSTEM

A Repair

MARYLAND STATE DEPARTMENT OF HEALTH

HOWARD COUNTY

INDEX

ELLICOTT CITY

must dig out to 14'-15' in trench to allow for evaluation of ground if OK, trench to 10' accept the 77

DISTRICT 3rd

DATE 8/31/82

Jack Fyock

IS PERMITTED TO INSTALL ALTER X

ADDRESS 13775 Triadelphia Road, Glenelg, Md. 21737 PHONE 988-9270

SUBDIVISION Burntwood ROAD 14011 Ardara Court LOT 14, Blk. C, Sec. 3

PROPERTY OWNER John Staples

ADDRESS 14011 Ardara Court, Glenwood, Md. 21738 Phone: 4894396

SPECIFICATIONS

SEPTIC TANK CAPACITY _____ GALLONS

DRAIN FIELD _____ DEPTH _____ FEET, BOTTOM AREA _____ SQ. FT.

DEEP TRENCH _____ DEPTH _____ FEET, BOTTOM AREA _____ SQ. FT.

SEEPAGE PITS _____ ABSORBENT SIDE-WALL AREA _____ SQ. FT.

INLET PIPE _____ FT. BELOW ORIGINAL GRADE. MAXIMUM DEPTH _____ FT. BELOW ORIGINAL GRADE

EFFECTIVE DEPTH AT _____ FT. BELOW ORIGINAL GRADE.

LOCATE DISPOSAL AREA _____ FT. FROM _____ LOT LINE AND _____ FT. FROM _____ LOT LINE AS SEEN WHEN
FACING LOT FROM

REPAIR - Add 300 sq. ft. to system in trench. Inlet at 4 1/2 ft. below original

grade and maximum depth 9 ft. below original grade; conditions permit-

ting.

PLANS APPROVED BY Fred Frommelt DATE 8/31/82

COVER NO WORK UNTIL INSPECTED AND APPROVED.

NEITHER THE HOWARD COUNTY COUNCIL NOR THE HEALTH DEPARTMENT IS RESPONSIBLE FOR THE SUCCESSFUL OPERATION OF ANY SYSTEM.

NOTE: IF TRENCH IS USED CALL FOR INSPECTION BEFORE PLACING GRAVEL IN TRENCH.

NOTE: NO DRY WELL SHALL EXCEED 15 FOOT IN DIAMETER.

NOTE: ALL PIPE FROM HOUSE TO DISPOSAL AREA MUST BE CAST IRON.

PERMIT VOID AFTER THREE YEARS.

NOTE: INSTALL STAND PIPE ON SEPTIC TANK AND DRY WELL. STAND PIPES MUST BE 8 INCHES IN DIAMETER. CAST IRON, CONCRETE OR TERRA
COTTA ACCEPTED.

*INSTALLER IS RESPONSIBLE FOR OBTAINING FINAL APPROVAL ON THIS PERMIT.

XP 32137

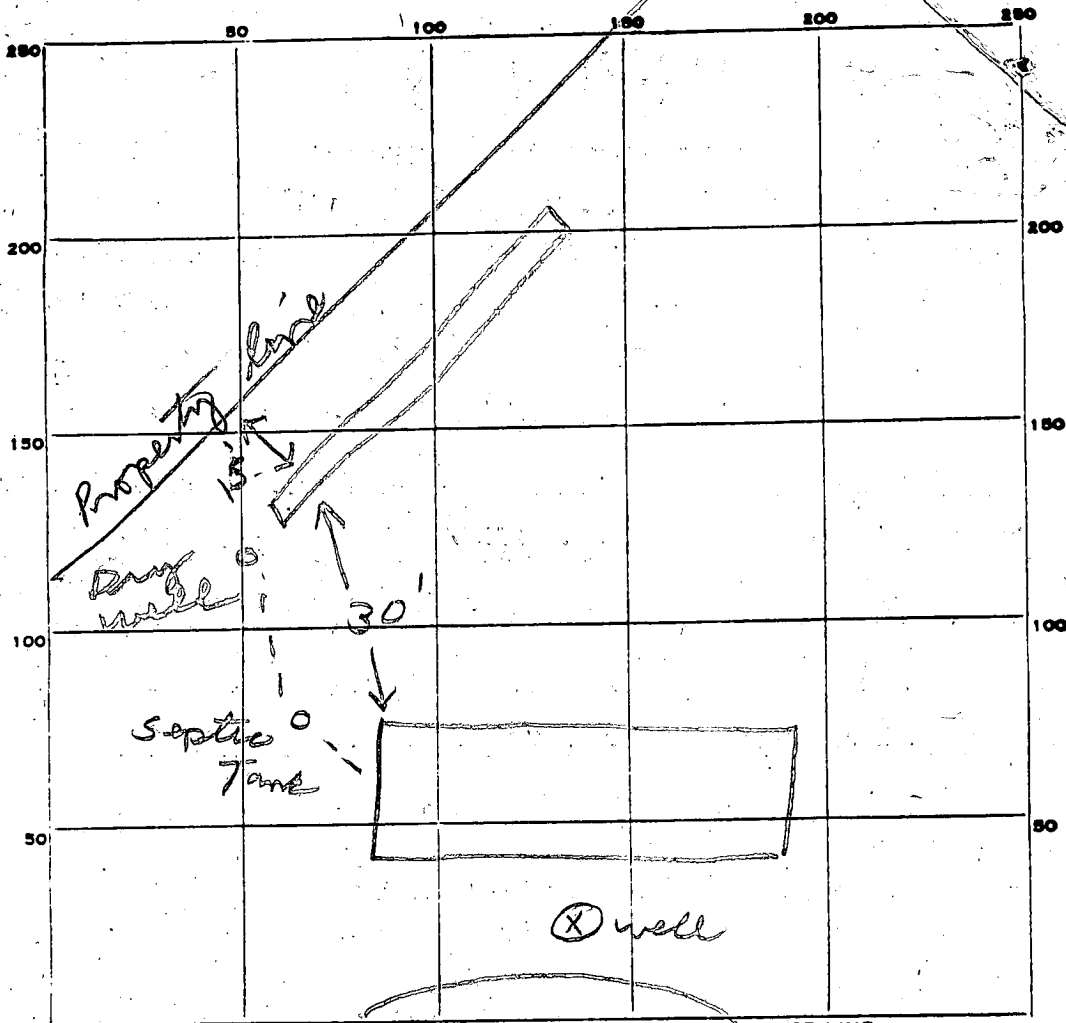

INDICATE NORTH. - NAME ADJOINING ROADWAY AS BASE LINE.

← Indiana Ct.

PERMIT CARD _____

SEPTIC TANK, LEVEL _____

CLEANOUTS _____

DISTRIBUTION BOX, LEVEL _____

TILE FIELD, DEPTH 10 1/2 FT. TRENCH WIDTH 2 FT.

GRAVEL DEPTH 6 1/2 IN. TOTAL LENGTH 50 FT.

6.5
50
3250

NUMBER OF TRENCHES 1 TOTAL BOTTOM AREA 325

SEEPAGE PITS, INSIDE DIAMETER _____ FT. DEPTH BELOW INLET _____ FT.

ABSORBENT AREA 325 SQ. FT.

REMARKS 9/9/82 - 14 1/2 ft Visual hole dug - sand at 12 ft. no down.

9/9/82 OK to add stone in trenches. J

9/9/82 - OK to cover all work. J

DATE SYSTEM APPROVED 9/9/82

INSPECTOR Stayer

opp 11/17/66

slw

P 11909

A 09051

PERMIT

SEWAGE DISPOSAL SYSTEM

MARYLAND STATE DEPARTMENT OF HEALTH

HOWARD COUNTY

ELLICOTT CITY

DISTRICT 3

DATE 6/15/66

INDEXED

Elwood Scaggs IS PERMITTED TO INSTALL ALTER

ADDRESS Mercury Rd., Fulton PHONE PA.5-0324

A SEWAGE DISPOSAL SYSTEM LOCATED AT Burnt Woods

SUBDIVISION Burnt Woods ROAD Ardara Court LOT 14, Blk C, Sec 3

PROPERTY OWNER Carroll & Shirley Hahn

ADDRESS Ellicott City

SPECIFICATIONS

DRAIN FIELD _____ DEPTH _____ FEET, BOTTOM AREA _____ SQ. FT.

SEEPAGE PITS _____ ABSORBENT SIDE-WALL AREA _____ SQ. FT.

SEPTIC TANK CAPACITY 1,000 GALLONS

FOR GARBAGE GRINDER, INCREASE DISPOSAL AREA 22% & TANK CAPACITY 50%.

OTHER Dry Well - 108 sq. ft. sidewall area below inlet pipe per bedroom.

Place dry well about 60 ft. from front lot line and about 15 ft.

from left sideline as seen when facing lot from Ardara Court (Ct. C)

Detail - 9/14/66 - Dry Well - 400 sq ft absorbent sidewall area below inlet pipe, inlet pipe no deeper than 4 ft below original grade. Place dry well at point 6 ft behind house and about 3 ft to the left of the left rear corner of house as seen when facing from the front. D.W.H.

PLANS APPROVED BY D. W. Monaghan DATE 9/8/64

FILL SEPTIC TANK AND DISTRIBUTION BOX WITH WATER BEFORE CALLING FOR AN INSPECTION. COVER NO WORK UNTIL INSPECTED AND APPROVED.

NEITHER THE HOWARD COUNTY COMMISSIONERS NOR THE HEALTH DEPARTMENT IS RESPONSIBLE FOR THE SUCCESSFUL OPERATION OF ANY SYSTEM.

A 09051

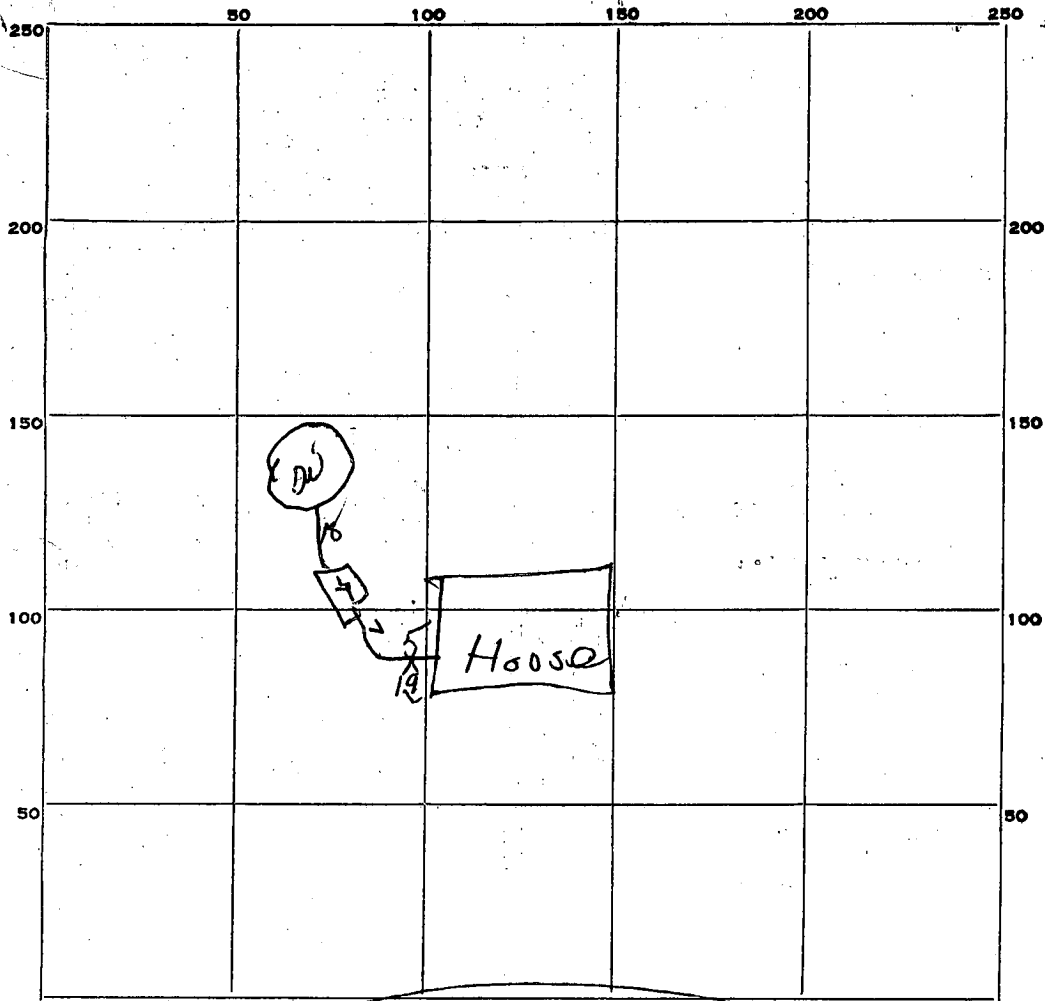

INDICATE NORTH. - NAME ADJOINING ROADWAY AS BASE LINE.

OK *adara Ct*

PERMIT CARD _____

SEPTIC TANK, LEVEL *OK* CLEANOUTS *OK*

DISTRIBUTION BOX, LEVEL _____

TILE FIELD, DEPTH _____ FT. TRENCH WIDTH _____ FT.

GRAVEL DEPTH _____ IN. TOTAL LENGTH _____ FT.

NUMBER OF TRENCHES _____ TOTAL BOTTOM AREA _____

SEEPAGE PITS, INSIDE DIAMETER *outside 13 FT* FT. DEPTH BELOW INLET *11* FT.

ABSORBENT AREA *449* SQ. FT.

REMARKS _____

DATE SYSTEM APPROVED *11/17/66* INSPECTOR *Edw. Murphy*

Retest
9-16-66
150

APPLICATION

A 12180

P _____

SEWAGE DISPOSAL TESTING

MARYLAND STATE DEPARTMENT OF HEALTH

HOWARD COUNTY

ELLICOTT CITY

DISTRICT 3

DATE 9/13/66

*9/14/66 - see permit
for new 5 pipe sewer*
RETEST

TO: THE COUNTY HEALTH OFFICER
ELLICOTT CITY, MARYLAND

I, HEREBY, APPLY FOR THE NECESSARY TESTS IN ORDER TO CONSTRUCT (OR RECONSTRUCT) A SEWAGE DISPOSAL SYSTEM.

PROPERTY OWNER Burnt Woods Development Co., Inc.

ADDRESS 212 Crownwood Rd., E.C. PHONE HO 5-1345

PROPERTY LOCATION:

SUBDIVISION Burnt Wood LOT NO. 14, Blk. C, Sec..3, pt. 2

ROAD AND DESCRIPTION Ardera Court

OCCUPANT _____ PHONE _____

PERSON TO CONSTRUCT SYSTEM _____

ADDRESS _____ PHONE _____

SIZE OF LOT 65' x 205' x 295' TYPE BLDG. 4
NUMBER OF BEDROOMS

IF NOT SINGLE RESIDENCE DESCRIBE _____

SIGNATURE OF APPLICANT *Lloyd C. Johnson*

APPROVED BY *Donald W. Managhan* FOR *Dry Well* DATE *9/15/66*
(KIND OF SYSTEM)

REJECTED BY _____ FOR _____ DATE _____
(KIND OF SYSTEM)

HOLD PENDING FURTHER TESTS _____ DATE _____

REASONS FOR REJECTION OR HOLDING _____

THIS IS NOT A PERMIT

00115

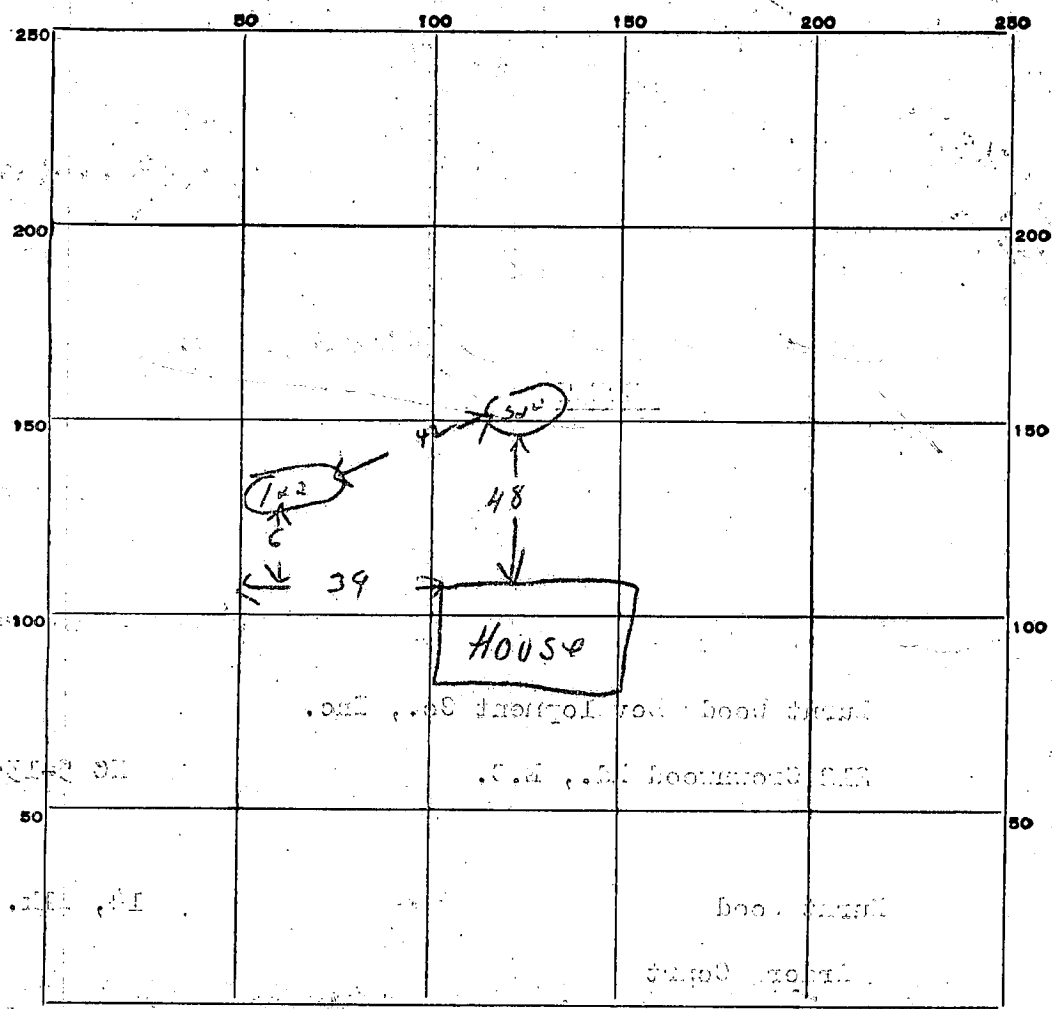

INDICATE NORTH. - NAME ADJOINING ROADWAY AS BASE LINE.

Ordina Co.

DATE	TEST NO.	DEPTH	PRE-WET		TEST - 1" DROP		TIME
			START	STOP	START	STOP	
9/12/66	1	10 1/2	9	9	9	9	7 min
	2	5 1/2	9	9	9	9	8 min
	3	9 1/2	9	10	10	10	7 min
	4	4 1/2	10	10	10	10	4 min

on 922

SOIL AUGER FINDING *SWM*

TESTED BY _____

REMARKS *See glass Connell*

APPLICATION

A 12180

P _____

SEWAGE DISPOSAL TESTING

MARYLAND STATE DEPARTMENT OF HEALTH

HOWARD COUNTY

ELLICOTT CITY

DISTRICT 5

DATE 9/13/66

RETEST

TO: THE COUNTY HEALTH OFFICER
ELLICOTT CITY, MARYLAND

I, HEREBY, APPLY FOR THE NECESSARY TESTS IN ORDER TO CONSTRUCT (OR RECONSTRUCT) A SEWAGE DISPOSAL SYSTEM.

PROPERTY OWNER Burnt Woods Development Co., Inc.

ADDRESS 212 Crownwood Rd., E.C. PHONE HO 5-1345

PROPERTY LOCATION:

SUBDIVISION Burnt Wood LOT NO. 14, Blk. C, Sec. 3, pt. 2

ROAD AND DESCRIPTION Ardera Court

OCCUPANT _____ PHONE _____

PERSON TO CONSTRUCT SYSTEM _____

ADDRESS _____ PHONE _____

SIZE OF LOT 65' x 205' x 295' TYPE BLDG. 4
NUMBER OF BEDROOMS _____

IF NOT SINGLE RESIDENCE DESCRIBE _____

SIGNATURE OF APPLICANT Lloyd C. Johnson

APPROVED BY Donald W. Managhan FOR Dry Well DATE 9/13/66
(KIND OF SYSTEM)

REJECTED BY _____ FOR _____ DATE _____
(KIND OF SYSTEM)

HOLD PENDING FURTHER TESTS _____ DATE _____

REASONS FOR REJECTION OR HOLDING _____

THIS IS NOT A PERMIT

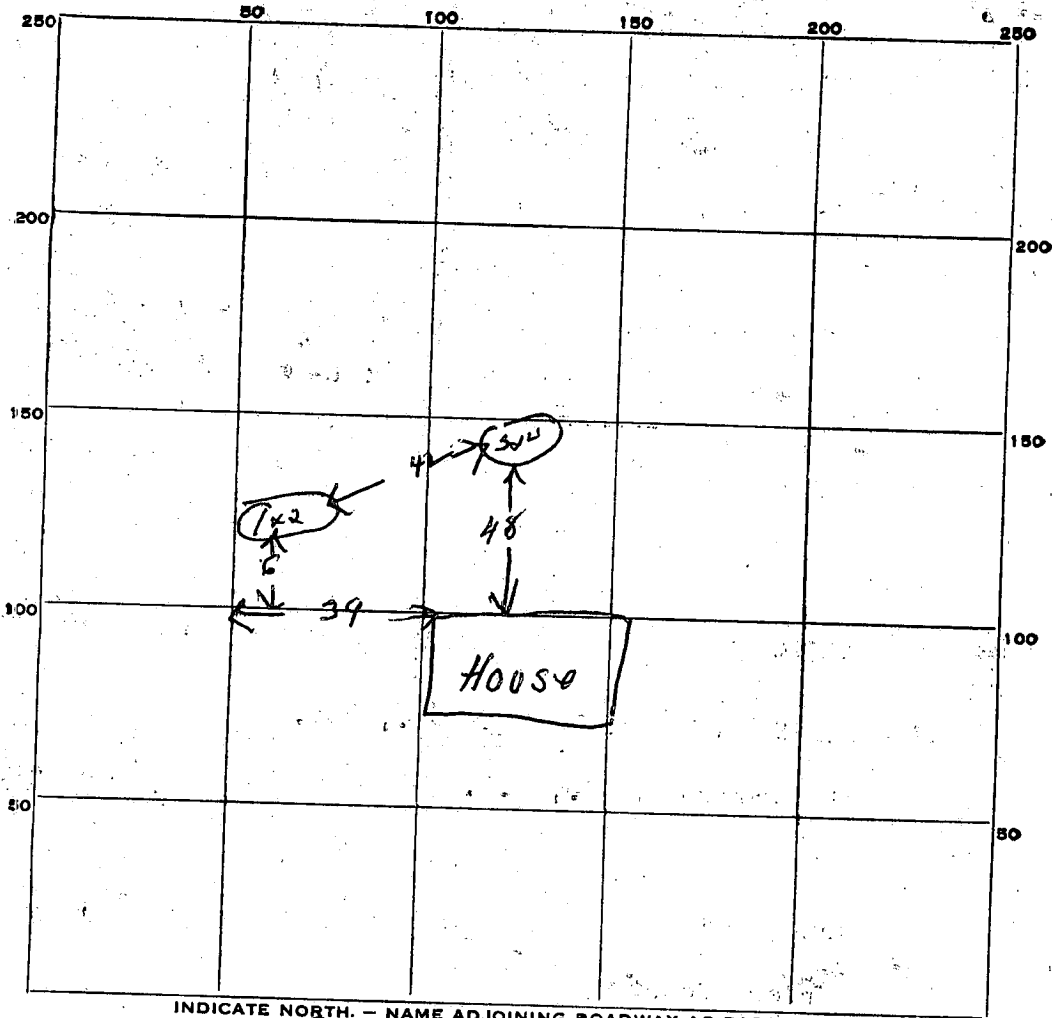

INDICATE NORTH. - NAME ADJOINING ROADWAY AS BASE LINE.

Ardara Ct

DATE	TEST NO.	DEPTH	PRE-WET		TEST - 1" DROP		TIME
			START	STOP	START	STOP	
9/14/66	1	10 ft	9 24	9 48	9 48	9 55	7 min
	2	5 ft	9 44	9 48	9 49	9 57	8 min
	3	9 1/2	9 58	10 05	10 05	10 12	7 min
	4	4 ft	10 00	10 03	10 03	10 07	4 min

no 937

SOIL AUGER FINDING _____

TESTED BY *DUM*

REMARKS _____

abandon - Douglas Connell

APPLICATION

A 09051

SEWAGE DISPOSAL TESTING

P _____

MARYLAND STATE DEPARTMENT OF HEALTH

HOWARD COUNTY

ELLICOTT CITY

Septic Tank - 3 bedroom - 750 gal
4 " - 1,000 gal
5 " - 1,500 gal

DISTRICT 3

DATE 9/10/64

Dry Well - 108 sq ft sidewall and below inlet pipe per bedroom
Place Dry Well about 60 ft from front lot line and about 15 ft from
left side line or rear unless facing lot from Court C.

TO: THE COUNTY HEALTH OFFICER
ELLICOTT CITY, MARYLAND

I, HEREBY, APPLY FOR THE NECESSARY TESTS IN ORDER TO CONSTRUCT (OR RECONSTRUCT) A SEWAGE DISPOSAL SYSTEM.

PROPERTY OWNER Burnt Woods Development Co., Inc.

ADDRESS 212 Crownwood Road, E. C., Md. PHONE HO 5-1345

PROPERTY LOCATION:

SUBDIVISION Burnt Wood LOT NO. 14, Blk. C, Sec. 302

ROAD AND DESCRIPTION Andora Court "C"

OCCUPANT _____ PHONE _____

PERSON TO CONSTRUCT SYSTEM _____

ADDRESS _____ PHONE _____

SIZE OF LOT 65' x 205' x 295' TYPE BLDG. test per bedroom
NUMBER OF BEDROOMS

IF NOT SINGLE RESIDENCE DESCRIBE _____

SIGNATURE OF APPLICANT /s/ M. A. Wakefield, Jr.

APPROVED BY Dev Monaghan FOR Dry Well DATE 9/09/64
(KIND OF SYSTEM)

REJECTED BY _____ FOR _____ DATE _____
(KIND OF SYSTEM)

HOLD PENDING FURTHER TESTS _____ DATE _____

REASONS FOR REJECTION OR HOLDING _____

THIS IS NOT A PERMIT

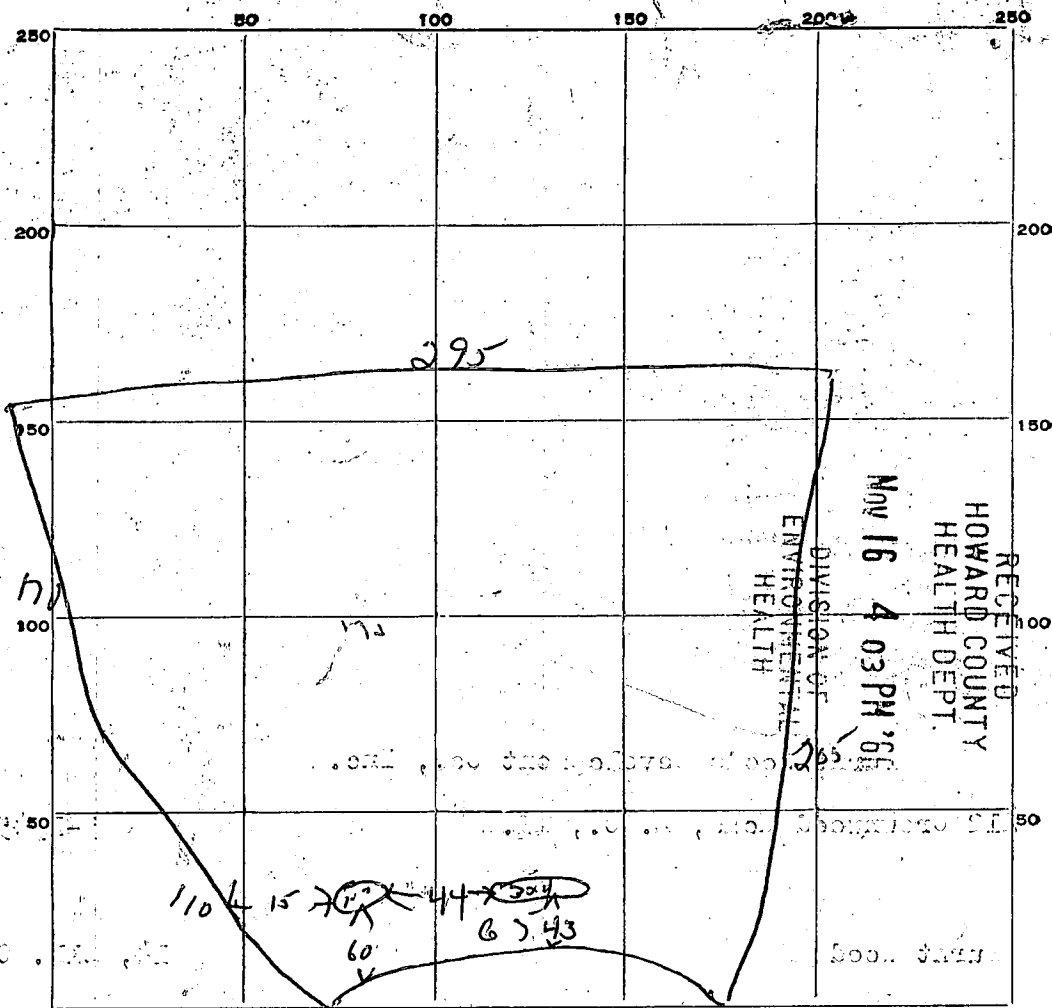

DATE	TEST NO.	DEPTH	PRE-WET		TEST - 1" DROP		TIME
			START	STOP	START	STOP	
9/15/64	1	5 1/2 ft	1201	1203	1203	1209	5 min
	2	10 ft	1201	1203	1203	1216	7 min
	3	5 1/2 ft	1206	1211	1211	1222	11 min
	4	10 ft	1205	1209	1209	1219	10 min

SOIL AUGER FINDING _____

TESTED BY Rum 9/15/64

REMARKS _____

ALSO PRESENT _____

S. Both

LOT NO. 146 Sec 3 part 2