

7/15/82  
9:30 A.M.  
7/22/82 around noon

# PERMIT

APPROVED  
7/22/82  
P 32023  
A REPAIR

SEWAGE DISPOSAL SYSTEM

MARYLAND STATE DEPARTMENT OF HEALTH

HOWARD COUNTY

01-164368

ELLICOTT CITY

DISTRICT 1st.

## INDEX

DATE 7/12/82

Otis Ketterman  
O F K Construction Service

IS PERMITTED TO INSTALL \_\_\_\_\_ ALTER X

ADDRESS 4647 Manor Lane, Ellicott City, Maryland PHONE 992-0062

SUBDIVISION \_\_\_\_\_ ROAD 5628 Montgomery Road LOT \_\_\_\_\_

PROPERTY OWNER Edward Eckart PHONE: 796-1044

ADDRESS 5628 Montgomery Road

### SPECIFICATIONS

SEPTIC TANK CAPACITY \_\_\_\_\_ GALLONS

DRAIN FIELD \_\_\_\_\_ DEPTH \_\_\_\_\_ FEET, BOTTOM AREA \_\_\_\_\_ SQ. FT.

DEEP TRENCH \_\_\_\_\_ DEPTH \_\_\_\_\_ FEET, BOTTOM AREA \_\_\_\_\_ SQ. FT.

SEEPAGE PITS \_\_\_\_\_ ABSORBENT SIDE-WALL AREA \_\_\_\_\_ SQ. FT.

INLET PIPE \_\_\_\_\_ FT. BELOW ORIGINAL GRADE, MAXIMUM DEPTH \_\_\_\_\_ FT. BELOW ORIGINAL GRADE

EFFECTIVE DEPTH AT \_\_\_\_\_ FT. BELOW ORIGINAL GRADE.

LOCATE DISPOSAL AREA \_\_\_\_\_ FT. FROM \_\_\_\_\_ LOT LINE AND \_\_\_\_\_ FT. FROM \_\_\_\_\_ LOT LINE AS SEEN WHEN FACING LOT FROM

REPAIR - CALL FOR INSPECTION WHEN GROUND IS OPENED UP SO SANITARIAN CAN RECOMMEND REPAIR.

Trench - 5 ft wide - 4 ft deep with 1 1/2 ft of stone.  
Trench to run across property 10 ft from each side of property  
J.S. 7/15/82

PLANS APPROVED BY Palmer F. Wine DATE 7/12/82

COVER NO WORK UNTIL INSPECTED AND APPROVED.

NEITHER THE HOWARD COUNTY COUNCIL NOR THE HEALTH DEPARTMENT IS RESPONSIBLE FOR THE SUCCESSFUL OPERATION OF ANY SYSTEM.

NOTE: IF TRENCH IS USED CALL FOR INSPECTION BEFORE PLACING GRAVEL IN TRENCH.

NOTE: NO DRY WELL SHALL EXCEED 15 FOOT IN DIAMETER.

NOTE: ALL PIPE FROM HOUSE TO DISPOSAL AREA MUST BE CAST IRON.

PERMIT VOID AFTER THREE YEARS.

NOTE: INSTALL STAND PIPE ON SEPTIC TANK AND DRY WELL. STAND PIPES MUST BE 6 INCHES IN DIAMETER. CAST IRON, CONCRETE OR TERRAZZO ACCEPTED.

\*INSTALLER IS RESPONSIBLE FOR OBTAINING FINAL APPROVAL ON THIS PERMIT.

P 32023

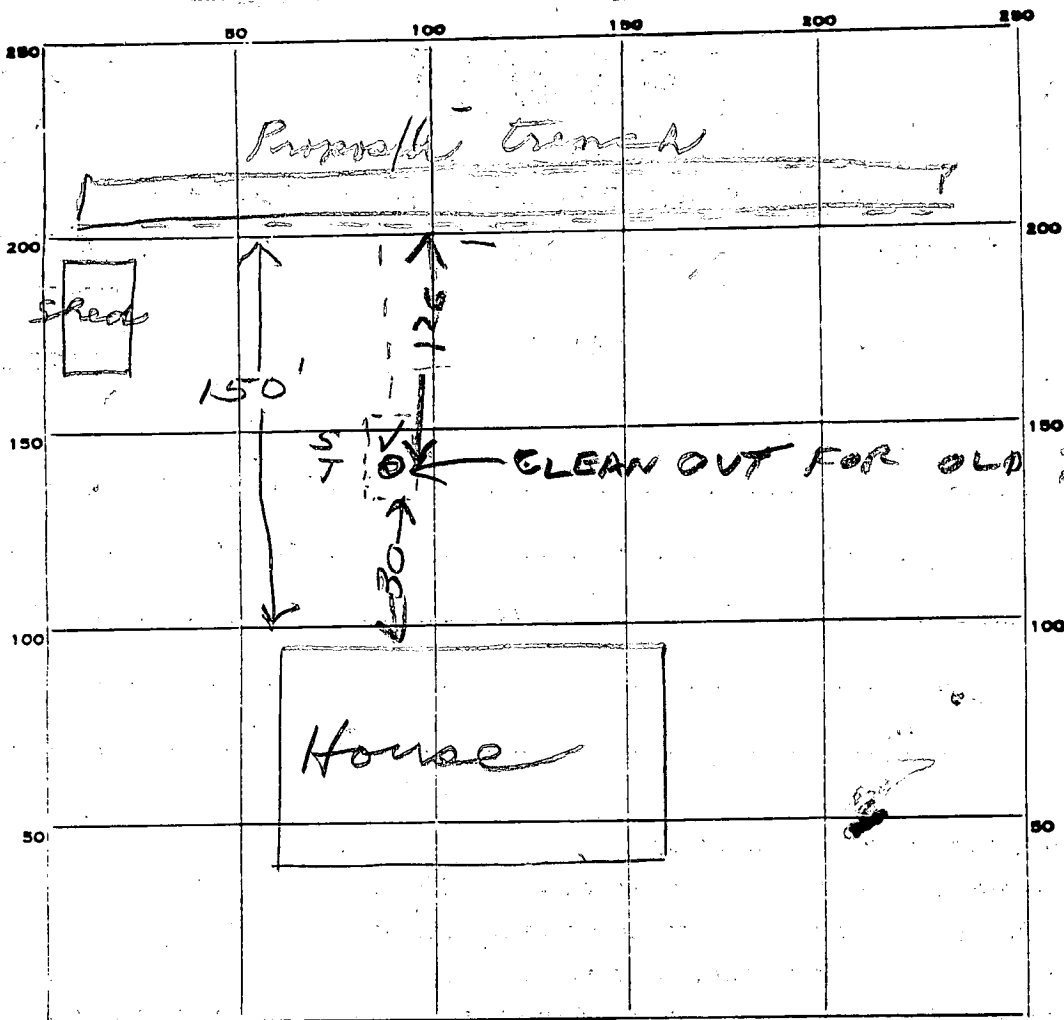

INDICATE NORTH - NAME ADJOINING ROADWAY AS BASE LINE.

Montgomery Rd.

525  
23

PERMIT CARD \_\_\_\_\_

SEPTIC TANK, LEVEL \_\_\_\_\_

CLEANOUTS \_\_\_\_\_

DISTRIBUTION BOX, LEVEL \_\_\_\_\_

TILE FIELD, DEPTH 4-7 FT. TRENCH WIDTH 6 FT.

GRAVEL DEPTH 2 FT IN. TOTAL LENGTH 70 FT.

NUMBER OF TRENCHES 1 TOTAL BOTTOM AREA 468

SEEPAGE PITS, INSIDE DIAMETER \_\_\_\_\_ FT. DEPTH BELOW INLET \_\_\_\_\_ FT.

ABSORBENT AREA \_\_\_\_\_ SQ. FT.

REMARKS

7/22/82 HOME OWNER MEASURED DEPTH OF DITCH SEE ATTACHED PAPER

DATE SYSTEM APPROVED

7/22/82

INSPECTOR

Raymond Hodges

P32023

Edward E. Hunt  
5628 Montgomery Rd  
Elliott City, Md 21043

On 7/20/82 a six ft. wide 78 ft long and tapered from  $4\frac{1}{2}$  ft at one end and  $7\frac{1}{2}$  ft at the other was dug.

On 7/22/82 app  $2\frac{1}{2}$  ft of #2 gravel was put into the hole along with enough pipe to go from end to end to repair my septic system.

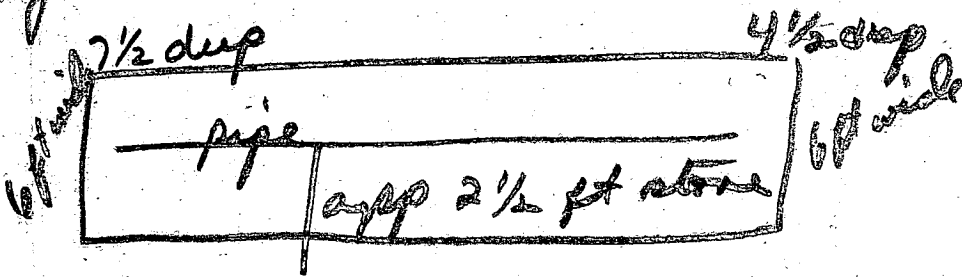

Edward E. Hunt