

4/10/84
around noon

approved
4/10/84
William

PERMIT

P 33764
A Repair

SEWAGE DISPOSAL SYSTEM

MARYLAND STATE DEPARTMENT OF HEALTH

HOWARD COUNTY
BUREAU OF ENVIRONMENTAL HEALTH
992-2330

INDEX

04-320530

ELLICOTT CITY
DISTRICT 4th
DATE 4/10/84

Jack Fyock _____ IS PERMITTED TO INSTALL _____ ALTER

ADDRESS 13775 Triadelphia Road, Glenelg, Md. 21737 PHONE 988-9270

SUBDIVISION _____ ROAD 1860 Daisy Road LOT _____

PROPERTY OWNER Mr. L. Kevin Kelly

ADDRESS 1860 Daisy Road, Woodbine, Maryland 21797 Phone: 854-6261

IF GARBAGE GRINDER IS USED INCREASE SEPTIC TANK CAPACITY BY 50% AND ABSORPTION AREA BY 22%.

GARBAGE GRINDER? YES _____ NO _____

SEPTIC TANK CAPACITY _____ GALLONS NUMBER OF BEDROOMS _____

REPAIR - Call for an appointment when ground is opened up and Sanitarian will recommend the repair area.

53
371

PLANS APPROVED BY Frank A. Skinner DATE 4/10/84

COVER NO WORK UNTIL INSPECTED AND APPROVED.
NEITHER THE HOWARD COUNTY COUNCIL NOR THE HEALTH DEPARTMENT IS RESPONSIBLE FOR THE SUCCESSFUL OPERATION OF ANY SYSTEM.
NOTE: IF TRENCH IS USED CALL FOR INSPECTION BEFORE AND AFTER PLACING GRAVEL IN TRENCH.
NOTE: NO DRY WELL SHALL EXCEED 15 FOOT IN DIAMETER. NO ABSORPTION TRENCH TO EXCEED 100 FEET IN LENGTH.
NOTE: ALL PIPE FROM HOUSE TO SEPTIC TANK MUST BE CAST IRON OR SCHEDULE 40 PVC OR ABS.
PERMIT VOID AFTER THREE YEARS.
NOTE: INSTALL STAND PIPE ON SEPTIC TANK AND DRY WELL. STAND PIPES MUST BE 6 INCHES IN DIAMETER. CAST IRON, CONCRETE OR TERRA COTTA, OR PVC OR ABS ACCEPTED. IF TOP OF SEPTIC TANK IS DEEPER THAN 3 FEET MANHOLE TO GRADE REQUIRED.

***INSTALLER IS RESPONSIBLE FOR OBTAINING FINAL APPROVAL ON THIS PERMIT**

*CALL 992-2330 FOR INSPECTION OF SEPTIC SYSTEMS.

EH - 2-1082

P 33764

P 33764 Repair

1860 Daisy Road

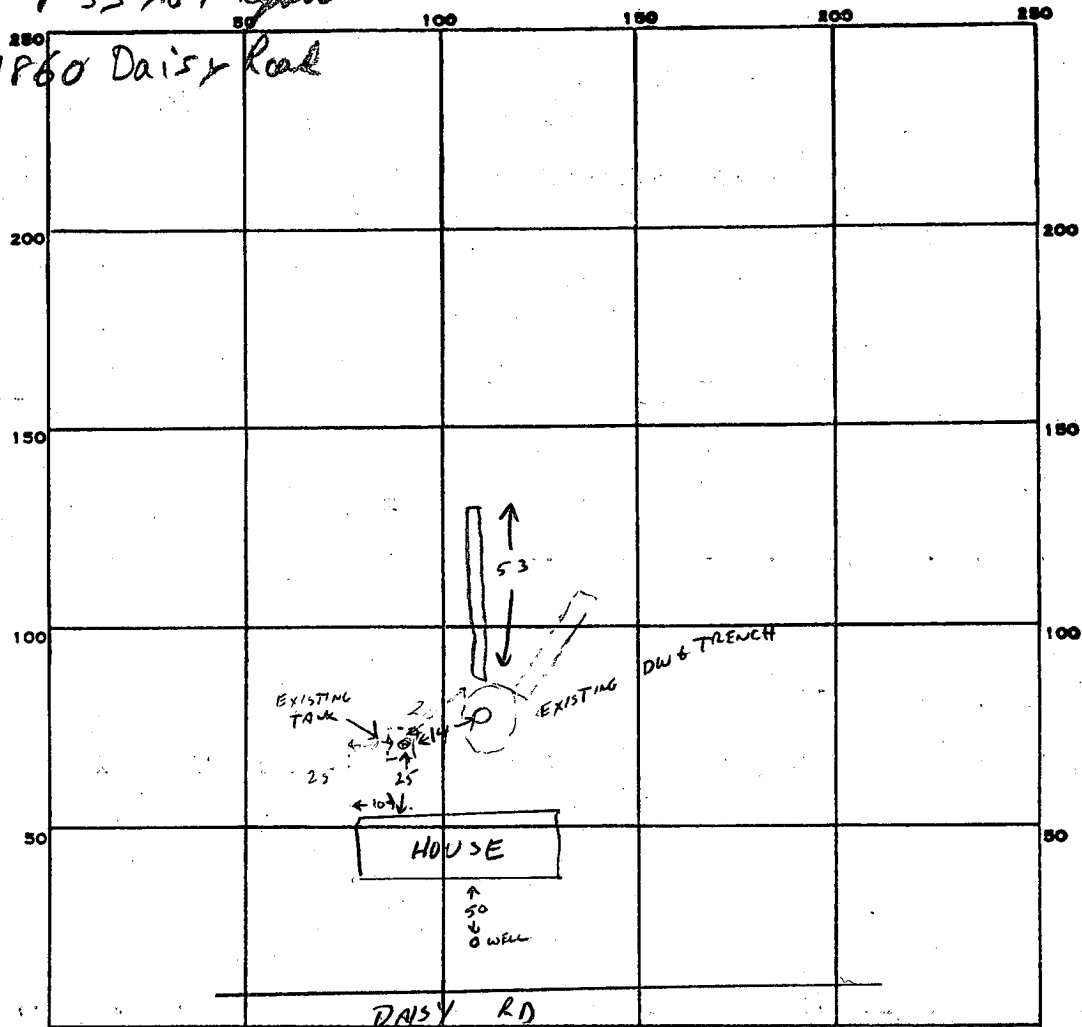

INDICATE NORTH. - NAME ADJOINING ROADWAY AS BASE LINE.

PERMIT CARD

SEPTIC TANK, LEVEL EXISTING

CLEANOUTS EXISTING ST

DISTRIBUTION BOX, LEVEL N/A

TILE FIELD, DEPTH 12 FT. TRENCH WIDTH 2 FT.

GRAVEL DEPTH 7 FT IN. TOTAL LENGTH 53 FT.

NUMBER OF TRENCHES 1 ^{ONE SIDEWALL} TOTAL BOTTOM AREA 371

SEEPAGE PITS, INSIDE DIAMETER _____ FT. DEPTH BELOW INLET _____ FT.

ABSORBENT AREA 371 SQ. FT. + EXISTING SYSTEM.

REMARKS

371 SQ FT TRENCH SYSTEM ADDED TO EXISTING DAYWELL -

MICA-SAND-LUAM SOIL. 4-11-84 Cullinan

DATE SYSTEM APPROVED 4-11-84

INSPECTOR Cullinan