

2/22/84  
2/24/84

Approved 2/24/84 C. Ed.  
File F.C.O.

# PERMIT

P 33576

A Repair

SEWAGE DISPOSAL SYSTEM

MARYLAND STATE DEPARTMENT OF HEALTH\*

HOWARD COUNTY  
BUREAU OF ENVIRONMENTAL HEALTH  
992-2330

## INDEX

ELLICOTT CITY  
DISTRICT 4th

04-330633

DATE 2/22/84

Herman Sirk IS PERMITTED TO INSTALL \_\_\_\_\_ ALTER X

ADDRESS 2555 Jennings Chapel Road, Woodbine, Md. 21797 PHONE 489-4724

SUBDIVISION \_\_\_\_\_ ROAD 17698 Annapolis Rock Rd

PROPERTY OWNER Mr. William R. Warfield

ADDRESS 17698 Annapolis Rock Road, Woodbine, Md. 21797 Phone: 442-2058

IF GARBAGE GRINDER IS USED INCREASE SEPTIC TANK CAPACITY BY 50% AND ABSORPTION AREA BY 22%.

GARBAGE GRINDER? YES \_\_\_\_\_ NO \_\_\_\_\_

SEPTIC TANK CAPACITY \_\_\_\_\_ GALLONS NUMBER OF BEDROOMS \_\_\_\_\_

Repair - Call for an appointment when ground is opened up and Sanitarian will recommend the repair system.

65' TRENCH 3'-10" ADDED TO EXISTING DRYWELL, CW 2-

BLDG. PERMIT SIGNED  
AND RETURNED 4/4/85

Serial # 64105 -  
Addition Bedroom  
DATE 2/22/84 Balkorn

PLANS APPROVED BY Frank A. Skinner

COVER NO WORK UNTIL INSPECTED AND APPROVED.

NEITHER THE HOWARD COUNTY COUNCIL NOR THE HEALTH DEPARTMENT IS RESPONSIBLE FOR THE SUCCESSFUL OPERATION OF ANY SYSTEM.

NOTE: IF TRENCH IS USED CALL FOR INSPECTION BEFORE AND AFTER PLACING GRAVEL IN TRENCH.

NOTE: NO DRY WELL SHALL EXCEED 15 FOOT IN DIAMETER. NO ABSORPTION TRENCH TO EXCEED 100 FEET IN LENGTH.

NOTE: ALL PIPE FROM HOUSE TO SEPTIC TANK MUST BE CAST IRON OR SCHEDULE 40 PVC OR ABS.

PERMIT VOID AFTER THREE YEARS.

NOTE: INSTALL STAND PIPE ON SEPTIC TANK AND DRY WELL. STAND PIPES MUST BE 6 INCHES IN DIAMETER. CAST IRON, CONCRETE OR TERRA COTTA, OR PVC OR ABS ACCEPTED. IF TOP OF SEPTIC TANK IS DEEPER THAN 3 FEET MANHOLE TO GRADE REQUIRED.

**\*INSTALLER IS RESPONSIBLE FOR OBTAINING FINAL APPROVAL ON THIS PERMIT**

\*CALL 992-2330 FOR INSPECTION OF SEPTIC SYSTEMS.

EH - 2-1082

P 33576

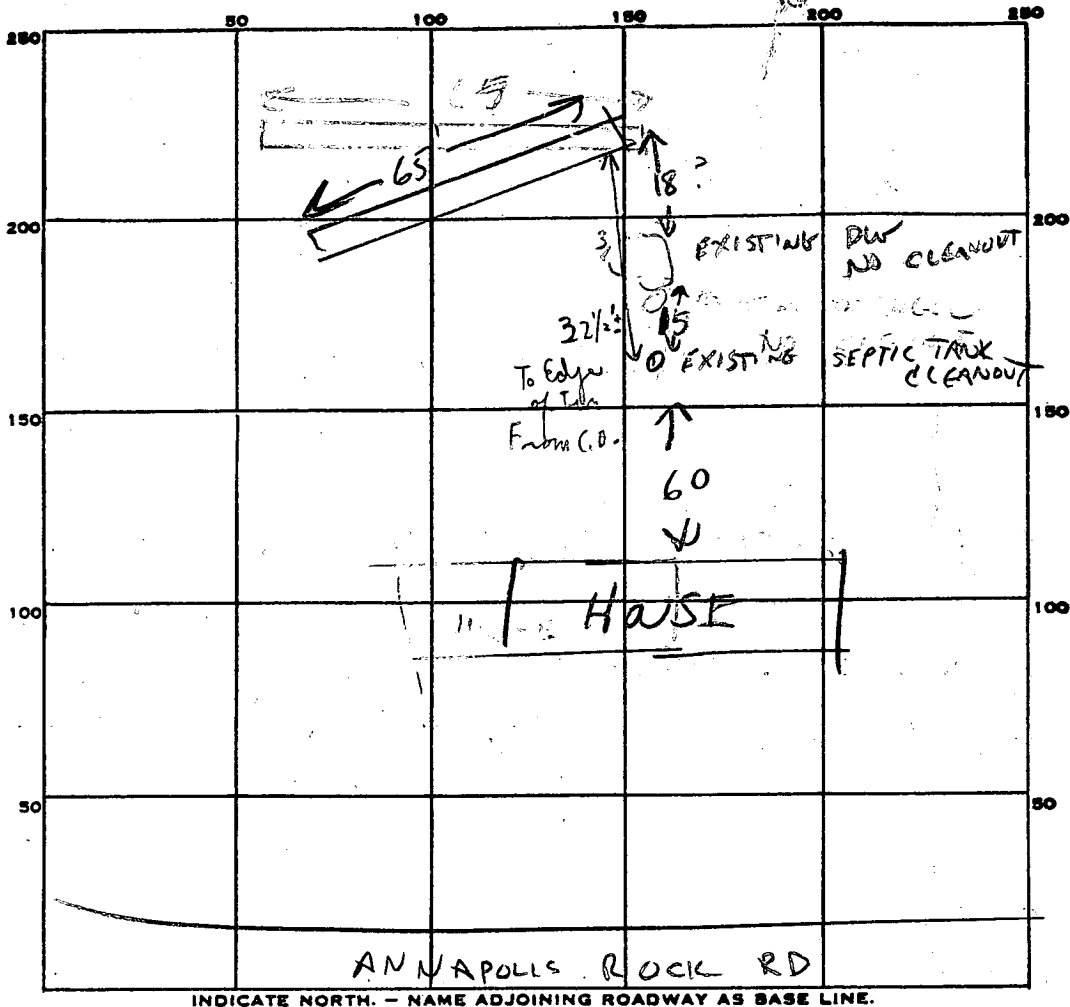

INDICATE NORTH. - NAME ADJOINING ROADWAY AS BASE LINE.

PERMIT CARD Left papers at machine

SEPTIC TANK, LEVEL - CLEANOUTS -

DISTRIBUTION BOX, LEVEL -

TILE FIELD, DEPTH 10' <sup>per 2/27</sup> <sub>CV</sub> FT. TRENCH WIDTH 2 FT.

GRAVEL DEPTH 8' + 1" IN. TOTAL LENGTH 66 FT.

NUMBER OF TRENCHES 1 <sup>1 SIDEWALL</sup> TOTAL BOTTOM AREA 528

SEEPAGE PITS, INSIDE DIAMETER - FT. DEPTH BELOW INLET - FT.

<sup>1 SIDEWALL</sup> ABSORBENT AREA 528 SQ. FT.

REMARKS Hold need depth

65' TRENCH DUG 2-22-84 CW Miller; 2/24/84 Paper on ground  
in trench to 2' to 2 1/2' from top - trench only used. Hold final  
for C. Williams; 2/27/84 Depth confirmed. C.B.P.

DATE SYSTEM APPROVED 2/27/84 INSPECTOR C.B. Theaker

George Richardson  
489-7035

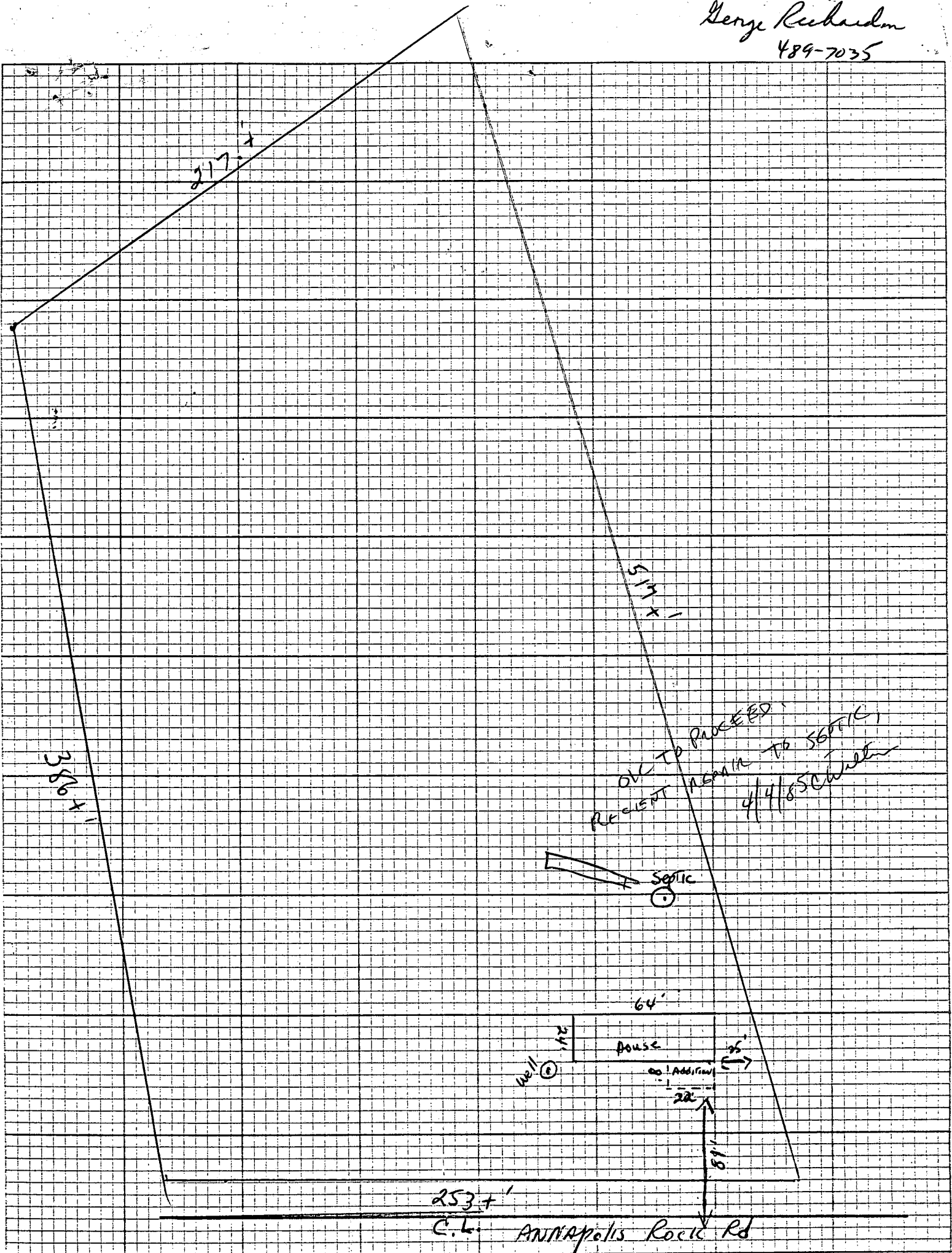

BEE 10x10 1" = 50' SCALE