

12/30/83
as soon as
possible

approved
12-30-83
C Williams

PERMIT

P 33435

A Repair

SEWAGE DISPOSAL SYSTEM

MARYLAND STATE DEPARTMENT OF HEALTH

HOWARD COUNTY

BUREAU OF ENVIRONMENTAL HEALTH
992-2330

05-423821

ELLICOTT CITY

DISTRICT 5th

INDEX

DATE 12/29/83

Jack Fyock

IS PERMITTED TO INSTALL _____ ALTER X

ADDRESS 13775 Triadelphia Road, Glenelg, Md. 21737 PHONE 988-9270

SUBDIVISION Cedar Acres ROAD 10891 Hilltop Lane LOT _____
Columbia, Maryland

PROPERTY OWNER Ken Wright - Mr. Wright has tenants living in this house

ADDRESS 14717 Carson Drive, Burtonsville, Md. 20866 Phone: 384-9556

IF GARBAGE GRINDER IS USED INCREASE SEPTIC TANK CAPACITY BY 50% AND ABSORPTION AREA BY 22%.

GARBAGE GRINDER? YES _____ NO _____

SEPTIC TANK CAPACITY _____ GALLONS NUMBER OF BEDROOMS _____

REPAIR - Call for an inspection when ground is opened up and Sanitarian will recommend the repair system.

2ND REPAIR OF SYSTEM. SANDY SOIL 6'-15'. TOP LAYER CHANGING TO SAND AT 6'.

INSTALL 70 TRENCH OFF EXISTING DRYWELL. INLET AT 5', BOTTOM AT 12'.

7 FT GRAVEL X 70 FT TRENCH = 490 FT² ABS AREA ADDED.

12-30-83 C Williams

PLANS APPROVED BY Frank A. Skinner DATE 12/29/83

COVER NO WORK UNTIL INSPECTED AND APPROVED.

NEITHER THE HOWARD COUNTY COUNCIL NOR THE HEALTH DEPARTMENT IS RESPONSIBLE FOR THE SUCCESSFUL OPERATION OF ANY SYSTEM.

NOTE: IF TRENCH IS USED CALL FOR INSPECTION BEFORE AND AFTER PLACING GRAVEL IN TRENCH.

NOTE: NO DRY WELL SHALL EXCEED 15 FOOT IN DIAMETER. NO ABSORPTION TRENCH TO EXCEED 100 FEET IN LENGTH.

NOTE: ALL PIPE FROM HOUSE TO SEPTIC TANK MUST BE CAST IRON OR SCHEDULE 40 PVC OR ABS.

PERMIT VOID AFTER THREE YEARS.

NOTE: INSTALL STAND PIPE ON SEPTIC TANK AND DRY WELL. STAND PIPES MUST BE 6 INCHES IN DIAMETER. CAST IRON, CONCRETE OR TERRA COTTA, OR PVC OR ABS ACCEPTED. IF TOP OF SEPTIC TANK IS DEEPER THAN 3 FEET MANHOLE TO GRADE REQUIRED.

***INSTALLER IS RESPONSIBLE FOR OBTAINING FINAL APROVAL ON THIS PERMIT**

*CALL 992-2330 FOR INSPECTION OF SEPTIC SYSTEMS.

EH - 2-1082

P 33435

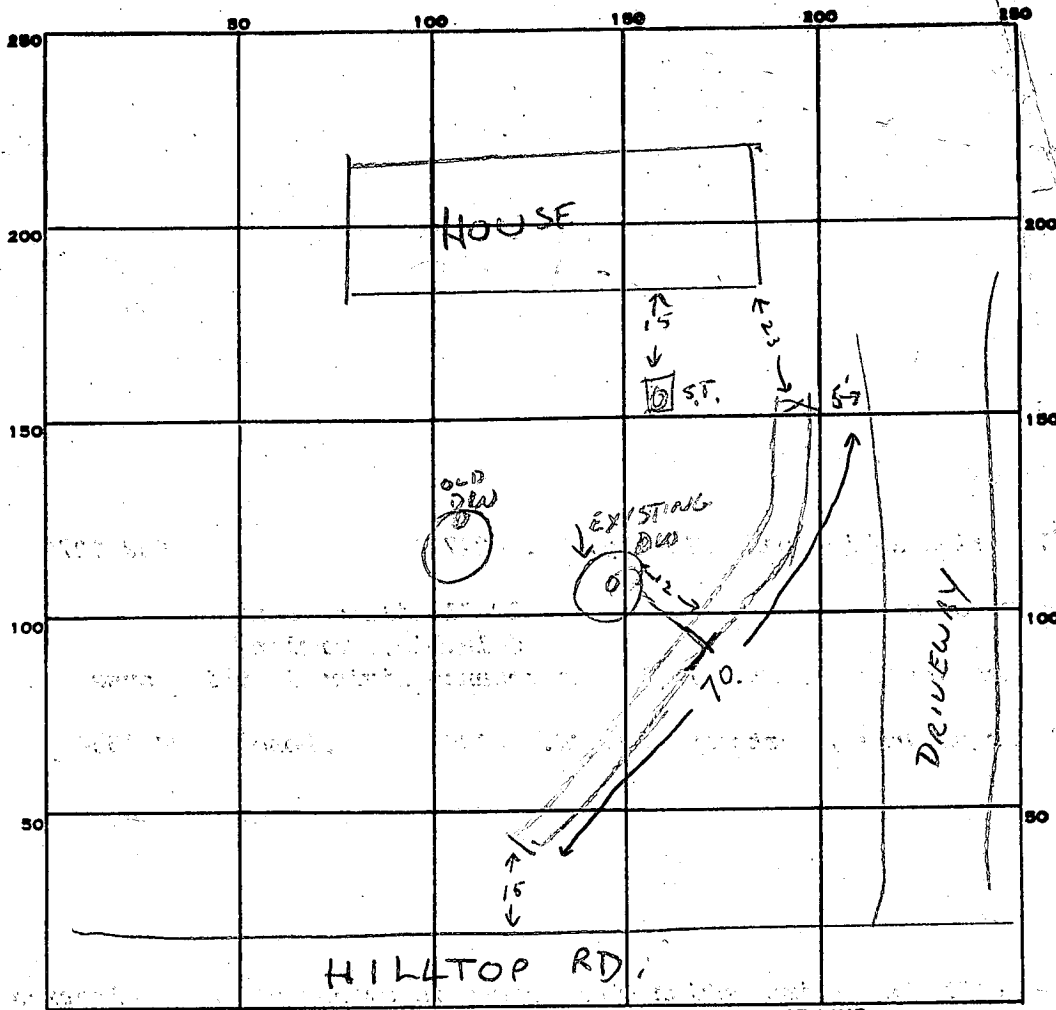

INDICATE NORTH. - NAME ADJOINING ROADWAY AS BASE LINE.

PERMIT CARD

SEPTIC TANK, LEVEL EXISTING

CLEANOUTS EXISTING

DISTRIBUTION BOX, LEVEL N/A

TILE FIELD, DEPTH 12 FT. TRENCH WIDTH 22 FT.

GRAVEL DEPTH 7 FT IN. TOTAL LENGTH 70 FT.

NUMBER OF TRENCHES 1 TOTAL BOTTOM AREA 490

SEEPAGE PITS, INSIDE DIAMETER EXISTING FT. DEPTH BELOW INLET FT.

ABSORBENT AREA EXISTING + 490 SQ. FT.

REMARKS _____

DATE SYSTEM APPROVED 12-30-83

INSPECTOR C. Wilbur