

APPROVAL  
9/2/83  
P 33096

# PERMIT

SEWAGE DISPOSAL SYSTEM

A REPAIR

MARYLAND STATE DEPARTMENT OF HEALTH\*

HOWARD COUNTY  
BUREAU OF ENVIRONMENTAL HEALTH  
992-2330

Sept. 2, 1983  
A.M.  
06-430228

ELLICOTT CITY  
DISTRICT \_\_\_\_\_

DATE August 31, 1983

W.F. Collins Co.

IS PERMITTED TO INSTALL \_\_\_\_\_ ALTER

ADDRESS 5409 Butler Road, Bethesda, MD 20816 PHONE 654-9294

SUBDIVISION Hammond Village ROAD ~~2813~~ Gorman Road LOT 2

PROPERTY OWNER Ms. Chesser 10614 GORMAN RD

ADDRESS ~~2813~~ Gorman Road, Laurel, MD 6 DUMP TRUCK BACK HOLE

IF GARBAGE GRINDER IS USED INCREASE SEPTIC TANK CAPACITY BY 50% AND ABSORPTION AREA BY 22%. NO

GARBAGE GRINDER? YES \_\_\_\_\_ NO

SEPTIC TANK CAPACITY \_\_\_\_\_ GALLONS NUMBER OF BEDROOMS \_\_\_\_\_

REPAIR - CALL FOR INSPECTION WHEN GROUND IS OPENED UP SO SANITARIAN CAN RECOMMEND REPAIR.

W.F. Collins Co.

PLANS APPROVED BY Frank Skinner DATE August 31, 1983

- COVER NO WORK UNTIL INSPECTED AND APPROVED.
- NEITHER THE HOWARD COUNTY COUNCIL NOR THE HEALTH DEPARTMENT IS RESPONSIBLE FOR THE SUCCESSFUL OPERATION OF ANY SYSTEM.
- NOTE: IF TRENCH IS USED CALL FOR INSPECTION BEFORE AND AFTER PLACING GRAVEL IN TRENCH.
- NOTE: NO DRY WELL SHALL EXCEED 15 FOOT IN DIAMETER. NO ABSORPTION TRENCH TO EXCEED 100 FEET IN LENGTH.
- NOTE: ALL PIPE FROM HOUSE TO SEPTIC TANK MUST BE CAST IRON OR SCHEDULE 40 PVC OR ABS.
- PERMIT VOID AFTER THREE YEARS.
- NOTE: INSTALL STAND PIPE ON SEPTIC TANK AND DRY WELL. STAND PIPES MUST BE 6 INCHES IN DIAMETER. CAST IRON, CONCRETE OR TERRA COTTA, OR PVC OR ABS ACCEPTED. IF TOP OF SEPTIC TANK IS DEEPER THAN 3 FEET MANHOLE TO GRADE REQUIRED.

\*INSTALLER IS RESPONSIBLE FOR OBTAINING FINAL APROVAL ON THIS PERMIT

\*CALL 992-2330 FOR INSPECTION OF SEPTIC SYSTEMS.

P 33096

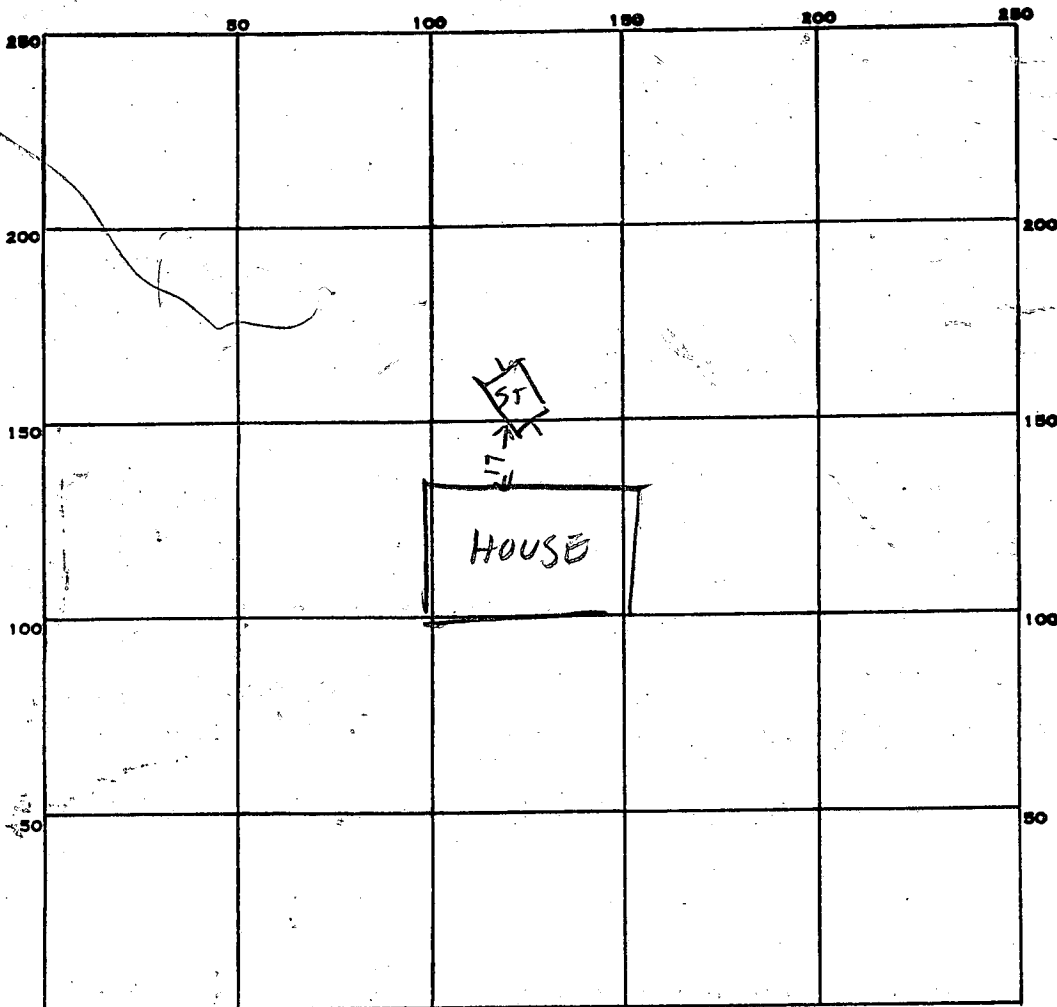

INDICATE NORTH. - NAME ADJOINING ROADWAY AS BASE LINE.

PERMIT CARD \_\_\_\_\_

MANHOLE

SEPTIC TANK, LEVEL 2000 Concrete CLEANOUTS NO  
TOP 3 1/2 FT BELOW GROUND  
 DISTRIBUTION BOX, LEVEL \_\_\_\_\_

TILE FIELD, DEPTH \_\_\_\_\_ FT. TRENCH WIDTH \_\_\_\_\_ FT.

GRAVEL DEPTH \_\_\_\_\_ IN. TOTAL LENGTH \_\_\_\_\_ FT.

NUMBER OF TRENCHES \_\_\_\_\_ TOTAL BOTTOM AREA \_\_\_\_\_

SEEPAGE PITS, INSIDE DIAMETER \_\_\_\_\_ FT. DEPTH BELOW INLET \_\_\_\_\_ FT.

ABSORBENT AREA \_\_\_\_\_ SQ. FT.

REMARKS 9/2/83 - Old metal septic tank  
Collapsed after 20 years  
FINISH CONNECTION PIPE & COVER

DATE SYSTEM APPROVED 9/2/83 INSPECTOR Raymond Bradley