

5/10/85
A.M.

5-13-85
S.A. [unclear]
Approved

PERMIT

P 35380
A 33285

SEWAGE DISPOSAL SYSTEM

MARYLAND STATE DEPARTMENT OF HEALTH

HOWARD COUNTY
BUREAU OF ENVIRONMENTAL HEALTH
992-2330

02-290448
(INDEXED)

ELLICOTT CITY
DISTRICT 2nd
DATE 5/2/85

Dave Thompson IS PERMITTED TO INSTALL ALTER

ADDRESS _____ PHONE 465-1881

SUBDIVISION _____ ROAD 2650 Bethany Lane LOT _____

PROPERTY OWNER David C. Diffendal

ADDRESS _____

IF GARBAGE GRINDER IS USED INCREASE SEPTIC TANK CAPACITY BY 50% AND ABSORPTION AREA BY 22%.

GARBAGE GRINDER? YES _____ NO

SEPTIC TANK CAPACITY 1000 GALLONS NUMBER OF BEDROOMS 3

70
59352
512
12
352
184 40
3 25
52 552 200

TRENCHES - 184 sq. ft. per bedroom. Trench to be 2 feet wide. Inlet 4 feet below original grade Bottom maximum depth 8 feet below original grade. Effective area begins at 4 feet below original grade. 4 feet of stone below distribution pipe. LOCATION: Place the distribution box 245 feet from the front lot line and 30 feet from the right lot line as seen when facing the lot from Bethany Lane. Run trenches along level ground toward left rear of lot. NOTE: No trench to exceed 100 feet in length. If more than one trench used, a distribution box is required. Call for inspection of trench(s) before and after gravel is installed. Provide 6" - 8" diameter cleanout and cap to grade or above on septic tank.

4/28/97 T/C w/OWNER: PROPOSED 1 BR ADD'N: DRAINFIELD EXTENSION (24')
WAVED DUE TO MINIMAL SIZE OF EXTENSION TO
COMPRISE 720 A AND EX. SYSTEM ACTUALLY ~ 3 1/4 BR (MR)

PLANS APPROVED BY C. Williams DATE 11/30/84

COVER NO WORK UNTIL INSPECTED AND APPROVED.

NEITHER THE HOWARD COUNTY COUNCIL NOR THE HEALTH DEPARTMENT IS RESPONSIBLE FOR THE SUCCESSFUL OPERATION OF ANY SYSTEM.

NOTE: IF TRENCH IS USED CALL FOR INSPECTION BEFORE AND AFTER PLACING GRAVEL IN TRENCH.

NOTE: NO DRY WELL SHALL EXCEED 15 FOOT IN DIAMETER. NO ABSORPTION TRENCH TO EXCEED 100 FEET IN LENGTH.

NOTE: ALL PIPE FROM HOUSE TO SEPTIC TANK MUST BE CAST IRON OR SCHEDULE 40 PVC OR ABS. **BLDG. PERMIT SIGNES**

PERMIT VOID AFTER THREE YEARS.

NOTE: INSTALL STAND PIPE ON SEPTIC TANK AND DRY WELL. STAND PIPES MUST BE 6 INCHES IN DIAMETER. CAST IRON, CONCRETE OR TERRA COTTA, OR PVC OR ABS ACCEPTED. IF TOP OF SEPTIC TANK IS DEEPER THAN 3 FEET MANHOLE TO GRADE REQUIRED. **AND RETURNED 6-16-97**
Smith 200/106287
additional fee
gauge - master
Fuller

***INSTALLER IS RESPONSIBLE FOR OBTAINING FINAL APPROVAL ON THIS PERMIT**

*CALL 992-2330 FOR INSPECTION OF SEPTIC SYSTEMS.

EH - 2-1082

A 33285

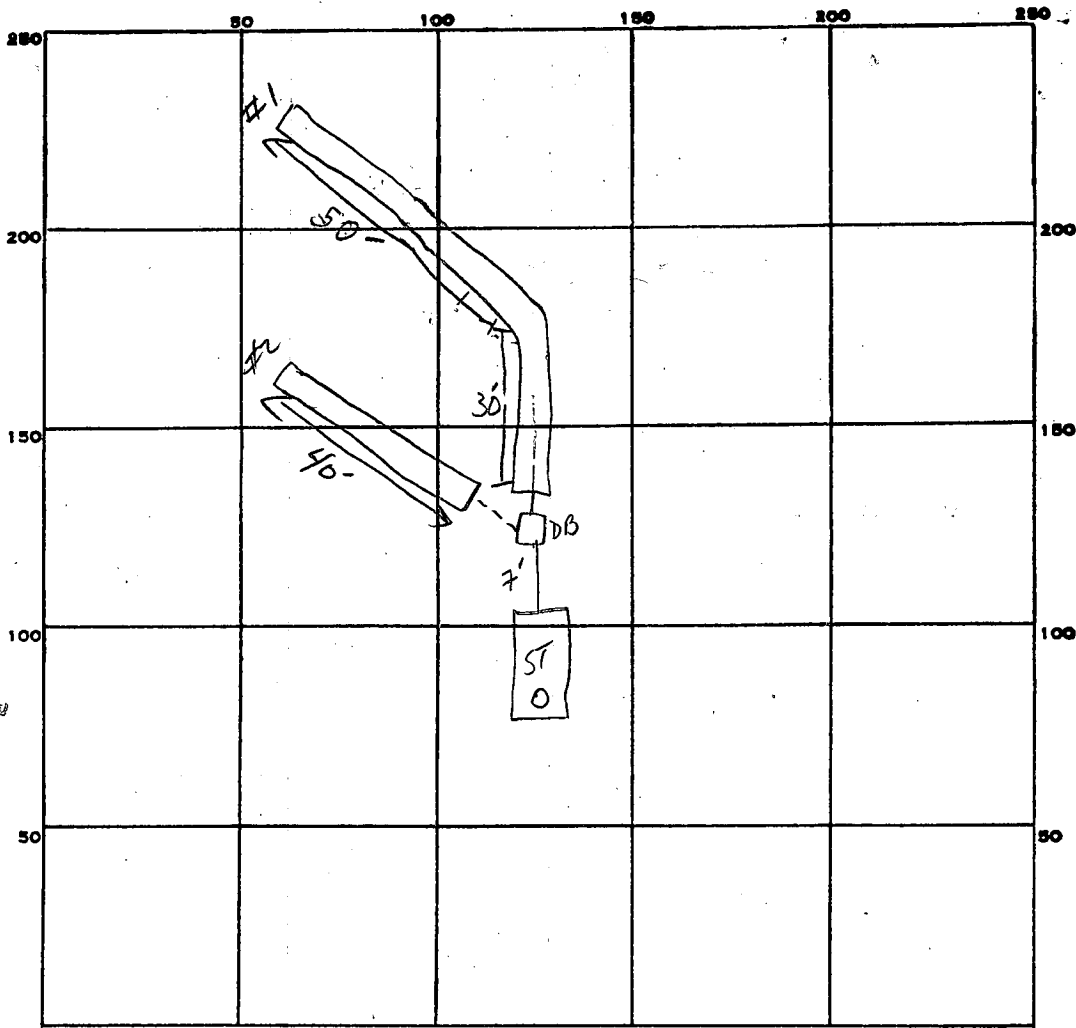

INDICATE NORTH. - NAME ADJOINING ROADWAY AS BASE LINE.

BETHANY LANE

PERMIT CARD

SEPTIC TANK, LEVEL

CLEANOUTS

DISTRIBUTION BOX, LEVEL

TILE FIELD, DEPTH #1 19" FT. TRENCH WIDTH #1 2' FT. INLET #1 4'

GRAVEL DEPTH #2 29" IN. TOTAL LENGTH #2 40' FT. TOTAL 120

NUMBER OF TRENCHES #2 TOTAL BOTTOM AREA 600 φ

120
5
600

SEEPAGE PITS, INSIDE DIAMETER _____ FT. DEPTH BELOW INLET _____ FT.

70 ABSORBENT AREA 600 SQ. FT.

REMARKS 1ST 40 FT OF 1ST TRENCH OK CREDIT GIVEN FOR 5 FT STONE.

70' Mono TRENCH

5-10-85 - COMPLETE DIGGING BOTH TRENCHES; ADD STONE + PIPE CALL FOR FINAL MONDAY SAVED

5-13-85 OK TO COVER ALL WORK

DATE SYSTEM APPROVED 5-13-85

INSPECTOR SABEL

Reviewed

APPLICATION

SEWAGE DISPOSAL TESTING

STATE OF MARYLAND - DEPARTMENT OF HEALTH AND MENTAL HYGIENE

HOWARD COUNTY HEALTH DEPARTMENT
ENVIRONMENTAL HEALTH SERVICES
P. O. BOX 476 ELLICOTT CITY, MARYLAND 21043
TELEPHONE: 992-2330

A 33285

P _____

DISTRICT 2nd

DATE 11/7/83

TO: THE COUNTY HEALTH OFFICER
ELLICOTT CITY, MARYLAND

I, HEREBY, APPLY FOR THE NECESSARY TEST IN ORDER TO CONSTRUCT (OR RECONSTRUCT) A SEWAGE DISPOSAL SYSTEM.

PROPERTY OWNER Percontee, Inc. David C. Diffendal
8016 CREST ROAD
ADDRESS 11900 Tech Road, Silver Spring, Md. 20904 PHONE 792-4030
LAUREL, Md 26207 725-2615

PROPERTY LOCATION:
SUBDIVISION _____ LOT NO. _____

ROAD AND DESCRIPTION 2650 Bethany Lane

SIZE OF LOT 4.505 acres TYPE BLDG. 3 or 4 bedrooms
(NUMBER OF BEDROOMS)

THE SYSTEM INSTALLED UNDER THIS APPLICATION IS ACCEPTABLE ONLY UNTIL PUBLIC FACILITIES BECOME AVAILABLE. I FULLY UNDERSTAND THE FEE CONNECTED WITH THE FILING OF THIS PERC TEST APPLICATION IS NON-REFUNDABLE UNDER ANY CIRCUMSTANCES. I ALSO AGREE TO COMPLY WITH ALL M.O.S.H.A. REQUIREMENTS IN TESTING THIS LOT.

C.T. Diffendal
(SIGNATURE OF APPLICANT)

APPROVED BY _____ FOR _____ DATE _____

REJECTED BY _____ FOR _____ DATE _____

HOLD PENDING FURTHER TESTS _____ DATE _____

REASONS FOR REJECTION OR HOLDING _____

LOG. PERMIT SIGNED
AND RETURNED 11/30/83
Serial # 61962

THIS IS NOT A PERMIT

SOIL PROFILE

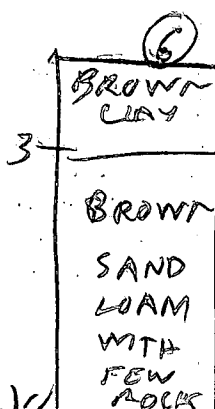
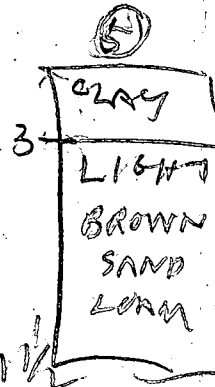
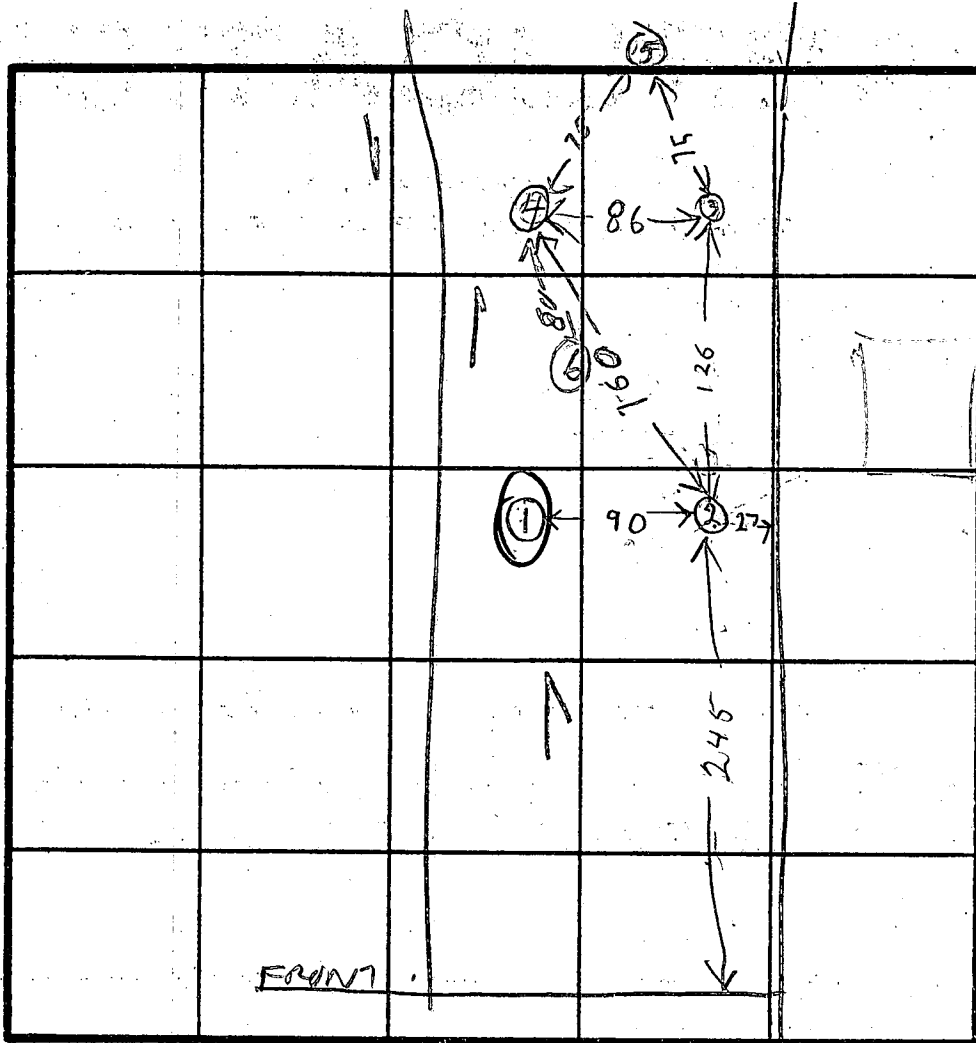
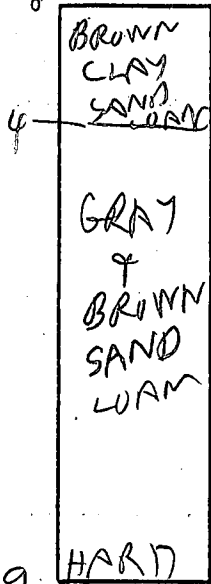

INDICATE NORTH - NAME ADJOINING ROADWAY AS BASE LINE.

BETHANY LANE

DATE	TEST NO.	DEPTH	PRE-WET		TEST - 1" DROP		TIME
			START	STOP	START	STOP	
12/5/83	1V	3 1/2	9 41	10 41	little perc		SLOW
	2V	9	LOOKS	DOUBTFUL			
	2S	3	9 43	9 50	9 50	10 05	15
	2V	12	LOOKS	OK			
	3S	3 1/2	9 56	10 01	10 01	10 24	23
	3V	10	2				
	4S	2 1/2	10 09	10 23	little perc		
	4V	12	LOOKS	OK			
	4M	3 1/2	10 23	10 25	10 25	10 28	3
	5S	13 1/2	10 47	11 00	11 00	11 15	15
12/5/83	5V	11 1/2	LOOKS	OK			
	6V	10	LOOKS	OK			

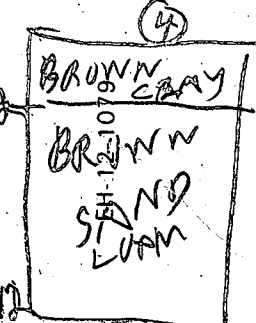
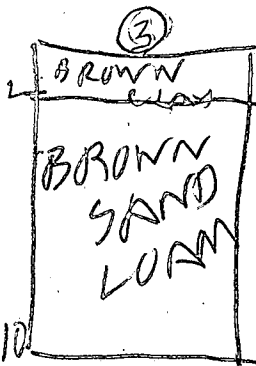
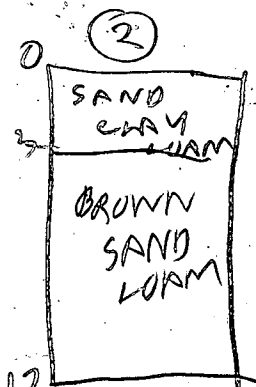

HOLE ELEV

- ① ② HIGH
- ③ NEXT HIGH
- ③ ④ LOW
- ⑤ LOWEST

REMARKS CITY WATER

TYPE OF SOIL

TESTED BY R. HODGES

ALSO PRESENT PERGA Backhoe BAKER BOLLNER

TRENCH INLET $\frac{1}{2}$ B.G.
SYSTEM TO START 245'
FROM FRONT LOT LINE.
11/30/84 CW/whm

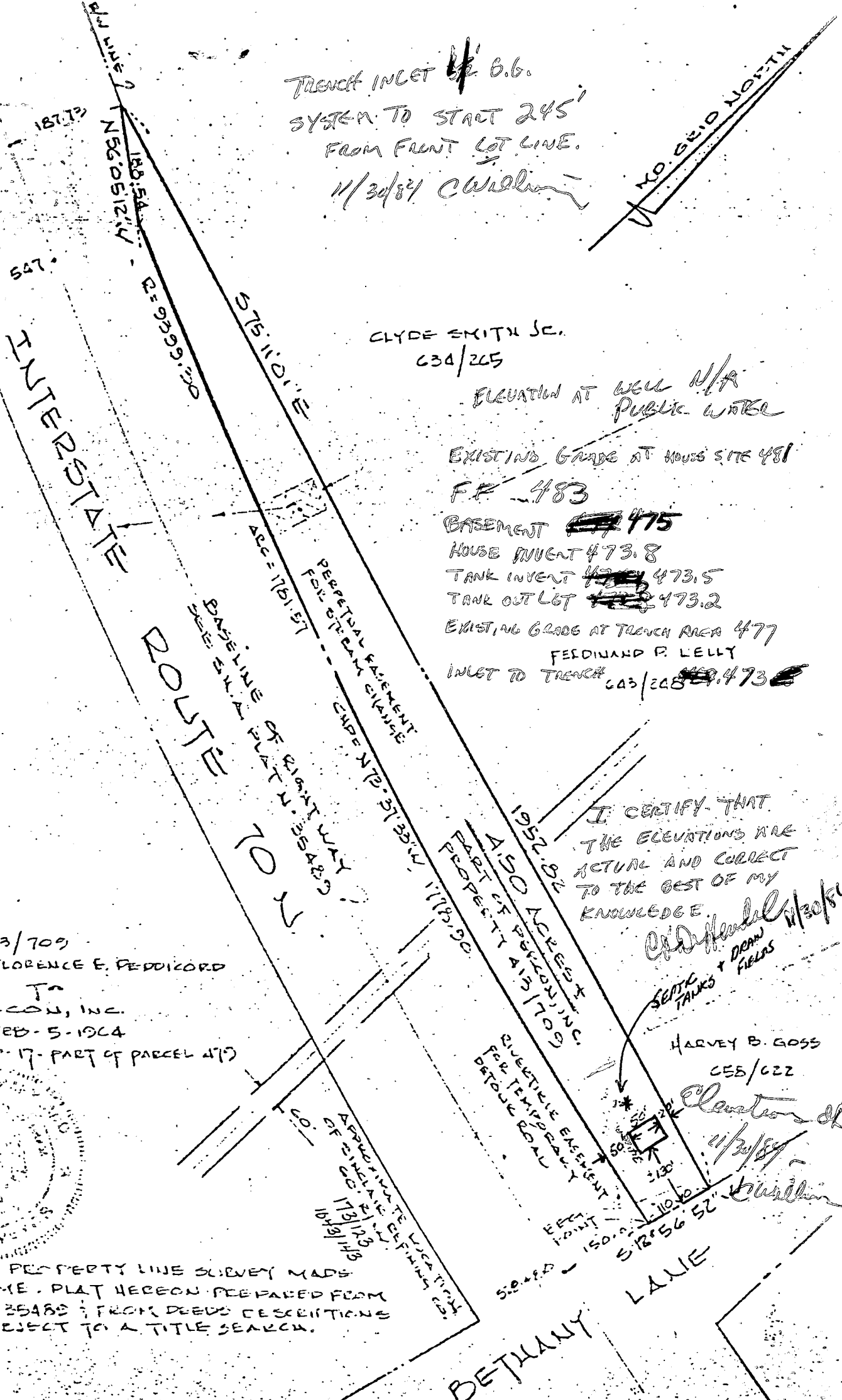

CLYDE SMITH JR.
634/205

ELEVATION AT WELL N/A
PUBLIC WATER

EXISTING GRADE AT HOUSE SITE 481
FF 483

BASEMENT ~~475~~
HOUSE INVENT 473.8
TANK INVENT ~~473.5~~ 473.5
TANK OUTLET ~~473.2~~ 473.2

EXISTING GRADE AT TRENCH AREA 477
FERDINAND P. LELLY
INLET TO TRENCH 603/208 ~~473.0~~ 473.0

I CERTIFY THAT
THE ELEVATIONS ARE
ACTUAL AND CORRECT
TO THE BEST OF MY
KNOWLEDGE.

(Signature) 11/30/84
SEPTIC TANKS & DEBRIS FIELDS

HARVEY B. GOSS
655/622

Elevation of
(Signature) 11/30/84

413/709
EVEL A. & FLORENCE E. PEDDICORD
TO
PERCON, INC.
FEB-5-1964
TAX MAP 17 - PART OF PARCEL 479

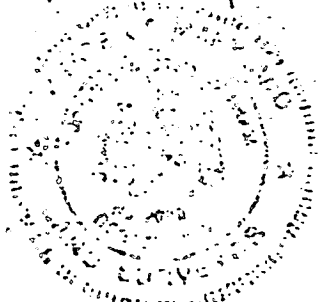

NOTE: NO PROPERTY LINE SURVEY MADE
AT THIS TIME. PLAT HEREON PREPARED FROM
C.H.A. PLAT # 35485 & FROM DEEDS DESCRIPTIONS
ONLY & SUBJECT TO A TITLE SEARCH.

PLAT OF 4.50 ACRES ±
PART OF THE PERCON, INC. PROPERTY
INTERSTATE ROUTE 70N & BETHANY LANE
END DIST. HOWARD COUNTY, MD.

J. R. McCRONE, JR., INC.
REGISTERED PROFESSIONAL ENGINEERS
AND SURVEYORS
ANNAPOLIS, MARYLAND
PRINCE FREDERICK CHESTERTOWN
EASTON LEONARDTOWN DENTON

DRAWN BY Rocco
SCALE 1" = 200'
DATE SEPT. 3 - 81
JOB NO. _____
FOLDER _____

Property known as:

THIS PLAT CAN NOT BE USED TO ESTABLISH PROPERTY LINES OR CORNERS.

L. 1226 F. 159
2ND ELECTION DISTRICT
HOWARD COUNTY, MD

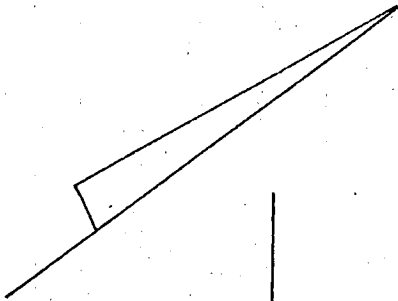

SEC PLAT 35489

I-70

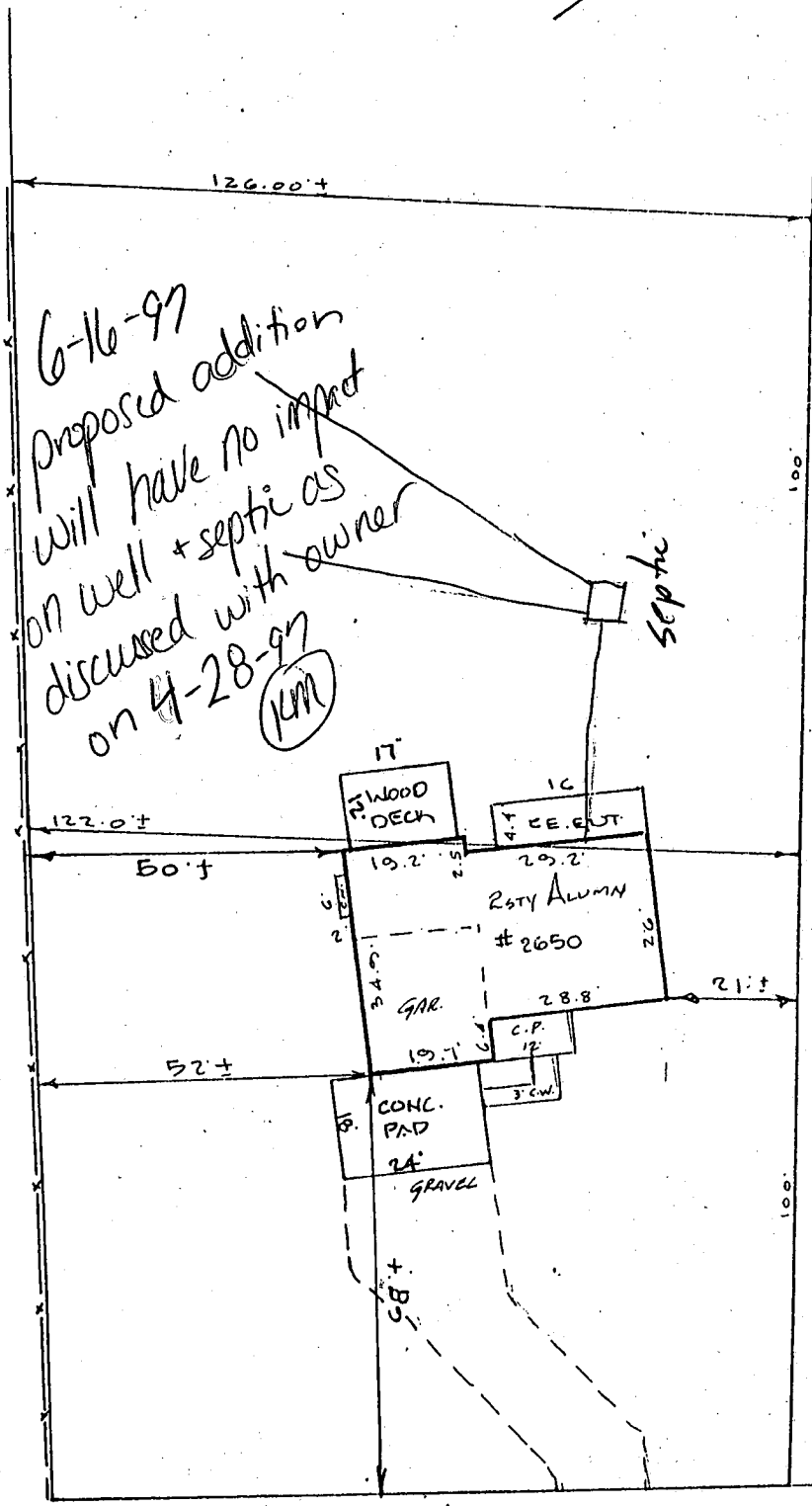

188.34
N 56° 05' 12" W
1.00 AC ± L. 1600' F. 125
L = 1781.57' ±
N 19° 05' 53" E 105.56
1957.82' ±

L = 1337.64'
B = 5205.70'
3.5 AC ± REMAINDER
1325.03
575° 11' 01" E

I-70



Walter Park
1325.03

110.00
S 12° 56' 52" W