

Howard County Health Dept.
P. O. Box 476
Ellicott City, Maryland 21043

APPLICATION

18501
P. _____

SEWAGE DISPOSAL TESTING

STATE OF MARYLAND - DEPARTMENT OF HEALTH AND MENTAL HYGIENE

HOWARD COUNTY HEALTH DEPARTMENT
ENVIRONMENTAL HEALTH SERVICES

P. O. BOX 476, ELlicOTT CITY, MARYLAND 21043
TELEPHONE: 485-8000, EXT. 336

DISTRICT 5th Howard Dist.
DATE 11/18/73

Fill out in triplicate.
Make \$15.00 check payable:
Howard County Health Dept. - Sanitation

*Septic Tank - 1250 gal.
Dry Well - 448 sq ft
of abundant sidewalk area to begin below
the first 3' of top surface. Maximum
depth permitted for dry well is 11' 6" below
grade. Locate dry well 135 ft. from front lot
line and 45 ft. from right side line as seen
from Clarkson Dr.*

TO: THE COUNTY HEALTH OFFICER
ELlicOTT CITY, MARYLAND

I, HEREBY, APPLY FOR THE NECESSARY TEST IN ORDER TO CONSTRUCT (OR RECONSTRUCT) A SEWAGE DISPOSAL SYSTEM.

PROPERTY OWNER Henry J. Lilienfield (Contractor Purchaser - James Phenix)
Residence - 1124 W. Nollcrest Dr., Silver Spring, Md.
ADDRESS 20903 (Phone: 993-2265)
20903

PROPERTY LOCATION:

SUBDIVISION Parcel "C" of the Property of H. J. Lilienfield LOT NO. Parcel C

ROAD AND DESCRIPTION:

Located at the Western end of Clarkson Drive

SIZE OF LOT

5.739 acres TYPE BLDG. 4

IF NOT SINGLE RESIDENCE DESCRIBE _____

THE SYSTEM INSTALLED UNDER THIS APPLICATION IS ACCEPTABLE ONLY UNTIL PUBLIC FACILITIES BECOME AVAILABLE.

SIGNATURE OF APPLICANT

James E. Phenix

APPROVED BY

Robert V. Toner FOR Dry Well DATE 11/20/73

REJECTED BY _____

FOR _____ (KIND OF SYSTEM) DATE _____

HOLD PENDING FURTHER TESTS _____

DATE _____

REASONS FOR REJECTION OR HOLDING _____

THIS IS NOT A PERMIT

APPLICATION

Howard County Health Dept.
 P. O. Box 443
 Ellicott City, Maryland 21032

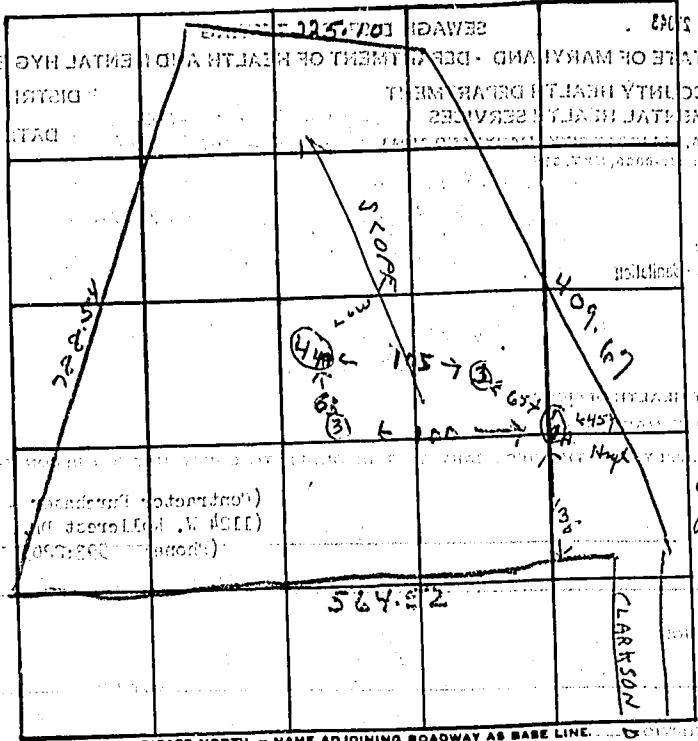

Fill out in ink.
 Make 110 copies.
 Howard County Health Dept.

Location as taken from certified Engineers Plot.

INDICATE NORTH - NAME ADJOINING ROADWAY AS BASE LINE.

DATE	TEST NO.	DEPTH	PRE-WET		TEST: 1" DROP		TIME
			START	STOP	START	STOP	
6/8/73	1	3 1/2	10 ¹⁷	10 ³⁷	10 ²⁷	10 ⁴³	16 min
	1A	10 1/2 ft.	10 ¹⁷			10 ²²	5 min
	2	11 ft.	Good soil	5 ft.			
	3	11 1/2 ft.	Good soil - clay	3 ft.			3-36 ft.
	4	10 1/2 ft.	10 ³⁸	10 ³¹	10 ³¹	10 ³⁵	4 min
	4A	4 1/2 ft.	10 ³³	10 ³⁶	10 ³⁶	10 ⁴¹	5 min

REMARKS: R.T. - Hole to be certified by engineers.
 TYPE OF SOIL: Use: hilt hole 1, 1A
or 3 - whichever is highest