

APPLICATION

A 09289

SEWAGE DISPOSAL TESTING

P _____

MARYLAND STATE DEPARTMENT OF HEALTH

HOWARD COUNTY

ELLICOTT CITY

#Bedrooms	Size Tank	Size Tile Field	DISTRICT	DATE
2	750 gal	300 sq. ft. bottom area	5	10/26/64
3	750 gal	300 sq. ft. bottom area		
4	1000 gal	400 sq. ft. bottom area		

Place the tile field 45 ft to 80 ft from the back lot line and 35 ft to 45 ft from the right sidewalk as seen when facing the lot from Clarkson Drive.

I, HEREBY, APPLY FOR THE NECESSARY TESTS IN ORDER TO CONSTRUCT (OR RECONSTRUCT) A SEWAGE DISPOSAL SYSTEM. Tile field to be no deeper than 4 ft from original grade to bottom of trench

PROPERTY OWNER: John P. & Ruth A. Kondrup
 ADDRESS: 5132 Loughboro Rd., Washington 16, D. C. PHONE: 563-5335

PROPERTY LOCATION:
 SUBDIVISION: Beaufort Park LOT NO. 1, Blk. G
 ROAD AND DESCRIPTION: Clarkson Drive

OCCUPANT: _____ PHONE: _____
 PERSON TO CONSTRUCT SYSTEM: _____ PHONE: _____
 ADDRESS: _____

SIZE OF LOT: 40,114 sq. ft. TYPE BLDG.: test per bedroom
NUMBER OF BEDROOMS

IF NOT SINGLE RESIDENCE DESCRIBE: _____

SIGNATURE OF APPLICANT: 16/ Gray & Kondrup

APPROVED BY: Raymond W. Hodge FOR: Tile Field DATE: 7 Jan 65
(KIND OF SYSTEM)

REJECTED BY: _____ FOR: _____ DATE: _____
(KIND OF SYSTEM)

HOLD PENDING FURTHER TESTS: 2/27/64 RIT DATE: _____

REASONS FOR REJECTION OR HOLDING: 7-2-64 For test and test allowed
Very costly
Very costly

THIS IS NOT A PERMIT

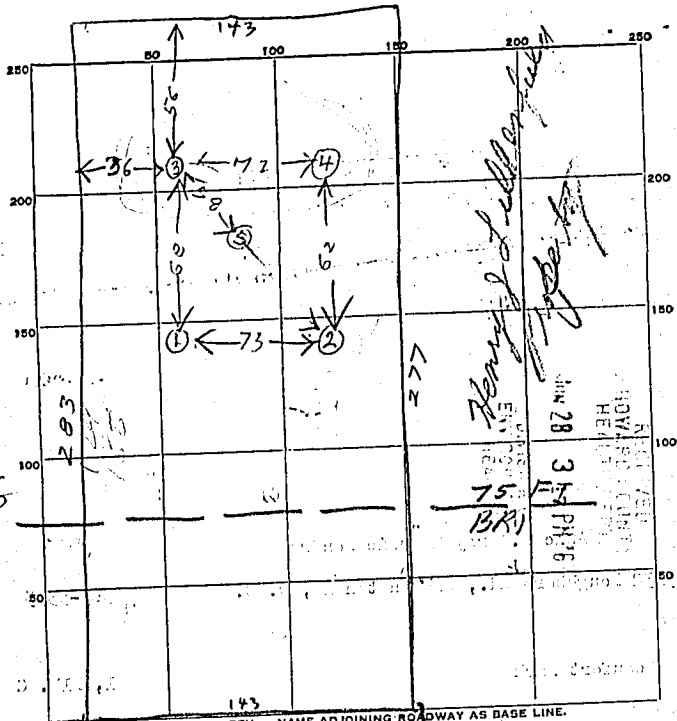

INDICATE NORTH - NAME ADJOINING ROADWAY AS BASE LINE.

CLARKSON DRIVE DEADEND

DATE	TEST NO.	DEPTH	PRE-WET		TEST - 1" DROP		TIME	
			START	STOP	START	STOP		
20 Oct 64	1	3	155	205	2:05	2:20	15	
"	2	3	159	238	1st inch 39 min			
"	3	3 1/2	202	211	2:11	2:27	16	
"	4	3	214	216	2:16	2:21	5	
"	5	9	NOWATER. ALL SANDY					

SOIL AUGER FINDING

TESTED BY

Raymond Kedge

REMARKS

Lot 16 - almost level in area tested at hour 1:00

ALSO PRESENT

LOT NO.

Lot 16