

APPLICATION

PERCOLATION TESTING

A 517904

F _____

HOWARD COUNTY HEALTH DEPARTMENT
BUREAU OF ENVIRONMENTAL HEALTH
3525-H ELLICOTT MILLS DRIVE/ELLICOTT CITY, MARYLAND 21043
TELEPHONE: 313-2640

DISTRICT _____

DATE 9/5/02

TO: THE COUNTY HEALTH OFFICER
ELLICOTT CITY, MARYLAND

I HEREBY APPLY FOR THE NECESSARY TEST PRIOR TO APPLICATION FOR PERMIT TO CONSTRUCT (OR RECONSTRUCT) A SEWAGE DISPOSAL SYSTEM.

PROPERTY OWNER DORSEY MILL L.L.C.
ADDRESS 14045 GARDEN DRIVE PHONE 410-531-8930
GLENWOOD, MD 21738 FAX 410-531-8939

AGENT OR PROSPECTIVE BUYER _____
ADDRESS _____ PHONE _____

PROPERTY LOCATION:
SUBDIVISION DORSEY MILL ROAD LOT NO. _____
ROAD AND DESCRIPTION 14445 DORSEY MILL RD, GLENWOOD, MD 21737

TAX MAP 21 PARCEL # 227
SIZE OF LOT 53.87 AC. TYPE BLDG. SINGLE FAMILY DWELLING
(SINGLE FAMILY DWELLING OR COMMERCIAL)

THE SYSTEM INSTALLED UNDER THIS APPLICATION IS ACCEPTABLE ONLY UNTIL PUBLIC FACILITIES BECOME AVAILABLE. I FULLY UNDERSTAND THE FEE CONNECTED WITH THE FILING OF THIS PERC TEST APPLICATION IS NON-REFUNDABLE UNDER ANY CIRCUMSTANCES. I ALSO AGREE TO COMPLY WITH ALL M.O.S.H.A. REQUIREMENTS IN TESTING THIS LOT.

James H. [Signature]
(SIGNATURE OF APPLICANT)

APPROVED BY _____ FOR _____ DATE _____

DISAPPROVED BY _____ FOR _____ DATE _____

HOLD PENDING FURTHER TESTS _____

REASONS FOR REJECTION OR HOLDING _____

PERCOLATION TEST PLAT/PRELIMINARY PLAT - TITLE OR I.D. # _____ DATE _____

SITE DEVELOPMENT PLAN/FINAL PLAT - TITLE OR I.D. # _____ DATE _____

THIS IS NOT A PERMIT

NOT TO SCALE

517904

COUNTY #

SOIL PROFILE

3526

0' brn lm
 1' tan-brn heavy lm
 2' yellow-red fine sandy lm micaceous
 NO ROCK
 13'

3527

SEE 3526

15'

3528

2' red-brn loam
 ↓
 2' creamy-white/tan-brn silt lm
 4' tan/beige powdery fine sandy lm
 NO ROCK
 No obvious signs of redox features
 14'

SOIL PROFILE

3529

SAME AS

3528

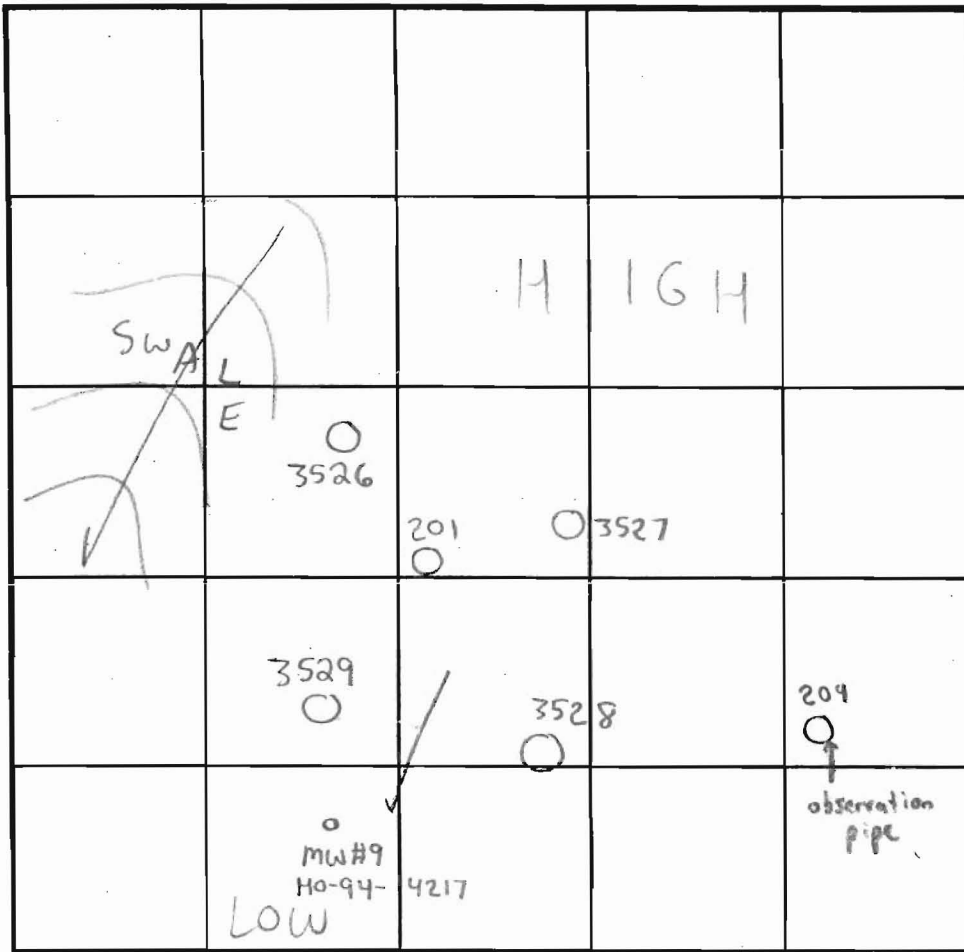

INDICATE NORTH - NAME ADJOINING ROADWAY AS BASE LINE.

| DATE | TEST NO. | DEPTH | PRE-WET | | TEST - 1" DROP | | TIME | |
|----------|-------------------|-------------------------|-----------------------------------|---------|-------------------|---------|-------|----|
| | | | START | STOP | START | STOP | | |
| 12/4/02 | 3526 | 13'V | (VISUAL | OK | SEE SOIL PROFILE) | NA | OK | |
| | 3527 | 15'V | (" | " | " " | NA | OK | |
| 12/3/02 | 3528 ⁺ | 14'V | (VISUAL | OK | SEE SOIL PROFILE) | NA | OK | |
| | 3529 ⁺ | 6' T 14'V | 12:15pm | 12:20pm | 12:20pm | 12:30pm | 10min | OK |
| 10/27/98 | 201 | 4' T 18'V | (PREVIOUSLY EVAL. BY RON PINKLEY) | | | | 2min | OK |

REMARKS + MW#9 - indicates that adequate treatment zone exists downhill & below prop. SDA (addition of extra buffer taken into consideration for MW#9 data in 2000)

TYPE OF SOIL Glenelg
 TESTED BY SRK Donnie Simpson = Hatfields ALSO PRESENT Jim Selfridge - 12/3/02 & 12/4
(Backhoe) Bob Sheesley - 12/3/02
 TRENCH DESIGN DATA: AVERAGE PERCOLATION TIME 2-7min ok TRENCH WIDTH 3
 INLET DEPTH 3 MAXIMUM BOTTOM DEPTH 5 SQ. FT/BEDROOM 180
Lot 9

SEDIMENT CONTROL NOTES

- A MINIMUM OF 48 HOURS NOTICE MUST BE GIVEN TO THE HOWARD COUNTY DEPARTMENT OF INSPECTIONS, LICENSES AND PERMITS, SEDIMENT CONTROL DIVISION PRIOR TO THE START OF ANY CONSTRUCTION OPERATIONS.
- ALL VEGETATIVE AND STRUCTURAL PRACTICES ARE TO BE INSTALLED ACCORDING TO THE PROVISIONS OF THIS PLAN AND ARE TO BE IN CONFORMANCE WITH THE MOST CURRENT MARYLAND STANDARDS AND SPECIFICATIONS FOR SOIL EROSION AND SEDIMENT CONTROL, AND REVISIONS THEREOF.
- FOLLOWING INITIAL SOIL DISTURBANCE OR RE-DISTURBANCE, PERMANENT OR TEMPORARY STABILIZATION SHALL BE COMPLETED WITHIN 7 CALENDAR DAYS FOR ALL PERMITTED SEDIMENT CONTROL STRUCTURES, DICES, FERTILIZER STRIPS AND ALL SLOPES EXCEPT 1:1 IN DAYS AS TO ALL OTHER DISTURBED OR GRADED AREAS ON THE PROJECT SITE.
- ALL SEDIMENT TRANSPORTATION MUST BE FENCED AND MARKED. SLOPES MUST BE PROTECTED BY VEGETATION OR COVERING WITHIN 14 DAYS AFTER THE DISTURBANCE OR RE-DISTURBANCE. REFER TO CHAPTER 12 OF THE HOWARD COUNTY DESIGN MANUAL, STORM DRAINAGE, FOR FURTHER INFORMATION ON VEGETATION AND COVERING.
- ALL DISTURBED AREAS MUST BE RESTORED TO ORIGINAL OR BETTER CONDITION WITHIN THE PERIOD SPECIFIED ABOVE IN ACCORDANCE WITH THE 1989 MARYLAND STANDARDS AND SPECIFICATIONS FOR SOIL EROSION AND SEDIMENT CONTROL, AND REVISIONS THEREOF. TEMPORARY STABILIZATION WITH MULCH ALONE CAN ONLY BE DONE WHEN RECOMMENDED SEEDING DATES DO NOT ALLOW FOR PROPER GERMINATION AND ESTABLISHMENT OF GRASSES.
- ALL SEDIMENT CONTROL STRUCTURES ARE TO REMAIN IN PLACE AND ARE TO BE MAINTAINED IN OPERATIVE CONDITION UNTIL PERMITS FOR THEIR REMOVAL HAS BEEN OBTAINED FROM THE HOWARD COUNTY SEDIMENT CONTROL INSPECTOR.
- SOIL ANALYSIS:
 - TOTAL AREA OF SITE: 1,002 ACRES
 - AREA TO BE DISTURBED: 638 ACRES
 - AREA TO BE GRADED OR PAVED: 634 ACRES
 - AREA TO BE VEGETATIVELY STABILIZED: 222 CUVLOS
 - TOTAL CUT: 500 CUVLOS
 - TOTAL FILL: 500 CUVLOS
- WASTE/WATER/SEWERAGE LOCATION: N/A
- ANY SEDIMENT CONTROL PRACTICES WHICH IS DISTURBED BY GRADING ACTIVITY FOR PLACEMENT OF UTILITIES MUST BE REPAIRED ON THE DAY OF DISTURBANCE.
- ADDITIONAL SEDIMENT CONTROLS MUST BE PROVIDED, IF DEEMED NECESSARY BY THE HOWARD COUNTY SEDIMENT CONTROL INSPECTOR.
- ON ALL SITES WITH DISTURBED AREAS IN EXCESS OF 2 ACRES, APPROVAL OF THE INSPECTION AGENCY SHALL BE REQUESTED UPON INSTALLATION OF PERMITTER EROSION AND SEDIMENT CONTROL STRUCTURES, BUT BEFORE PROCEEDING WITH ANY OTHER EARTH DISTURBANCE OR GRADING. OTHER BUILDING OR GRADING INSPECTION APPROVALS MAY NOT BE AUTHORIZED UNTIL THIS INITIAL APPROVAL BY THE INSPECTION AGENCY IS MADE.
- TRENCHES FOR THE CONSTRUCTION OF UTILITIES IS LIMITED TO THREE FEET LENGTHS OF THAT WHICH SHALL BE BACK-FILLED AND STABILIZED WITHIN ONE WORKING DAY, WHOEVER IS SHORTER.

TEMPORARY SEEDING NOTES

APPLY TO GRADED OR CLEARED AREAS LIKELY TO BE REDISTURBED WHERE A SHORT-TERM VEGETATIVE COVER IS NEEDED.

SEEDING PREPARATION
LOOSEN UPPER THREE INCHES OF SOIL BY RAKING, DISCING OR OTHER ACCEPTABLE MEANS BEFORE SEEDING. IF NOT PREVIOUSLY LOOSENED.

SOIL AMENDMENTS
APPLY 500 LBS. PER ACRE 10-10-10 FERTILIZER @ 150 LBS./1,000 SQ.FT.

SEEDING
FOR THE PERIODS MARCH 1 THROUGH APRIL 30, AND AUGUST 1 THROUGH NOVEMBER 15, SEED WITH 1 1/2 BU/ACR PER ANNUAL EYE. (32 LBS./1,000 SQ.FT.) OF KENTUCKY 31 TALL FESCUE. FOR THE PERIOD MAY 1 THROUGH JULY 31, SEED WITH 60 LBS./ACR @ 150 LBS./1,000 SQ.FT. OF KENTUCKY 31 TALL FESCUE AND 2 LBS. PER ACRE (200 LBS./1,000 SQ.FT.) OF WEEDING LOWGRASS. DURING THE PERIOD OF OCTOBER 1 THROUGH FEBRUARY 28, PROJECT SITE BY OPTION (D) - TWO TONS PER ACRE OF WELL ANCHORED STRAW MULCH AND SEED AS SOON AS POSSIBLE IN THE SPRING, OR USE SOO.

MULCHING
APPLY 1 1/2 TO 2 TONS PER ACRE (70 TO 90 LBS./1,000 SQ.FT.) OF UNWETTED SMALL GRASS STRAW IMMEDIATELY AFTER SEEDING. ANCHOR MULCH IMMEDIATELY AFTER APPLICATION USING 200 GALLONS PER ACRE (5 GALLONS/1,000 SQ.FT.) OF EMULSIFIED ASPHALT ON FLAT AREAS ON SLOPES 8 FEET OR HIGHER, USE 340 GALLONS PER ACRE (34 GALLONS/1,000 SQ.FT.) FOR ANCHORING.

MAINTENANCE
INSPECT ALL SEEDING AREAS AND MAKE NEEDED REPAIRS, REPLACEMENTS AND RESEEDINGS.
FOR PUBLIC PONES SUBSTITUTE CHECKING CROWNWATCH AT 15 LBS./ACR AND KENTUCKY 31 TALL FESCUE AT 40 LBS./ACR AS THE SEEDING REQUIREMENT. OPTIMUM SEEDING DATE FOR THIS MIXTURE IS MARCH 1 TO APRIL 30.

PERMANENT SEEDING NOTES

ALL DISTURBED AREAS SHALL BE STABILIZED AS FOLLOWS:

SEEDING PREPARATION
LOOSEN UPPER THREE INCHES OF SOIL BY RAKING, DISCING OR OTHER ACCEPTABLE MEANS BEFORE SEEDING.

SOIL AMENDMENTS
APPLY TWO TONS PER ACRE (100 LBS./500 SQ.FT.) OF UNWETTED SMALL GRASS STRAW IMMEDIATELY AFTER SEEDING. ANCHOR MULCH IMMEDIATELY AFTER APPLICATION USING 200 GALLONS PER ACRE (5 GALLONS/1,000 SQ.FT.) OF EMULSIFIED ASPHALT ON FLAT AREAS ON SLOPES 8 FEET OR HIGHER, USE 340 GALLONS PER ACRE (34 GALLONS/1,000 SQ.FT.) FOR ANCHORING.

SEEDING
FOR THE PERIODS MARCH 1 THROUGH APRIL 30, AND AUGUST 1 THROUGH OCTOBER 15, SEED WITH 100 LBS. PER ACRE (23 LBS./1,000 SQ.FT.) OF KENTUCKY 31 TALL FESCUE. FOR THE PERIOD MAY 1 THROUGH JULY 31, SEED WITH 60 LBS./ACR @ 150 LBS./1,000 SQ.FT. OF KENTUCKY 31 TALL FESCUE AND 2 LBS. PER ACRE (200 LBS./1,000 SQ.FT.) OF WEEDING LOWGRASS. DURING THE PERIOD OF OCTOBER 1 THROUGH FEBRUARY 28, PROJECT SITE BY OPTION (D) - TWO TONS PER ACRE OF WELL ANCHORED STRAW MULCH AND SEED AS SOON AS POSSIBLE IN THE SPRING, OPTION (C) - USE SOO OPTION (D) - SEED WITH 100 LBS./ACR KENTUCKY 31 TALL FESCUE AND MULCH WITH TWO TONS/ACR WELL ANCHORED STRAW. ALL SLOPES SHOULD BE HYDROSEEDING.

MULCHING
APPLY 1 1/2 TO 2 TONS PER ACRE (70 TO 90 LBS./1,000 SQ.FT.) OF UNWETTED SMALL GRASS STRAW IMMEDIATELY AFTER SEEDING. ANCHOR MULCH IMMEDIATELY AFTER APPLICATION USING 200 GALLONS PER ACRE (5 GALLONS/1,000 SQ.FT.) OF EMULSIFIED ASPHALT ON FLAT AREAS ON SLOPES 8 FEET OR HIGHER, USE 340 GALLONS PER ACRE (34 GALLONS/1,000 SQ.FT.) FOR ANCHORING.

MAINTENANCE
INSPECT ALL SEEDING AREAS AND MAKE NEEDED REPAIRS, REPLACEMENTS AND RESEEDINGS.
FOR PUBLIC PONES SUBSTITUTE CHECKING CROWNWATCH AT 15 LBS./ACR AND KENTUCKY 31 TALL FESCUE AT 40 LBS./ACR AS THE SEEDING REQUIREMENT. OPTIMUM SEEDING DATE FOR THIS MIXTURE IS MARCH 1 TO APRIL 30.

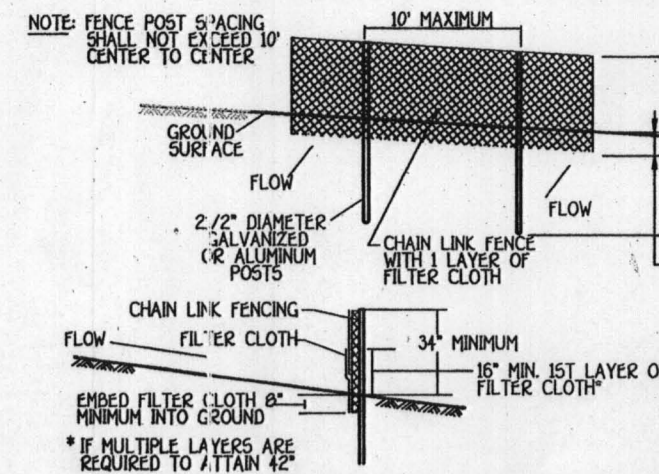

SEQUENCE OF CONSTRUCTION

- OBTAIN GRADING PERMIT. 1 DAY
- INSTALL SEDIMENT AND EROSION CONTROL DEVICES AS SHOWN ON PLAN. 1 DAY
- CLEAR ANY GRASS TO LIMITS OF DISTURBANCE AND MASS GRADE TO SUB-BASE. 1 DAY
- INSTALL TEMPORARY SEEDING. 1 DAY
- CONSTRUCT BUILDINGS. 2 MONTHS
- FINE GRADE SITE AND INSTALL PERMANENT SEEDING AND LANDSCAPE. 2 MONTHS
- REMOVE SEDIMENT CONTROL DEVICES AS UPLAND AREAS ARE STABILIZED AND PERMISSION IS GRANTED BY E/S CONTROL INSPECTOR. 2 DAYS

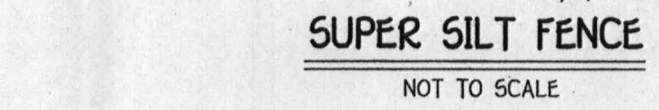

SEQUENCE OF CONSTRUCTION

- OBTAIN GRADING PERMIT. 1 DAY
- INSTALL SEDIMENT AND EROSION CONTROL DEVICES AS SHOWN ON PLAN. 1 DAY
- CLEAR ANY GRASS TO LIMITS OF DISTURBANCE AND MASS GRADE TO SUB-BASE. 1 DAY
- INSTALL TEMPORARY SEEDING. 1 DAY
- CONSTRUCT BUILDINGS. 2 MONTHS
- FINE GRADE SITE AND INSTALL PERMANENT SEEDING AND LANDSCAPE. 2 MONTHS
- REMOVE SEDIMENT CONTROL DEVICES AS UPLAND AREAS ARE STABILIZED AND PERMISSION IS GRANTED BY E/S CONTROL INSPECTOR. 2 DAYS

GENERAL NOTES (CONT.)

- THIS AREA DESIGNATES A PRIVATE SEWAGE EASEMENT OF AT LEAST 10,000 SQUARE FEET AS REQUIRED BY THE MD. DEPT. OF ENVIRONMENT FOR INDIVIDUAL SEWAGE DISPOSAL IMPROVEMENTS OF ANY NATURE IN THIS AREA ARE RESTRICTED. THIS EASEMENT SHALL BECOME NULL AND VOID UPON CONNECTION TO A PUBLIC SEWAGE SYSTEM. THE COUNTY HEALTH OFFICER SHALL HAVE AUTHORITY TO GRANT ADJUSTMENTS TO THE PRIVATE SEWAGE EASEMENT. RECORDATION OF A REVISED SEWAGE EASEMENT SHALL NOT BE NECESSARY.
- ANY CHANGES TO A PRIVATE SEWAGE EASEMENT SHALL REQUIRE A REVISED PERC CERTIFICATION PLAN.
- THE LOT SHOWN HEREON COMPLIES WITH THE MINIMUM OWNERSHIP WIDTH AND LOT AREA AS REQUIRED BY THE MD. DEPT. OF ENVIRONMENT.
- EXISTING WELLS AND SEPTIC EASEMENTS WITHIN 100 FEET OF THE PROPERTY (LOT) BOUNDARIES HAVE BEEN LOCATED.

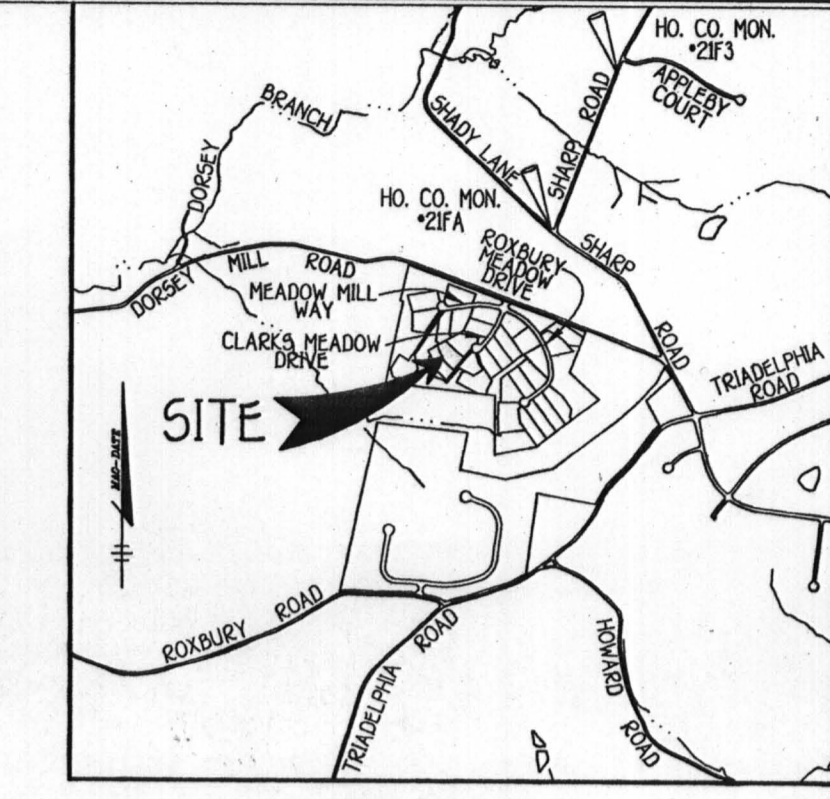

VICINITY MAP
SCALE: 1" = 2000'

GENERAL NOTES

- SUBJECT PROPERTY ZONED: RC-DEO
- TOTAL AREA OF PROPERTY: 43,554 SQ.FT.
- SEPTIC EASEMENT SUBJECT TO HOWARD COUNTY HEALTH DEPARTMENT REVIEW.
- LENGTH OF TRENCH TO BE DETERMINED AT TIME OF SEPTIC PERMIT ISSUANCE.
- CONTRACTOR/BUILDER TO VERIFY ELEVATION IN THE FIELD BEFORE BEGINNING ANY CONSTRUCTION.
- FIELD RUN TOPOGRAPHIC SURVEY WAS PREPARED BY AIR SURVEY, INC. IN MARCH, 2001.
- NO WETLANDS CURRENTLY EXIST ON THE PROPERTY.
- DRIVEWAY CULVERTS SHALL BE CONSTRUCTED AT SITE DEVELOPMENT PLAN STAGE IN ACCORDANCE WITH APPROVED CULVERT SIZE SHOWN ON F-06-029.
- STORMWATER MANAGEMENT IS PROVIDED UNDER F-06-029.
- PLAT REFERENCE NO. 18483

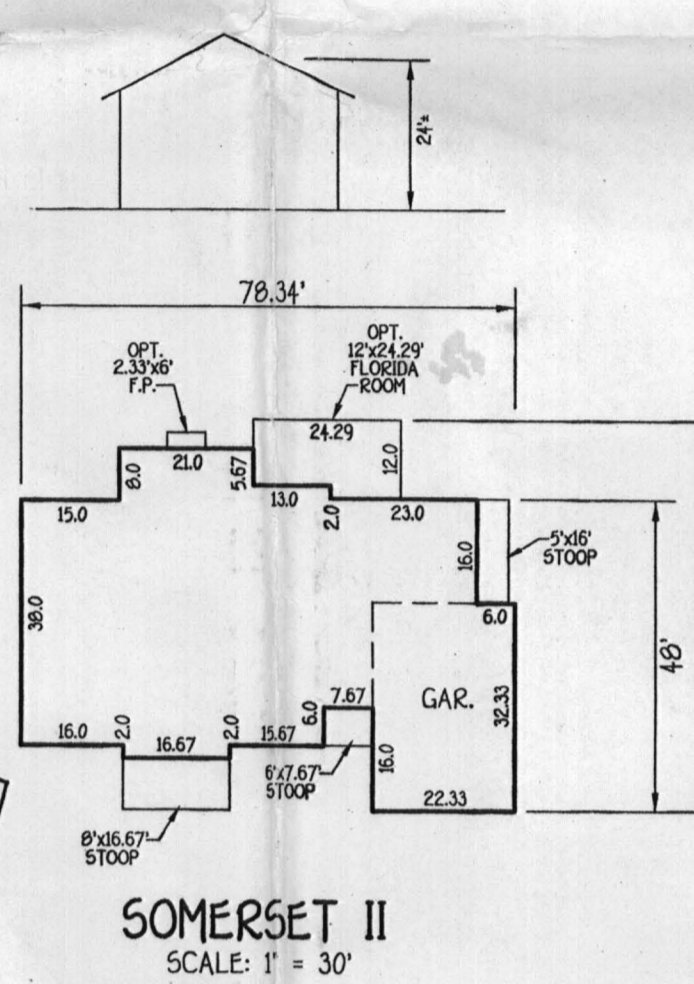

SOMERSET II
SCALE: 1" = 30'

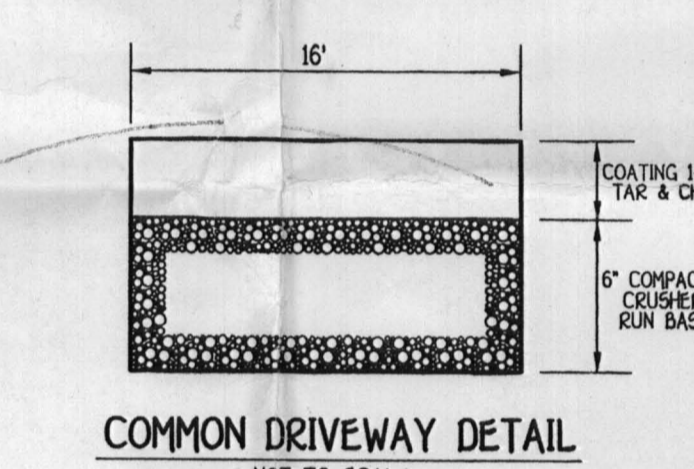

COMMON DRIVEWAY DETAIL
NOT TO SCALE

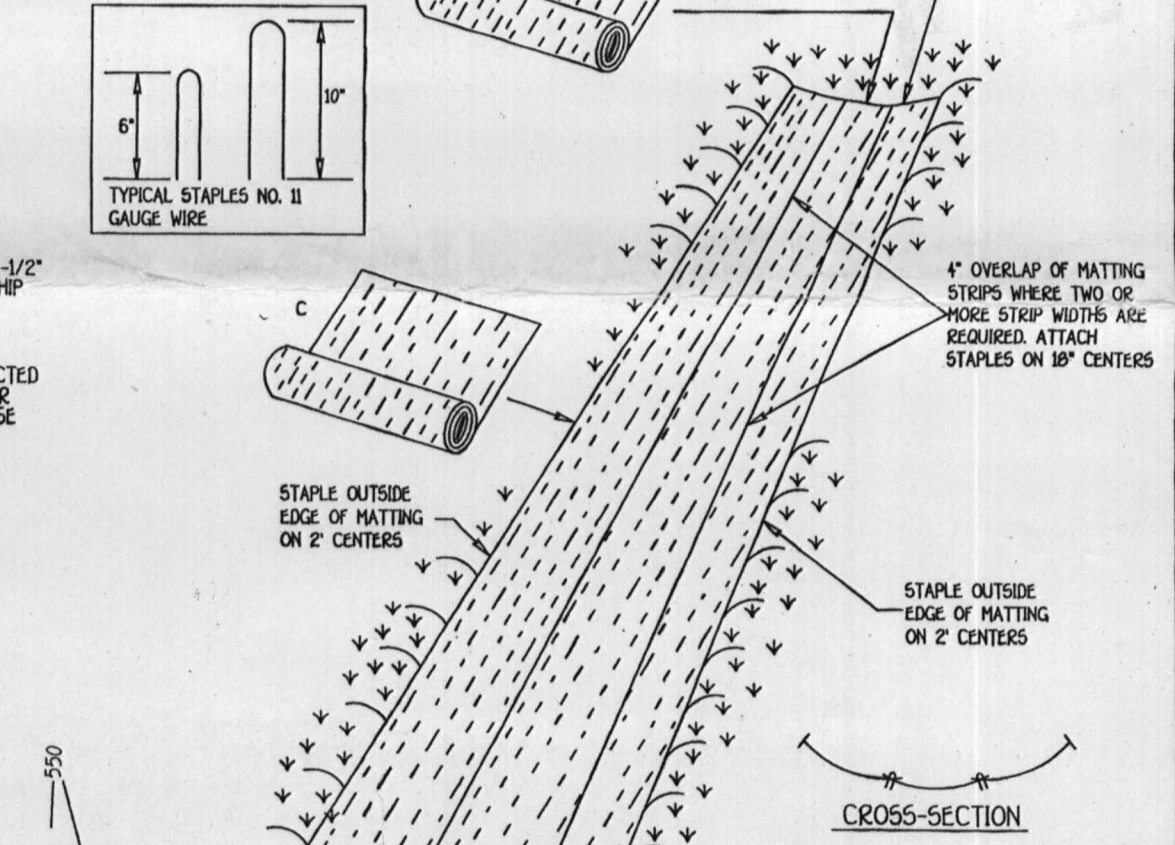

EROSION CONTROL MATTING
NOT TO SCALE

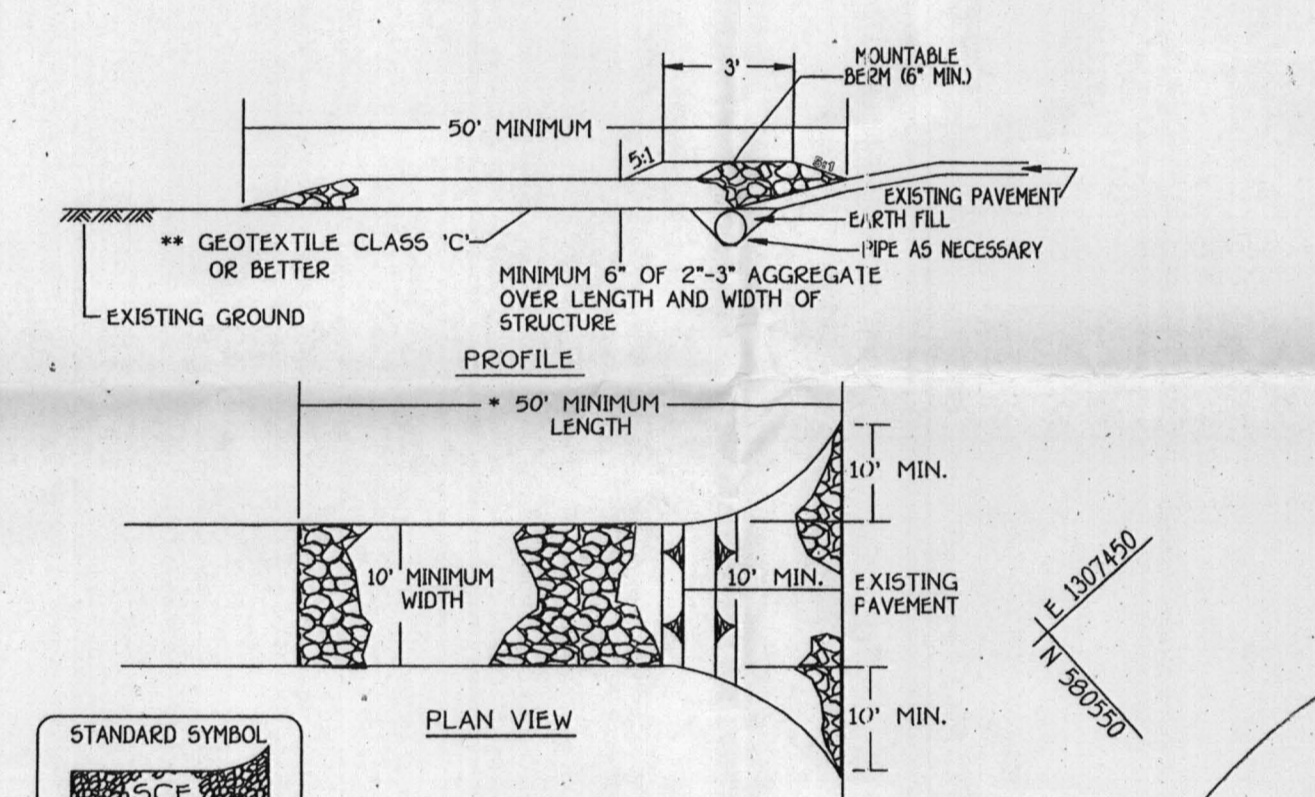

STABILIZED CONSTRUCTION ENTRANCE
NOT TO SCALE

Construction Specification

- Length - minimum of 50' (40' for single residence lot).
- Width - 10' minimum, should be flared at the existing road to provide a turning radius.
- Construction fabric - filter cloth shall be placed over the existing ground prior to placing stone. The plan approval authority may not require single family residences to use geotextile.
- Stone - crushed aggregate (2" to 3") or reclaimed or recycled concrete equivalent shall be placed at least 6" deep over the length and width of the entrance.
- Surface Water - all surface water flowing to or diverted toward construction entrances shall be piped through the entrance, maintaining positive drainage. Pipe installed through the stabilized construction entrance shall be protected with a removable berm with 24 slopes and a minimum of 6" of stone over the pipe. Pipe has to be sized according to the drainage. When the SCE is located at a high spot and has no drainage to convey a pipe will not be necessary. Pipe should be sized according to the amount of runoff to be conveyed. A 6" minimum will be required.
- Location - A stabilized construction entrance shall be located at every point where construction traffic enters or leaves a construction site. Vehicles leaving the site must travel over the entire length of the stabilized construction entrance.

PERC CERTIFICATION

I CERTIFY THAT THE INFORMATION SHOWN HEREON ARE BASED ON FIELD LOCATIONS DONE UNDER MY DIRECT SUPERVISION AND ARE CORRECT TO THE BEST OF MY PROFESSIONAL KNOWLEDGE AND BELIEF.

Terrell A. Fisher 2/24/08
TERRELL A. FISHER, PROFESSIONAL LAND SURVEYOR NO. 10692 DATE

APPROVED FOR PRIVATE WATER AND PRIVATE SEWERAGE SYSTEMS, HOWARD COUNTY HEALTH DEPARTMENT.

B. William Foster 4/12/08
COUNTY HEALTH OFFICER DATE

OWNER/BUILDER/DEVELOPER

DOUGLAS HOMES
P.O. BOX 628
CITY, MARYLAND 21041
410-750-0522

DEVELOPER'S CERTIFICATE

"I/WE CERTIFY THAT ALL DEVELOPMENT AND CONSTRUCTION WILL BE DONE ACCORDING TO THIS PLAN AND THAT ANY RESPONSIBLE PERSONNEL INVOLVED IN THE CONSTRUCTION PROJECT WILL HAVE A CERTIFICATE OF ATTENDANCE AT A DEPARTMENT OF THE ENVIRONMENT APPROVED TRAINING PROGRAM FOR THE CONTROL OF SEDIMENT AND EROSION BEFORE BEGINNING THE PROJECT. I ALSO AUTHORIZE PERIODIC ON-SITE INSPECTION BY THE HOWARD SOIL CONSERVATION DISTRICT."

Carl Cunzeman 1/2/2008
SIGNATURE OF DEVELOPER DATE
CARL CUNZEMAN

ENGINEER'S CERTIFICATE

"I HEREBY CERTIFY THAT THIS PLAN FOR EROSION AND SEDIMENT CONTROL REPRESENTS A PRACTICAL AND WORKABLE PLAN BASED ON MY PERSONAL KNOWLEDGE OF THE SITE CONDITION AND THAT IT WAS PREPARED IN ACCORDANCE WITH THE REQUIREMENTS OF THE HOWARD SOIL CONSERVATION DISTRICT."

Earl D. Collins 1-2-08
SIGNATURE OF ENGINEER DATE
EARL D. COLLINS

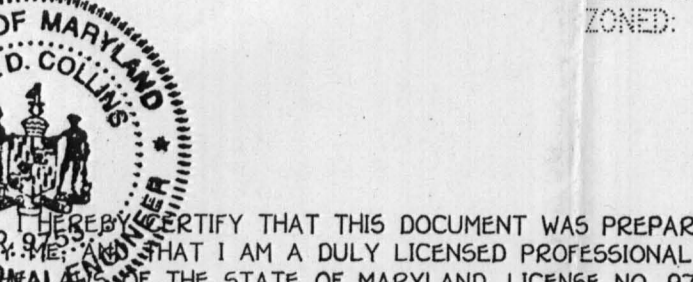

LEGEND

| SYMBOL | DESCRIPTION |
|-----------|------------------------------|
| --- | EXISTING CONTOUR 2' INTERVAL |
| - - - - | PROPOSED CONTOUR 2' INTERVAL |
| +362.5 | SPOT ELEVATION |
| -55' -55' | SUPER SILT FENCE |
| • | EROSION CONTROL MATTING |
| LOD | LIMITS OF DISTURBANCE |

THIS DEVELOPMENT IS APPROVED FOR SOIL EROSION AND SEDIMENT CONTROL BY THE HOWARD SOIL CONSERVATION DISTRICT. APPROVED:

Ma. K. P... 1/4/08
HOWARD SOIL CONSERVATION DISTRICT DATE

3299 CLARKS MEADOW DRIVE
PERCOLATION CERTIFICATION PLAN
SEDIMENT/EROSION CONTROL, NOTES & DETAILS
CLARKS MEADOW
LOT 9

ZONED: RC-DEO PLAT NO: 15703
4TH ELECTION DISTRICT HOWARD COUNTY, MARYLAND
SCALE: 1" = 30' DATE: DECEMBER, 2007

SHEET 1 OF 1 PC#52362G-I

G.P. 08-45