

DEPARTMENT OF INSPECTIONS, LICENSES AND PERMITS HOWARD COUNTY HOUSE DRIVE ELLICOTT CITY, MD 21043 PERMITS (410) 313-3406 INSPECTIONS (410) 313-1410 AUTOMATED INFORMATION (410) 313-3800	HOWARD COUNTY PERMIT APPLICATION	PERMIT NUMBER 808001876
Building Address <u>3565 Church Rd.</u> <u>ELLICOTT CITY MD. 21043</u> Suite/Apt. #: _____ SDP/WP/Petition #: _____ Census Tract _____ Subdivision _____ Section _____ Area _____ Lot _____ Tax Map _____ Parcel _____ Grid _____ Zoning _____ Map Coordinates _____ Lot size _____	Property Owner's Name <u>JEFFREY RASMUSSEN</u> Address <u>3565 Church Rd.</u> City <u>ELLICOTT CITY</u> State <u>MD</u> Zip Code <u>21043</u> Phone <u>410-480-1655</u> Phone _____ Applicant's Name & Mailing Address, (if other than stated hereon): Phone _____ Fax _____	
Existing Use <u>Residence</u> Proposed Use <u>Residence</u> Estimated Construction Cost \$ <u>85,000.00</u> Description of Work <u>Build a one story addition and deck on rear of existing house</u>	Contractor Company <u>D.M. Delp co.</u> Contact Person <u>Dale M. Delp</u> Address <u>5617 Wilken Ave.</u> City <u>Catonsville</u> State <u>MD</u> Zip Code <u>21228</u> License No. <u>65153</u> Phone <u>410-747-2149</u> Fax _____	
Occupant or Tenant _____ Contact Name _____ Address _____ City _____ State _____ Zip Code _____ Phone _____ Fax _____	Engineer or Architect Company _____ Contact Person _____ Address _____ City _____ State _____ Zip Code _____ Phone _____ Fax _____	

BUILDING DESCRIPTION - COMMERCIAL		BUILDING DESCRIPTION - RESIDENTIAL	
Building Characteristics Height: _____ No. of stories: _____ Gross area, sq. ft. per floor: _____ Use group: _____ Construction type: <input type="checkbox"/> Reinforced Concrete <input type="checkbox"/> Structural Steel <input type="checkbox"/> Masonry <input type="checkbox"/> Wood Frame <input type="checkbox"/> State Certified Modular	Utilities Water Supply: <input type="checkbox"/> Public <input type="checkbox"/> Private Sewage Disposal: <input type="checkbox"/> Public <input type="checkbox"/> Private Electric Yes <input type="checkbox"/> No <input type="checkbox"/> Gas Yes <input type="checkbox"/> No <input type="checkbox"/> Heating System: <input type="checkbox"/> Electric <input type="checkbox"/> Oil <input type="checkbox"/> <input type="checkbox"/> Natural Gas <input type="checkbox"/> <input type="checkbox"/> Propane Gas <input type="checkbox"/> Sprinkler system: N/A <input type="checkbox"/> <input type="checkbox"/> Full <input type="checkbox"/> Partial <input type="checkbox"/> Other Suppression <input type="checkbox"/> # of Heads	Building Characteristics SF Dwelling <input checked="" type="checkbox"/> SF Townhouse <input type="checkbox"/> <u>Depth</u> <u>Width</u> 1st floor: _____ 2nd floor: _____ Basement: <input type="checkbox"/> Finished Basement <input type="checkbox"/> Unfinished Basement <input type="checkbox"/> Crawl space <input type="checkbox"/> Slab on Grade <input type="checkbox"/> No. of Bedrooms: _____ Height: _____ Multi-family dwellings: No. of efficiency units: _____ No. of 1 BR units: _____ No. of 2 BR units: _____ No. of 3 BR units: _____ Other Structure: _____ Dimensions: _____ Footings: _____ Roof Height: _____ <input type="checkbox"/> State Certified Modular <input type="checkbox"/> Manufactured Home	Utilities Water Supply: <input checked="" type="checkbox"/> Public <input type="checkbox"/> Private Sewage Disposal: <input type="checkbox"/> Public <input checked="" type="checkbox"/> Private Electric Yes <input type="checkbox"/> No <input type="checkbox"/> Gas Yes <input type="checkbox"/> No <input type="checkbox"/> Heating System: <input type="checkbox"/> Electric <input type="checkbox"/> Oil <input type="checkbox"/> <input type="checkbox"/> Natural Gas <input type="checkbox"/> <input type="checkbox"/> Propane Gas <input type="checkbox"/> Sprinkler system: N/A <input type="checkbox"/> <input type="checkbox"/> NFPA #13D <input type="checkbox"/> NFPA #13R <input type="checkbox"/> Other:

THE UNDERSIGNED HEREBY CERTIFIES AND AGREES AS FOLLOWS: (1) THAT HE/SHE IS AUTHORIZED TO MAKE THIS APPLICATION; (2) THAT THE INFORMATION IS CORRECT; (3) THAT HE/SHE WILL COMPLY WITH ALL REGULATIONS OF HOWARD COUNTY WHICH ARE APPLICABLE THERETO; (4) THAT HE/SHE WILL PERFORM NO WORK ON THE ABOVE REFERENCED PROPERTY NOT SPECIFICALLY DESCRIBED IN THIS APPLICATION; (5) THAT HE/SHE GRANTS COUNTY OFFICIALS THE RIGHT TO ENTER ONTO THIS PROPERTY FOR THE PURPOSE OF INSPECTING THE WORK PERMITTED AND POSTING NOTICES.

<u>M. B. Delp</u> Applicant's Signature <u>D. M. Delp co.</u> Title/Company	<u>M. B. Delp</u> Print Name <u>6-25-2008</u> Date
--	---

Checks payable to: **DIRECTOR OF FINANCE OF HOWARD COUNTY**
 ** PLEASE WRITE NEATLY AND LEGIBLY. **
 FOR OFFICE USE ONLY

AGENCY	DATE	SIGNATURE APPROVAL	DPZ SETBACK INFORMATION	PROPERTY ID#
Land Development, DPZ			Front: _____	Filing fee \$ _____
State Highways			Rear: _____	Permit fee \$ _____
Building Official			Side: _____	Excise tax \$ _____
Dev. Engineering, DPZ			Side St: _____	Add'l per. fee \$ _____
Health	<u>6/25/08</u>	<u>[Signature]</u>	All minimum setbacks met?	TOTAL FEES \$ _____
Fire Protection			YES <input type="checkbox"/> NO <input type="checkbox"/>	Sub-total paid \$ _____
Is Sediment Control approval required prior to issuance?			Is Entrance Permit required?	Balance due \$ _____
YES <input type="checkbox"/> NO <input type="checkbox"/>			YES <input type="checkbox"/> NO <input type="checkbox"/>	Check # _____
			Historic District?	Validation # _____
			YES <input type="checkbox"/> NO <input type="checkbox"/>	
CONTINGENCY CONSTRUCTION START: <input type="checkbox"/>			Lot Coverage for New Town Zone _____	
ONE-STOP SHOP: <input type="checkbox"/>			SDP/Red-line approval date _____	Accepted by _____
Distribution of Copies: White: Building Official Green: LDD, DPZ Yellow: DED, DPZ Pink: Health Gold: SHA				

APPROVED
WALKTHRU BUILDING PERMIT
BE# _____ A# N/A
APP SAN 45 DATE: 6-25-08
DESC. OF WORK: addition (no basement)
& deck

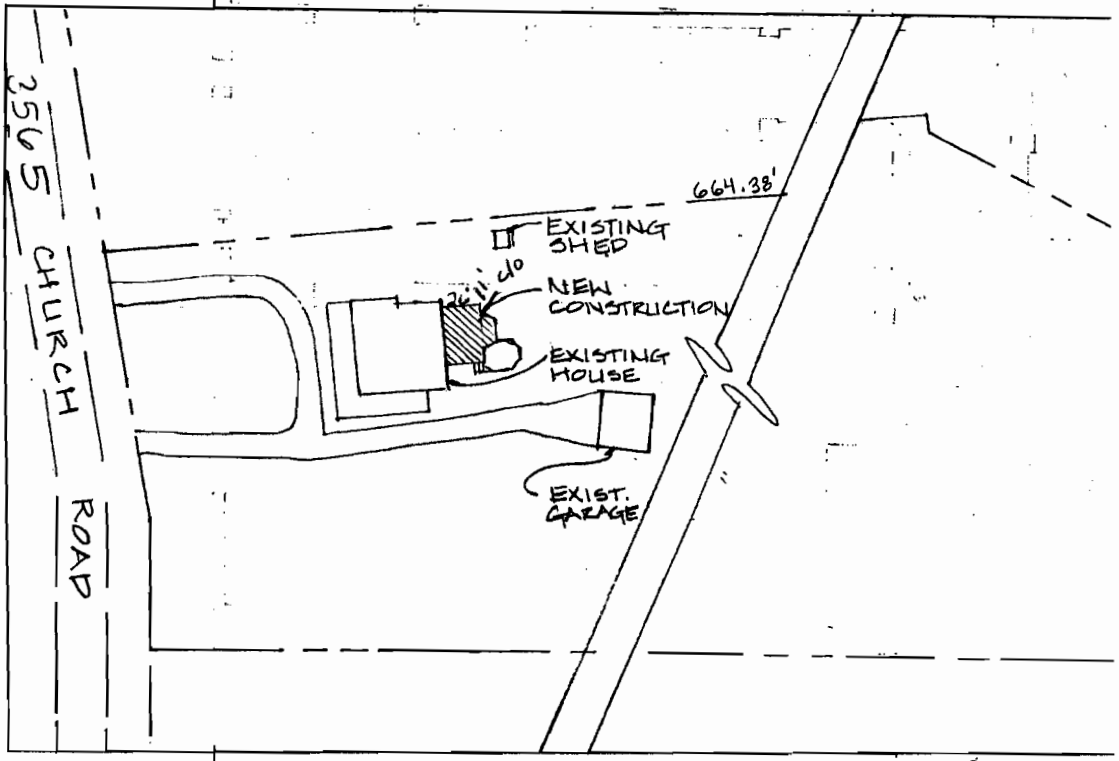

1
A-1

SITE PLAN (INSET)

SCALE ~ 1" = 60'-0"