

06-394760

PERMIT

P 34957

A 34449

SEWAGE DISPOSAL SYSTEM

MARYLAND STATE DEPARTMENT OF HEALTH

NO INS. NOT APPROVED

2/12/85

HOWARD COUNTY
BUREAU OF ENVIRONMENTAL HEALTH
992-2330

ELLICOTT CITY

DISTRICT 6th

DATE 2/11/85

NO INSPECTION RECORDS AS OF 7/95
PRESUMED COMPLETED
INDEX NOT APPROVED

(CW)

(CW)

INDEXED

Warren Brown

IS PERMITTED TO INSTALL ALTER

ADDRESS 11609 Maryland Avenue, Beltsville, MD 20705 PHONE 937-4119

SUBDIVISION _____ ROAD 7623 Old Columbia LOT Parcel 6

PROPERTY OWNER Warren Brown

ADDRESS _____

IF GARBAGE GRINDER IS USED INCREASE SEPTIC TANK CAPACITY BY 50% AND ABSORPTION AREA BY 22%.

GARBAGE GRINDER? YES NO

SEPTIC TANK CAPACITY 2000 GALLONS NUMBER OF BEDROOMS 5

2 DRYWELLS - EACH 15 ft. square

DRY WELLS - 153 sq. ft. with garbage disposal. Inlet 2 1/2 feet below original grade. Bottom maximum depth 9 feet below original grade. Effective area begins at 2 1/2 feet below original grade. NOTE: If Trench is used to make up absorbent area, run the trench on level ground and leave a 5 foot earth buffer between dry well and trench. No trench is to exceed 100 feet in length. Trench inlet to be same as dry well, with 6 1/2 feet of stone below distribution pipe. LOCATION: Place the first dry well 475 feet from the front lot line and 185 feet from the left lot line. Second dry well to be 30 feet downhill from first dry well.

PLANS APPROVED BY C. Williams

DATE 2/11/85

COVER NO WORK UNTIL INSPECTED AND APPROVED.

NEITHER THE HOWARD COUNTY COUNCIL NOR THE HEALTH DEPARTMENT IS RESPONSIBLE FOR THE SUCCESSFUL OPERATION OF ANY SYSTEM.

NOTE: IF TRENCH IS USED CALL FOR INSPECTION BEFORE AND AFTER PLACING GRAVEL IN TRENCH.

NOTE: NO DRY WELL SHALL EXCEED 15 FOOT IN DIAMETER. NO ABSORPTION TRENCH TO EXCEED 100 FEET IN LENGTH.

NOTE: ALL PIPE FROM HOUSE TO SEPTIC TANK MUST BE CAST IRON OR SCHEDULE 40 PVC OR ABS.

PERMIT VOID AFTER THREE YEARS.

NOTE: INSTALL STAND PIPE ON SEPTIC TANK AND DRY WELL. STAND PIPES MUST BE 6 INCHES IN DIAMETER. CAST IRON, CONCRETE OR TERRA COTTA, OR PVC OR ABS ACCEPTED. IF TOP OF SEPTIC TANK IS DEEPER THAN 3 FEET MANHOLE TO GRADE REQUIRED.

***INSTALLER IS RESPONSIBLE FOR OBTAINING FINAL APROVAL ON THIS PERMIT**

*CALL 992-2330 FOR INSPECTION OF SEPTIC SYSTEMS.

EH - 2-1082

A 34449

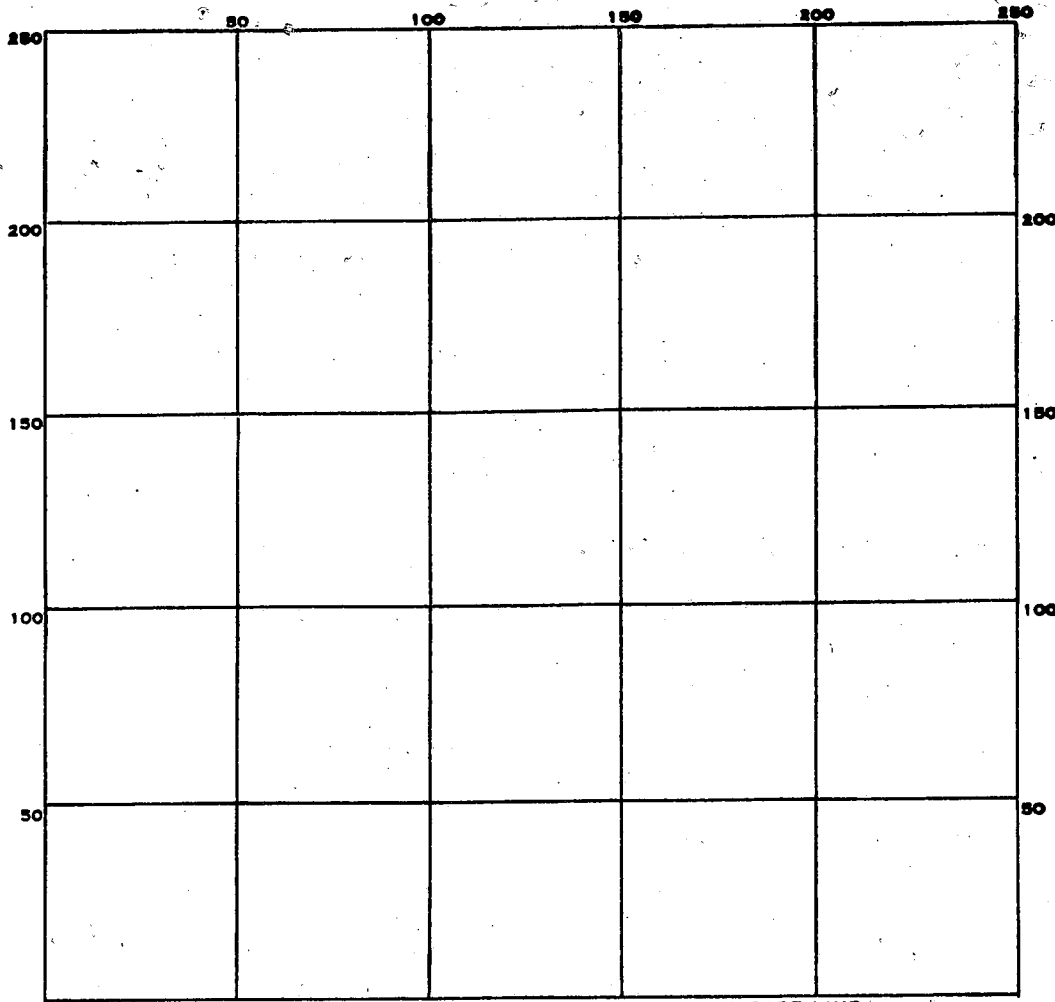

INDICATE NORTH. - NAME ADJOINING ROADWAY AS BASE LINE.

PERMIT CARD _____

SEPTIC TANK, LEVEL _____ CLEANOUTS _____

DISTRIBUTION BOX, LEVEL _____

TILE FIELD, DEPTH _____ FT. TRENCH WIDTH _____ FT.

GRAVEL DEPTH _____ IN. TOTAL LENGTH _____ FT.

NUMBER OF TRENCHES _____ TOTAL BOTTOM AREA _____

SEEPAGE PITS, INSIDE DIAMETER _____ FT. DEPTH BELOW INLET _____ FT.

ABSORBENT AREA _____ SQ. FT.

REMARKS NO RECORD OF ANY INSPECTION AS OF
7/17/95
INDEX AS PROSURES COMPLETED, NOT APPROVED (CL)

DATE SYSTEM APPROVED _____ INSPECTOR _____

C1 2925 (THIS NUMBER IS TO BE PUNCHED IN COLS. 3-6 ON ALL CARDS)

STATE OF MARYLAND WELL COMPLETION REPORT
 FILL IN THIS FORM COMPLETELY PLEASE PRINT OR TYPE

THIS REPORT MUST BE SUBMITTED WITHIN 45 DAYS AFTER WELL IS COMPLETED.
 COUNTY NUMBER A 34449

DATE RECEIVED [] [] [] [] [] [] DATE WELL COMPLETED 020615 Depth of Well 175 (TO NEAREST FOOT) PERMIT NO. FROM "PERMIT TO DRILL WELL" H0-81-0702

OWNER Brown Warren
 STREET OR RFD last name 3 Old Columbia Rd. first name TOWN Atholton
 SUBDIVISION MAP 41 PARCEL 6 SECTION LOT

WELL LOG
 Not required for driven wells

STATE THE KIND OF FORMATIONS PENETRATED, THEIR COLOR, DEPTH, THICKNESS AND IF WATER BEARING

DESCRIPTION (Use additional sheets if needed)	FEET		Check if water bearing
	FROM	TO	
Overburden	0	5	
Mica	5	42	
GRAY ROCK	42	175	X

GROUTING RECORD
 WELL HAS BEEN GROUTED (Circle Appropriate Box) YES NO
 TYPE OF GROUTING MATERIAL
 CEMENT CM BENTONITE CLAY BC
 NO. OF BAGS 10 NO. OF POUNDS 1000
 GALLONS OF WATER 60
 DEPTH OF GROUT SEAL (to nearest foot)
 from 0 ft. to 42 ft.
 (enter 0 if from surface)

CASING RECORD
 casing types insert appropriate code below
 ST CO
 STEEL CONCRETE
 PL OT
 PLASTIC OTHER

MAIN CASING TYPE ST
 Nominal diameter top (main) casing (nearest inch) 6
 Total depth of main casing (nearest foot) 42

OTHER CASING (if used)
 diameter inch depth (feet) from to

SCREEN RECORD
 screen type or open hole insert appropriate code below
 ST BR HO
 STEEL BRASS OPEN HOLE
 PL OT
 PLASTIC OTHER

C2
 DEPTH (nearest ft.)
 EACH SCREEN
 1 H0 42 175
 2
 3
 SLOT SIZE 1 2 3
 DIAMETER OF SCREEN (NEAREST INCH) from to

CIRCLE APPROPRIATE LETTER
 A A WELL WAS ABANDONED AND SEALED WHEN THIS WELL WAS COMPLETED
 E ELECTRIC LOG OBTAINED
 P TEST WELL CONVERTED TO PRODUCTION WELL

I HEREBY CERTIFY THAT THIS WELL HAS BEEN CONSTRUCTED IN ACCORDANCE WITH COMAR 10.17.13 "WELL CONSTRUCTION" AND IN CONFORMANCE WITH ALL CONDITIONS STATED IN THE ABOVE CAPTIONED PERMIT, AND THAT THE INFORMATION PRESENTED HEREIN IS ACCURATE AND COMPLETE TO THE BEST OF MY KNOWLEDGE.

DRILLERS IDENT. NO. 120
 DRILLERS SIGNATURE Sandy B Cochran
 DRILLERS SIGNATURE (MUST MATCH SIGNATURE ON APPLICATION) Thoyd Price
 SITE SUPERVISOR (sign. of driller or journeyman responsible for sitework if different from permittee)

GRAVEL PACK IF WELL DRILLED WAS FLOWING WELL INSERT F IN BOX 68

OEP USE ONLY (NOT TO BE FILLED IN BY DRILLER)
 T (E.R.O.S.) WQ
 70 72 74 75 76
 TELESCOPE CASING LOG INDICATOR OTHER DATA

C3
PUMPING TEST
 HOURS PUMPED (nearest hour) 6
 PUMPING RATE (gal. per min. to nearest gal.) 170
 METHOD USED TO MEASURE PUMPING RATE SUBMERSIBLE
 WATER LEVEL (distance from land surface) BEFORE PUMPING 3711" WHEN PUMPING 1372"
 TYPE OF PUMP USED (for test)
 A air P piston T turbine
 C centrifugal R rotary O other (describe below)
 J jet S submersible

PUMP INSTALLED
 DRILLER WILL INSTALL PUMP YES NO
 IF DRILLER INSTALLS PUMP, THIS SECTION MUST BE COMPLETED FOR ALL WELLS EXCEPT HOME USE
 TYPE OF PUMP INSTALLED PLACE (A,C,J,P,R,S,T,O) IN BOX - SEE ABOVE:
 CAPACITY: GALLONS PER MINUTE (to nearest gallon)
 PUMP HORSE POWER
 PUMP COLUMN LENGTH (nearest ft.)
 CASING HEIGHT (circle appropriate box and enter casing height)
 + above } LAND SURFACE (nearest foot)
 - below }

LOCATION OF WELL ON LOT
 SHOW PERMANENT STRUCTURE SUCH AS BUILDING, SEPTIC TANKS, AND/OR LANDMARKS AND INDICATE NOT LESS THAN TWO DISTANCES (MEASUREMENTS TO WELL)

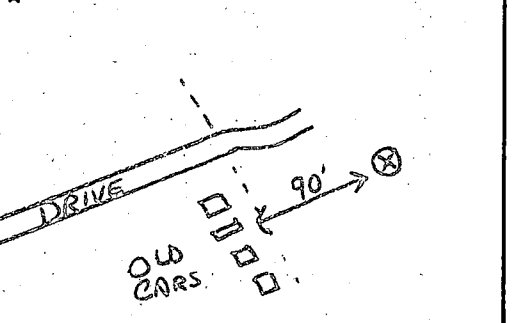

FIELD DATA SHEET
HOWARD COUNTY WELL YIELD TEST

Well Permit No. HO - 81-0702
 Location of property (road) 7623 Old Columbia Rd.
 Subdivision Map 41 Parcel 6 Lot Block Plat Sec.
 Well Driller Sandy B. Cochran Owner Warren Brown

Depth of well 175
 Distance of measuring point (M.P.) above ground 14"
 Static water level (S.W.L.) below M.P. 37' 11"

High rate pumping -- reservoir drawdown

Time pump started 0800 Pumping rate 14.29
 Total time 90 to reach pumping water level 140 ft. below M.P.

11. Recovery pump test data - observations to be recorded every 15 minutes

TIME (in 15 minute intervals)	WATER LEVEL below M.P.	PUMPING RATE time to fill 5 gallon bucket	FLOW METER READING (if used)	CALCULATED FLOW (gallons per minute)
0800	37' 11"	21		14.29
0815	75'	21		14.29
0830	90' 3"	21		14.29
0845	103' 4"	21		14.29
0900	111' 3"	21		14.29
0915	120' 2"	21		14.29
0930	140'	21		14.29
0945	135' 9"	25		12.0
1000	135' 9"	25		12.0
1015	135' 9"	25		12.0
1030	135' 9"	25		12.0
1045	135' 9"	25		12.0
1100	136' 1"	25		12.0
1115	136' 8"	25		12.0
1130	136' 7"	25		12.0
1145	136' 7"	25		12.0
1200	136' 7"	25		12.0
1215	136' 7"	25		12.0
1230	136' 7"	25		12.0
1245	136' 7"	25		12.0
1300	136' 7"	25		12.0
1315	136' 7"	25		12.0
1330	136' 7"	25		12.0
1345	136' 9"	25		12.0

B 1 **6453** SEQUENCE NO. (OEP USE ONLY)
 (THIS NUMBER IS TO BE PUNCHED IN COLS. 3-6 ON ALL CARDS)

STATE OF MARYLAND
 PERMIT TO DRILL WELL
 please print or type

OEP PERMIT NUMBER
40-81-0798
 fill in this form completely

Date Received **1/16/84 - 1:00 PM**
 OWNER INFORMATION
NEEDHAM GEOFFREY
 Last Name Owner First Name
7621010 COLUMBIA Rd
 Street or RFD
LAUREL **MD 20707**
 Town State Zip

B 3 LOCATION OF WELL
HOWARD COUNTY
 SUBDIVISION
 SECTION **44 46** LOT **48 50** **PARCEL 6**
COLUMBIA NEAREST TOWN
 MILES FROM TOWN (enter 0 if in town) **3 MI**

DRILLER INFORMATION
Dana Kyker, Jr. II License No. **256**
Westminster Rotary Well Drilling, Inc.
 Firm Name
Box 86 Westminster, Md. 11/14/84
 Address
Dana Kyker, Jr. II Date

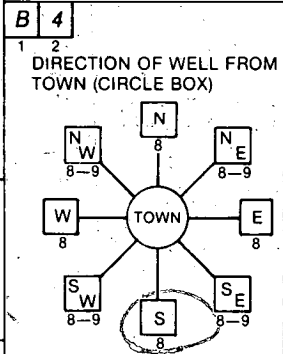

Rt. 29 NEAR WHAT ROAD
 NOT TO BE FILLED IN BY DRILLER HEALTH DEPARTMENT APPROVAL
Howard COUNTY NAME
A-W-34575 COUNTY NO.
 OEP SIGNATURE _____ STATE HEALTH INSERT S _____
 DATE ISSUED **112784** CO SIGNATURE **CW...** EXP. DATE **5/27/85**
 NORTH GRID **480000** EAST GRID **0830000**

B 2 WELL INFORMATION
 APPROX. PUMPING RATE (GAL. PER MIN.) **5**
 AVERAGE DAILY QUANTITY NEEDED (GAL. PER DAY) **395**

USE FOR WATER (CIRCLE APPROPRIATE BOX)
 HOME (SINGLE OR DOUBLE HOUSEHOLD UNIT ONLY)
 FARMING (LIVESTOCK WATERING & AGRICULTURAL IRRIGATION)
 INDUSTRIAL, COMMERCIAL, STATE AND FEDERAL GOV. OTHER (REQUIRES APPROPRIATION PERMIT)
 PUBLIC OR PRIVATE WATER COMPANY (REQUIRES APPROPRIATION PERMIT AND STATE HEALTH DEPARTMENT APPROVAL)
 TEST, OBSERVATION, MONITORING (MAY REQUIRE APPROPRIATION PERMIT)

SHOW MAJOR FEATURES OF BOX & LOCATE WELL WITH AN X
 SOURCES OF DRILLING WATER
 1. **CITY**
 2.
 3.
 WRITE THE BOX NUMBER FROM THE MAP HERE
 E **830**
 N **480**
 000
 000
Location looks OK? No Property tables
84' casing
50' open
25' bag cement
Tag + papers given to Kyker crew
X WELL
12/6/84

APPROXIMATE DEPTH OF WELL **75** FEET

APPROXIMATE DIAMETER OF WELL **6"** NEAREST INCH

METHOD OF DRILLING (circle one)
 BORED (or Augered) JETTED Jetted & DRIVEN
 AIR-ROTary AIR-PERCussion ROTARY (Hydraulic Rotary)
 CABLE REVerse-ROTary DRive-POINT
 other _____

REPLACEMENT OR DEEPEINED WELLS (CIRCLE APPROPRIATE BOX)
 THIS WELL WILL NOT REPLACE AN EXISTING WELL
 THIS WELL WILL REPLACE A WELL THAT WILL BE ABANDONED AND SEALED
 THIS WELL WILL REPLACE A WELL THAT WILL BE USED AS A STANDBY
 THIS WELL WILL DEEPEIN AN EXISTING WELL
 PERMIT NUMBER OF WELL TO BE REPLACED OR DEEPEINED (IF AVAILABLE) _____

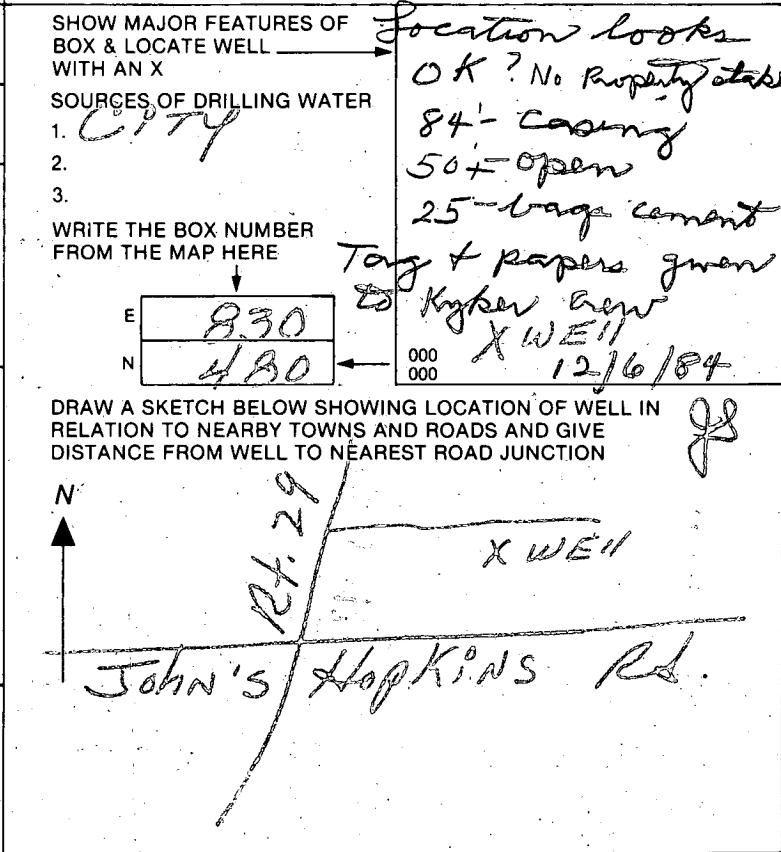

Not to be filled in by driller (OEP USE ONLY)
 APPROP. PERMIT NUMBER _____ GAP _____
 FORCE **06** WRITE INITIALS IN BOX PERMIT No. **40-81-0798**

SPECIAL CONDITIONS

Plat for
Well site
Geoffrey Needham

RECEIVED
NOV 21 9 25 AM '94
ELECTRONIC

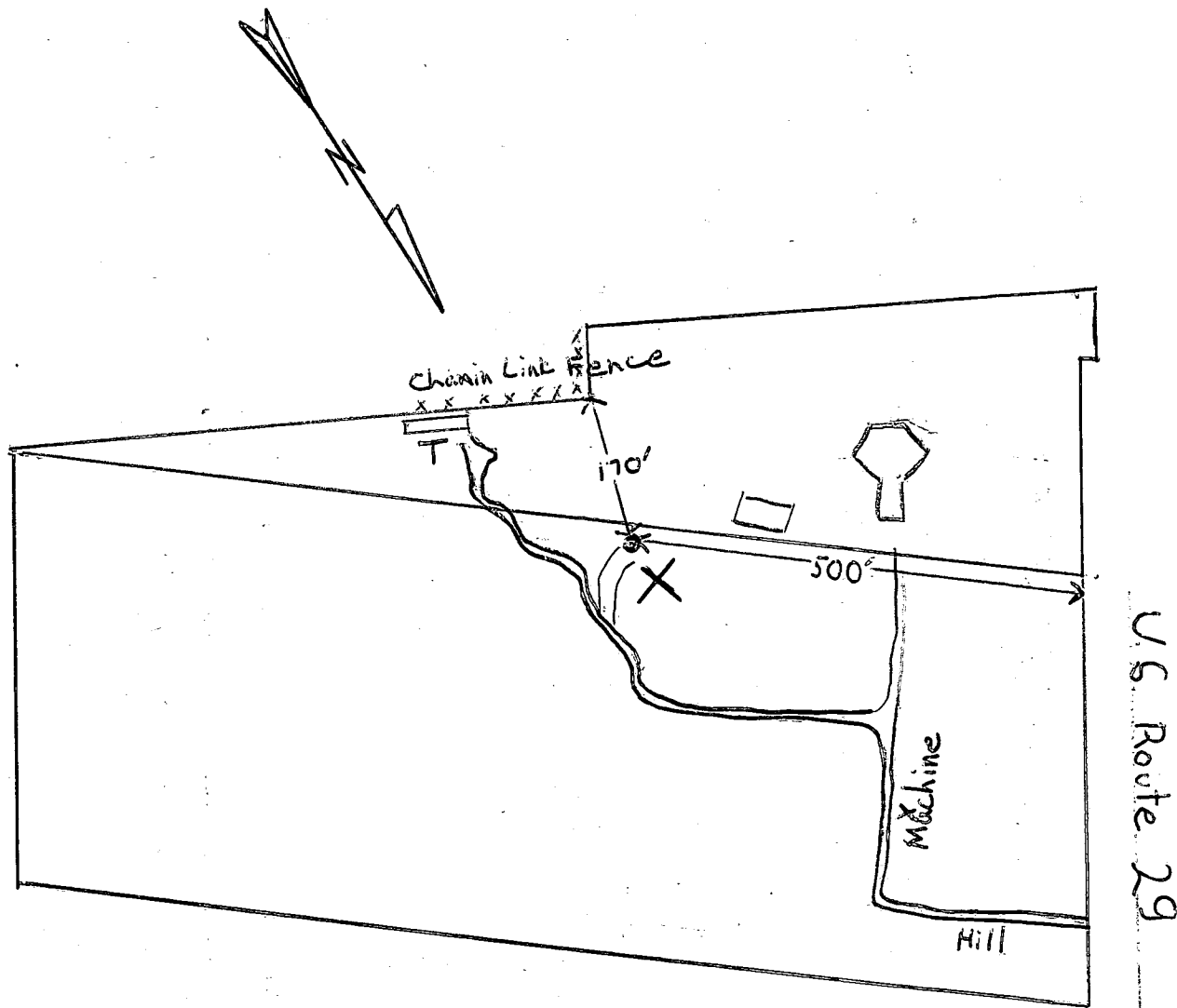

T= trailer
X= well vicinity

$$.5 \left(\frac{1}{2}\right) = 100 \text{ Feet}$$

APPLICATION

SEWAGE DISPOSAL TESTING

STATE OF MARYLAND - DEPARTMENT OF HEALTH AND MENTAL HYGIENE

A 34449

P _____

HOWARD COUNTY HEALTH DEPARTMENT
ENVIRONMENTAL HEALTH SERVICES
P. O. BOX 476 ELLICOTT CITY, MARYLAND 21043
TELEPHONE: 992-2330

DISTRICT Sixth Election District

DATE 10-9-84

*10/15/84
9:30 AM
10/14/84
1:30 PM*

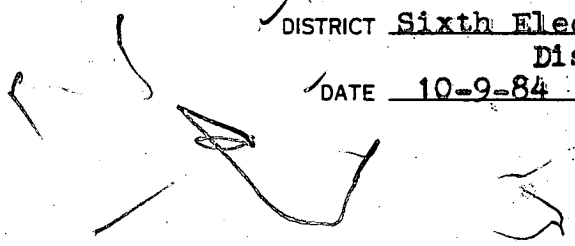

TO: THE COUNTY HEALTH OFFICER
ELLICOTT CITY, MARYLAND

I, HEREBY, APPLY FOR THE NECESSARY TEST IN ORDER TO CONSTRUCT (OR RECONSTRUCT) A SEWAGE DISPOSAL SYSTEM.

PROPERTY OWNER Warren & Teresa Brown, Geoffrey & Linde Needham, and Merlin & Doris Brown

ADDRESS 7623 Old Columbia Rd., Laurel, MD 20707 PHONE 776-8646

Day phone: 937-4119

PROPERTY LOCATION:

SUBDIVISION not in subdivision LOT NO. none

ROAD AND DESCRIPTION 7603 Old Columbia Road Col. Pike

SIZE OF LOT 12.56 acres TYPE BLDG. 3 bedrooms

(NUMBER OF BEDROOMS)
WITH GARBAGE

THE SYSTEM INSTALLED UNDER THIS APPLICATION IS ACCEPTABLE ONLY UNTIL PUBLIC FACILITIES BECOME AVAILABLE. I FULLY UNDERSTAND THE FEE CONNECTED WITH THE FILING OF THIS PERC TEST APPLICATION IS NON-REFUNDABLE UNDER ANY CIRCUMSTANCES. I ALSO AGREE TO COMPLY

WITH ALL M.O.S.H.A. REQUIREMENTS IN TESTING THIS LOT. Warren E Brown
(SIGNATURE OF APPLICANT)

APPROVED BY Raymond Hodger FOR Myrella French DATE 2/11/85

REJECTED BY _____ FOR _____ DATE _____

HOLD PENDING FURTHER TESTS _____ DATE _____

REASONS FOR REJECTION OR HOLDING 10/15/84 - More holes needed for
10/16/84 - Res OK Hold for Certifier/Hole
& mine elevation - septic plan R/H
2/9

INDIC. PERMIT SIGNED
AND RETURNED 2-22-85

THIS IS NOT A PERMIT

APPLICATION

SEWAGE DISPOSAL TESTING

A 34449

STATE OF MARYLAND - DEPARTMENT OF HEALTH AND MENTAL HYGIENE

P _____

HOWARD COUNTY HEALTH DEPARTMENT
ENVIRONMENTAL HEALTH SERVICE
P. O. BOX 476 ELLICOTT CITY, MARYLAND 21043
TELEPHONE: 992-2330

✓ DISTRICT Sixth Election District
DATE 10-9-84

TO: THE COUNTY HEALTH OFFICER
ELLICOTT CITY, MARYLAND

I, HEREBY, APPLY FOR THE NECESSARY TEST IN ORDER TO CONSTRUCT (OR RECONSTRUCT) A SEWAGE DISPOSAL SYSTEM.

✓ PROPERTY OWNER Warren & Teresa Brown, Geoffrey & Linde Needham, and Merlin & Doris Brown

ADDRESS 7623 Old Columbia Rd., Laurel, MD 20707 PHONE 776-8646

Day phone: 937-4119

✓ PROPERTY LOCATION: 7603 Columbia Pike

✓ SUBDIVISION not in subdivision LOT NO. none

✓ ROAD AND DESCRIPTION _____

✓ SIZE OF LOT 12.56 acres TYPE BLDG. 3 bedrooms
(NUMBER OF BEDROOMS)

THE SYSTEM INSTALLED UNDER THIS APPLICATION IS ACCEPTABLE ONLY UNTIL PUBLIC FACILITIES BECOME AVAILABLE. I FULLY UNDERSTAND THE FEE CONNECTED WITH THE FILING OF THIS PERC TEST APPLICATION IS NON-REFUNDABLE UNDER ANY CIRCUMSTANCES. I ALSO AGREE TO COMPLY

✓ WITH ALL M.O.S.H.A. REQUIREMENTS IN TESTING THIS LOT. _____

(SIGNATURE OF APPLICANT)

APPROVED BY _____ FOR _____ DATE _____

REJECTED BY _____ FOR _____ DATE _____

HOLD PENDING FURTHER TESTS _____ DATE _____

REASONS FOR REJECTION OR HOLDING _____

THIS IS NOT A PERMIT

97
26
SOIL PROFILE

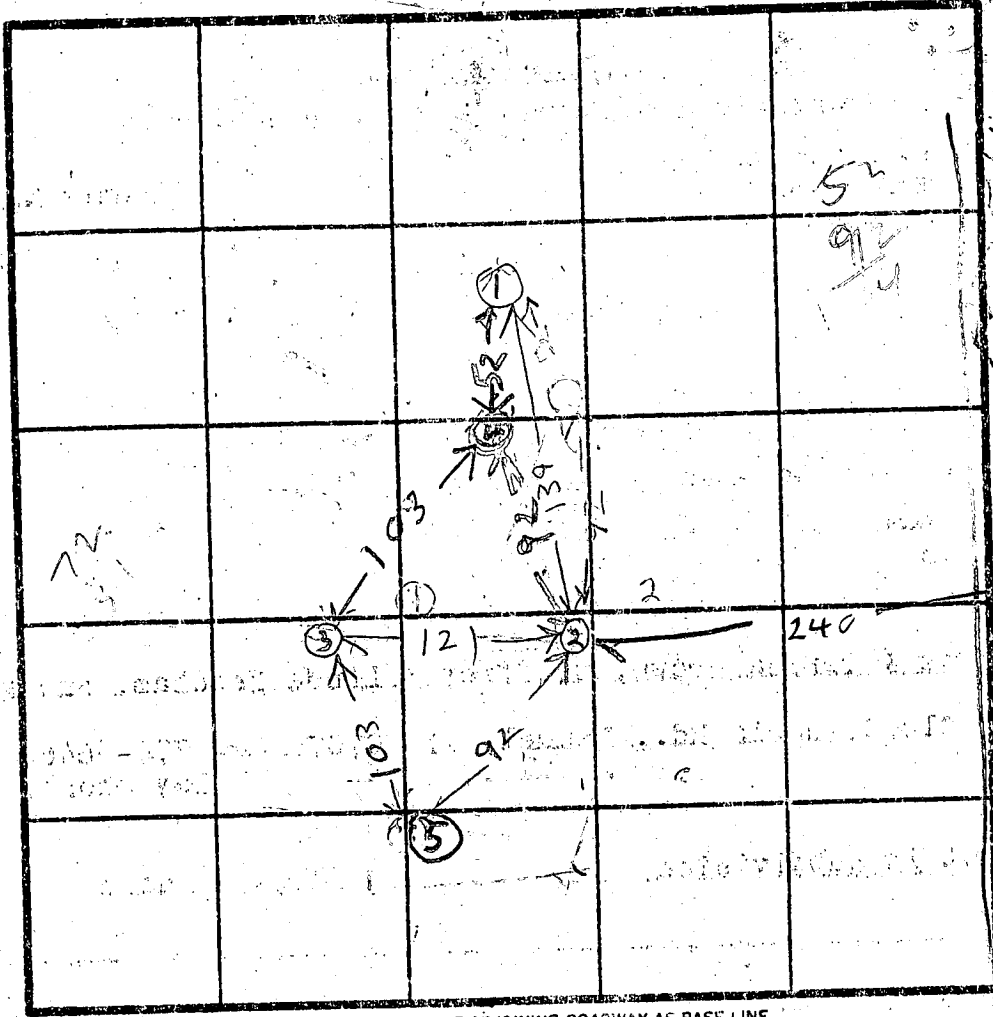

EXISTING BUILDING ON NEXT LOT



INDICATE NORTH - NAME ADJACING ROADWAY AS BASE LINE.

PT 29

DATE	TEST NO.	DEPTH	PRE WET		TEST - 1" DROP		TIME
			START	STOP	START	STOP	
10/15/04	1V	11	WATER		10 FT		
	2S	4	1155	1157	1157	1200	3
	2V	11 1/2	LOOKS OK				
	3S	4 1/2	1206	1210	1210	1215	5
	3V	11	LOOKS OK				
10/16/04	4S	5 1/2	143	144	144	145	1
10/16/04	4V	11 1/2	LOOKS OK				
	5S	5 1/2	156	157	157	159	2
10/16/04	5V	12	LOOKS OK				
see other side for soil profile							

1 = LOWEST
4 = LOW
5 = HIGHEST
2 = NEXT HIGH

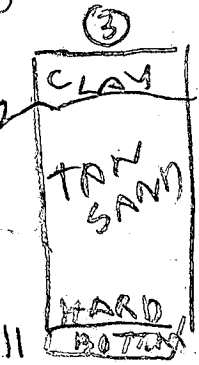
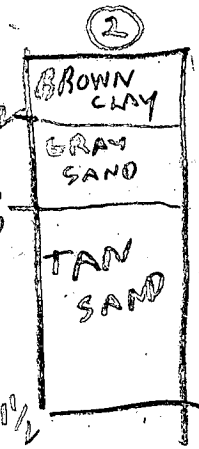

REMARKS 2 holes only 8 FT deep due at time of arrival. Backhoe broke after 3 holes dug. Holes dug in woods near junk yard.

RAJUDGES

PART OWNER WARREN BROWN BACKH

B 1 7381 SEQUENCE NO. (OEP USE ONLY)
(THIS NUMBER IS TO BE PUNCHED IN COLS. 3-6 ON ALL CARDS)

STATE OF MARYLAND PERMIT TO DRILL WELL

please print or type

OEP PERMIT NUMBER

HO-81-0702
fill in this form completely

Date Received: 1/16/85 - 2:00 PM.
OWNER INFORMATION
BROWN WARREN
11609 MARYLAND AVE
BELTSVILLE MD 20705

DRILLER INFORMATION
Sandy B. Cochran
G. EDGAR HARR SONS CORP.
1207 Falls Rd, Conowingo, MD 21030
12-7-84

WELL INFORMATION
APPROX. PUMPING RATE (GAL. PER MIN.) 5
AVERAGE DAILY QUANTITY NEEDED (GAL. PER DAY) 750

USE FOR WATER (CIRCLE APPROPRIATE BOX)
D HOME (SINGLE OR DOUBLE HOUSEHOLD UNIT ONLY)
F FARMING (LIVESTOCK WATERING & AGRICULTURAL IRRIGATION)
I INDUSTRIAL, COMMERCIAL, STATE AND FEDERAL GOV. OTHER (REQUIRES APPROPRIATION PERMIT)
P PUBLIC OR PRIVATE WATER COMPANY (REQUIRES APPROPRIATION PERMIT AND STATE HEALTH DEPARTMENT APPROVAL)
T TEST, OBSERVATION, MONITORING (MAY REQUIRE APPROPRIATION PERMIT)

APPROXIMATE DEPTH OF WELL 200 FEET
APPROXIMATE DIAMETER OF WELL 6 INCH

METHOD OF DRILLING (circle one)
BORED (or Augered) JETTED Jetted & DRIVEN
AIR-ROTary AIR-PERCussion ROTARY (Hydraulic Rotary)
CABLE REVerse-ROTary DRive-POINT
other

REPLACEMENT OR DEEPEMED WELLS (CIRCLE APPROPRIATE BOX)
N THIS WELL WILL NOT REPLACE AN EXISTING WELL
Y THIS WELL WILL REPLACE A WELL THAT WILL BE ABANDONED AND SEALED
S THIS WELL WILL REPLACE A WELL THAT WILL BE USED AS A STANDBY
D THIS WELL WILL DEEPEN AN EXISTING WELL
PERMIT NUMBER OF WELL TO BE REPLACED OR DEEPEMED (IF AVAILABLE)

Not to be filled in by driller (OEP USE ONLY)
APPROP. PERMIT NUMBER GAP
FORCE FS PERMIT NO. HO-81-0702

SPECIAL CONDITIONS

LOCATION OF WELL W-34656 40.10
HOWARD COUNTY
MAP 41 PARCEL 6
SECTION 44 46 LOT 48 50
ATHOLTON
MILES FROM TOWN (enter 0 if in town) 2 MI

7623 OLD COLUMBIA RD.
DIRECTION OF WELL FROM TOWN (CIRCLE BOX)
ON WHICH SIDE OF ROAD (CIRCLE APPROPRIATE BOX)
DISTANCE FROM ROAD 803 FT

NOT TO BE FILLED IN BY DRILLER HEALTH DEPARTMENT APPROVAL
HOWARD COUNTY NAME
A34449 COUNTY NO.
OEP SIGNATURE Frank Shuman
DATE ISSUED 6/30/85
NORTH GRID 484000 EAST GRID 0832000

SHOW MAJOR FEATURES OF BOX & LOCATE WELL WITH AN X
SOURCES OF DRILLING WATER
1. 1/16/85
2. Well grouted before I arrived
3. at 3:30 P.M.
WRITE THE BOX NUMBER FROM THE MAP HERE
830 E 832
480 N 484

DRAW A SKETCH BELOW SHOWING LOCATION OF WELL IN RELATION TO NEARBY TOWNS AND ROADS AND GIVE DISTANCE FROM WELL TO NEAREST ROAD JUNCTION
Sketch showing location of well relative to Old Columbia Rd, Gorman Rd, U.S. 29, and Johns Hopkins Rd.

1/8/85
New well site to
be close to old well in pit
but must be at least 10 ft away
from existing well (to be abandoned & sealed)
Well site OK.
F.S.

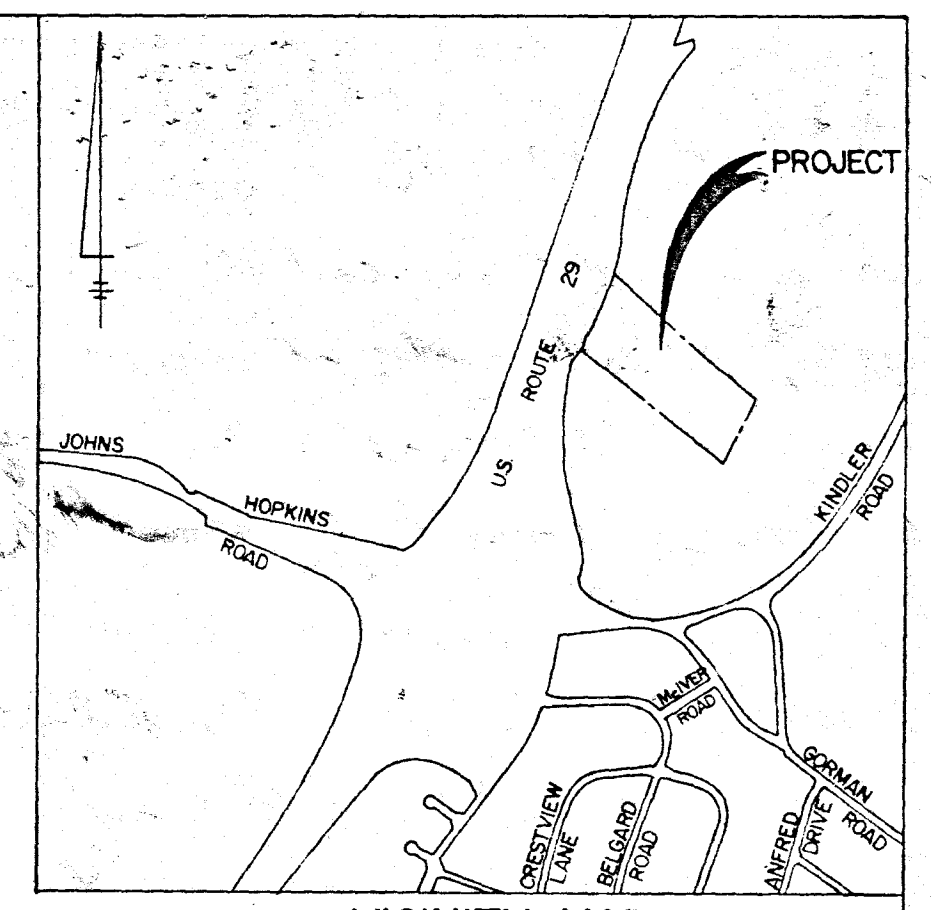
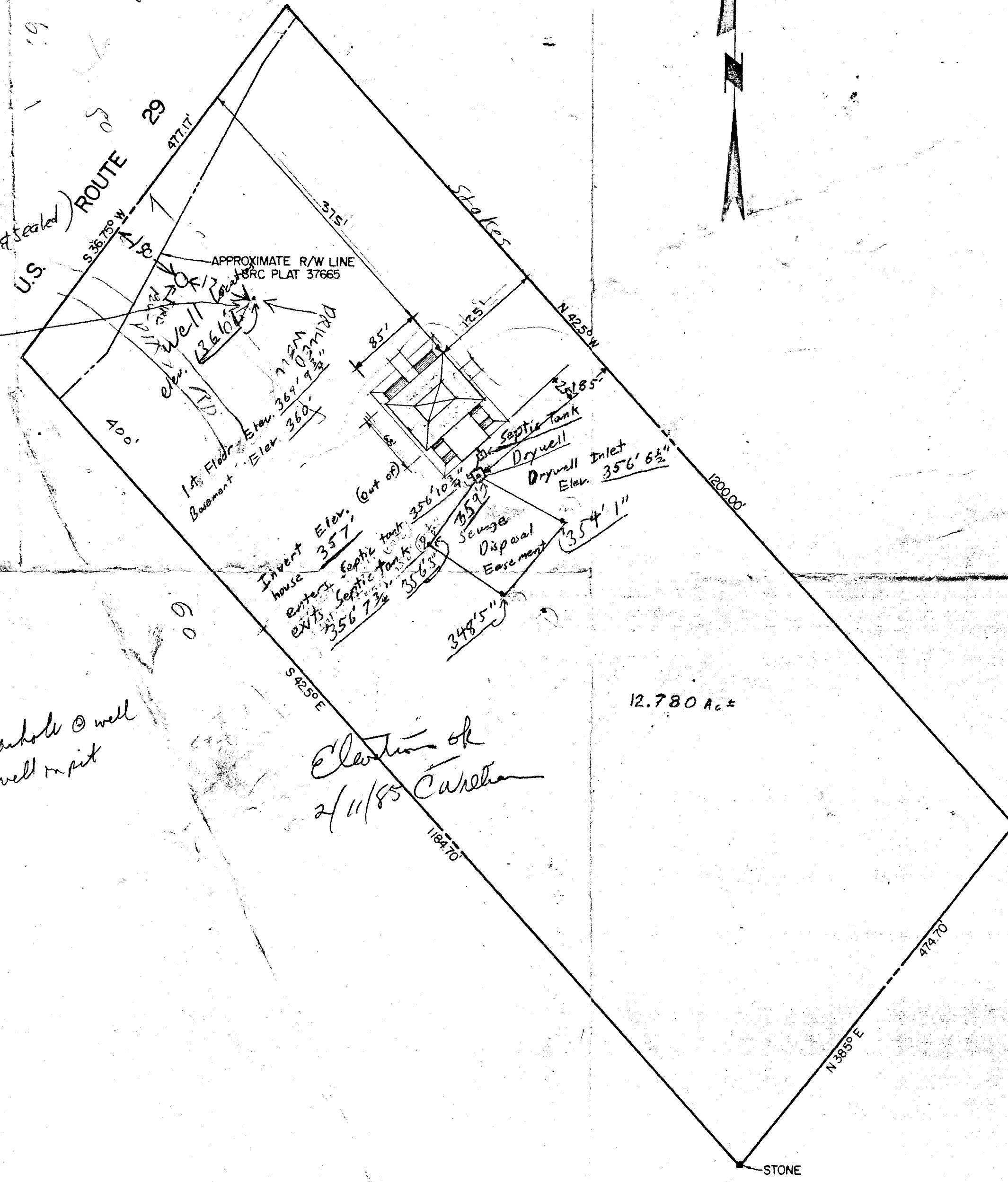

VICINITY MAP
SCALE: 1"=1200'

FISHER, COLLINS AND CARTER, INC.
CONSULTING ENGINEERS AND LAND SURVEYORS
8388 COURT AVENUE
ELLCOTT CITY, MARYLAND 21043
TELEPHONE: (301) 461-2855

PLAT FROM DEEDS
PROPERTY OF
GEOFFREY J. NEEDHAM
SIXTH ELECTION DISTRICT
HOWARD COUNTY, MARYLAND

TAX MAP 41
SCALE: 1"=100'
PARCEL 6
JULY 17, 1984

240
92
37

10/26/94

- ① Well - old Muller well found in small pit located 70 ft from edge of dirt road and 125 ft from the fire plug going toward back of lot. The well needs ① puller adapter ② extended well casing ③ Well Cap ④ Probably grout

- ② Per holes - Per holes on plat are OK. Plans should show distance from house to tank & tank to dry well. Also a short trench must be shown running off the dry well.

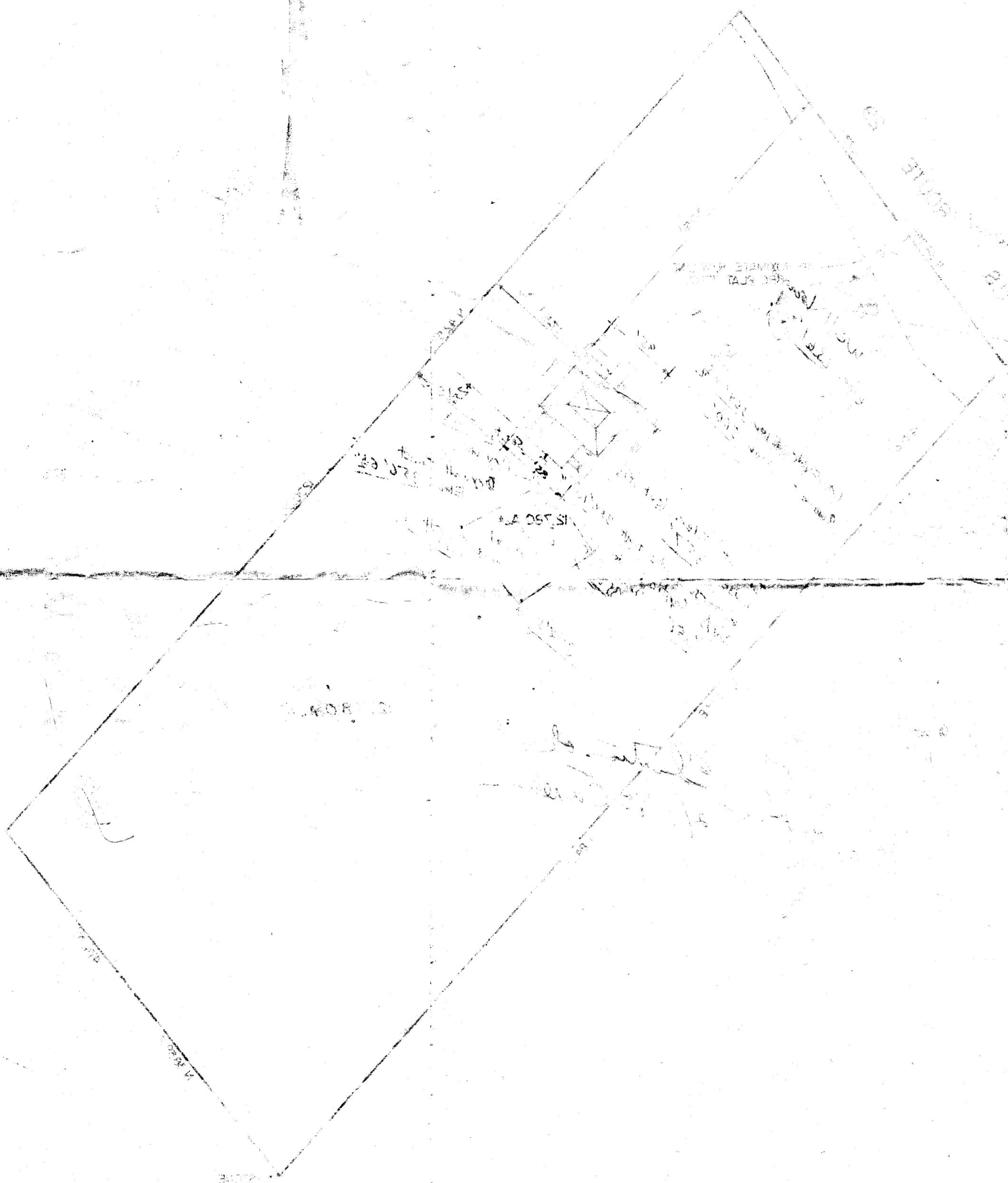

W.A. O'S BROWN
957-4119

HOWARD COUNTY, MARYLAND
SIXTH ELECTION DISTRICT
GEOFFREY J. WHELAN

RISHER, COLLINS AND CARTER, INC.
ENGINEERS AND ARCHITECTS
1000 W. BROADWAY
SUIT 1000
BALTIMORE, MARYLAND 21201

has done & sealed

U.S. ROUTE 29

477.17'

S 36.75° W

400'

Well Point
elev. 1361.0

APPROXIMATE R/W LINE
BRC PLAT 57665

1st Floor Elev. 364' 9 3/4"
Basement Elev. 360'

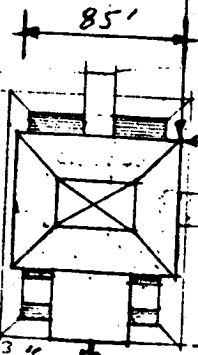

Invert Elev. (out of house) 357'

enters Septic tank 356' 10 3/4"
exits Septic tank 356' 7 3/4"

Septic Tank
Drywell

356' 3"
Sewer Disposal Easement

Drywell Inlet Elev. 356' 6 1/2"
354' 1"

348' 5"

S 42.5° E

N 42.5° W

1200.00'

Collection of Currier
2/11/85

1184.70'

12.780 A.C.

474.70'

N 38.5° E

STONE