

7/23/84 around noon please

APPROVED
7/23/84 RH

P 34127

A Repair

PERMIT

SEWAGE DISPOSAL SYSTEM

MARYLAND STATE DEPARTMENT OF HEALTH

ELLICOTT CITY

HOWARD COUNTY
BUREAU OF ENVIRONMENTAL HEALTH
992-2330

DISTRICT 4th

INDEXED
03-240077

DATE 7/23/84

Jack Fyock IS PERMITTED TO INSTALL _____ ALTER X

ADDRESS 13775 Triadelphia Road, Glenelg, Md. 21737 PHONE 988-9270

SUBDIVISION _____ ROAD 3300 Roscommon Drive LOT _____

PROPERTY OWNER ~~Mr. Paul D. Tapora~~ ALEXANDER ROSS

ADDRESS 3300 Roscommon Drive, Glenelg, Md. 21737 Phone: 489-4064

IF GARBAGE GRINDER IS USED INCREASE SEPTIC TANK CAPACITY BY 50% AND ABSORPTION AREA BY 22%.

GARBAGE GRINDER? YES _____ NO _____

SEPTIC TANK CAPACITY _____ GALLONS NUMBER OF BEDROOMS _____

REPAIR - Call for an appointment when ground is opened up and Sanitarian will

recommend the repair system.

7/23/84 DEEP DITCH 11 FT DEEP 75 FT
LONG 2 FT WIDE, 7 FT STONE
BUND OFF OLD DRY WELL
PARALLEL TO CASTLE BAR DRIVE
RH

PLANS APPROVED BY Frank A. Skinner DATE 7/23/84

COVER NO WORK UNTIL INSPECTED AND APPROVED.

NEITHER THE HOWARD COUNTY COUNCIL NOR THE HEALTH DEPARTMENT IS RESPONSIBLE FOR THE SUCCESSFUL OPERATION OF ANY SYSTEM.

NOTE: IF TRENCH IS USED CALL FOR INSPECTION BEFORE AND AFTER PLACING GRAVEL IN TRENCH.

NOTE: NO DRY WELL SHALL EXCEED 15 FOOT IN DIAMETER. NO ABSORPTION TRENCH TO EXCEED 100 FEET IN LENGTH.

NOTE: ALL PIPE FROM HOUSE TO SEPTIC TANK MUST BE CAST IRON OR SCHEDULE 40 PVC OR ABS.

PERMIT VOID AFTER THREE YEARS.

NOTE: INSTALL STAND PIPE ON SEPTIC TANK AND DRY WELL. STAND PIPES MUST BE 6 INCHES IN DIAMETER. CAST IRON, CONCRETE OR TERRA COTTA, OR PVC OR ABS ACCEPTED. IF TOP OF SEPTIC TANK IS DEEPER THAN 3 FEET MANHOLE TO GRADE REQUIRED.

***INSTALLER IS RESPONSIBLE FOR OBTAINING FINAL APROVAL ON THIS PERMIT**

*CALL 992-2330 FOR INSPECTION OF SEPTIC SYSTEMS.

EH - 2-1082

P
34127
1200012

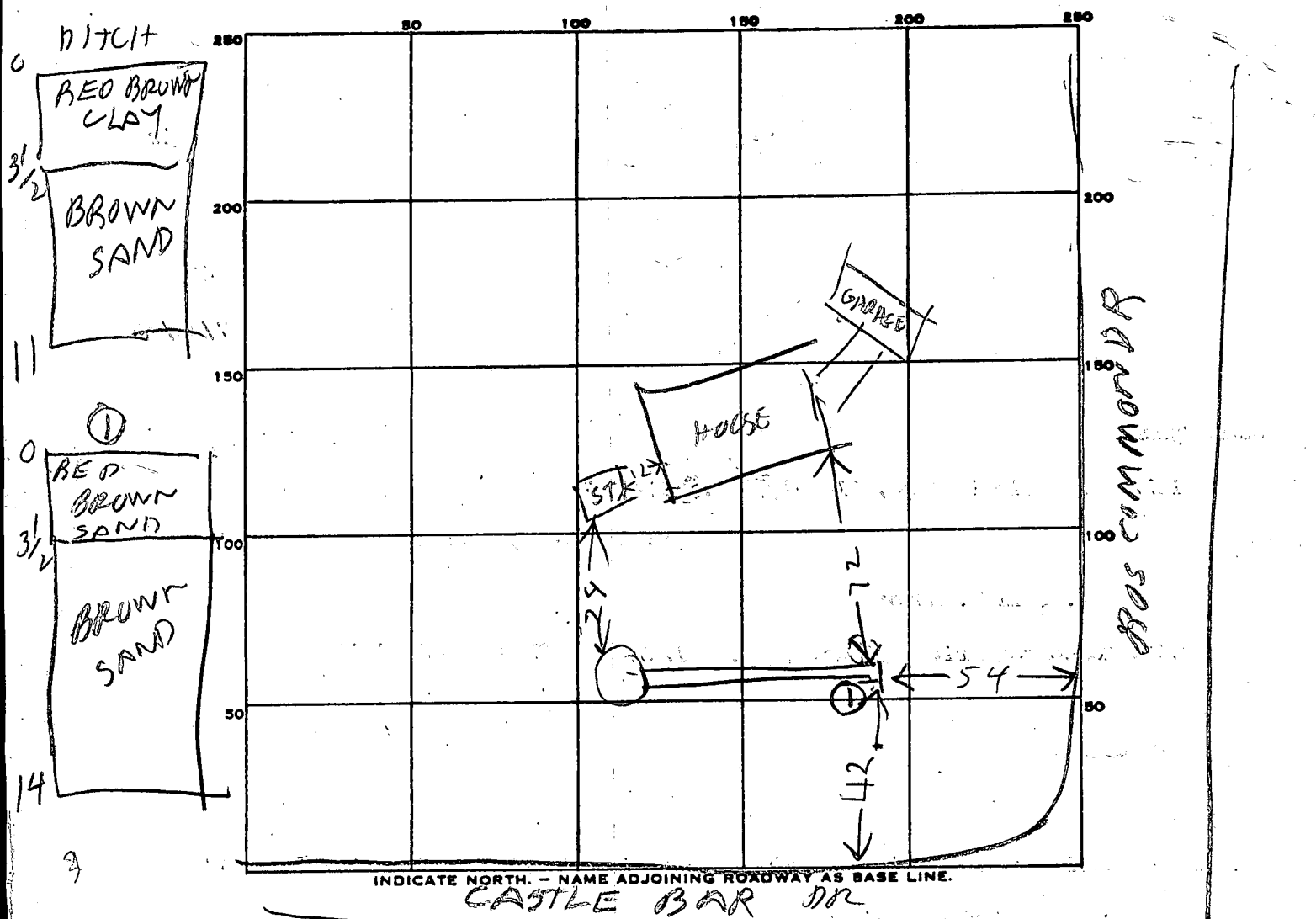

PERMIT CARD _____

SEPTIC TANK, LEVEL _____ CLEANOUTS _____

DISTRIBUTION BOX, LEVEL _____

TILE FIELD, DEPTH 11 FT. TRENCH WIDTH 2 FT.

GRAVEL DEPTH 7 FT IN. TOTAL LENGTH 75 FT.

NUMBER OF TRENCHES 1 TOTAL BOTTOM AREA 525

SEEPAGE PITS, INSIDE DIAMETER _____ FT. DEPTH BELOW INLET _____ FT.

REMARKS 7/23/84 - 1200⁰⁰ DITCH DUG 11 FT DEEP. LOOKS OK Water
Well on back per sketch. OK TO ADD STONE
TO DITCH. BH
7/23/84 - STONE ADD TO DITCH

DATE SYSTEM APPROVED 7/23/84 INSPECTOR Raymond Hodger