

4/12/85  
11:10 AM

4-11-85  
approved  
S. Abel

# PERMIT

P 35251

A REPAIR

SEWAGE DISPOSAL SYSTEM

MARYLAND STATE DEPARTMENT OF HEALTH\*

HOWARD COUNTY  
BUREAU OF ENVIRONMENTAL HEALTH  
992-2330

02-252902

ELLICOTT CITY

DISTRICT \_\_\_\_\_

INDEXED

DATE 4/08/85

Jenkins Bowers IS PERMITTED TO INSTALL \_\_\_\_\_ ALTER X

ADDRESS Route 144, Ellicott City, Maryland 21043 PHONE 465-6646

SUBDIVISION \_\_\_\_\_ ROAD 9321 Route 99 LOT \_\_\_\_\_

PROPERTY OWNER Warren R. Wilson PHONE: 465-9228

ADDRESS 9321 Route 99  
Ellicott City, Maryland 21043

IF GARBAGE GRINDER IS USED INCREASE SEPTIC TANK CAPACITY BY 50% AND ABSORPTION AREA BY 22%.

GARBAGE GRINDER? YES \_\_\_\_\_ NO \_\_\_\_\_

SEPTIC TANK CAPACITY \_\_\_\_\_ GALLONS NUMBER OF BEDROOMS \_\_\_\_\_

**REPAIR - REPLACE METAL SEPTIC TANK WITH A 1000 GAL CONCRETE TANK.**

PLANS APPROVED BY Craig Williams DATE 4/08/85

COVER NO WORK UNTIL INSPECTED AND APPROVED.

NEITHER THE HOWARD COUNTY COUNCIL NOR THE HEALTH DEPARTMENT IS RESPONSIBLE FOR THE SUCCESSFUL OPERATION OF ANY SYSTEM.

NOTE: IF TRENCH IS USED CALL FOR INSPECTION BEFORE AND AFTER PLACING GRAVEL IN TRENCH.

NOTE: NO DRY WELL SHALL EXCEED 15 FOOT IN DIAMETER. NO ABSORPTION TRENCH TO EXCEED 100 FEET IN LENGTH.

NOTE: ALL PIPE FROM HOUSE TO SEPTIC TANK MUST BE CAST IRON OR SCHEDULE 40 PVC OR ABS.

PERMIT VOID AFTER THREE YEARS.

NOTE: INSTALL STAND PIPE ON SEPTIC TANK AND DRY WELL. STAND PIPES MUST BE 6 INCHES IN DIAMETER. CAST IRON, CONCRETE OR TERRA COTTA, OR PVC OR ABS ACCEPTED. IF TOP OF SEPTIC TANK IS DEEPER THAN 3 FEET MANHOLE TO GRADE REQUIRED.

**\*INSTALLER IS RESPONSIBLE FOR OBTAINING FINAL APPROVAL ON THIS PERMIT**

\*CALL 992-2330 FOR INSPECTION OF SEPTIC SYSTEMS.

EH - 2-1082

P 35251

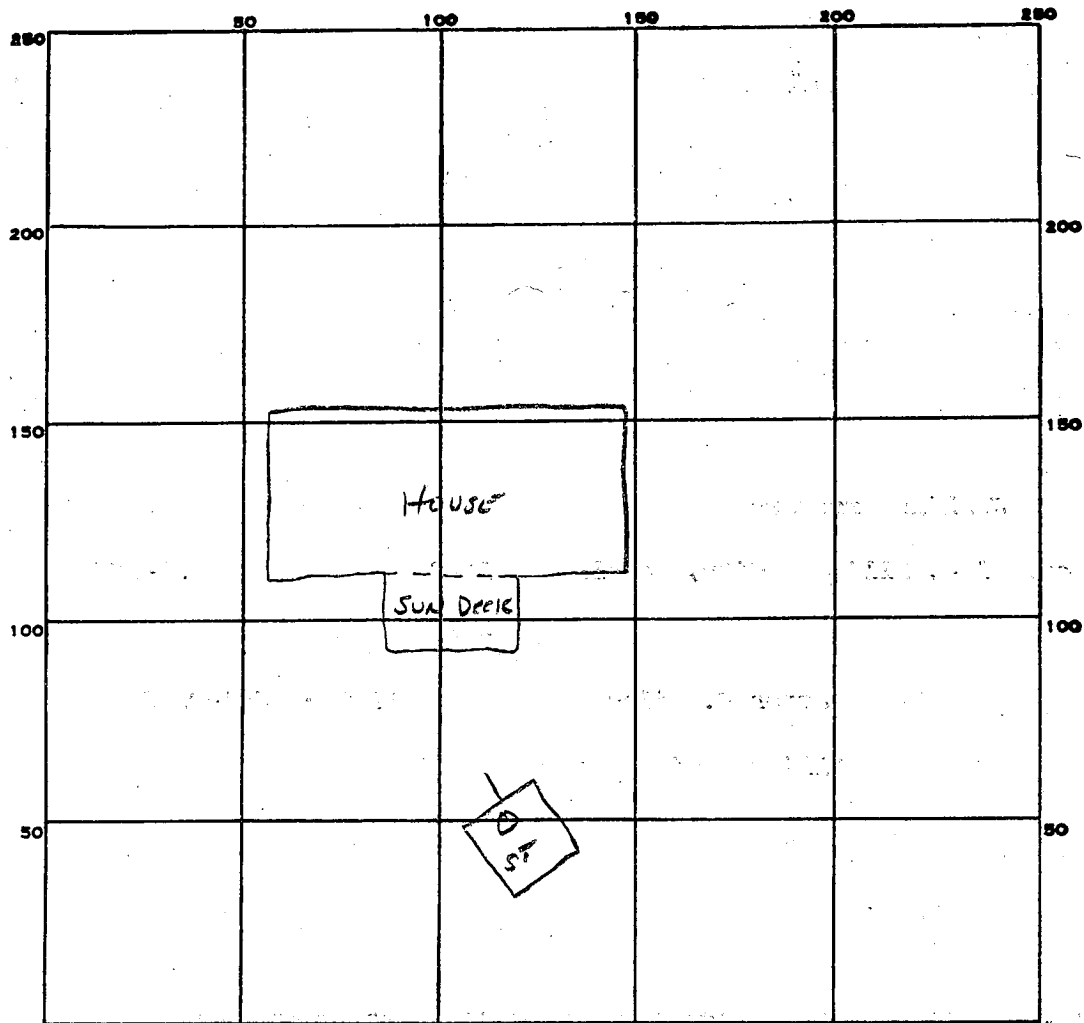

INDICATE NORTH. - NAME ADJOINING ROADWAY AS BASE LINE.

RE 99 ROGERS AVE

PERMIT CARD

SEPTIC TANK, LEVEL 1000 GAL

CLEANOUTS  ST

DISTRIBUTION BOX, LEVEL \_\_\_\_\_

TILE FIELD, DEPTH \_\_\_\_\_ FT. TRENCH WIDTH \_\_\_\_\_ FT.

GRAVEL DEPTH \_\_\_\_\_ IN. TOTAL LENGTH \_\_\_\_\_ FT.

NUMBER OF TRENCHES \_\_\_\_\_ TOTAL BOTTOM AREA \_\_\_\_\_

SEEPAGE PITS, INSIDE DIAMETER \_\_\_\_\_ FT. DEPTH BELOW INLET \_\_\_\_\_ FT.

ABSORBENT AREA \_\_\_\_\_ SQ. FT.

REMARKS 4-12-85 SEPTIC TANK 1000 GAL LEVEL CEMENT INLET + OUTLET

CAST IRON PIPES NO LEAKING. S. ABEL

DATE SYSTEM APPROVED 4-12-85

INSPECTOR S. ABEL