

3/26/85  
ASAP

APPROVED  
3/27/85  
RHODES  
P. 35179

# PERMIT

SEWAGE DISPOSAL SYSTEM

MARYLAND STATE DEPARTMENT OF HEALTH

A REPAIR

Purpose of repair  
to be failed  
system

HOWARD COUNTY  
BUREAU OF ENVIRONMENTAL HEALTH  
992-2330

ELLICOTT CITY  
DISTRICT \_\_\_\_\_  
DATE 3/26/85

INDEXED

Jack Fuock \_\_\_\_\_ IS PERMITTED TO INSTALL \_\_\_\_\_ ALTER X

ADDRESS \_\_\_\_\_ PHONE 9889270

SUBDIVISION \_\_\_\_\_ ROAD 11660 Route 108 LOT \_\_\_\_\_

PROPERTY OWNER Ms. Betty Hynbal PHONE: 531-2611  
11660 Route 108

ADDRESS \_\_\_\_\_

IF GARBAGE GRINDER IS USED INCREASE SEPTIC TANK CAPACITY BY 50% AND ABSORPTION AREA BY 22%.

GARBAGE GRINDER? YES \_\_\_\_\_ NO

SEPTIC TANK CAPACITY 1,000 GALLONS NUMBER OF BEDROOMS 2

REPAIR - CALL FOR INSPECTION WHEN GROUND IS OPENED UP SO SANITARIAN CAN RECOMMEND REPAIR.

3/MAR 85 - 108 PAST HONGBWOOD, CROSS BRIDGE-TURN RIGHT IMMEDIATELY BEAR RIGHT TO TOWER  
60 X 6 X 5 FT DEEP TRENCH  
2 FT STONE  
PLACE TRENCH ABOUT 75 TO  
175 FT FROM THE LEFT SIDE OF THE  
HOUSE AS SEEN WHEN FACING THE

PLANS APPROVED BY Craig Williams DATE 3/26/85

COVER NO WORK UNTIL INSPECTED AND APPROVED. HOUSE FROM THE DRIVEWAY

NEITHER THE HOWARD COUNTY COUNCIL NOR THE HEALTH DEPARTMENT IS RESPONSIBLE FOR THE SUCCESSFUL OPERATION OF ANY SYSTEM.

- NOTE: IF TRENCH IS USED CALL FOR INSPECTION BEFORE AND AFTER PLACING GRAVEL IN TRENCH.
- NOTE: NO DRY WELL SHALL EXCEED 15 FOOT IN DIAMETER. NO ABSORPTION TRENCH TO EXCEED 100 FEET IN LENGTH.
- NOTE: ALL PIPE FROM HOUSE TO SEPTIC TANK MUST BE CAST IRON OR SCHEDULE 40 PVC OR ABS.
- PERMIT VOID AFTER THREE YEARS.
- NOTE: INSTALL STAND PIPE ON SEPTIC TANK AND DRY WELL. STAND PIPES MUST BE 6 INCHES IN DIAMETER. CAST IRON, CONCRETE OR TERRA COTTA, OR PVC OR ABS ACCEPTED. IF TOP OF SEPTIC TANK IS DEEPER THAN 3 FEET MANHOLE TO GRADE REQUIRED.

\*INSTALLER IS RESPONSIBLE FOR OBTAINING FINAL APROVAL ON THIS PERMIT

\*CALL 992-2330 FOR INSPECTION OF SEPTIC SYSTEMS.

A 35179

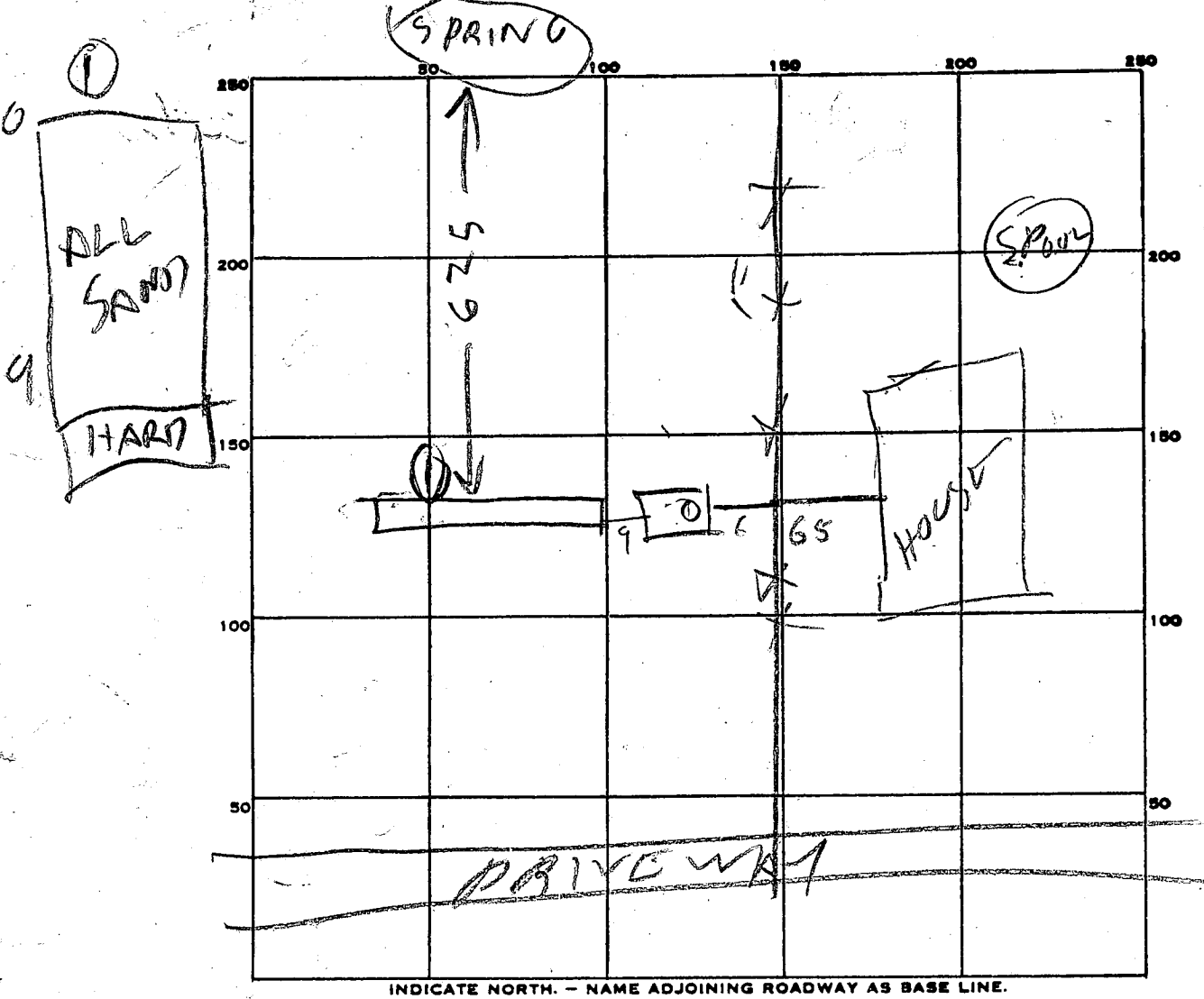

PERMIT CARD \_\_\_\_\_

SEPTIC TANK, LEVEL 1000 cone CLEANOUTS OK  
 Old steel removed & filled  
 DISTRIBUTION BOX, LEVEL \_\_\_\_\_

TILE FIELD, DEPTH 5 FT. TRENCH WIDTH 6.3 FT.

GRAVEL DEPTH 3 FT IN. TOTAL LENGTH 61 FT.

NUMBER OF TRENCHES \_\_\_\_\_ TOTAL BOTTOM AREA \_\_\_\_\_

SEEPAGE PITS, INSIDE DIAMETER \_\_\_\_\_ FT. DEPTH BELOW INLET \_\_\_\_\_ FT.

ABSORBENT AREA \_\_\_\_\_ SQ. FT.

REMARKS 26 MAR 85 AM - ADD STONE TO TRENCH + RH  
26 MAR 85 - PM - STONE ADDED RH

DATE SYSTEM APPROVED 26 MAR 85 INSPECTOR Raymond Hodges