

11/14/88/AM

05-399246

File

PERMIT

P 42853

SEWAGE DISPOSAL SYSTEM

A 35646

MARYLAND STATE DEPARTMENT OF HEALTH DISTRICT _____

HOWARD COUNTY
BUREAU OF ENVIRONMENTAL HEALTH
461-9933

INDEXED

DATE 10/20/88

DATE SYSTEM APPROVED 11/14/88

INSPECTOR C.B.W.

Dale Fogle Septic Service

IS PERMITTED TO INSTALL ALTER _____

ADDRESS 6430 Woodbine Road, Woodbine, Maryland 21797 PHONE 795-5670

SUBDIVISION Dayton Meadows ROAD 4856 Green Bridge Rd LOT 1, Sec.1, Area II

PROPERTY OWNER Barry Feage Mark Bailey

ADDRESS _____

IF GARBAGE GRINDER IS USED INCREASE SEPTIC TANK CAPACITY BY 50% AND ABSORPTION AREA BY 22%.

GARBAGE GRINDER? YES _____ NO

SEPTIC TANK CAPACITY 1250 GALLONS NUMBER OF BEDROOMS 4

TRENCHES - 180 sq. ft. per bedroom. Trench to be 3 feet wide. Inlet 3 1/2 feet below original grade. Bottom maximum depth 5 1/2 feet below original grade. Effective area begins at 3 1/2 feet below original grade. 2 feet of stone below distribution pipe.

LOCATION - Beginning from the left front lot corner, place 1st trench 170 feet down the left (455.00') lot line and 40 feet off the left lot line as seen when facing the property from Greenbridge Road. Run trenches along contour towards the left (457' and rear (528.00') lot lines.

NOTE - No trench to exceed 100 feet in length. Provide 6" -8" diameter cleanout and cap to grade or above on septic tank. d/cw

PLANS APPROVED BY Bert Nixon DATE 5/25/87

COVER NO WORK UNTIL INSPECTED AND APPROVED

NEITHER THE HOWARD COUNTY COUNCIL NOR THE HEALTH DEPARTMENT IS RESPONSIBLE FOR THE SUCCESSFUL OPERATION OF ANY SYSTEM

NOTE: CLEANOUT REQUIRED EVERY 70 FEET OF SEWER LINE AND/OR AT 90° SWEEPS IN LINES FROM HOUSE TO DRAIN FIELDS

NOTE: ALL PARTS OF SEPTIC SYSTEMS (I.E. TANK, DISTRIBUTION BOX, TRENCHES) TO BE 100 FEET FROM WELL (UNLESS OTHERWISE SPECIFICALLY AUTHORIZED)

NOTE: IF DEEP TRENCH(ES) ARE USED CALL FOR INSPECTION BEFORE AND AFTER PLACING GRAVEL IN TRENCH(ES)

NOTE: NO DRY WELL SHALL EXCEED 15 FOOT IN DIAMETER NO ABSORPTION TRENCH TO EXCEED 100 FEET IN LENGTH.

NOTE: ALL PIPE FROM HOUSE TO SEPTIC TANK MUST BE CAST IRON OR SCHEDULE 40 PVC OR ABS

PERMIT VOID AFTER TWO YEARS

NOTE: INSTALL STAND PIPE ON SEPTIC TANK AND DRY WELL. STAND PIPES MUST BE 6 INCHES IN DIAMETER. CAST IRON, CONCRETE OR TERRA COTTA OR PVC OR ABS ACCEPTED. IF TOP OF SEPTIC TANK IS DEEPER THAN 3 FEET, MANHOLE TO GRADE REQUIRED

NOTE: DISTRIBUTION BOXES MUST HAVE BAFFLES

***INSTALLER IS RESPONSIBLE FOR OBTAINING FINAL APROVAL ON THIS PERMIT**

*CALL 461-9933 FOR INSPECTION OF SEPTIC SYSTEMS.

A 35646

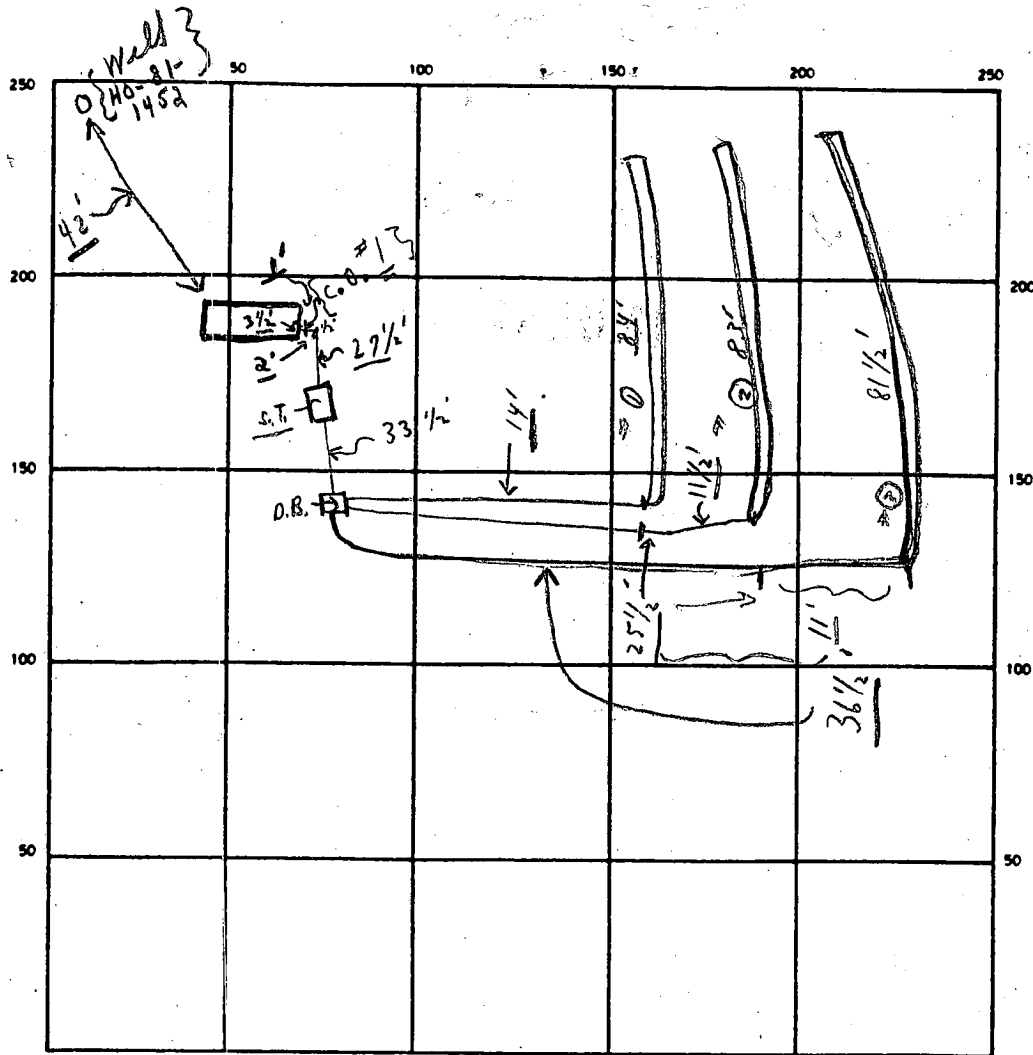

INDICATE NORTH - NAME ADJOINING ROADWAY AS BASE LINE

GREEN BRIDGE ROAD

c.o. #1 | S.T.

SEPTIC TANK LEVEL OK CLEANOUTS OK | OK

DISTRIBUTION BOX LEVEL OK (Baffle and)

DRAIN FIELD/TILE FIELD DEPTH 5 1/2 FT. TRENCH WIDTH 3 FT. INLET DEPTH 3 1/2 FT.

EFFECTIVE GRAVEL DEPTH 2 1/2 FT. TOTAL LENGTH $\frac{\textcircled{1}}{84'}$ } FT 24 8 1/2
 $\frac{\textcircled{2}}{83'}$ }
 $\frac{\textcircled{3}}{81 1/2'}$ }

NUMBER OF TRENCHES 3 ONE SIDEWALL/BOTTOM AREA 745 1/2 + SQ. FT.

DRYWELL INSIDE DIAMETER — FT EFFECTIVE DEPTH BELOW INLET — FT.

ABSORBENT AREA 745 SQ. FT.

REMARKS 11/14/88 Finished - oh to cover all work. Files
11/14/88 ticks left at S.T. cleanout. c. 88.

DATE SYSTEM APPROVED 11/14/88 INSPECTOR Charles Bryan Stecker

5/25/84

1-
A 35646 ✓

SUBDIVISION:

DAYTON MEADOW
SEC 1
GREENBRIDGE ROAD
DRY WELL OR DRY WELL AND TRENCH

LOT NUMBER: 1 AREA II

_____ sq. ft./bedroom

	Septic Tank	Minimum Total Square Feet
3 bedroom	1000 gallon	_____
4 bedroom	1250 gallon	_____
5 bedroom	1500 gallon	_____

Inlet _____ feet below original grade.
Bottom maximum depth _____ feet below original grade.
Effective area begins at _____ feet below original grade.

NOTE: If trench is used to make up absorbent area, run the trench on level ground and leave a 5-foot earth buffer between dry well and trench. No trench is to exceed 100 feet in length. Trench inlet to be same as dry well, with _____ feet of stone below distribution pipe.

TRENCHES

180 sq. ft./bedroom

Trench to be 3 wide.
Inlet 3 1/2 feet below original grade.
Bottom maximum depth 5 1/2 feet below original grade.
Effective area begins at 3 1/2 feet below original grade.
2 feet of stone below distribution pipe.

4BR/BD

- NOTE:
- (1) No trench to exceed 100 feet in length.
 - (2) If more than one trench used, a distribution box is required.
 - (3) Trenches to be installed on level ground.
 - (4) Call for inspection of trench before gravel is installed.
 - (5) Provide 6" - 8" diameter cleanout and cap to grade or above on septic tank and drywell.
 - (6) If a garbage disposal is used, increase septic tank capacity by 50% and increase absorbent sidewall area by 22%.

LOCATION: BEGINNING FROM THE LEFT FRONT LOT CORNER
PLACE 1ST TRENCH 170' DOWN THE LEFT (455.00') LOT
LINE AND 40' OFF THE LEFT LOT LINE AS SEEN WHEN
FACING THE PROPERTY FROM GREENBRIDGE RD. RUN
TRENCHES ALONG CONTOUR TOWARDS THE RIGHT (457.00')
AND REAR (528.00') LOT LINES.

APPLICATION

SEWAGE DISPOSAL TESTING

A 35646

P _____

STATE OF MARYLAND - DEPARTMENT OF HEALTH AND MENTAL HYGIENE

HOWARD COUNTY HEALTH DEPARTMENT
ENVIRONMENTAL HEALTH SERVICES

DISTRICT _____

P. O. BOX 476 ELLICOTT CITY, MARYLAND 21043
TELEPHONE: 992-2330

DATE 6/18/85

TO: THE COUNTY HEALTH OFFICER
ELLICOTT CITY, MARYLAND

I. HEREBY, APPLY FOR THE NECESSARY TEST IN ORDER TO CONSTRUCT (OR RECONSTRUCT) A SEWAGE DISPOSAL SYSTEM.

PROPERTY OWNER CARMAN Associates MARK Bailey

ADDRESS Box 122, Ellicott City Md PHONE 301 854-0498

PROPERTY LOCATION: see I AREA II

SUBDIVISION Dayton Meadows LOT NO. ONE (1)

ROAD AND DESCRIPTION 4856 Greenbridge Rd, Dayton, Md.

SIZE OF LOT 3 AC. + TYPE BLDG. Three
(NUMBER OF BEDROOMS)

THE SYSTEM INSTALLED UNDER THIS APPLICATION IS ACCEPTABLE ONLY UNTIL PUBLIC FACILITIES BECOME AVAILABLE. I FULLY UNDERSTAND THE FEE CONNECTED WITH THE FILING OF THIS PERC TEST APPLICATION IS NON-REFUNDABLE UNDER ANY CIRCUMSTANCES. I ALSO AGREE TO COMPLY WITH ALL M.O.S.H.A. REQUIREMENTS IN TESTING THIS LOT.

[Signature]
(SIGNATURE OF APPLICANT)

APPROVED BY Sid Abel FOR Shallow Dept DATE 6-6-88

REJECTED BY _____ FOR _____ DATE _____

HOLD PENDING FURTHER TESTS _____ DATE _____

REASONS FOR REJECTION OR HOLDING 7-16-85 perc. Results Satisfactory, Hold for Certified Subdivision Plat 8A

BLDG. PERMIT SIGNED
AND RETURNED 6-6-88

BP18521
Sch

THIS IS NOT A PERMIT

① ②
SOIL PROFILE

6" A-3
RED BROWN
CLAY LOAM
CL 10%
SAPROLITE

RED BROWN
SAND LOAM
CL 10%
SAPROLITE

10" Δ#2

10" Δ#1

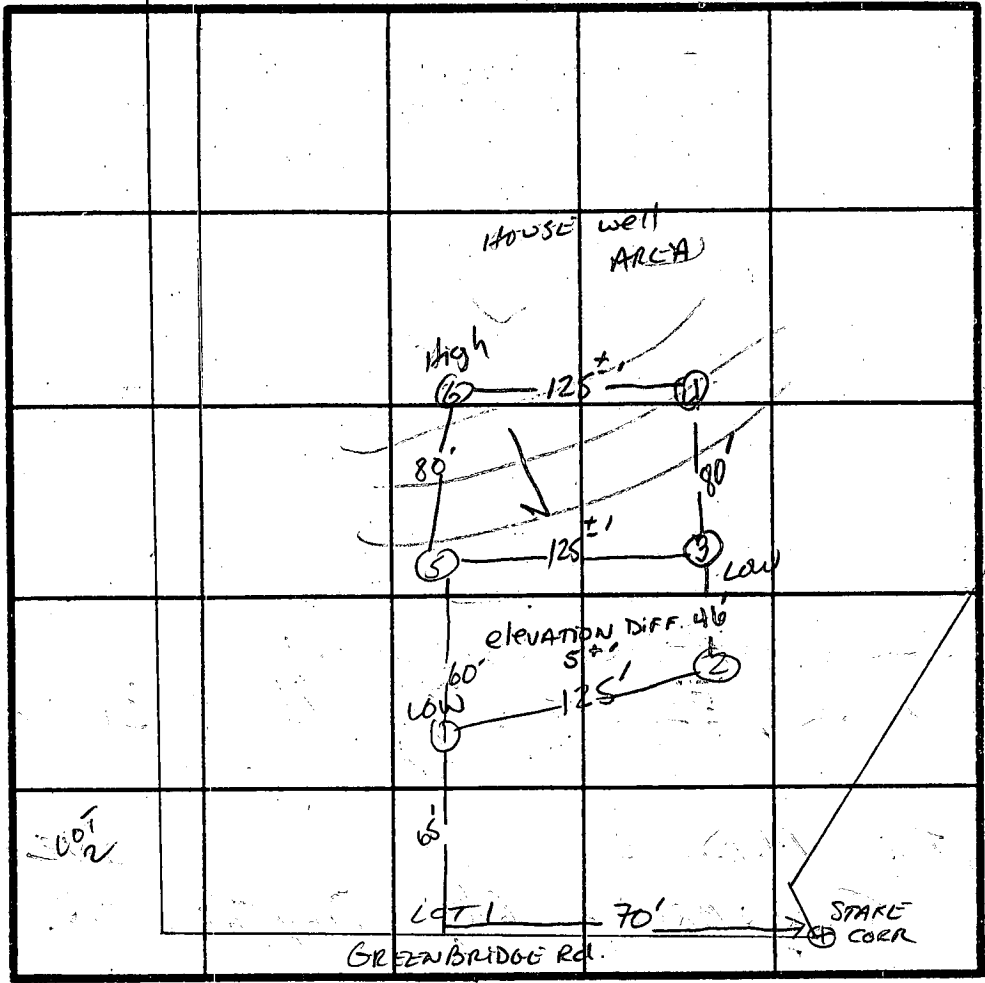

INDICATE NORTH - NAME ADJOINING ROADWAY AS BASE LINE.

③ ④ ⑤ ⑥

6" A-3/AP

YELLOW BROWN
SANDY CLAY
LOAM CL 10%
SAPROLITE

3.5" YELLOW BROWN
MICAPOUS
SAND SILT
LOAM CL 10%
SAPROLITE

12"

DATE	TEST NO.	DEPTH	PRE-WET		TEST - 1" DROP		TIME
			START	STOP	START	STOP	
7/15/85	1 V	13'	WATER AT 11"		SOIL SLIGHTLY MOIST		
	2 V		WATER AT 10 FE				
	3 V	4"	3:09	3:10	3:10	3:14	4min
	4 V	12"	see profile				
	5 V	4"	3:08	3:09	3:09	3:11	2min
	6 V	12"	see profile				
7/16/85	5 V	4"	10:09	10:10	10:10	10:11	1min
	6 V	12"	see profile				
	7 V	4"	10:12	10:13	10:13	10:16	3min
	8 V	13'	see profile				

REMARKS _____

TYPE OF SOIL Glenelg - MAJOR

TESTED BY Sfabel

ALSO PRESENT Phil Manglitz
C. Crossil

EH-12-1079

Bailey House

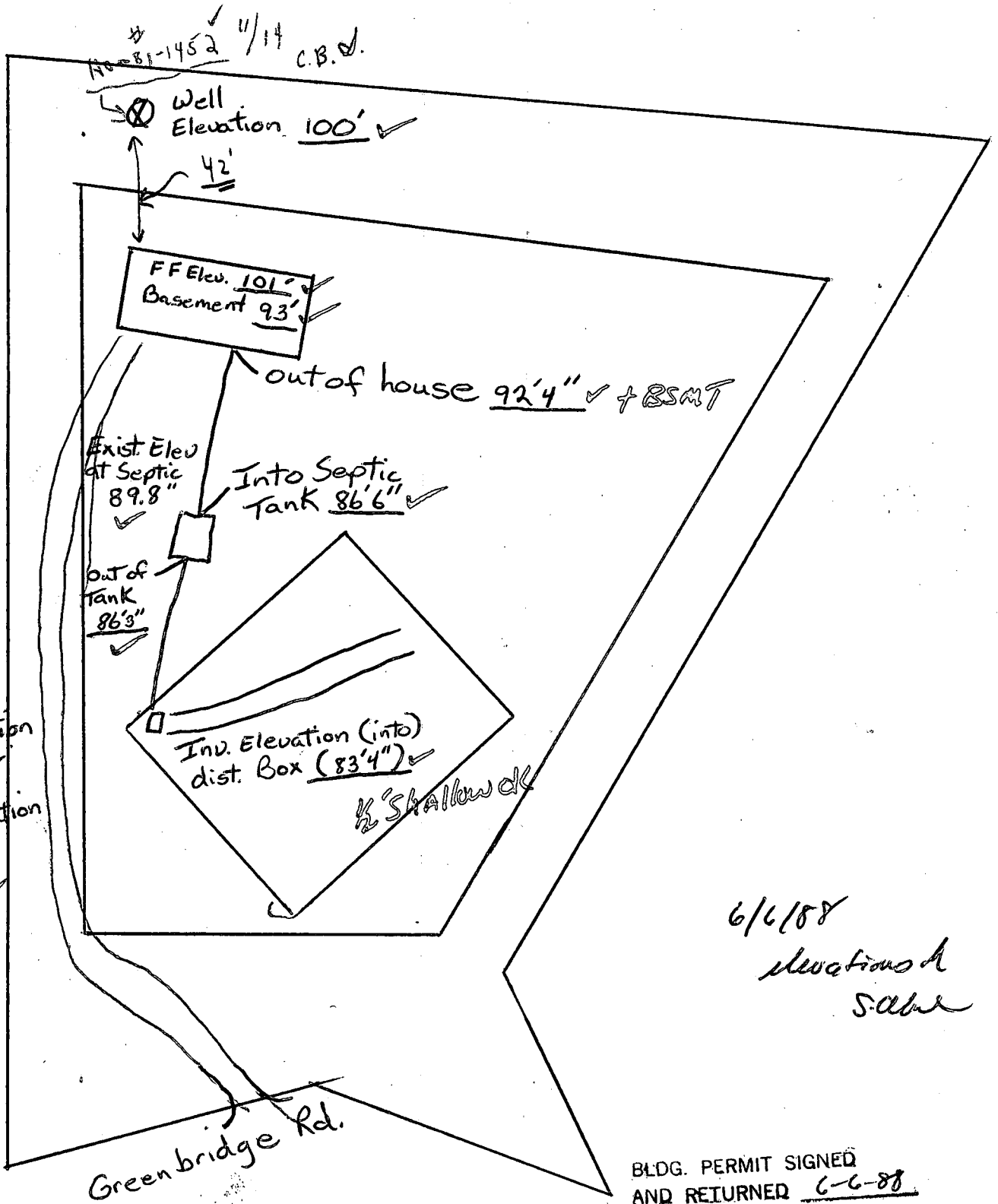

6/6/88
elevations A
SAB

BLDG. PERMIT SIGNED
AND RETURNED 6-6-88

BP185U
SAB

4 Bed rooms

Barry P. Feaga

B 7 8286

SEQUENCE NO. (OEP USE ONLY)

STATE OF MARYLAND PERMIT TO DRILL WELL

please print or type

OEP PERMIT NUMBER

40-81-1452

fill in this form completely

(THIS NUMBER IS TO BE PUNCHED IN COLS. 3-6 ON ALL CARDS)

Date Received

Empty date grid

OWNER INFORMATION

JARMAN ASSOCIATES

POX 122

ELKICOH CITY MD 21043

DRILLER INFORMATION

Joseph L. Mayde 238

Joseph L. Mayde - WKA Drilling

5512 Ridge RD. Mt. Airy 21771

Joseph P. Mayde 1/21/87

WELL INFORMATION

APPROX. PUMPING RATE (GAL. PER MIN.) 5

AVERAGE DAILY QUANTITY NEEDED (GAL. PER DAY) 500

USE FOR WATER (CIRCLE APPROPRIATE BOX)

- D HOME (SINGLE OR DOUBLE HOUSEHOLD UNIT ONLY)
F FARMING (LIVESTOCK WATERING & AGRICULTURAL IRRIGATION)
I INDUSTRIAL, COMMERCIAL, STATE AND FEDERAL GOV. OTHER (REQUIRES APPROPRIATION PERMIT)
P PUBLIC OR PRIVATE WATER COMPANY (REQUIRES APPROPRIATION PERMIT AND STATE HEALTH DEPARTMENT APPROVAL)
T TEST, OBSERVATION, MONITORING (MAY REQUIRE APPROPRIATION PERMIT)

APPROXIMATE DEPTH OF WELL 300 FEET

APPROXIMATE DIAMETER OF WELL 6 INCH

METHOD OF DRILLING (circle one)

- BORED (or Augered) JETTED Jetted & DRIVEN
AIR-ROTARY AIR-PERCussion ROTARY (Hydraulic Rotary)
CABLE REVERSE-ROTARY Drive-POINT
other

REPLACEMENT OR DEEPEMED WELLS (CIRCLE APPROPRIATE BOX)

- N THIS WELL WILL NOT REPLACE AN EXISTING WELL
Y THIS WELL WILL REPLACE A WELL THAT WILL BE ABANDONED AND SEALED
S THIS WELL WILL REPLACE A WELL THAT WILL BE USED AS A STANDBY
D THIS WELL WILL DEEPEM AN EXISTING WELL

PERMIT NUMBER OF WELL TO BE REPLACED OR DEEPEMED (IF AVAILABLE)

Not to be filled in by driller (OEP USE ONLY)

APPROP. PERMIT NUMBER GAP

FORCE INITIALS PERMIT No. 40-81-1452

SPECIAL CONDITIONS

REISSUE SAME TAG SAME PROPERTY

LOCATION OF WELL

HOWARD

DAYTON MEADOWS

SECTION 2 LOT I Area II

DAYTON

MILES FROM TOWN (enter 0 if in town) 0 MI

GREEN BRIDGE RD.

DIRECTION OF WELL FROM TOWN (CIRCLE BOX)

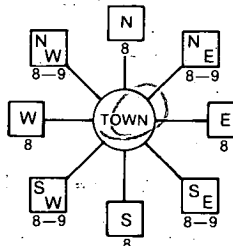

ON WHICH SIDE OF ROAD (CIRCLE APPROPRIATE BOX)



DISTANCE FROM ROAD 425 FT

NOT TO BE FILLED IN BY DRILLER HEALTH DEPARTMENT APPROVAL

HOWARD COUNTY NAME
A 35646 COUNTY NO.
DATE ISSUED 052587
CO SIGNATURE B. Nelson 11/25/87
NORTH GRID 511000 EAST GRID 0802000

SHOW MAJOR FEATURES OF BOX & LOCATE WELL WITH AN X

- SOURCES OF DRILLING WATER
1. Well
2.
3.

WRITE THE BOX NUMBER FROM THE MAP HERE

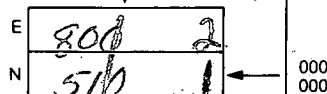

DRAW A SKETCH BELOW SHOWING LOCATION OF WELL IN RELATION TO NEARBY TOWNS AND ROADS AND GIVE DISTANCE FROM WELL TO NEAREST ROAD JUNCTION

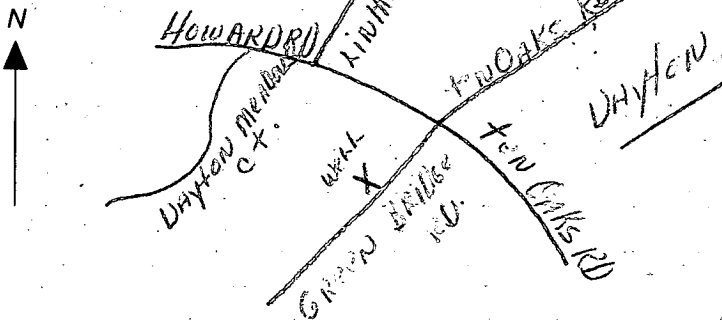

9/17/87

11:00 AM

- ① 67 F7 casing
- ② 53 ft open hole
- ③ Not sure of location but well stake seen
- ④ 14 BAGS
- ⑤ WELL OK

Well not Pump Tester B J Dodge

Today because pump not working very well. However the pump was working well enough to supply a nitrate sample & sample taken now.

7-8-87

McBride

HD-81-2168

7025 Brooks Rd

225' 2' above

6 bags

30 min → draw down

19 open

started at 7 am → 10 am

22 ft casing

Wtr level 71

12 gal max

9:30 71

6

10

10:00 71'

6 sec / 1 gal

10 gpm

C1 0385 SEQUENCE NO. (OEP USE ONLY)

STATE OF MARYLAND WELL COMPLETION REPORT

THIS REPORT MUST BE SUBMITTED WITHIN 45 DAYS AFTER WELL IS COMPLETED.

(THIS NUMBER IS TO BE PUNCHED IN COLS. 3-6 ON ALL CARDS)

COUNTY NUMBER A 35646

DATE RECEIVED

DATE WELL COMPLETED 070887

DEPTH OF WELL

PERMIT NO. FROM "PERMIT TO DRILL WELL" HQ-81-1452

OWNER ASSOCIATES CARMEN STREET OR RFD GREEN BRIDGE ROAD TOWN DAYTON SUBDIVISION DAYTON MEADOWS SECTION 1 LOT 1 AREA 2

WELL LOG

GROUTING RECORD

C 3

Not required for driven wells STATE THE KIND OF FORMATIONS PENETRATED, THEIR COLOR, DEPTH, THICKNESS AND IF WATER BEARING

WELL HAS BEEN GROUTED (Circle Appropriate Box) YES Y NO N TYPE OF GROUTING MATERIAL CEMENT CM BENTONITE CLAY BC

PUMPING TEST HOURS PUMPED (nearest hour) 3

Table with columns: DESCRIPTION (Use additional sheets if needed), FEET (FROM, TO), Check if water bearing. Includes handwritten entries: SAND 0-61, GRAY Micaceous Rock 61-225.

NO. OF BAGS 14 NO. OF POUNDS 1316 GALLONS OF WATER 84 DEPTH OF GROUT SEAL (to nearest foot) from 0 ft. to 53 ft.

PUMPING RATE (gal. per min. to nearest gal.) 4 1/2 METHOD USED TO MEASURE PUMPING RATE bucket WATER LEVEL (distance from land surface) BEFORE PUMPING 35 WHEN PUMPING 113

CASING RECORD casing types insert appropriate code below ST CO STEEL CONCRETE PL OT PLASTIC OTHER

TYPE OF PUMP USED (for test) A air P piston T turbine C centrifugal R rotary O other (describe below) J jet S submersible

MAIN CASING TYPE Nominal diameter top (main) casing (nearest inch) Total depth of main casing (nearest foot) S+ 6 67

PUMP INSTALLED

OTHER CASING (if used) diameter inch depth (feet) from to

DRILLER WILL INSTALL PUMP YES NO IF DRILLER INSTALLS PUMP, THIS SECTION MUST BE COMPLETED FOR ALL SECTIONS EXCEPT HOME USE TYPE OF PUMP INSTALLED PLACE (A,C,J,P,R,S,T,O) IN BOX - SEE ABOVE: CAPACITY: GALLONS PER MINUTE (to nearest gallon) PUMP HORSE POWER PUMP COLUMN LENGTH (nearest ft.) CASING HEIGHT (circle appropriate box and enter casing height) + above LAND SURFACE - below (nearest foot)

SCREEN RECORD screen type or open hole insert appropriate code below ST BR HO STEEL BRASS OPEN HOLE PL OT PLASTIC OTHER

CIRCLE APPROPRIATE LETTER A A WELL WAS ABANDONED AND SEALED WHEN THIS WELL WAS COMPLETED E ELECTRIC LOG OBTAINED P TEST WELL CONVERTED TO PRODUCTION WELL

DEPTH (nearest ft.) 110 65 235

I HEREBY CERTIFY THAT THIS WELL HAS BEEN CONSTRUCTED IN ACCORDANCE WITH COMAR 10.17.13 "WELL CONSTRUCTION" AND IN CONFORMANCE WITH ALL CONDITIONS STATED IN THE ABOVE CAPTIONED PERMIT, AND THAT THE INFORMATION PRESENTED HEREIN IS ACCURATE AND COMPLETE TO THE BEST OF MY KNOWLEDGE.

SLOT SIZE 1 2 3 DIAMETER OF SCREEN (NEAREST INCH) from to

DRILLERS IDENT. NO. 238 DRILLERS SIGNATURE (MUST MATCH SIGNATURE ON APPLICATION)

GRAVEL PACK IF WELL DRILLED WAS FLOWING WELL INSERT F IN BOX 68

SITE SUPERVISOR (sign. of driller or journeyman responsible for sitework if different from permittee)

OEP USE ONLY (NOT TO BE FILLED IN BY DRILLER) T (E.R.O.S.) W Q TELESCOPE CASING LOG INDICATOR OTHER DATA

LOCATION OF WELL ON LOT SHOW PERMANENT STRUCTURE SUCH AS BUILDING, SEPTIC TANKS, AND/OR LANDMARKS AND INDICATE NOT LESS THAN TWO DISTANCES (MEASUREMENTS TO WELL)

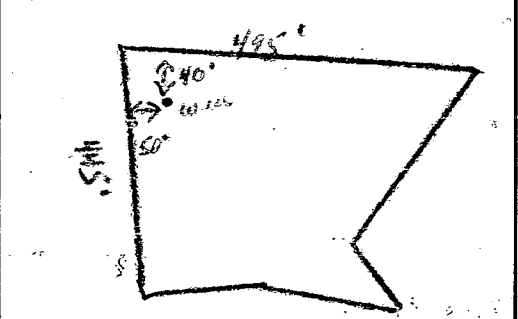

11/16/88
AM

HOWARD COUNTY HEALTH DEPARTMENT
Bureau of Environmental Health
3525-H Ellicott Mills Drive
Ellicott City, MD 21043
461-9933

APPLICATION FOR PITLESS ADAPTER, WELL PUMP AND PRESSURE TANK INSTALLATION

New Installation Replacement
Receipt # 42995
Date 11/15/88
Name of Installer J.A. Smith & Co Inc. Telephone 796-7532
License Number 5581
Certified Well Pump Installer Well Driller Registered Plumber
Name of Property Owner MARK + DEBORAH Bailey Telephone 788-1665
Subdivision DAYTON MEADOWS Lot # 1 Well Tag # HO-81-1452
Site Address 43256 GREENBRIDGE RD LOT 1 AREA 2 SECT 1

Pump
1. Type
a. Deep well jet
b. Shallow well jet
c. Submersible
2. Make FESOSYTH GOUIDS
3. Model # 53505411
4. Capacity 5 GPM
5. Pump exceeds well capacity Yes No
6. If Yes, is low pressure cutoff switch installed? Yes No
7. What methods are used to protect the pump and electrical wiring from vibrations? Torque arrestors Cable guards Other
Motor
1. Horsepower 1/2
2. RPM 3450
3. Voltage
a. 110
b. 220
Pitless Adapter
1. Make MARTINSON
2. Model # B104
3. Depth 48"

Tank
1. Capacity 40
2. Pressure relief valve? yes
Piping
1. Type NT 160
2. Size 1"
3. NSF and/or BOCA Code approved
4. Depth of supply line 42"
Well data
1. Depth 225 ft.
2. Yield 5 GPM
3. Static water level 37 ft.
4. Will water supply be disinfected by installer?

I understand that it is my responsibility to notify the Howard County Health Department when the installation is ready for inspection (otherwise this permit is null and void).

All information given above is true to the best of my knowledge.

Signature of Applicant: J. Allen Smith
Date: 11/14/88

Note: A sticker indicating approval/status of the installation will be placed on the well casing at the time of the inspection.

10/16/88 - WELL OK STICKER APPLIED R H
HD-215

B 1 **1038** SEQUENCE NO. (OEP USE ONLY)
 (THIS NUMBER IS TO BE PUNCHED IN COLS. 3-6 ON ALL CARDS)

STATE OF MARYLAND PERMIT TO DRILL WELL

please print or type

OEP PERMIT NUMBER

MD-91-1452
 fill in this form completely

Date Received **4/29/86**

OWNER INFORMATION

Last Name **Owner** **First Name**
ORRMAN ASSOCIATES

Street or RFD
PO BOX 132

Town **State** **Zip**
ELICOTT CITY MARYLAND 21037

B 3 **LOCATION OF WELL**

COUNTY **NEVER**

SUBDIVISION **INDUSTRIAL W/ADJACENT**

SECTION **LOT** **AREA**
1 **7** **ARON 2**

NEAREST TOWN **INDUSTRIAL**

MILES FROM TOWN (enter 0 if in town) **7 MI**

DRILLER INFORMATION

Driller's Name **Joseph I. Mayne** **License No.** **238**

Firm Name **Joseph I. Mayne Well Drilling**

Address **5512 RIVER RD. MD ARLY 2071**

Signature **Joseph I. Mayne** **Date** **11/1/86**

B 4 **DIRECTION OF WELL FROM TOWN (CIRCLE BOX)**

NEAR WHAT ROAD **Garrett Bridge Rd.**

ON WHICH SIDE OF ROAD (CIRCLE APPROPRIATE BOX)

DISTANCE FROM ROAD **200** **ENTER FT or MI** **FT**

B 2 **WELL INFORMATION**

APPROX. PUMPING RATE (GAL. PER MIN.) **5**

AVERAGE DAILY QUANTITY NEEDED (GAL. PER DAY) **570**

USE FOR WATER (CIRCLE APPROPRIATE BOX)

HOME (SINGLE OR DOUBLE HOUSEHOLD UNIT ONLY)

FARMING (LIVESTOCK WATERING & AGRICULTURAL IRRIGATION)

INDUSTRIAL, COMMERCIAL, STATE AND FEDERAL GOV. OTHER (REQUIRES APPROPRIATION PERMIT)

PUBLIC OR PRIVATE WATER COMPANY (REQUIRES APPROPRIATION PERMIT AND STATE HEALTH DEPARTMENT APPROVAL)

TEST, OBSERVATION, MONITORING (MAY REQUIRE APPROPRIATION PERMIT)

NOT TO BE FILLED IN BY DRILLER HEALTH DEPARTMENT APPROVAL

COUNTY NAME **HOWARD** **COUNTY NO.** **A 35646**

OEP SIGNATURE **DATE ISSUED** **11/02/86**

CO SIGNATURE **EXP. DATE**

NORTH GRID **511000** **EAST GRID** **0502000**

APPROXIMATE DEPTH OF WELL **200** **FEET**

APPROXIMATE DIAMETER OF WELL **6** **NEAREST INCH**

METHOD OF DRILLING (circle one)

BORED (or Augered) **JETTED** **Jetted & DRIVEN**

AIR-ROTary **AIR-PERcussion** **ROTARY (Hydraulic Rotary)**

CABLE **REVERSE-ROTary** **DRive-POINT**

other _____

SHOW MAJOR FEATURES OF BOX & LOCATE WELL WITH AN X

SOURCES OF DRILLING WATER

- Well
-
-

WRITE THE BOX NUMBER FROM THE MAP HERE

Box 2

Box 1

7-8-87 Not present for grant.

Box well

REPLACEMENT OR DEEPEMED WELLS (CIRCLE APPROPRIATE BOX)

THIS WELL WILL NOT REPLACE AN EXISTING WELL

THIS WELL WILL REPLACE A WELL THAT WILL BE ABANDONED AND SEALED

THIS WELL WILL REPLACE A WELL THAT WILL BE USED AS A STANDBY

THIS WELL WILL DEEPEM AN EXISTING WELL

PERMIT NUMBER OF WELL TO BE REPLACED OR DEEPEMED (IF AVAILABLE)

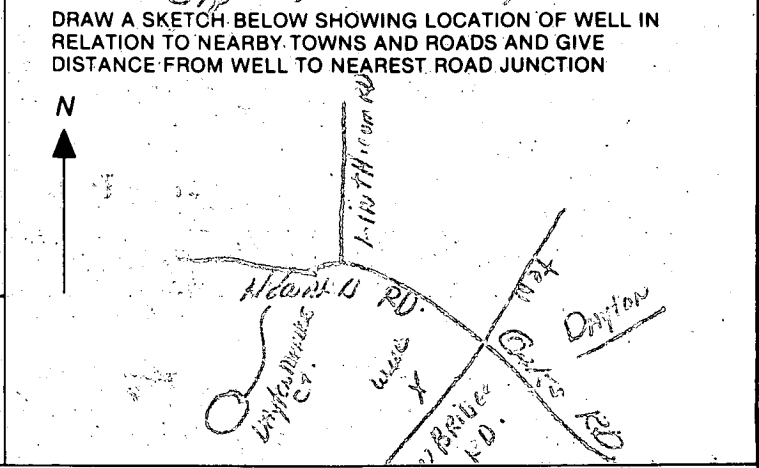

Not to be filled in by driller (OEP USE ONLY)

APPROP. PERMIT NUMBER **GAP**

FORCE **INITIALS** **PERMIT No.** **MD-91-1452**

SPECIAL CONDITIONS

DAYTON MEADOWS
SECTION 1 AREA 1
PLAT

5/25/87
300 adjusted previously
200 adjusted previously

WELL
approx location of 1st site.

LOT 1
3.061 Ac. ±

DAYTON MEADOWS
Lot 1
AREA 2

LOT 4
3.300 Ac. ±

LOT 3
3.125 Ac. ±

50' EASEMENT FOR
INGRESS AND EGRESS
FOR LOTS 3, 4, 5 AND 6.

FISHER, COLLINS AND CARTER, INC.
CONSULTING ENGINEERS AND LAND SURVEYORS
8388 COURT AVENUE
ELLCOTT CITY, MARYLAND 21043

OWNER AND DEVELOPER
CARMAN ASSOCIATES
P.O. BOX 122

