



APPLICATION

FOR PERCOLATION TESTING AND SITE EVALUATION

TEST DATE(S) _____ TEST TIME _____

AP 526152

AGENCY REVIEW: _____

DATE 12/27/06

DO NOT WRITE ABOVE THIS LINE

I HEREBY APPLY FOR THE NECESSARY TESTING/EVALUATION PRIOR TO ISSUANCE OF SEWAGE DISPOSAL SYSTEM PERMIT(S) TO:

CHECK AS NEEDED:

- CONSTRUCT NEW SEPTIC SYSTEM(S)
- REPAIR/ADD TO AN EXISTING SEPTIC SYSTEM
- REPLACE AN EXISTING SEPTIC SYSTEM

CHECK AS NEEDED:

- NEW STRUCTURE(S)
- ADDITION TO AN EXISTING STRUCTURE
- REPLACE AN EXISTING STRUCTURE

CHECK ONE:

- CREATE NEW LOT(S)
- BUILD ON AN EXISTING LOT IN A SUBDIVISION
- BUILD ON AN EXISTING PARCEL OF RECORD

IS THE PROPERTY WITHIN 2500' OF ANY RESERVOIR?

- YES
- NO

THE TYPE OF STRUCTURE IS:

- RESIDENTIAL WITH 3 PROPOSED BEDROOMS IN THE COMPLETED STRUCTURE (NOTE **UNKNOWN** IF APPROPRIATE)
- COMMERCIAL (PROVIDE DETAIL OF NUMBERS AND TYPES OF EMPLOYEES/ CUSTOMERS ON ACCOMPANYING PLAN)
- INSTITUTIONAL/GOVERNMENT (PROVIDE DETAIL OF NUMBERS AND TYPES OF EMPLOYEES/USERS ON ACCOMPANYING PLAN)

PROPERTY OWNER(S) Phillip Niskell

DAYTIME PHONE 301-490-9762 CELL _____ FAX _____

MAILING ADDRESS 7541 Cherry Tree Dr. Fulton MD
STREET CITY/TOWN STATE ZIP

APPLICANT J.M. Contracting LLC / Ronnie Heaps

DAYTIME PHONE 443-277-7526 CELL 443-277-7526 FAX 410-552-5815

MAILING ADDRESS 425 O Brecht Rd. Sykesville MD 21784
STREET CITY/TOWN STATE ZIP

APPLICANT'S ROLE: DEVELOPER BUILDER BUYER RELATIVE/FRIEND REALTOR CONSULTANT

PROPERTY LOCATION

SUBDIVISION/PROPERTY NAME _____ LOT NO. _____

PROPERTY ADDRESS 7141 Cherry Tree Dr. Fulton
STREET TOWN/POST OFFICE

TAX MAP PAGE(S) _____ GRID _____ PARCEL(S) _____ PROPOSED LOT SIZE _____

AS APPLICANT, I UNDERSTAND THE FOLLOWING: THE SYSTEM INSTALLED SUBSEQUENT TO THIS APPLICATION IS ACCEPTABLE ONLY UNTIL PUBLIC SEWERAGE IS AVAILABLE. THIS APPLICATION IS COMPLETE WHEN ALL APPLICABLE FEES AND A SUITABLE SITE PLAN HAVE BEEN RECEIVED. I ACCEPT THE RESPONSIBILITY FOR COMPLIANCE WITH ALL M.O.S.H.A. AND 'MISS UTILITY' REQUIREMENTS. APPROVAL IS BASED UPON SATISFACTORY REVIEW OF A PERC CERTIFICATION PLAN.

TEST RESULTS WILL BE MAILED TO APPLICANT.

Ronnie E Heaps
SIGNATURE OF APPLICANT

HOWARD COUNTY HEALTH DEPARTMENT, BUREAU OF ENVIRONMENTAL HEALTH, WELL AND SEPTIC PROGRAM
7178 COLUMBIA GATEWAY DRIVE · COLUMBIA, MARYLAND 21046 (410) 313-2640 FAX (410) 313-2648
TDD (410) 313-2323 TOLL FREE 1-877-4MD-DHMH

AP _____

(A)

- 1.5' Br Topsoil
- 4.5'-5' Red Br Si/Cl Loam Trace Rock
- 5.5' Red Br Sa/Cl Loam Trace Rock
- 16' Red Br Sa/Cl Loam, 20-25% Rock and Saprolite

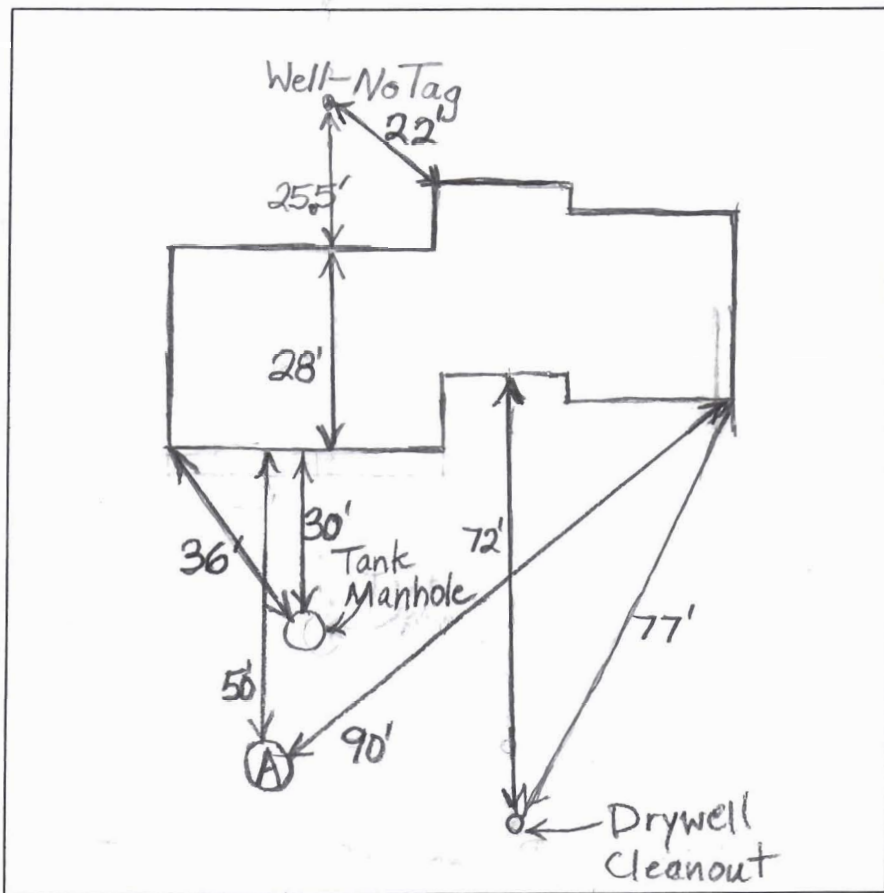

Cherry Tree Drive

DATE	TEST #	DEPTH	START	BREAK 1" DROP	STOP 2" DROP	TIME OF 2ND INCH	P/F/H
12/29/06	A	5.5'/16'		13		23	P
		6.5'		4		5 1/2	P

REMARKS Water Poured in Bottom of Test Hole - Rate OK.
 SANITARIAN B. Baker BACKHOE R. Heaps OTHERS _____
 TEST HOLES USED IN SDA A AVG. PERC TIME 5 1/2 SQ. FT/BR 180
 TRENCH WIDTH 2 INLET DEPTH 5 MAX. BOT DEPTH 12' EFFECTIVE SW 6'