

3/27/86 AM - 9:30 - 10:00

02-222094

Approved 3/27/86

# PERMIT

P-36720 RH

A REPAIR

SEWAGE DISPOSAL SYSTEM

MARYLAND STATE DEPARTMENT OF HEALTH\*

HOWARD COUNTY

ELLICOTT CITY

BUREAU OF ENVIRONMENTAL HEALTH

DISTRICT \_\_\_\_\_

461-9933

INDEXED

DATE 3/26/86

Jack Fyock

IS PERMITTED TO INSTALL \_\_\_\_\_ ALTER

ADDRESS \_\_\_\_\_ PHONE 988-9270

SUBDIVISION \_\_\_\_\_ ROAD 3560 Church Road LOT \_\_\_\_\_

PROPERTY OWNER Herman G. Mueller

ADDRESS \_\_\_\_\_

IF GARBAGE GRINDER IS USED INCREASE SEPTIC TANK CAPACITY BY 50% AND ABSORPTION AREA BY 22%.

GARBAGE GRINDER? YES  NO

SEPTIC TANK CAPACITY NA GALLONS NUMBER OF BEDROOMS 4

REPAIR - CALL FOR INSPECTION WHEN GROUND IS OPENED UP SO SANITARIAN CAN RECOMMEND

REPAIR. 3/27/86 - TRENCH OFF EXISTING

DRY WELL 500 SQFT ABSORBENT AREA ONE SIDE  
TRENCH 10 FT DEEP 2 FT WIDE 8 FT STONE 63 FT LONG

PLANS APPROVED BY C. Williams DATE 3/26/86

COVER NO WORK UNTIL INSPECTED AND APPROVED.

NEITHER THE HOWARD COUNTY COUNCIL NOR THE HEALTH DEPARTMENT IS RESPONSIBLE FOR THE SUCCESSFUL OPERATION OF ANY SYSTEM.

NOTE: IF TRENCH IS USED CALL FOR INSPECTION BEFORE AND AFTER PLACING GRAVEL IN TRENCH.

NOTE: NO DRY WELL SHALL EXCEED 15 FOOT IN DIAMETER. NO ABSORPTION TRENCH TO EXCEED 100 FEET IN LENGTH.

NOTE: ALL PIPE FROM HOUSE TO SEPTIC TANK MUST BE CAST IRON OR SCHEDULE 40 PVC OR ABS.

PERMIT VOID AFTER THREE YEARS.

NOTE: INSTALL STAND PIPE ON SEPTIC TANK AND DRY WELL. STAND PIPES MUST BE 6 INCHES IN DIAMETER. CAST IRON, CONCRETE OR TERRA COTTA, OR PVC OR ABS ACCEPTED. IF TOP OF SEPTIC TANK IS DEEPER THAN 3 FEET MANHOLE TO GRADE REQUIRED.

\*INSTALLER IS RESPONSIBLE FOR OBTAINING FINAL APPROVAL ON THIS PERMIT

8/50.0

FOR INSPECTION OF SEPTIC SYSTEMS.

EH - 2-1082

A Repair 36720

13  
17

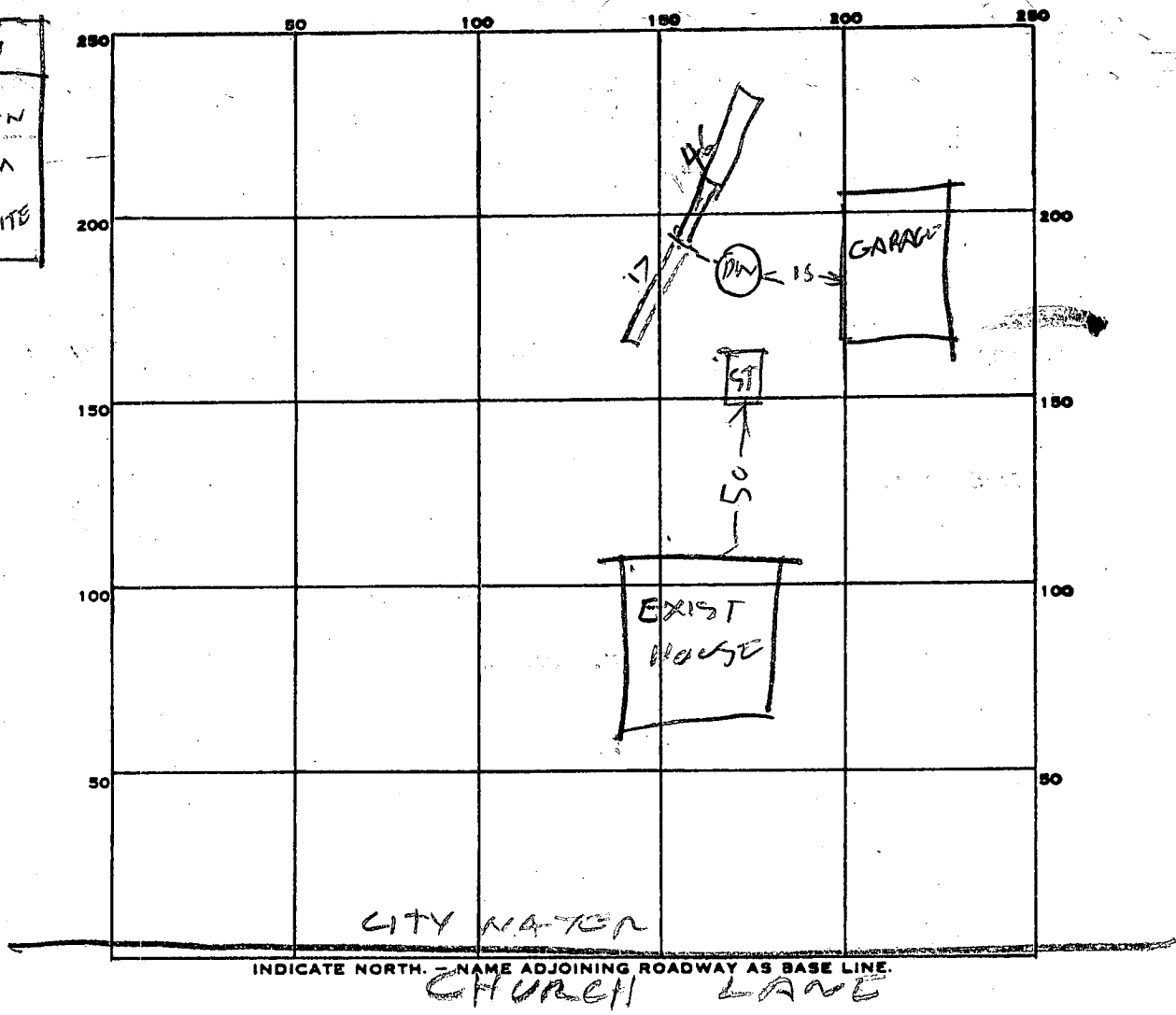
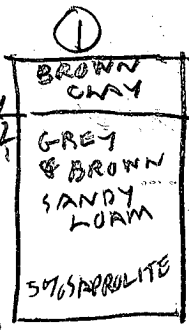

PERMIT CARD \_\_\_\_\_

SEPTIC TANK, LEVEL \_\_\_\_\_

CLEANOUTS \_\_\_\_\_

DISTRIBUTION BOX, LEVEL \_\_\_\_\_

TILE FIELD, DEPTH 10 FT. TRENCH WIDTH 2 FT.

GRAVEL DEPTH 9 FT IN. TOTAL LENGTH 3063 FT.

NUMBER OF TRENCHES 1 TOTAL BOTTOM AREA 504

SEEPAGE PITS, INSIDE DIAMETER \_\_\_\_\_ FT. DEPTH BELOW INLET \_\_\_\_\_ FT.

ABSORBENT AREA \_\_\_\_\_ SQ. FT.

REMARKS 3/27/86<sup>AM</sup> OLD DW 13 FT DEEP FOR SEVERAL YEARS, SOIL OK

FORTRENCH SYSTEM - FINISH DIGGING TRENCH ADD

STONE & CALL.

3/27/86<sup>AM</sup> TRENCH DUG & MOST OF STONE ADDED

FINISH ADDING STONE RH

DATE SYSTEM APPROVED 3/27/86

INSPECTOR Raymond Hodges

125  
500  
87

April 21, 1986

Ms. Joan Cochran  
c/o Urban Properties  
Equitable Bank Center  
Columbia, Maryland 21044

RE: Herman Mueller Property  
3560 Church Road

Dear Ms. Cochran,

A septic system repair on the above referenced property was approved according to the standards of the Howard County Health Department on March 27, 1986.

A copy of the notes from the repair inspection is enclosed for your reference.

Very truly yours,

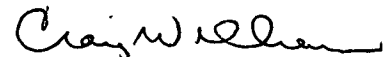

Craig Williams, Director  
Water and Sewerage Program

CW:JR

Enclosure