

ASAP

APPROVED
11/13/85
RH
P 36216
A REPAIR

PERMIT

SEWAGE DISPOSAL SYSTEM

MARYLAND STATE DEPARTMENT OF HEALTH*

HOWARD COUNTY
BUREAU OF ENVIRONMENTAL HEALTH
461-9933

03-279723

ELLICOTT CITY
DISTRICT 3rd
DATE 11/13/85

INDEXED

Jack Fyock IS PERMITTED TO INSTALL _____ ALTER X

ADDRESS _____ PHONE 988-9270

SUBDIVISION Woodmark ROAD 12139 Mt. Albert Rd LOT 10, Blk D., Sec. 1

PROPERTY OWNER Dr. & Mrs. Raymond D. Bahr

ADDRESS _____

IF GARBAGE GRINDER IS USED INCREASE SEPTIC TANK CAPACITY BY 50% AND ABSORPTION AREA BY 22%.

GARBAGE GRINDER? YES _____ NO X

SEPTIC TANK CAPACITY _____ GALLONS NUMBER OF BEDROOMS 4

REPAIR - CALL FOR INSPECTION WHEN GROUND IS OPENED UP SO SANITARIAN CAN RECOMMEND REPAIR.

7/13/85 Purpose of Repair is to fix a full
dry well
ROCK DECIDE ON COMBINATION
LEACHING BED & DEEP TRENCH: TOTAL 500
SQFT BOTTOM AREA. RUN DEEP TRENCH OFF DRY
WELL. MAKE DEEP TRENCH 10 FT DEEP 42 FT LONG
2 FT WIDE 7 FT STONE RUN SHALLOW BED OFF DEEP
TRENCH MAKE BED 5 FT DEEP 2 FT WIDE

PLANS APPROVED BY Craig Williams, DATE 11/06/85

COVER NO WORK UNTIL INSPECTED AND APPROVED. 25 FT LONG 1 1/2 FT STONE

NEITHER THE HOWARD COUNTY COUNCIL NOR THE HEALTH DEPARTMENT IS RESPONSIBLE FOR THE SUCCESSFUL OPERATION OF ANY SYSTEM. RH

- NOTE: IF TRENCH IS USED CALL FOR INSPECTION BEFORE AND AFTER PLACING GRAVEL IN TRENCH.
- NOTE: NO DRY WELL SHALL EXCEED 15 FOOT IN DIAMETER. NO ABSORPTION TRENCH TO EXCEED 100 FEET IN LENGTH.
- NOTE: ALL PIPE FROM HOUSE TO SEPTIC TANK MUST BE CAST IRON OR SCHEDULE 40 PVC OR ABS.
- PERMIT VOID AFTER THREE YEARS.
- NOTE: INSTALL STAND PIPE ON SEPTIC TANK AND DRY WELL. STAND PIPES MUST BE 6 INCHES IN DIAMETER. CAST IRON, CONCRETE OR TERRA COTTA, OR PVC OR ABS ACCEPTED. IF TOP OF SEPTIC TANK IS DEEPER THAN 3 FEET MANHOLE TO GRADE REQUIRED.

*INSTALLER IS RESPONSIBLE FOR OBTAINING FINAL APPROVAL ON THIS PERMIT

*CALL 992-2330 FOR INSPECTION OF SEPTIC SYSTEMS.

EH - 2-1082

A REPAIR 36216

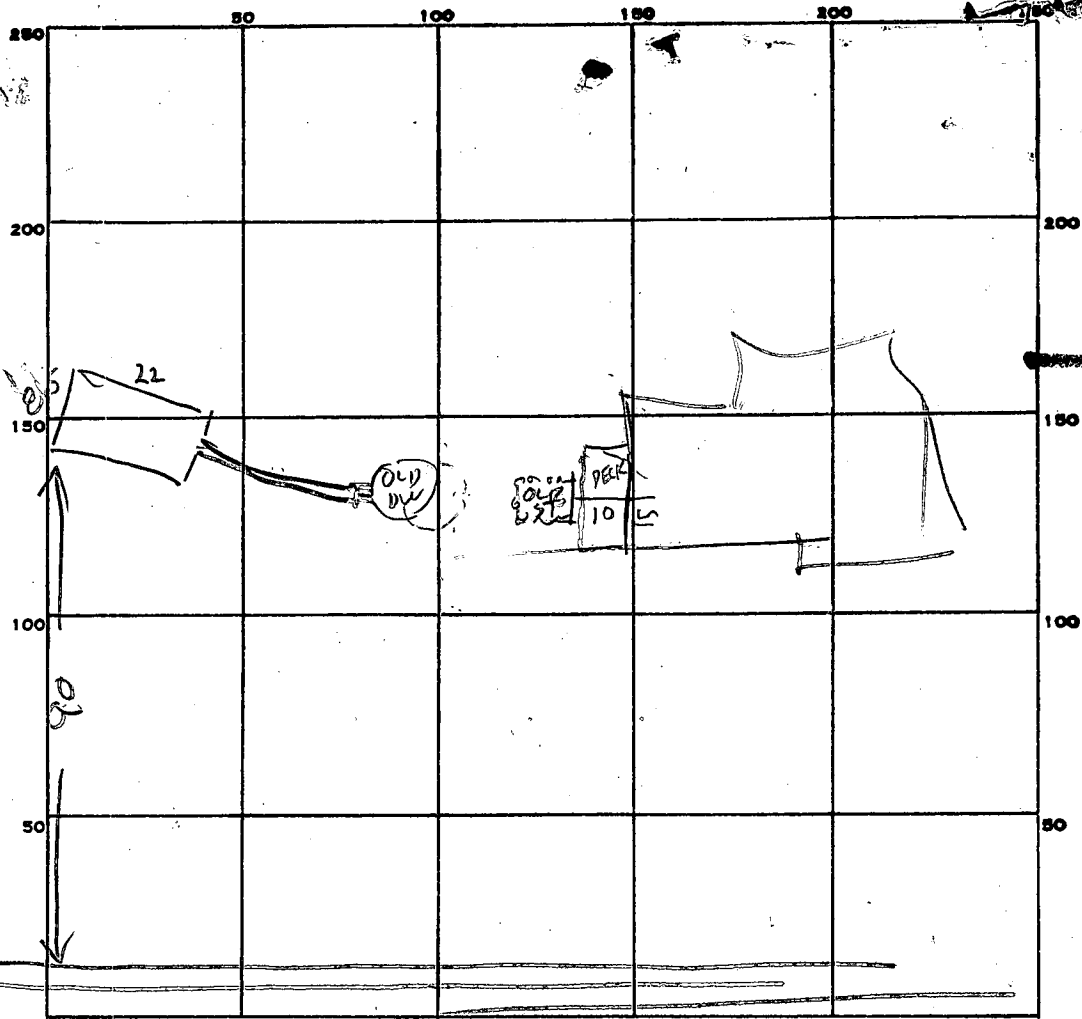

INDICATE NORTH. - NAME ADJOINING ROADWAY AS BASE LINE.
 MT ALBERT RD

PERMIT CARD _____

SEPTIC TANK, LEVEL N/A

CLEANOUTS _____

DISTRIBUTION BOX, LEVEL N/A

LEACHING BED & DEEP TRENCH SEE REMARKS
 TILE FIELD, DEPTH _____ FT. TRENCH WIDTH _____ FT.

GRAVEL DEPTH _____ IN. TOTAL LENGTH _____ FT.

NUMBER OF TRENCHES _____ TOTAL BOTTOM AREA _____

SEEPAGE PITS, INSIDE DIAMETER _____ FT. DEPTH BELOW INLET _____ FT.

ABSORBENT AREA _____ SQ. FT.

REMARKS 11/13/85^{AM} - FIRST NARROW 2FT WIDE PART OF TRENCH DUG

IT IS 42 FT LONG 2 FT WIDE 10 FT DEEP & 7 FT STONE RH

11/13/85^{PM} SECOND WIDE BED 8 1/2 FT WIDE X 22 FT LONG 6 FT DEEP

3 FT STONE. TRENCH HAS 284 SQ FT ONE SIDEWALL

AREA. BED HAS 187 SQ FT BOTTOM AREA - TOTAL

471 SQ FT SYSTEM RH

DATE SYSTEM APPROVED 11/13/85

INSPECTOR Raymond Hodges

46
2

PERMIT

SEWAGE DISPOSAL SYSTEM

MARYLAND STATE DEPARTMENT OF HEALTH

HOWARD COUNTY

ELLICOTT CITY

INDEXED

DISTRICT 3rd

DATE 11/29/72

P 17683

A 12928

1/20/13/73

OK 11/27/72 HLS

Jack Fyock

IS PERMITTED TO INSTALL ALTER

ADDRESS Ten Oaks Road, Glenelg, Md.

PHONE 286-2939

A SEWAGE DISPOSAL SYSTEM LOCATED AT _____

SUBDIVISION Woodmark

ROAD Mt. Albert Road

LOT 10, Blk. D,
Sect. 1

PROPERTY OWNER Woodmark, Inc. Dr. & Mrs. Raymond P. Bahr

ADDRESS 231 Chatham Road, Ellicott City, Md.

SPECIFICATIONS 4 bedrooms

DRAIN FIELD _____ DEPTH _____ FEET, BOTTOM AREA _____ SQ. FT.

SEEPAGE PITS _____ ABSORBENT SIDE-WALL AREA _____ SQ. FT.

SEPTIC TANK CAPACITY 1200 GALLONS

FOR GARBAGE GRINDER, INCREASE DISPOSAL AREA 22% & TANK CAPACITY 50%.

OTHER DRY WELL - 100 sq. ft. absorbent sidewall area below inlet pipe per bedroom. Inlet pipe 4 ft. below original grade. Maximum depth permitted for dry well below original grade is 12 ft. Place dry well 125 ft. from front lot line and 64 ft. from left sideline as seen when facing lot from Mt. Albert Road.

NOTE: ALL PIPE FROM HOUSE TO SEPTIC TANK MUST BE CAST IRON.

PERMIT VOID AFTER THREE YEARS.

NOTE: INSTALL STAND PIPE ON SEPTIC TANK AND DRY WELL.

PLANS APPROVED BY Donald W. Monaghan

DATE 3/4/68

FILL SEPTIC TANK AND DISTRIBUTION BOX WITH WATER BEFORE CALLING FOR AN INSPECTION. COVER NO WORK UNTIL INSPECTED AND APPROVED.

NEITHER THE HOWARD COUNTY COMMISSIONERS NOR THE HEALTH DEPARTMENT IS RESPONSIBLE FOR THE SUCCESSFUL OPERATION OF ANY SYSTEM.

BLDG. PERMIT SIGNED
AND RETURNED

10/25/85
Serial # 67581

A 12928

284
187
171

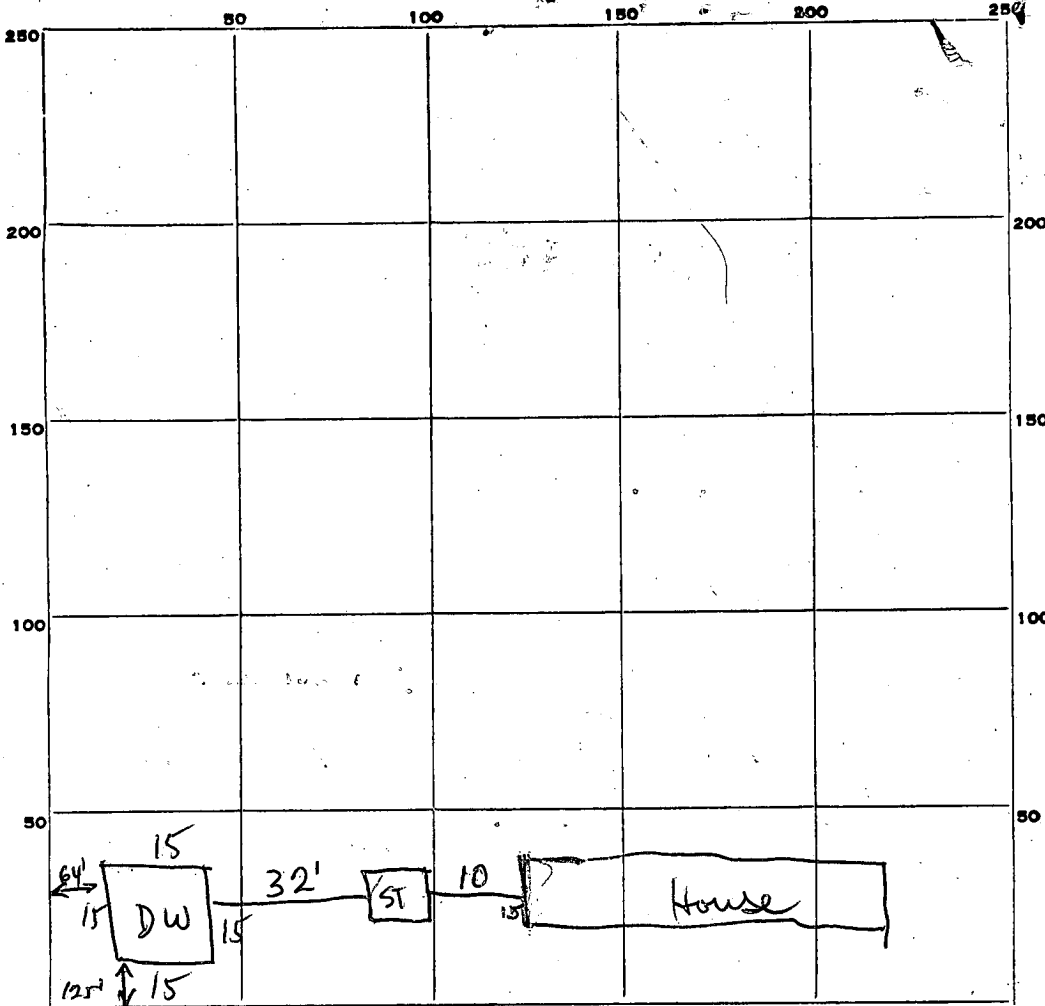

INDICATE NORTH. - NAME ADJOINING ROADWAY AS BASE LINE.

MT allent rd

PERMIT CARD OK

SEPTIC TANK, LEVEL OK

CLEANOUTS OK

DISTRIBUTION BOX, LEVEL _____

TILE FIELD, DEPTH _____ FT. TRENCH WIDTH _____ FT.

GRAVEL DEPTH _____ IN. TOTAL LENGTH _____ FT.

NUMBER OF TRENCHES _____ TOTAL BOTTOM AREA _____

SEEPAGE PITS, INSIDE DIAMETER perimeter 60 FT. DEPTH BELOW INLET 7' FT.

ABSORBENT AREA 420 SQ. FT.

REMARKS _____

Did NOT SIGN permit card

DATE SYSTEM APPROVED 11/2/73

INSPECTOR H Snyder

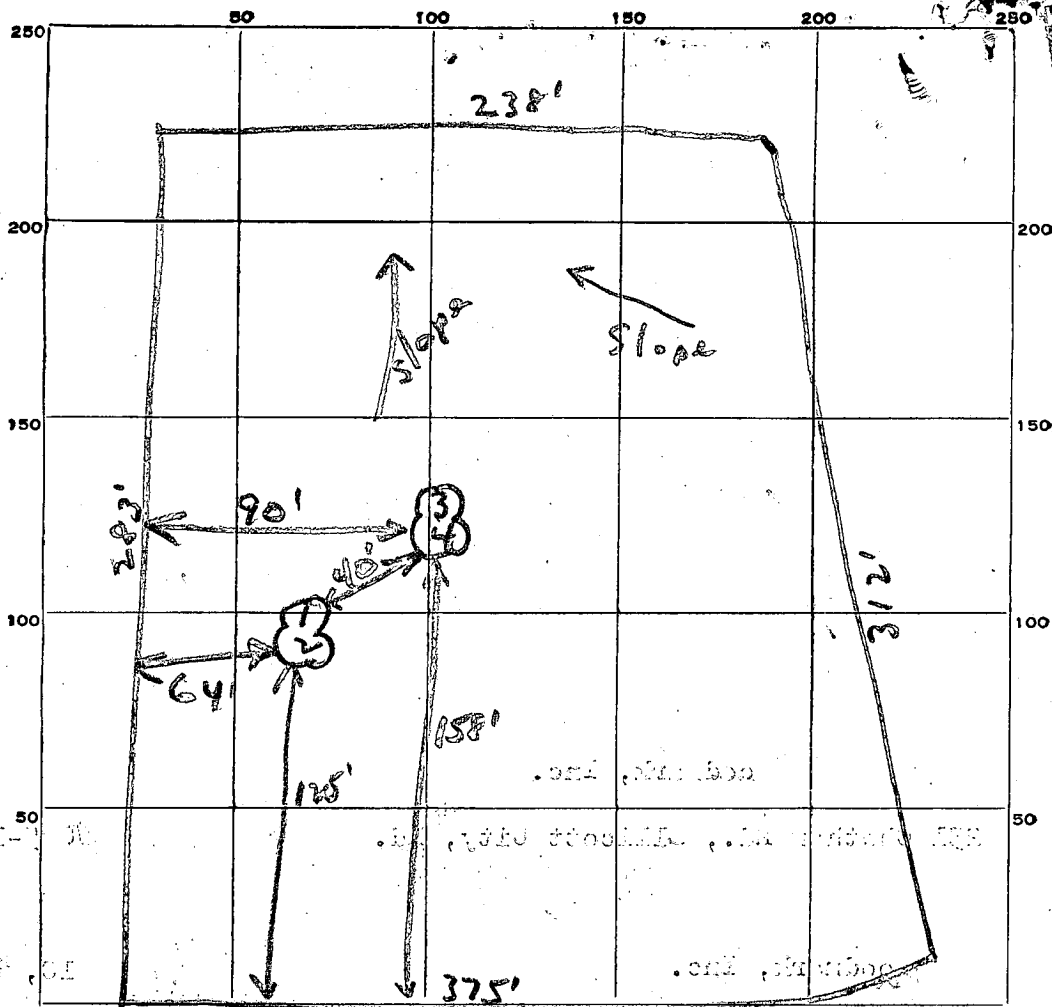

INDICATE NORTH. NAME ADJOINING ROADWAY AS BASE LINE.

Road A

DATE	TEST NO.	DEPTH	PRE-WET		TEST - 1" DROP		TIME
			START	STOP	START	STOP	
7/11/57	1	5'	3:14	3:15	3:15	3:18	3 min
	2	12'	3:14	3:21	3:21	3:33	12 min
	3	4 1/2'	3:09	3:11	3:11	3:13	2 min
	4	12'	3:10	3:12	3:12	3:15	3 min

SOIL AUGER FINDING _____

TESTED BY *JHK + Dwm*

REMARKS _____

Preliminary

APPLICATION

A 12928

SEWAGE DISPOSAL TESTING

P _____

MARYLAND STATE DEPARTMENT OF HEALTH

HOWARD COUNTY

ELLICOTT CITY

DISTRICT 3

DATE 7/21/67

TO: THE COUNTY HEALTH OFFICER
ELLICOTT CITY, MARYLAND

I, HEREBY, APPLY FOR THE NECESSARY TESTS IN ORDER TO CONSTRUCT (OR RECONSTRUCT) A SEWAGE DISPOSAL SYSTEM.

PROPERTY OWNER Woodmark, Inc.

ADDRESS 251 Chatham Rd., Ellicott City, Md. PHONE HO 5-1345

PROPERTY LOCATION:

SUBDIVISION Woodmark, Inc. LOT NO. 10, Blk, D, Sec. 2

ROAD AND DESCRIPTION Road "A" Mt. Albert Road

OCCUPANT _____ PHONE _____

PERSON TO CONSTRUCT SYSTEM _____

ADDRESS _____ PHONE _____

SIZE OF LOT 375' x 283' x 238' x 312' TYPE BLDG. 3 or 4
NUMBER OF BEDROOMS

IF NOT SINGLE RESIDENCE DESCRIBE _____

SIGNATURE OF APPLICANT /s/ Mark A. Wakefield

APPROVED BY [Signature] FOR [Signature] DATE 7-14-67
(KIND OF SYSTEM)

REJECTED BY _____ FOR _____ DATE _____
(KIND OF SYSTEM)

HOLD PENDING FURTHER TESTS _____ DATE _____

REASONS FOR REJECTION OR HOLDING _____

THIS IS NOT A PERMIT

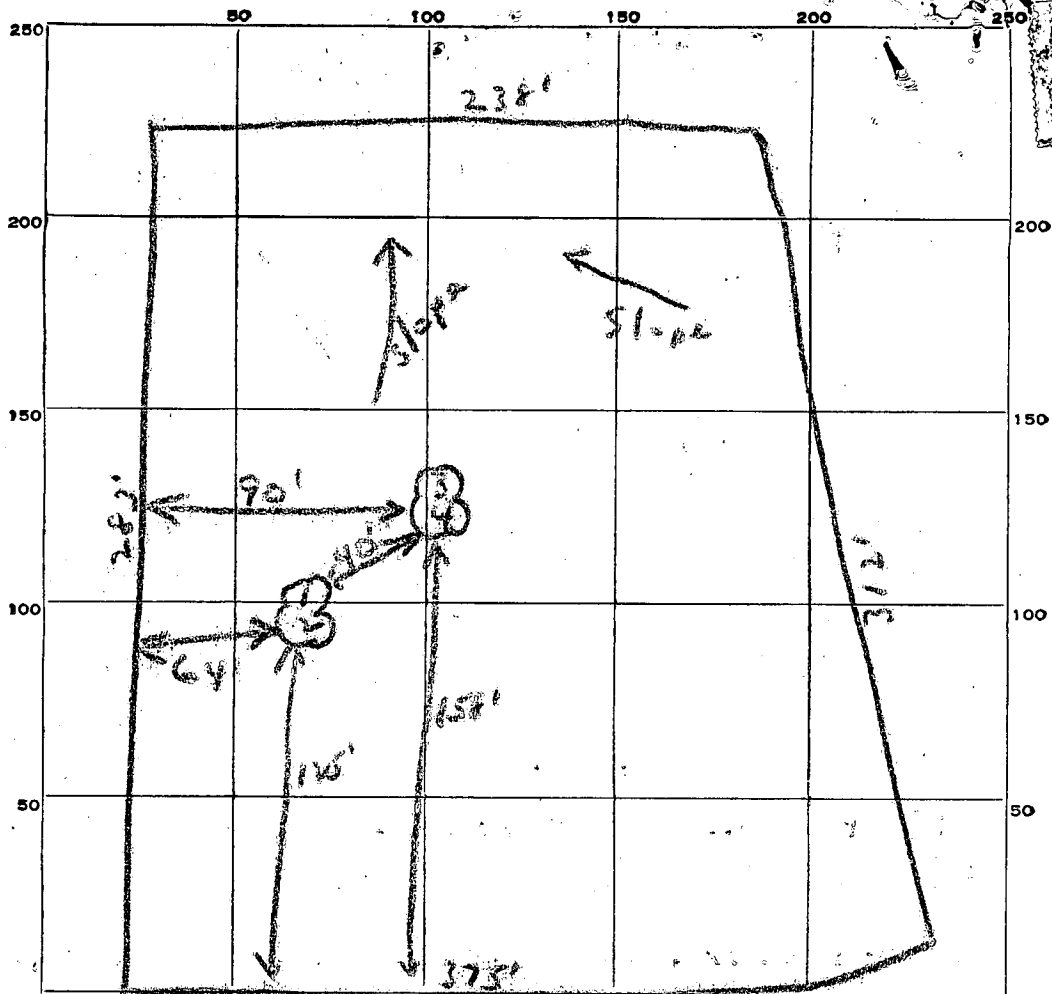

INDICATE NORTH - NAME ADJOINING ROADWAY AS BASE LINE.

Road A

DATE	TEST NO.	DEPTH	PRE-WET		TEST - 1" DROP		TIME
			START	STOP	START	STOP	
7/11/67	1	5'	3:14	3:15	3:15	3:18	3 min
	2	12'	3:14	3:21	3:21	3:33	12 min
	3	4 1/2'	3:09	3:11	3:11	3:13	2 min
	4	12'	3:10	3:12	3:12	3:15	3 min

SOIL AUGER FINDING _____

TESTED BY JHK + Dwan

REMARKS _____

100

1-8640

MOUNT ALBERT ROAD

296.71' TO P.C. @
MT. ALBERT CT.

R = 495.87'
L = 125.42'

DUE WEST - 244.05'

R = 628.11'
L = 6.57'

SCALE: 1" = 50'

S 26° 19' 39" E

111.5'

95.2'

12.2'

5' UTILITY EASEMENT
S 65° 37' 20" W - 227.70'

100' BUILDING RESTRICTION LINE

EXISTING RESIDENCE
(DR. + MRS. BAHR)

CONC. BLOCK FOUNDATION

PROPOSED SCREENED PORCH
102 ±

DECK IS RAISED 6" AB. GUNDS

BUILDER AGREES TO STOP STRUCTURE BEFORE SEPTIC CLEAROUT

FOOTINGS FOR DECK TO BE PLACED ADJACENT TO, BUT NOT OVER,

LOT 10 BLOCK D END OF TANK.

PART B SECTION NO ONE WOODMARK 13/62

OK TO PROCEED 10/24/85
20' DRAINAGE EASEMENT

This is to certify that I have surveyed the property known as LOT 10 - BLOCK D - PART B - SECTION NO. ONE - WOODMARK - THIRD ELECTION DISTRICT - HOWARD COUNTY, MARYLAND.

for the purpose of locating the improvements thereon, and the improvements are located as shown.

Signed this 30th day of NOVEMBER 1972

PURDUM AND JESCHKE
ENGINEERS AND LAND SURVEYORS
3697 PARK AVE.
ELLCOTT CITY, MARYLAND 21043
R.H. J.L.

DR & MRS RAYMOND BAHR
12139 MT. ALBERT CT
ELLCOTT CITY, MD
21043

William Kasele
Engineer and Land Surveyor

This plat is not intended for use in
" ment of property lines.

HOWARD COUNTY HEALTH DEPARTMENT

JOYCE M. BOYD, M.D., M.P.H.
COUNTY HEALTH OFFICER



Bureau of Environmental Health
3525 Ellicott Mills Drive
Ellicott City, Maryland 21043

Director - 461-9956
Water & Sewerage, Permits - 461-9933
Community Environmental Health - 461-9944
Technical Services - 461-9955

October 28, 1985

Mrs. Raymond Bahr
12139 Mt. Albert Road
Ellicott City, Maryland 21043

RE: Building Permit #67581
Screen Porch
12139 Mt. Albert Road

Dear Mrs. Bahr:

Per our discussion today, I have signed for Health Department approval of the above referenced building permit application. This approval is based on our understanding that the proposed porch will be installed at least 5 feet above grade, will not be enclosed, and will come to the edge of the septic tank, but will not cover any portion of it. Furthermore the builder understands that no piers or footings may be placed over the tank.

If these conditions are adhered to, I anticipate no interference with the functioning of your septic tank. After you left, I also inspected your drywell and found its prospects not so bright. This project has no impact on the drywell, but nevertheless it is nearly full to capacity. You may find this a convenient time to consider a repair to your disposal field rather than to wait until the system fails as it will most likely do in the near future.

If you have any questions relative to this matter, please call me at 461-9933.

Very truly yours,

Craig Williams, Director
Water and Sewerage Program

CW:JR