

system approved & completed 10/29/85 (RD)/C.W.
05-342597

10/30/85

PERMIT

P 36163
A REPAIR

SEWAGE DISPOSAL SYSTEM MARYLAND STATE DEPARTMENT OF HEALTH*

HOWARD COUNTY
BUREAU OF ENVIRONMENTAL HEALTH
██████████
461-9933

INDEXED

ELLICOTT CITY
DISTRICT _____
DATE 10/30/85

Jack Fyock IS PERMITTED TO INSTALL _____ ALTER X

ADDRESS _____ PHONE 988-9270

SUBDIVISION _____ ROAD 6544 Haviland Mill LOT 1

PROPERTY OWNER Baumgardner
6544 Haviland Mill Road

ADDRESS _____

IF GARBAGE GRINDER IS USED INCREASE SEPTIC TANK CAPACITY BY 50% AND ABSORPTION AREA BY 22%.

GARBAGE GRINDER? YES _____ NO _____

SEPTIC TANK CAPACITY _____ GALLONS NUMBER OF BEDROOMS 3

REPAIR - CALL FOR INSPECTION WHEN GROUND IS OPENED UP SO SANITARIAN CAN RECOMMEND REPAIR.

PLANS APPROVED BY C. Williams DATE 10/29/85

COVER NO WORK UNTIL INSPECTED AND APPROVED.

NEITHER THE HOWARD COUNTY COUNCIL NOR THE HEALTH DEPARTMENT IS RESPONSIBLE FOR THE SUCCESSFUL OPERATION OF ANY SYSTEM.

NOTE: IF TRENCH IS USED CALL FOR INSPECTION BEFORE AND AFTER PLACING GRAVEL IN TRENCH.

NOTE: NO DRY WELL SHALL EXCEED 15 FOOT IN DIAMETER. NO ABSORPTION TRENCH TO EXCEED 100 FEET IN LENGTH.

NOTE: ALL PIPE FROM HOUSE TO SEPTIC TANK MUST BE CAST IRON OR SCHEDULE 40 PVC OR ABS.

PERMIT VOID AFTER THREE YEARS.

NOTE: INSTALL STAND PIPE ON SEPTIC TANK AND DRY WELL. STAND PIPES MUST BE 6 INCHES IN DIAMETER. CAST IRON, CONCRETE OR TERRA COTTA, OR PVC OR ABS ACCEPTED. IF TOP OF SEPTIC TANK IS DEEPER THAN 3 FEET MANHOLE TO GRADE REQUIRED.

***INSTALLER IS RESPONSIBLE FOR OBTAINING FINAL APPROVAL ON THIS PERMIT**

*CALL 992-2330 FOR INSPECTION OF SEPTIC SYSTEMS.

EH - 2-1082

R36163
REPAIR

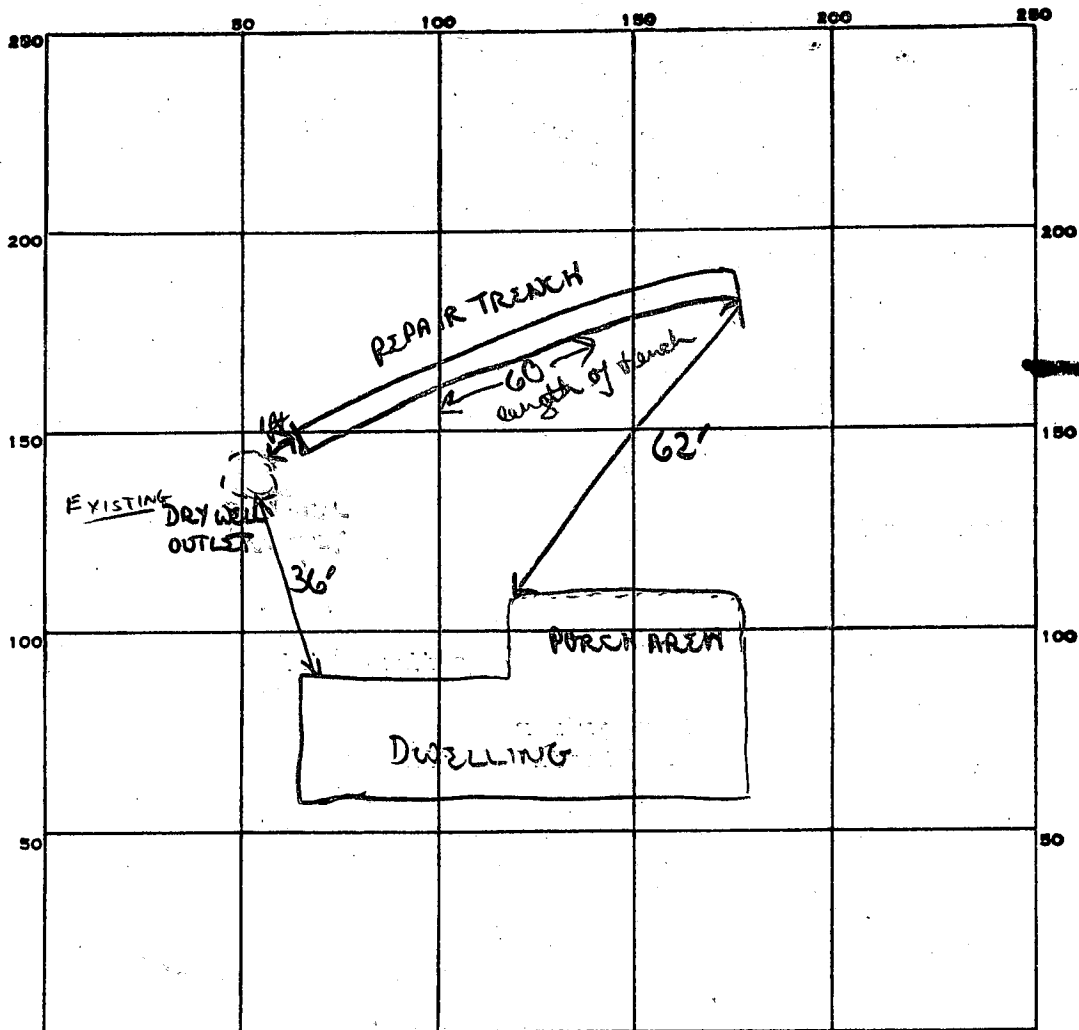

INDICATE NORTH. - NAME ADJOINING ROADWAY AS BASE LINE.

NAVILAND MILL RD.

PERMIT CARD _____

SEPTIC TANK, LEVEL _____

CLEANOUTS _____

DISTRIBUTION BOX, LEVEL _____

TILE FIELD, DEPTH 12 FT. TRENCH WIDTH 2 FT.

GRAVEL DEPTH 6 ft IN. TOTAL LENGTH 60 FT.

NUMBER OF TRENCHES 1 TOTAL BOTTOM AREA 360

1 SIDE WALL

*120/200
3
360*

SEEPAGE PITS, INSIDE DIAMETER _____ FT. DEPTH BELOW INLET _____ FT.

ABSORBENT AREA 360 SQ. FT.

REMARKS Hooked up to existing dry well / Inlet was at ≈ 6 ft
soil - uniform red silty loam - mixture
OK to cover trench & finish

DATE SYSTEM APPROVED 10/29/85

INSPECTOR B.N./C.W.