

PERMIT

P 36049

SEWAGE DISPOSAL SYSTEM

A REPAIR

MARYLAND STATE DEPARTMENT OF HEALTH*

HOWARD COUNTY

01-173502

ELLICOTT CITY

BUREAU OF ENVIRONMENTAL HEALTH

INDEXED

DISTRICT 1

~~202-2830~~

461-9933

DATE 10/01/85

Tim French - AHI General Contractors IS PERMITTED TO INSTALL _____ ALTER X

ADDRESS 4617 Roundhill Road, Ellicott City, Maryland 21043 PHONE _____

SUBDIVISION _____ ROAD 6291 Rockburn Hill LOT _____

PROPERTY OWNER Virginia Medairy

6291 Rockburn Hill Road

ADDRESS _____

IF GARBAGE GRINDER IS USED INCREASE SEPTIC TANK CAPACITY BY 50% AND ABSORPTION AREA BY 22%.

GARBAGE GRINDER? YES _____ NO X

SEPTIC TANK CAPACITY 1500 GALLONS NUMBER OF BEDROOMS 3

PUMP SYSTEM - 1500 gallon tank. Include pump pit and high water alarm device.

600 sq. ft. total bottom area system

LOCATION: As per perc test - start trench approximately 100 feet behind left rear corner of house.

Existing system to be pumped and abandoned.

WPI 1-20-86 - PITNESS IN AT 42" below GRADE. well line 42"-50" below GRADE;

New PRESSURE TANK w/ Relief valve installed. S. Abol.

PLANS APPROVED BY C. Williams DATE 11/29/85

COVER NO WORK UNTIL INSPECTED AND APPROVED.

NEITHER THE HOWARD COUNTY COUNCIL NOR THE HEALTH DEPARTMENT IS RESPONSIBLE FOR THE SUCCESSFUL OPERATION OF ANY SYSTEM.

NOTE: IF TRENCH IS USED CALL FOR INSPECTION BEFORE AND AFTER PLACING GRAVEL IN TRENCH.

NOTE: NO DRY WELL SHALL EXCEED 15 FOOT IN DIAMETER. NO ABSORPTION TRENCH TO EXCEED 100 FEET IN LENGTH.

NOTE: ALL PIPE FROM HOUSE TO SEPTIC TANK MUST BE CAST IRON OR SCHEDULE 40 PVC OR ABS.

PERMIT VOID AFTER THREE YEARS.

NOTE: INSTALL STAND PIPE ON SEPTIC TANK AND DRY WELL. STAND PIPES MUST BE 6 INCHES IN DIAMETER. CAST IRON, CONCRETE OR TERRA COTTA, OR PVC OR ABS ACCEPTED. IF TOP OF SEPTIC TANK IS DEEPER THAN 3 FEET MANHOLE TO GRADE REQUIRED.

***INSTALLER IS RESPONSIBLE FOR OBTAINING FINAL APPROVAL ON THIS PERMIT**

*CALL 992-2330 FOR INSPECTION OF SEPTIC SYSTEMS.

EH - 2-1082

P
A
36049

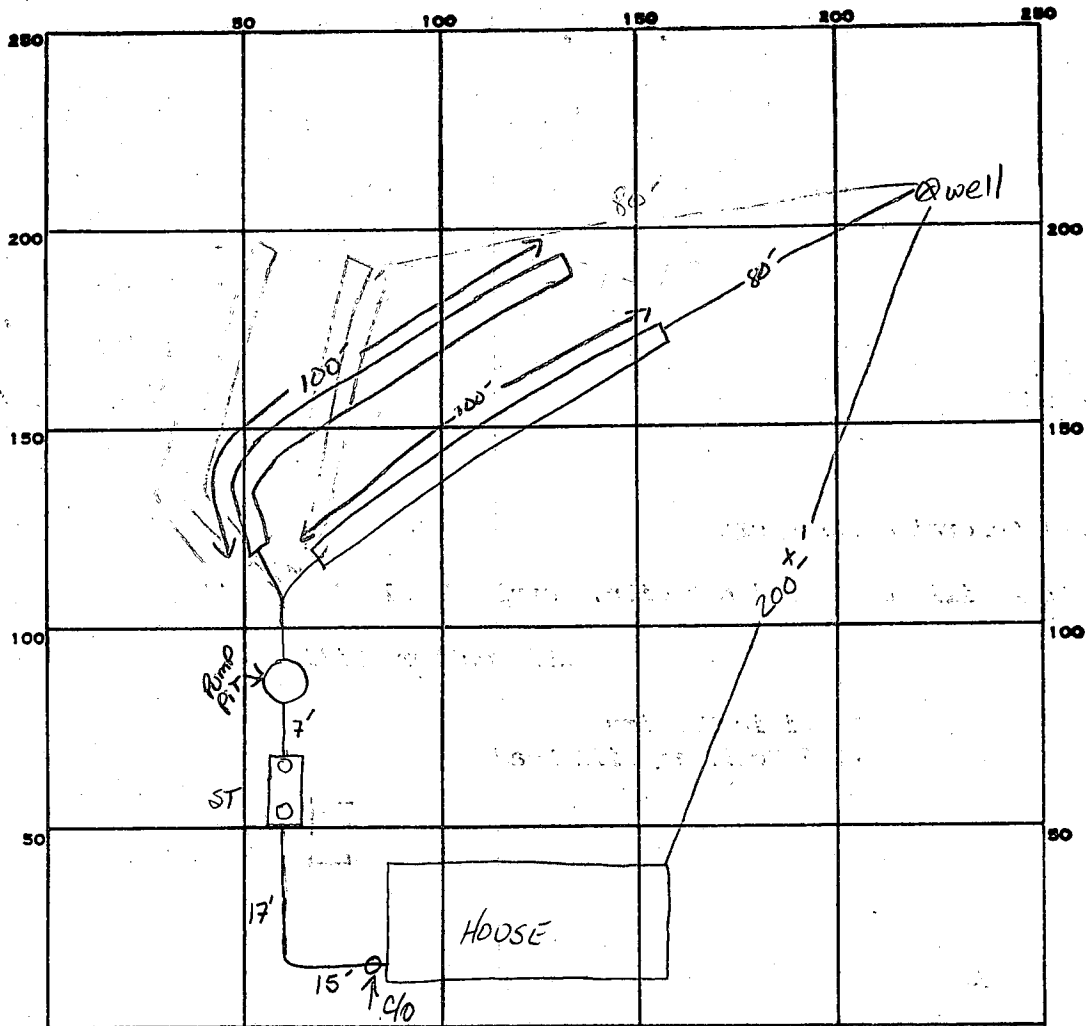

INDICATE NORTH. - NAME ADJOINING ROADWAY AS BASE LINE.

Row →

W. ROCKBORN

W. ROCKBORN HWY

PERMIT CARD

SEPTIC TANK, LEVEL 1500 GAL

CLEANOUTS ST X 2 / AT HOUSE

DISTRIBUTION BOX, LEVEL Pump Pit, - Pump Installed w/ CHECK VALVE + weep HOLE

TILE FIELD, DEPTH 6' FT. TRENCH WIDTH 3 FT. INLET 4.5'

GRAVEL DEPTH 18 IN. TOTAL LENGTH 200 FT.

NUMBER OF TRENCHES 2 TOTAL BOTTOM AREA 600 \square

SEEPAGE PITS, INSIDE DIAMETER FT. DEPTH BELOW INLET FT.

ABSORBENT AREA 600 SQ. FT.

REMARKS 1-13-86 Well trench in 48"-56" below grade; ST only installed. S. Abel

1-20-86 NEED HOUSE TO TANK CONNECTION; COVER PIPE W/ STONE AND PAPER; INSTALL Pump. S. Abel

1-20-86 OK TO COVER ALL WORK. S. Abel

DATE SYSTEM APPROVED

INSPECTOR

- 6291 -

ROCK BURN HILL: - MEDIARY

TIM FRENCH - PUMP SYSTEM

600 SQFT LEACHING BED ON TRENCHES

NO BULLDOZER

BOTTOM NO DEEPER THAN 6 FT

~~BELOW~~
START AT PERC HOLE BELOW SWIMMING POOL
AND EXTEND TO BACK OF LOT.

I TOLD MS MEDIARY SHE CAN
KEEP SPRING HOUSE FOR APPEARANCE ONLY,

IT IS CONTAMINATED AND MUST BE DISCONNECTED
WE MUST SEE IT.

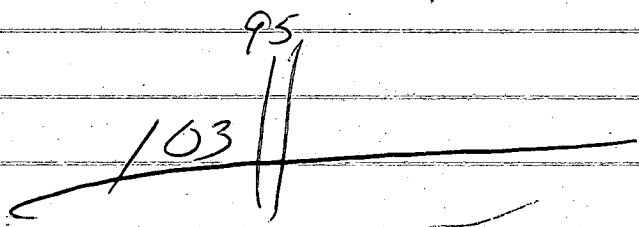
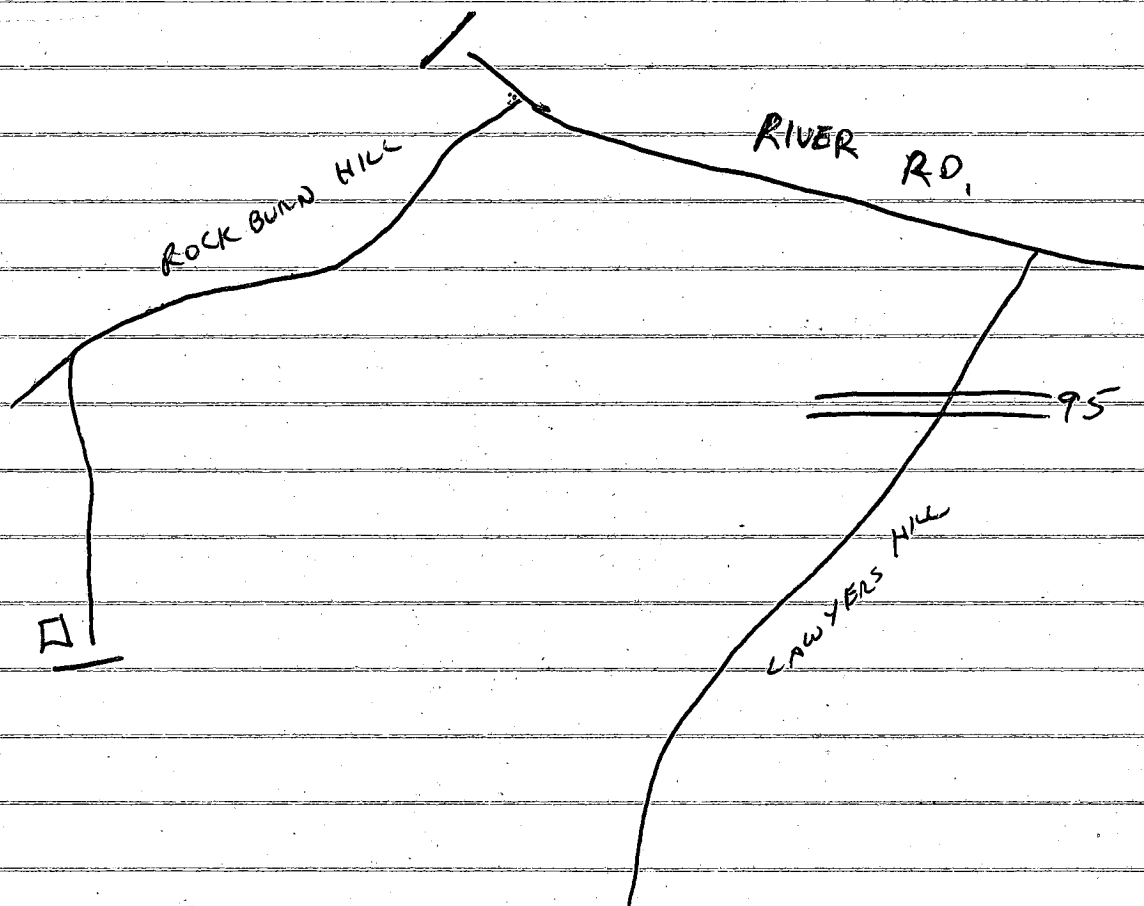

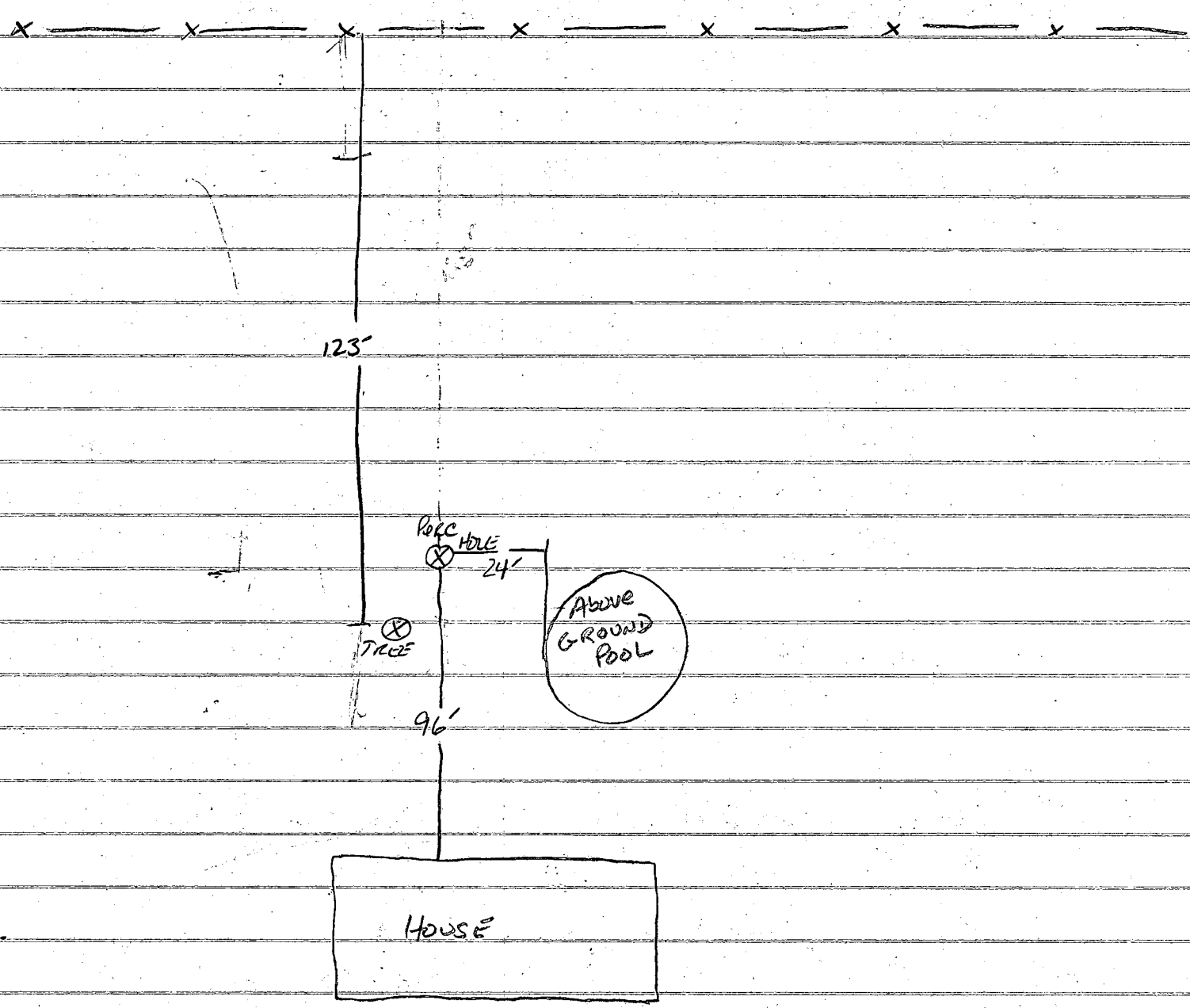

DRIVE WAY

BOTTOM MAX 6"
Require 600 ϕ
INLET 4.0 - 4.5'
18" - 24" STONE

B 1 6304

SEQUENCE NO (OEP USE ONLY)

STATE OF MARYLAND PERMIT TO DRILL WELL

OEP PERMIT NUMBER

40-81-1253

(THIS NUMBER IS TO BE PUNCHED IN COLS. 3-6 ON ALL CARDS)

1/2/86 9:30 AM

fill in this form completely

Date Received

1/20/83

OWNER INFORMATION MEDARY, WILBURN 6291 ROCKBURN HILL

B 3

LOCATION OF WELL

Owner: GEORGE EASTORDAY, First Name: GEORGE, Street of RFD: 4617 Rockburn Hill Rd, Town: Elkridge, State: Md, Zip: 21043

8 COUNTY: Howard, 23 SUBDIVISION: MAP 32 PARCEL 75, SECTION: 44 46, LOT: 48 50, 52 NEAREST TOWN: Elkridge, MILES FROM TOWN: 2 MI

DRILLER INFORMATION

Driller's Name: George Eastorday, License No. 80, Firm Name: L-Franklin Eastorday Inc, Address: 9065 Brown Church Rd, Md, Signature: George Eastorday, Date: 11-29-85

B 4

DIRECTION OF WELL FROM TOWN (CIRCLE BOX)

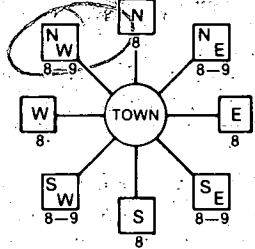

NEAR WHAT ROAD: 6291 Rockburn Hill Rd

ON WHICH SIDE OF ROAD (CIRCLE APPROPRIATE BOX)



DISTANCE FROM ROAD: 50 FT, ENTER FT or MI: 50

B 2

WELL INFORMATION

APPROX. PUMPING RATE (GAL. PER MIN.): 5, AVERAGE DAILY QUANTITY NEEDED (GAL. PER DAY): 600

USE FOR WATER (CIRCLE APPROPRIATE BOX)

- D HOME (SINGLE OR DOUBLE HOUSEHOLD UNIT ONLY)
F FARMING (LIVESTOCK WATERING & AGRICULTURAL IRRIGATION)
I INDUSTRIAL, COMMERCIAL, STATE AND FEDERAL GOV. OTHER (REQUIRES APPROPRIATION PERMIT)
P PUBLIC OR PRIVATE WATER COMPANY (REQUIRES APPROPRIATION PERMIT AND STATE HEALTH DEPARTMENT APPROVAL)
T TEST, OBSERVATION, MONITORING (MAY REQUIRE APPROPRIATION PERMIT)

NOT TO BE FILLED IN BY DRILLER HEALTH DEPARTMENT APPROVAL

COUNTY NAME: P 36049, OEP SIGNATURE: Chris Williams, DATE ISSUED: 120685, CO SIGNATURE: Chris Williams, EXP. DATE: 4/6/86, NORTH GRID: 506000, EAST GRID: 0877000

APPROXIMATE DEPTH OF WELL: 150 FEET

APPROXIMATE DIAMETER OF WELL: 6 INCH

METHOD OF DRILLING (circle one)

BORED (or Augered) JETTED Jetted & DRIVEN, AIR: ROTary AIR: PERcussion ROTARY (Hydraulic Rotary), CABLE REVERSE-ROTary Drive-POINT

SHOW MAJOR FEATURES OF BOX & LOCATE WELL WITH AN X: NOT Present FOR Grant 1/2/86 RH

SOURCES OF DRILLING WATER

- 1.
2.
3.

WRITE THE BOX NUMBER FROM THE MAP HERE

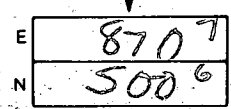

DRAW A SKETCH BELOW SHOWING LOCATION OF WELL IN RELATION TO NEARBY TOWNS AND ROADS AND GIVE DISTANCE FROM WELL TO NEAREST ROAD JUNCTION

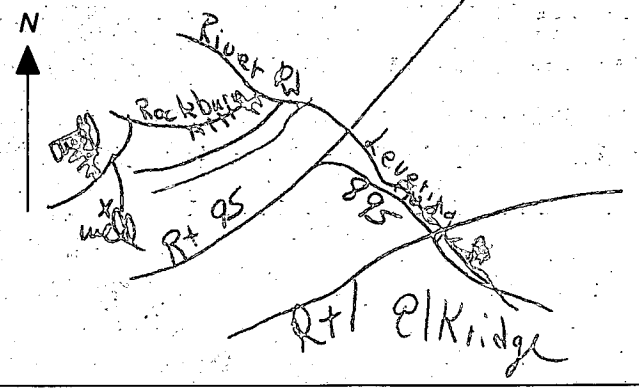

REPLACEMENT OR DEEPEMED WELLS (CIRCLE APPROPRIATE BOX)

- N THIS WELL WILL NOT REPLACE AN EXISTING WELL
Y THIS WELL WILL REPLACE A WELL THAT WILL BE ABANDONED AND SEALED
S THIS WELL WILL REPLACE A WELL THAT WILL BE USED AS A STANDBY
D THIS WELL WILL DEEPEN AN EXISTING WELL
PERMIT NUMBER OF WELL TO BE REPLACED OR DEEPEMED (IF AVAILABLE):

Not to be filled in by driller (OEP USE ONLY)

APPROP. PERMIT NUMBER: GAP

FORCE: CW, WRITE INITIALS IN BOX, PERMIT NO.: 40-81-1253

SPECIAL CONDITIONS

6291 Rockburn Hill Rd

Back lot line

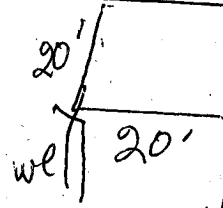

LOCATION OK
12/6/85 CWilham

Right lot
line.

5 30 00
12/6/85
CWilham

10/1/85

PERMIT

P ~~SEWER~~
A REPAIR

SEWAGE DISPOSAL SYSTEM MARYLAND STATE DEPARTMENT OF HEALTH*

HOWARD COUNTY
BUREAU OF ENVIRONMENTAL HEALTH
992-2330

ELLICOTT CITY
DISTRICT _____

DATE 10/01/85

Jack Fyock IS PERMITTED TO INSTALL _____ ALTER X

ADDRESS _____ PHONE 988-9270

SUBDIVISION _____ ROAD 6291 Rockburn Hill LOT _____

PROPERTY OWNER Wilburn Medairy

ADDRESS 6291 Rockburn Hill

IF GARBAGE GRINDER IS USED INCREASE SEPTIC TANK CAPACITY BY 50% AND ABSORPTION AREA BY 22%.

GARBAGE GRINDER? YES _____ NO _____

SEPTIC TANK CAPACITY _____ GALLONS NUMBER OF BEDROOMS _____

~~REPAIR - CALL FOR INSPECTION WHEN GROUND IS OPENED UP SO SANITARIAN CAN RECOMMEND REPAIR.~~

PLANS APPROVED BY C. Williams DATE 10/01/85

COVER NO WORK UNTIL INSPECTED AND APPROVED.

NEITHER THE HOWARD COUNTY COUNCIL NOR THE HEALTH DEPARTMENT IS RESPONSIBLE FOR THE SUCCESSFUL OPERATION OF ANY SYSTEM.

NOTE: IF TRENCH IS USED CALL FOR INSPECTION BEFORE AND AFTER PLACING GRAVEL IN TRENCH.

NOTE: NO DRY WELL SHALL EXCEED 15 FOOT IN DIAMETER. NO ABSORPTION TRENCH TO EXCEED 100 FEET IN LENGTH.

NOTE: ALL PIPE FROM HOUSE TO SEPTIC TANK MUST BE CAST IRON OR SCHEDULE 40 PVC OR ABS.

PERMIT VOID AFTER THREE YEARS.

NOTE: INSTALL STAND PIPE ON SEPTIC TANK AND DRY WELL. STAND PIPES MUST BE 6 INCHES IN DIAMETER. CAST IRON, CONCRETE OR TERRA COTTA, OR PVC OR ABS ACCEPTED. IF TOP OF SEPTIC TANK IS DEEPER THAN 3 FEET MANHOLE TO GRADE REQUIRED.

***INSTALLER IS RESPONSIBLE FOR OBTAINING FINAL APPROVAL ON THIS PERMIT**

*CALL 992-2330 FOR INSPECTION OF SEPTIC SYSTEMS.

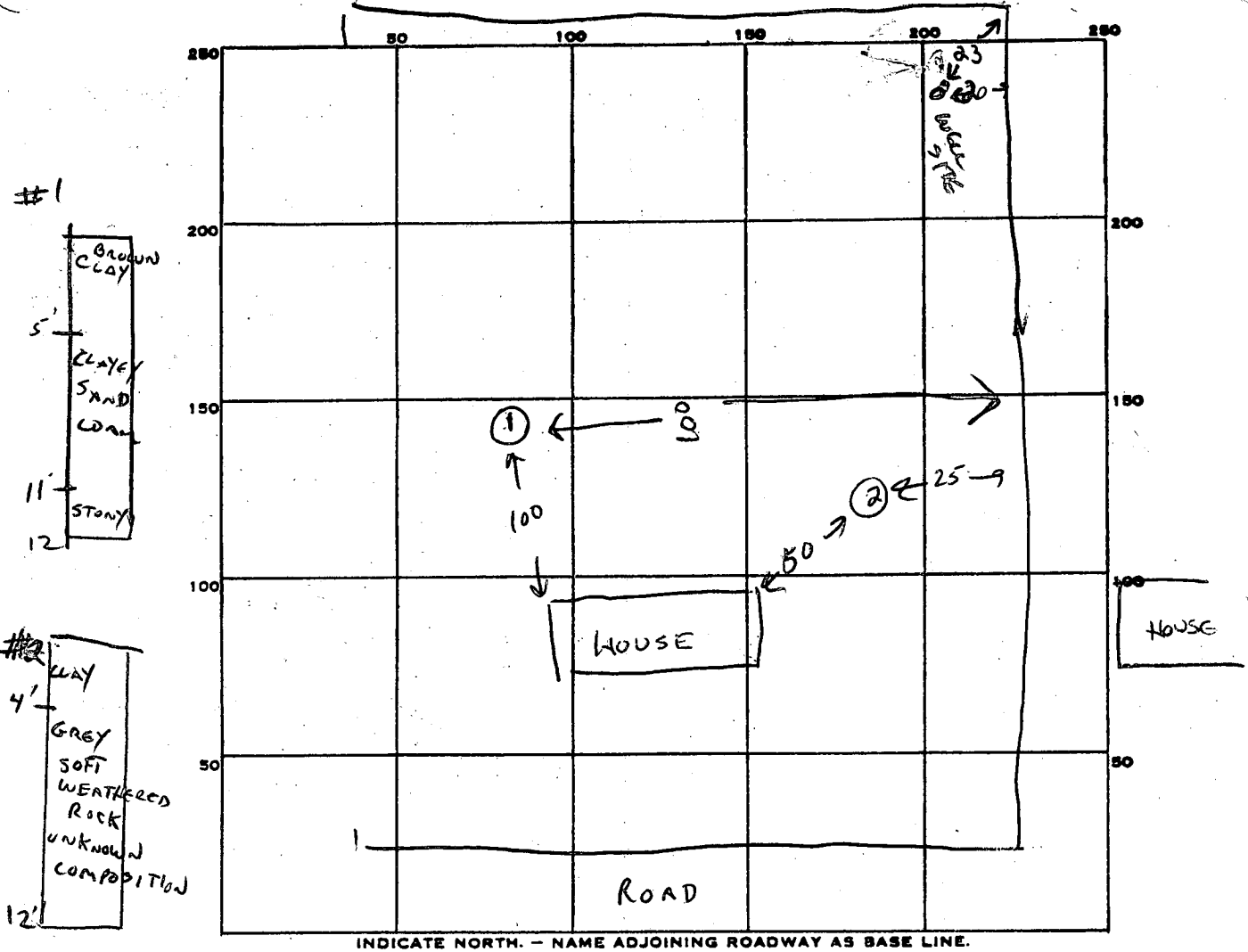

PERMIT CARD _____

SEPTIC TANK, LEVEL _____ CLEANOUTS _____

DISTRIBUTION BOX, LEVEL _____

TILE FIELD, DEPTH _____ FT. TRENCH WIDTH _____ FT.

GRAVEL DEPTH _____ IN. TOTAL LENGTH _____ FT.

NUMBER OF TRENCHES _____ TOTAL BOTTOM AREA _____

SEEPAGE PITS, INSIDE DIAMETER _____ FT. DEPTH BELOW INLET _____ FT.

ABSORBENT AREA _____ SQ. FT.

158
3
471

REMARKS 1500 SEPTIC TANK SPRING CONTAMINATED BY VERMIN, FOAMY SURFACE, IN SWALE.
600 50' FT ABS. AREA → LOCATED AT HOLE #1
PUMP PIT REQUIRED. ()

10/9/85

WILBURN MEDAERY SPECS'
6291 ROCK BURN HILL

- 1) ABANDON EXISTING SPRING HOUSE AND DRILL
NEW WELL.

SPRING HOUSE SHOULD BE KNOCKED DOWN, EXISTING
PIPE SHOULD BE DISCONNECTED, EXISTING PUMP
WHETHER IN HOUSE OR AT SPRING SHOULD BE REMOVED.

THE SPRING SHOULD BE FILLED WITH CLEAN MATERIAL
WHICH CAN INCLUDE ^{STONE, SAND, OR} THE BRICK FROM THE SPRING HOUSE
BUT SHOULD NOT INCLUDE TOPSOIL, HUMUS OR
OTHER RUBBLE.

- 2) ABANDON EXISTING SEPTIC SYSTEM AND INSTALL
NEW SYSTEM IN LOCATION DESCRIBED.

* - IF THE NEW SEPTIC TANK CAN BE SO
LOCATED THAT GRAVITY SERVICE TO THE FIRST
FLOOR IS FEASIBLE, THEN A PUMP SYSTEM
IS NOT REQUIRED.

IF, ON THE OTHER HAND, A GRAVITY SYSTEM
IS NOT FEASIBLE, THEN A PUMP SYSTEM WOULD
BE NECESSARY.

2 a) IN EITHER CASE - THE EXISTING SEPTIC SYSTEM SHOULD BE PUMPED OUT BY A LICENSED SCAVENGER. THE TANK AND/OR PIT MUST ~~BE~~ HAVE THE TOP BROKEN UP AND THE VOID FILLED WITH STONE OR SOIL. THIS FILL SHOULD BE PACKED SECURELY AND THE SITE ~~REGRADED~~ LEFT IN A SAFE, LEVEL CONDITION.

2 b) THE NEW SEPTIC SYSTEM MUST CONSIST OF A 1500 GAL CAPACITY SEPTIC TANK AND A LEACHING BED OF 600 SQ FT BOTTOM AREA ~~IS TO COMPRISE THE~~ DISPOSAL FIELD.

THE BED SHOULD BE NO WIDER THAN 20 FT AND HAVE A BOTTOM DEPTH OF 6 FT BELOW ORIGINAL GRADE. INLET TO THE BED IS 4 FT BELOW GRADE WITH 2 FT OF STONE BELOW DISTRIBUTION PIPE. A DISTRIBUTION BOX WITH TWO DISTRIBUTION LATERALS IS REQUIRED.

THE BED SHOULD START AT THE SITE OF THE RECENT TEST HOLE LOCATED APPROXIMATELY 100 FT FROM THE BACK-LEFT CORNER OF THE HOUSE. THE BED IS TO FOLLOW THE CONTOUR TOWARD THE REAR OF THE PROPERTY.

IF THE ^{SIX-} SLOPE OF THE LOT MAKES INSTALLATION OF A LEVEL BED DIFFICULT, THE CONTRACTOR MAY SUBSTITUTE AT HIS OPTION, SEPARATE TRENCHES HAVING AN EQUAL AMOUNT OF BOTTOM AREA.

2c) IN THE LIKELY EVENT THAT A PUMP SYSTEM IS FOUND TO BE NECESSARY, THEN A PUMP PIT OF 150-200 GALLON ~~EFFECTIVE~~ CAPACITY IS REQUIRED. EFFLUENT SHOULD BE PUMPED THROUGH A 2 INCH LINE TO A DISTRIBUTION BOX OF EQUAL CAPACITY.

THE EFFLUENT PUMP SHOULD BE SIZED TO ALLOW THE PUMP PIT TO BE EMPTIED IN LESS THAN 5 MINUTES.

A $\frac{1}{4}$ " WEEP-HOLE SHOULD BE DRILLED IN THE EFFLUENT LINE PAST THE PUMP, BUT STILL IN THE PUMP PIT, TO DEFEAT THE POSSIBILITIES OF BACK SIPHONAGE OR LINE FREEZE-UP FROM STANDING WATER IN THE LINE.

QUESTIONS ABOUT DETAILS OF THESE SPECIFICATIONS SHOULD BE DIRECTED TO THE BUREAU OF ENVIRONMENTAL HEALTH - 461-9933, ATTENTION - CRAIG WILLIAMS.