

11/10/60 - check out
Approved R.H.

PERMIT

SEWAGE DISPOSAL SYSTEM

MARYLAND STATE DEPARTMENT OF HEALTH
HOWARD COUNTY

INDEXED

ELLICOTT CITY

DISTRICT 2

DATE 11-9-60

P 031743

A 01719

check out 11/14/60 - approved R.H.

Robert D. Shilling IS PERMITTED TO INSTALL ALTER

ADDRESS Hunt Club Rd. ElkrIDGE 27 PHONE ElkrIDGE 1927

A SEWAGE DISPOSAL SYSTEM LOCATED AT _____

SUBDIVISION _____ ROAD Old Frederick Rd. LOT _____

PROPERTY OWNER Trinity E. U. B. Church of Rockland

ADDRESS Rockland

SPECIFICATIONS

DRAIN FIELD DEPTH _____ FEET, BOTTOM AREA 450 SQ. FT.

SEEPAGE PITS _____ ABSORBENT SIDE-WALL AREA _____ SQ. FT.

SEPTIC TANK CAPACITY 750 GALLONS

FOR GARBAGE GRINDER, INCREASE DISPOSAL AREA 22% & TANK CAPACITY 50%

OTHER 450 sq. ft. tile field, dry-well would work here too

PLANS APPROVED BY Palmer Wine DATE 9-23-59

FILL SEPTIC TANK AND DISTRIBUTION BOX WITH WATER BEFORE CALLING FOR AN INSPECTION. COVER NO WORK UNTIL INSPECTED AND APPROVED.

NEITHER THE HOWARD COUNTY COMMISSIONERS NOR THE HEALTH DEPARTMENT IS RESPONSIBLE FOR THE SUCCESSFUL OPERATION OF ANY SYSTEM.

01719

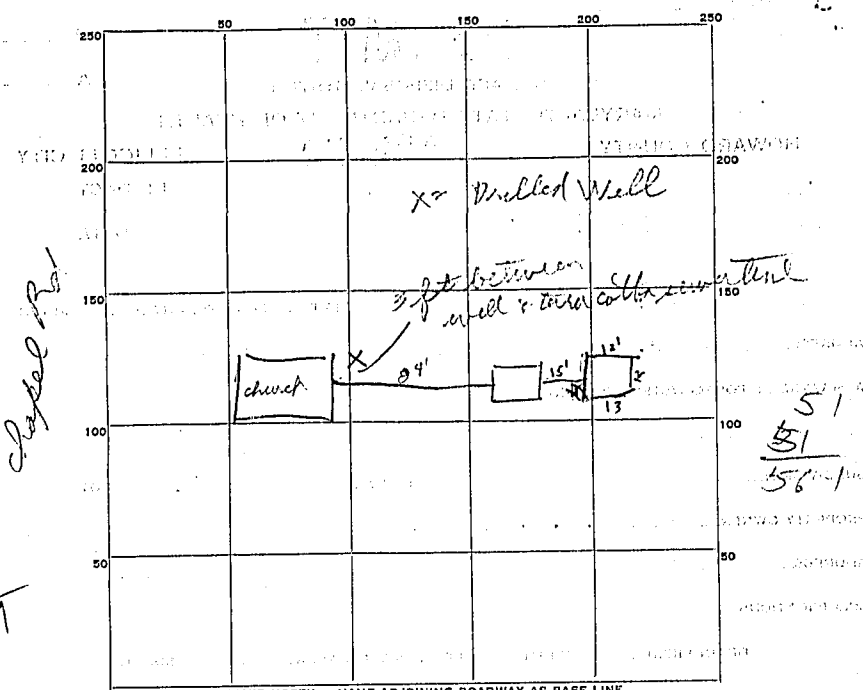

Chapel Rd.
 12
 12
 13
 14
 51

51
 51
 56

INDICATE NORTH. - NAME ADJOINING ROADWAY AS BASE LINE.

PERMIT CARD 715 Rt 99
 SEPTIC TANK, LEVEL OK 1000 CLEANOUTS OK 6" tank & DW
 DISTRIBUTION BOX, LEVEL _____
 TILE FIELD, DEPTH _____ FT. TRENCH WIDTH _____ FT.
 GRAVEL DEPTH _____ IN. TOTAL LENGTH _____ FT. 28
58
300
 NUMBER OF TRENCHES _____ TOTAL BOTTOM AREA _____

SEEPAGE PITS, INSIDE DIAMETER 9 FT. DEPTH BELOW INLET 11 FT.
 ABSORBENT AREA 300 SQ. FT. not counting stone
 REMARKS Perimeter of hole = 14 + 12 + 12 + 13
= 51 ft - sidewalk area counted
above is 561

11/10/60 There is a well within 3ft of the house sewer
made of terra cotta. Any part of the house sewer within 50ft
of the well must be cast in RH

DATE SYSTEM APPROVED 11/14/60 INSPECTOR Raymond Rodger
cast 1 iron pipe installed to tank