

Tax ID

approved  
9/17/86  
C. Wilson

P 37750  
A \_\_\_\_\_

# PERMIT

SEWAGE DISPOSAL SYSTEM  
MARYLAND STATE DEPARTMENT OF HEALTH\*

HOWARD COUNTY  
BUREAU OF ENVIRONMENTAL HEALTH  
992-2330

ELLICOTT CITY

INDEXED

DISTRICT \_\_\_\_\_

DATE 10/1/86

JACK FYOCK IS PERMITTED TO INSTALL \_\_\_\_\_ ALTER \_\_\_\_\_

ADDRESS \_\_\_\_\_ PHONE \_\_\_\_\_

SUBDIVISION \_\_\_\_\_ ROAD \_\_\_\_\_ LOT \_\_\_\_\_

PROPERTY OWNER BARBARA PATRICK

ADDRESS 2170 DAISY RD

IF GARBAGE GRINDER IS USED INCREASE SEPTIC TANK CAPACITY BY 50% AND ABSORPTION AREA BY 22%. 3BR

GARBAGE GRINDER? YES \_\_\_\_\_ NO \_\_\_\_\_

SEPTIC TANK CAPACITY \_\_\_\_\_ GALLONS NUMBER OF BEDROOMS \_\_\_\_\_

PLANS APPROVED BY \_\_\_\_\_ DATE \_\_\_\_\_

COVER NO WORK UNTIL INSPECTED AND APPROVED.

NEITHER THE HOWARD COUNTY COUNCIL NOR THE HEALTH DEPARTMENT IS RESPONSIBLE FOR THE SUCCESSFUL OPERATION OF ANY SYSTEM.

NOTE: IF TRENCH IS USED CALL FOR INSPECTION BEFORE AND AFTER PLACING GRAVEL IN TRENCH.

NOTE: NO DRY WELL SHALL EXCEED 15 FOOT IN DIAMETER. NO ABSORPTION TRENCH TO EXCEED 100 FEET IN LENGTH.

NOTE: ALL PIPE FROM HOUSE TO SEPTIC TANK MUST BE CAST IRON OR SCHEDULE 40 PVC OR ABS.

PERMIT VOID AFTER THREE YEARS.

NOTE: INSTALL STAND PIPE ON SEPTIC TANK AND DRY WELL. STAND PIPES MUST BE 6 INCHES IN DIAMETER. CAST IRON, CONCRETE OR TERRA COTTA, OR PVC OR ABS ACCEPTED. IF TOP OF SEPTIC TANK IS DEEPER THAN 3 FEET MANHOLE TO GRADE REQUIRED.

**\*INSTALLER IS RESPONSIBLE FOR OBTAINING FINAL APPROVAL ON THIS PERMIT**

\*CALL 992-2330 FOR INSPECTION OF SEPTIC SYSTEMS.

EH - 2-1082

37750  
A  
REPAIR

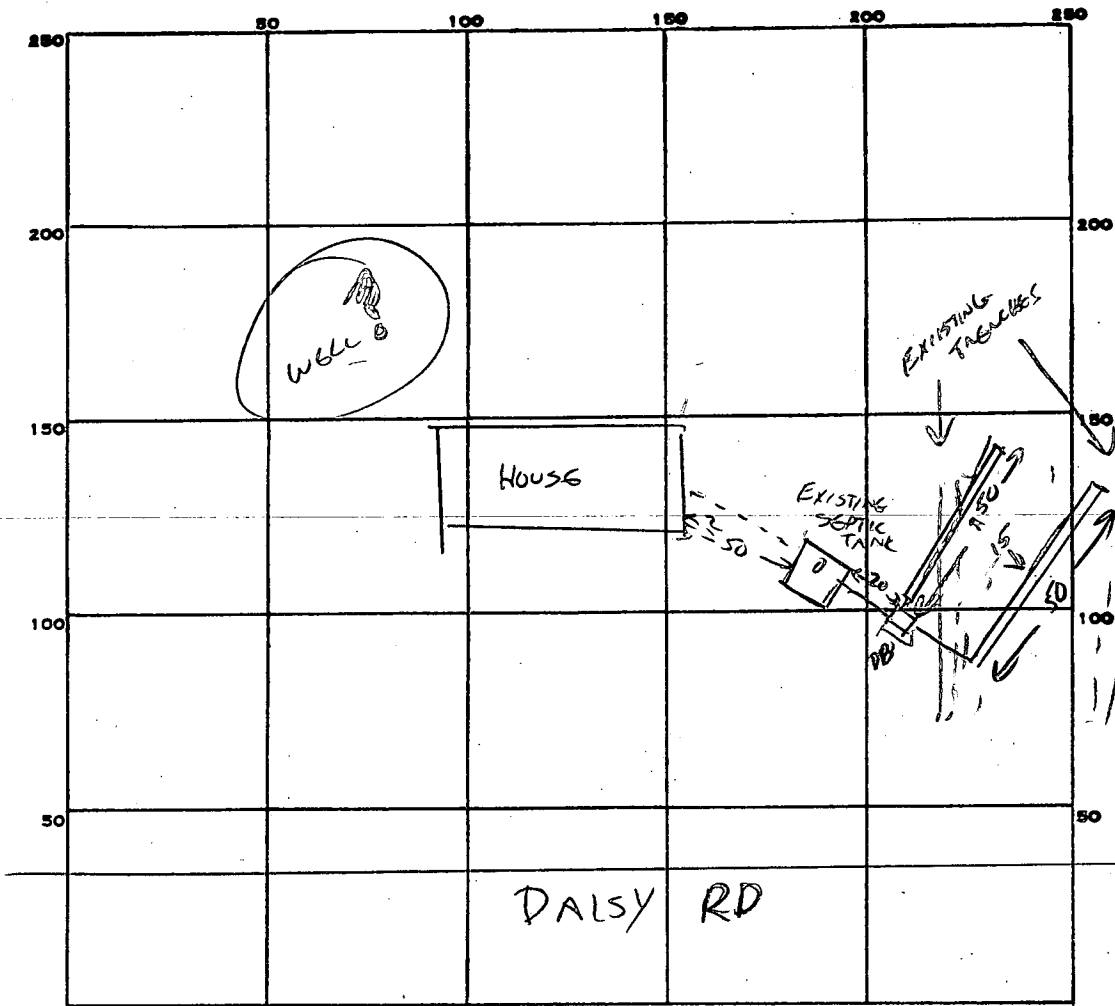

INDICATE NORTH. - NAME ADJOINING ROADWAY AS BASE LINE.

PERMIT CARD ✓

SEPTIC TANK, LEVEL EXISTING

CLEANOUTS EXISTING

DISTRIBUTION BOX, LEVEL ✓

TILE FIELD, DEPTH 8 FT. TRENCH WIDTH 2 FT.

GRAVEL DEPTH 4 FT IN. TOTAL LENGTH 100 + EXISTING FT.

NUMBER OF TRENCHES 2 (50+50) ONE SIDEWALL TOTAL BOTTOM AREA 400 + EXISTING

SEEPAGE PITS, INSIDE DIAMETER \_\_\_\_\_ FT. DEPTH BELOW INLET \_\_\_\_\_ FT.

ABSORBENT AREA 900 + EXISTING TRENCH. SQ. FT.

REMARKS LOWER TRENCH FAILING, DISCONNECTED, UPPER TRENCH REMAINS CONNECTED,

TWO ADDITIONAL TRENCHES. 9/17/86

SOIL MICA-SILT LOAM, SOME FRAGMENTS AT END OF TRENCH FARTHEST FROM ROAD. CU

DATE SYSTEM APPROVED 9/11/86

INSPECTOR Craig Williams

# APPLICATION

A 03375

P 03721

SEWAGE DISPOSAL TESTING

MARYLAND STATE DEPARTMENT OF HEALTH

HOWARD COUNTY

ELLICOTT CITY

SEPTIC TANK - 750 gallons

DISTRICT 4

TILE FIELD - 345 S.F. total area - to be installed  
in the area tested.

DATE 3-1-61

TO: THE COUNTY HEALTH OFFICER  
ELLICOTT CITY, MARYLAND

I, HEREBY, APPLY FOR THE NECESSARY TESTS IN ORDER TO CONSTRUCT (OR RECONSTRUCT) A SEWAGE DISPOSAL SYSTEM.

PROPERTY OWNER Patrick, David

ADDRESS Woodbine

PHONE Huntley 9-4486

PROPERTY LOCATION:

SUBDIVISION \_\_\_\_\_

LOT NO. \_\_\_\_\_

ROAD AND DESCRIPTION Daisy Rd. - From Rt. 144 about 1 1/2 mi. on right. Patrick on mailbox on opposite side of road from entrance.

OCCUPANT \_\_\_\_\_

PHONE \_\_\_\_\_

PERSON TO CONSTRUCT SYSTEM \_\_\_\_\_

ADDRESS \_\_\_\_\_

PHONE \_\_\_\_\_

SIZE OF LOT 1 acre

TYPE BLDG. \_\_\_\_\_

3  
NUMBER OF BEDROOMS

IF NOT SINGLE RESIDENCE DESCRIBE \_\_\_\_\_

SIGNATURE OF APPLICANT David Patrick

APPROVED BY Walter J. Levy

FOR

TILE FIELD

(KIND OF SYSTEM)

DATE

5/10/61

REJECTED BY \_\_\_\_\_

FOR

(KIND OF SYSTEM)

DATE \_\_\_\_\_

HOLD PENDING FURTHER TESTS \_\_\_\_\_

DATE \_\_\_\_\_

REASONS FOR REJECTION OR HOLDING \_\_\_\_\_

# THIS IS NOT A PERMIT

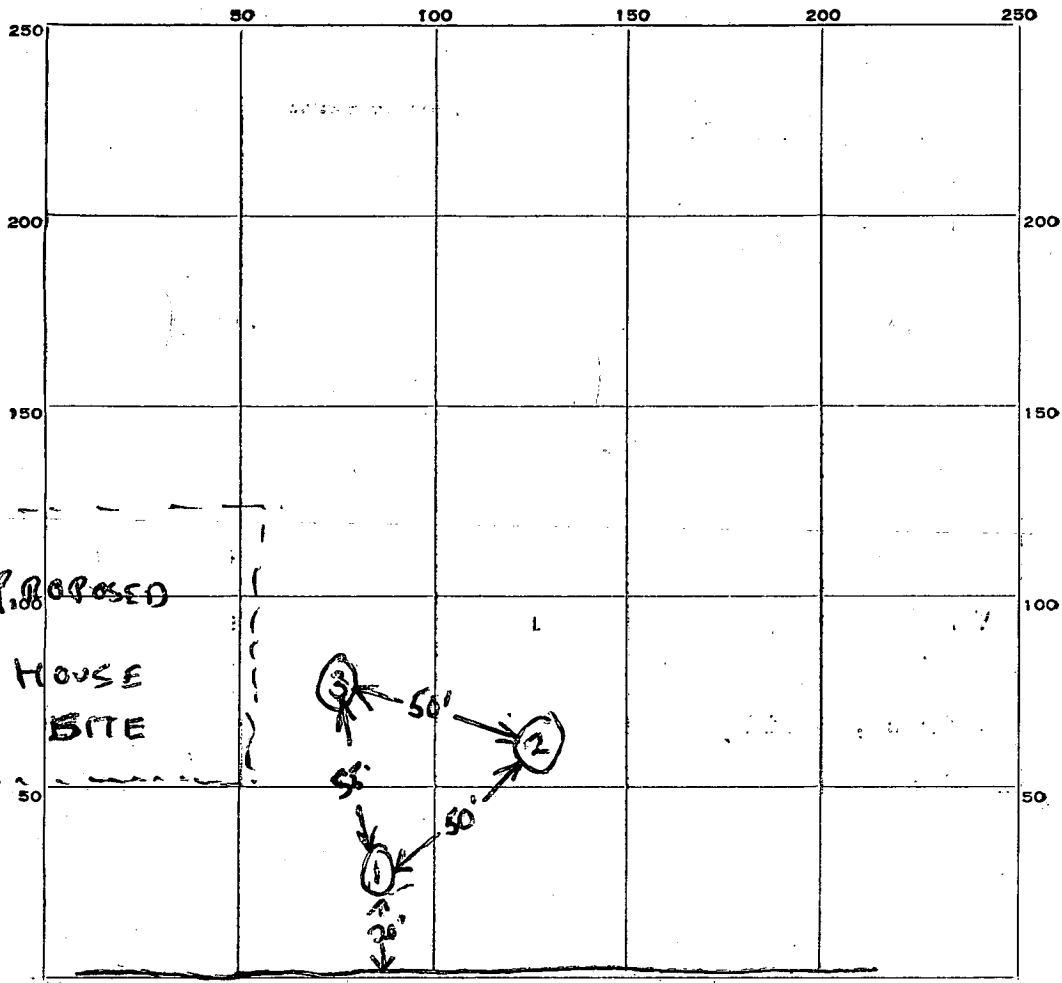

INDICATE NORTH. - NAME ADJOINING ROADWAY AS BASE LINE.

DAISY RD.

DATE	TEST NO.	DEPTH	PRE-WET		TEST - 1" DROP		TIME
			START	STOP	START	STOP	
5/10/61	1	3'	941	943	943	947	4 min
"	2	3'	946	949	949	953	4 min
"	3	3'	947	1004	1004	NO PERC	(40)

} 48 min total time, 16 min average

SOIL AUGER FINDING \_\_\_\_\_  
 TESTED BY Walter S. Geary  
 REMARKS \_\_\_\_\_  
 ALSO PRESENT David Patusk LOT NO. \_\_\_\_\_

# PERMIT

P 03721

SEWAGE DISPOSAL SYSTEM

A ~~7#88%~~ 03375

MARYLAND STATE DEPARTMENT OF HEALTH

HOWARD COUNTY

ELLICOTT CITY

DISTRICT 4

## INDEXED

DATE 5-17-61

~~Joseph Wenzler~~ Herman Sick IS PERMITTED TO INSTALL  ALTER

ADDRESS ~~514 North Rolling Road~~ Woodbine, PHONE ~~Ri 7-8090~~

A SEWAGE DISPOSAL SYSTEM LOCATED AT Daisy Rd. - From Rt. 144 about 1 1/2 mi on right  
Patrick on mailbox on opposite side of road from entrance.

SUBDIVISION \_\_\_\_\_ ROAD \_\_\_\_\_ LOT \_\_\_\_\_

PROPERTY OWNER David Patrick

ADDRESS Woodbine

### SPECIFICATIONS

DRAIN FIELD  DEPTH \_\_\_\_\_ FEET, BOTTOM AREA \_\_\_\_\_ SQ. FT.

SEEPAGE PITS \_\_\_\_\_ ABSORBENT SIDE-WALL AREA \_\_\_\_\_ SQ. FT.

SEPTIC TANK CAPACITY 750 GALLONS

FOR GARBAGE GRINDER, INCREASE DISPOSAL AREA 22% & TANK CAPACITY 50%.

OTHER Tile Field - 345 S. F. total acree - to be installed in the area tested.

PLANS APPROVED BY Walter Loevy DATE 5-10-61

FILL SEPTIC TANK AND DISTRIBUTION BOX WITH WATER BEFORE CALLING FOR AN INSPECTION. COVER NO WORK UNTIL INSPECTED AND APPROVED.

NEITHER THE HOWARD COUNTY COMMISSIONERS NOR THE HEALTH DEPARTMENT IS RESPONSIBLE FOR THE SUCCESSFUL OPERATION OF ANY SYSTEM.

A 03375

128  
3  
384

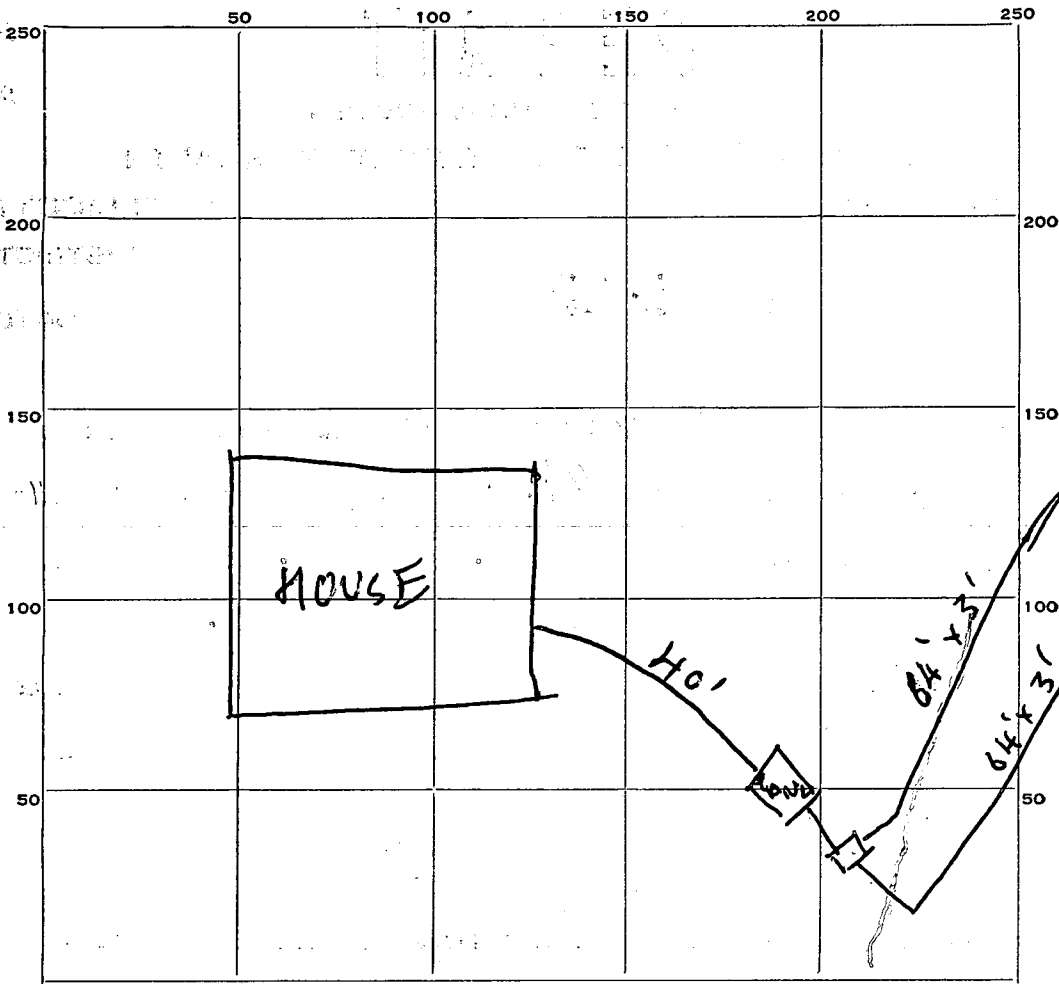

INDICATE NORTH. - NAME ADJOINING ROADWAY AS BASE LINE.

DAISY RD.

PERMIT CARD \_\_\_\_\_

SEPTIC TANK, LEVEL  1000 concrete CLEANOUTS \_\_\_\_\_

DISTRIBUTION BOX, LEVEL  \_\_\_\_\_

TILE FIELD, DEPTH 2-3 FT. TRENCH WIDTH 3 FT.

GRAVEL DEPTH 12 IN. TOTAL LENGTH 128 FT.

NUMBER OF TRENCHES 2 TOTAL BOTTOM AREA 384 S.F.

SEEPAGE PITS, INSIDE DIAMETER \_\_\_\_\_ FT. DEPTH BELOW INLET \_\_\_\_\_ FT.

ABSORBENT AREA ~~384~~ SQ. FT.

REMARKS \_\_\_\_\_

\_\_\_\_\_  
\_\_\_\_\_  
\_\_\_\_\_  
\_\_\_\_\_

DATE SYSTEM APPROVED 8/11/61

INSPECTOR J. J. J.