

1axID-04-329295

Approved  
8/29/86  
P. 37749 RH

# PERMIT

SEWAGE DISPOSAL SYSTEM

A REPAIR

MARYLAND STATE DEPARTMENT OF HEALTH

HOWARD COUNTY

ELLICOTT CITY

BUREAU OF ENVIRONMENTAL HEALTH

DISTRICT \_\_\_\_\_

XX 992-2330 XX

INDEXED

461-9933

DATE 10/1/86

Jack Fyock

IS PERMITTED TO INSTALL \_\_\_\_\_ ALTER

ADDRESS \_\_\_\_\_ PHONE 988-9270

SUBDIVISION \_\_\_\_\_ ROAD 3320 Shady Lane LOT \_\_\_\_\_

PROPERTY OWNER Poqartz  
3320 Shady Lane

ADDRESS \_\_\_\_\_

IF GARBAGE GRINDER IS USED INCREASE SEPTIC TANK CAPACITY BY 50% AND ABSORPTION AREA BY 22%.

GARBAGE GRINDER? YES \_\_\_\_\_ NO \_\_\_\_\_

SEPTIC TANK CAPACITY \_\_\_\_\_ GALLONS NUMBER OF BEDROOMS 6

REPAIR - CALL FOR INSPECTION WHEN GROUND IS OPENED UP SO SANITARIAN CAN RECOMMEND REPAIR.

8/29/86 RUN TRENCH OFF OLD DRY WELL  
750 SQ FT 13 FT DEEP 7 1/2 FT STONE 100 FT  
LONG. RH

BEDG. PERMIT SIGNED  
AND RETURNED [Signature]  
Serial # 17056 [Signature]

PLANS APPROVED BY C. Williams DATE 8/29/86

COVER NO WORK UNTIL INSPECTED AND APPROVED.

NEITHER THE HOWARD COUNTY COUNCIL NOR THE HEALTH DEPARTMENT IS RESPONSIBLE FOR THE SUCCESSFUL OPERATION OF ANY SYSTEM.

NOTE: IF TRENCH IS USED CALL FOR INSPECTION BEFORE AND AFTER PLACING GRAVEL IN TRENCH.

NOTE: NO DRY WELL SHALL EXCEED 15 FOOT IN DIAMETER. NO ABSORPTION TRENCH TO EXCEED 100 FEET IN LENGTH.

NOTE: ALL PIPE FROM HOUSE TO SEPTIC TANK MUST BE CAST IRON OR SCHEDULE 40 PVC OR ABS.

PERMIT VOID AFTER THREE YEARS.

NOTE: INSTALL STAND PIPE ON SEPTIC TANK AND DRY WELL. STAND PIPES MUST BE 6 INCHES IN DIAMETER. CAST IRON, CONCRETE OR TERRA COTTA, OR PVC OR ABS ACCEPTED. IF TOP OF SEPTIC TANK IS DEEPER THAN 3 FEET MANHOLE TO GRADE REQUIRED.

\*INSTALLER IS RESPONSIBLE FOR OBTAINING FINAL APPROVAL ON THIS PERMIT

\*CALL 992-2330 FOR INSPECTION OF SEPTIC SYSTEMS.

EH - 2-1082

37749  
A REPAIR

①  
BROWN  
RED CLAY  
  
PINK  
&  
BROWN  
SAND  
LOAM

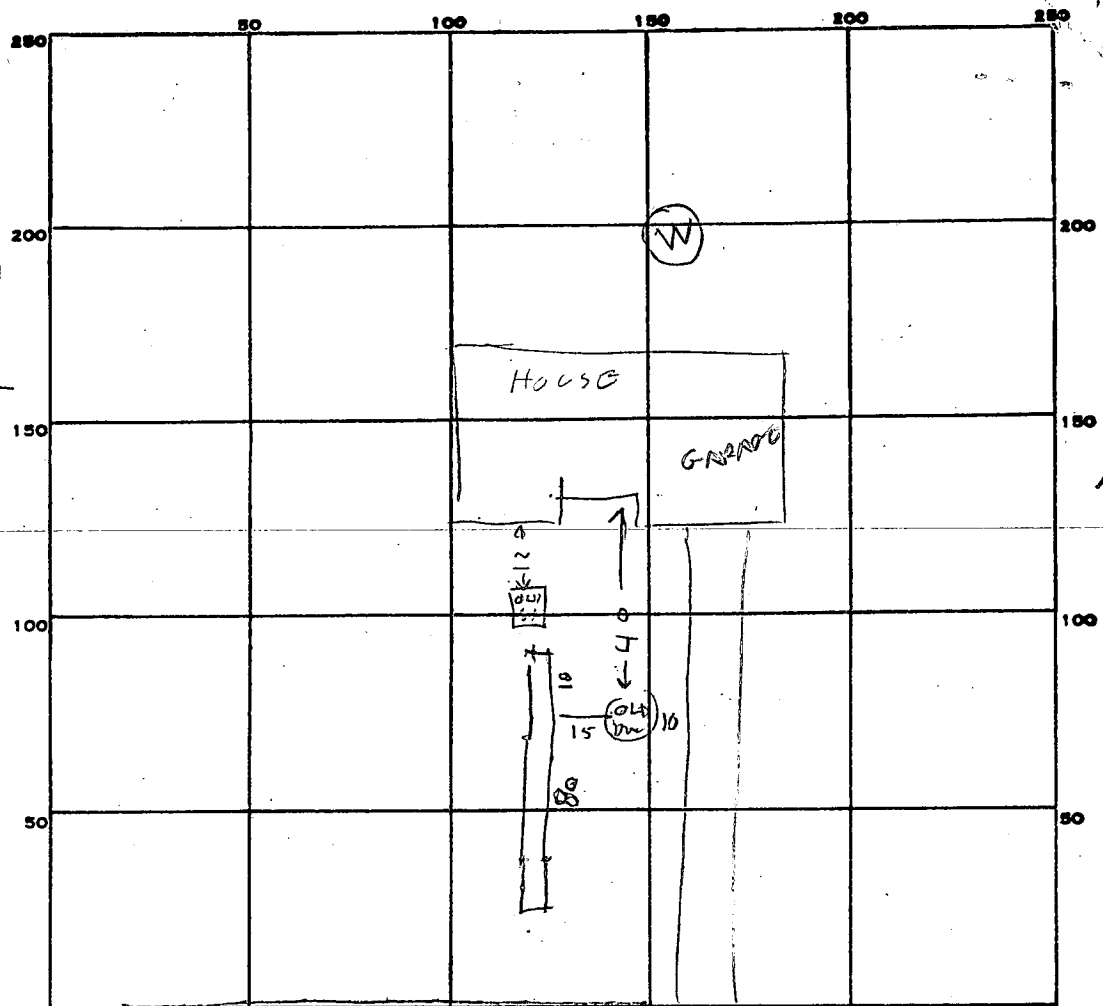

INDICATE NORTH. - NAME ADJOINING ROADWAY (AS BASE LINE).  
SHADY LANE

68  
7  
1/19/05  
New trench  
Tie in

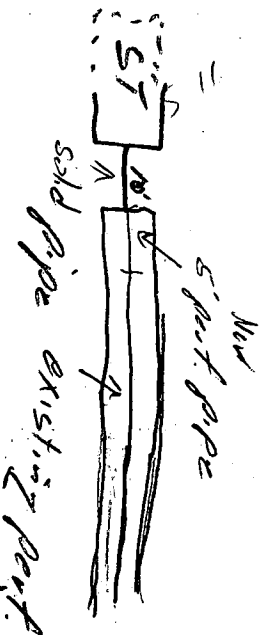

PERMIT CARD \_\_\_\_\_

SEPTIC TANK, LEVEL \_\_\_\_\_ CLEANOUTS \_\_\_\_\_

DISTRIBUTION BOX, LEVEL \_\_\_\_\_

TILE FIELD, DEPTH 13 FT. TRENCH WIDTH 2 FT.

GRAVEL DEPTH 9 FT. IN. TOTAL LENGTH 68 FT. 98

NUMBER OF TRENCHES 1 TOTAL BOTTOM AREA 784 (750 REQUIRED) 8

SEEPAGE PITS, INSIDE DIAMETER \_\_\_\_\_ FT. DEPTH BELOW INLET \_\_\_\_\_ FT.

ABSORBENT AREA \_\_\_\_\_ SQ. FT.

REMARKS 8/29/86 - SOIL OK TRENCH PARTLY DUG & PARTLY  
KILLED WITH STONE. FINISH TRENCH & FILL WITH  
STONE RH 8/29/86 STONE AND TRENCH MADE  
LONGER RH

DATE SYSTEM APPROVED 8/29/86 INSPECTOR Raymond Holder



# FILE INQUIRY FORM

Property Address: 3320 Shady Lane

1/19/05 - Charlie of Charlie's Bobcat  
Source call in about the dry well  
collapsed at this house & wanted to know  
what had to be done. Pulled fill, can't  
tell exactly how D.W. & repair trench are  
tied together. Told him to pump, collapse &  
fill in D.W.

At site, contractor exposed : 15' of  
trench just below the S.F., gravel dry  
& clean. Tie septic to trench &  
abandon D.W. (SO)