

6/24/86
Late AM

03-289001

approved
6/24/86 C. Williams

PERMIT

P 37232

A REPAIR

SEWAGE DISPOSAL SYSTEM

MARYLAND STATE DEPARTMENT OF HEALTH

HOWARD COUNTY
BUREAU OF ENVIRONMENTAL HEALTH

ELLICOTT CITY

XXX-XXXX
461-9933

DISTRICT _____

DATE 6/24/86

INDEXED

Norman Collins IS PERMITTED TO INSTALL _____ ALTER X

ADDRESS _____ PHONE 442-2235

SUBDIVISION _____ ROAD 11245 Route 99 LOT _____

PROPERTY OWNER Norwood King

ADDRESS 11245 Route 99
Marriottsville, Maryland 21104

IF GARBAGE GRINDER IS USED INCREASE SEPTIC TANK CAPACITY BY 50% AND ABSORPTION AREA BY 22%.

GARBAGE GRINDER? YES _____ NO _____

55
4
20

SEPTIC TANK CAPACITY _____ GALLONS NUMBER OF BEDROOMS _____

REPAIR - CALL FOR INSPECTION WHEN GROUND IS OPENED UP SO SANITARIAN CAN RECOMMEND REPAIR.

2 EXISTING TRENCH(S) OUBNFLOWING.

4' CLAY THEN 5' SAND-CLAY LOAM SOME CLAY POCKETS.

ADJACENT LOT AT 5' LOWER ELEVATION STRUCK WATER AT 11' SUMMER OF '85'

INSTALL 75' TRENCH W/ 5' STONE, CW,

PLANS APPROVED BY C. Williams DATE 6/24/86

COVER NO WORK UNTIL INSPECTED AND APPROVED.

NEITHER THE HOWARD COUNTY COUNCIL NOR THE HEALTH DEPARTMENT IS RESPONSIBLE FOR THE SUCCESSFUL OPERATION OF ANY SYSTEM.

NOTE: IF TRENCH IS USED CALL FOR INSPECTION BEFORE AND AFTER PLACING GRAVEL IN TRENCH.

NOTE: NO DRY WELL SHALL EXCEED 15 FOOT IN DIAMETER. NO ABSORPTION TRENCH TO EXCEED 100 FEET IN LENGTH.

NOTE: ALL PIPE FROM HOUSE TO SEPTIC TANK MUST BE CAST IRON OR SCHEDULE 40 PVC OR ABS.

PERMIT VOID AFTER THREE YEARS.

NOTE: INSTALL STAND PIPE ON SEPTIC TANK AND DRY WELL. STAND PIPES MUST BE 6 INCHES IN DIAMETER. CAST IRON, CONCRETE OR TERRA COTTA, OR PVC OR ABS ACCEPTED. IF TOP OF SEPTIC TANK IS DEEPER THAN 3 FEET MANHOLE TO GRADE REQUIRED.

***INSTALLER IS RESPONSIBLE FOR OBTAINING FINAL APROVAL ON THIS PERMIT**

*CALL ~~997~~ 22330 FOR INSPECTION OF SEPTIC SYSTEMS.

EH - 2-1082

P 37232
A REPAIR

EXISTING FAILING TRENCHES DISCONNECTED

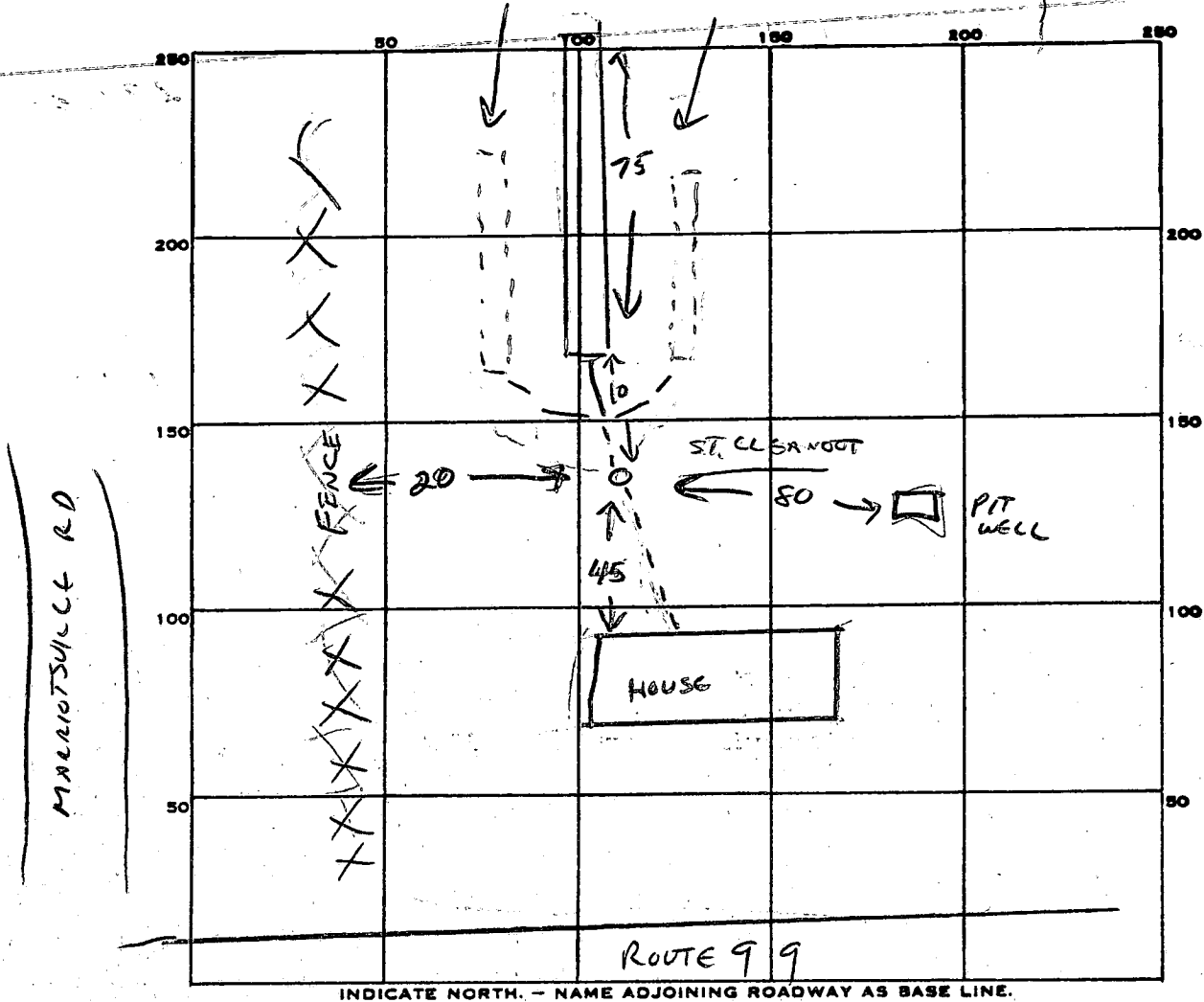

INDICATE NORTH. - NAME ADJOINING ROADWAY AS BASE LINE.

PERMIT CARD ✓

SEPTIC TANK, LEVEL EXISTING

CLEANOUTS EXISTING

DISTRIBUTION BOX, LEVEL N/A

TILE FIELD, DEPTH 10 FT. TRENCH WIDTH 2 FT.

GRAVEL DEPTH 5 FT. IN. TOTAL LENGTH 75 FT.

NUMBER OF TRENCHES 1 TOTAL BOTTOM AREA 375 ^{ONE SIDE WALL}

SEEPAGE PITS, INSIDE DIAMETER - FT. DEPTH BELOW INLET - FT.

ABSORBENT AREA 375 SQ. FT.

REMARKS _____

DATE SYSTEM APPROVED 6/24/86

INSPECTOR C. Williams