

NO # found in Red Prep.

# PERMIT

P 37188  
A REPAIR

SEWAGE DISPOSAL SYSTEM

MARYLAND STATE DEPARTMENT OF HEALTH

HOWARD COUNTY

ELLICOTT CITY

BUREAU OF ENVIRONMENTAL HEALTH

DISTRICT \_\_\_\_\_

~~XXXXXX~~

461-9933

DATE 6/16/86

Jack Fyock IS PERMITTED TO INSTALL \_\_\_\_\_ ALTER

ADDRESS \_\_\_\_\_ PHONE 988-9270

SUBDIVISION \_\_\_\_\_ ROAD 1402 Grooms Lane LOT \_\_\_\_\_

PROPERTY OWNER Cookson

1402 Grooms Lane

ADDRESS Woodstock, Maryland

IF GARBAGE GRINDER IS USED INCREASE SEPTIC TANK CAPACITY BY 50% AND ABSORPTION AREA BY 22%.

GARBAGE GRINDER? YES \_\_\_\_\_ NO \_\_\_\_\_

SEPTIC TANK CAPACITY 1000 GALLONS NUMBER OF BEDROOMS 3

*REPAIR - CALL FOR INSPECTION WHEN GROUND IS OPENED UP SO SANITARIAN CAN RECOMMEND*

*REPAIR.*

*DIRECTIONS - Woodstock Road - left on Grooms Lane - go back as far as you can into the woods.*

PLANS APPROVED BY C. Williams DATE 6/04/86

COVER NO WORK UNTIL INSPECTED AND APPROVED.

NEITHER THE HOWARD COUNTY COUNCIL NOR THE HEALTH DEPARTMENT IS RESPONSIBLE FOR THE SUCCESSFUL OPERATION OF ANY SYSTEM.

NOTE: IF TRENCH IS USED CALL FOR INSPECTION BEFORE AND AFTER PLACING GRAVEL IN TRENCH.

NOTE: NO DRY WELL SHALL EXCEED 15 FOOT IN DIAMETER. NO ABSORPTION TRENCH TO EXCEED 100 FEET IN LENGTH.

NOTE: ALL PIPE FROM HOUSE TO SEPTIC TANK MUST BE CAST IRON OR SCHEDULE 40 PVC OR ABS.

PERMIT VOID AFTER THREE YEARS.

NOTE: INSTALL STAND PIPE ON SEPTIC TANK AND DRY WELL. STAND PIPES MUST BE 6 INCHES IN DIAMETER. CAST IRON, CONCRETE OR TERRA COTTA, OR PVC OR ABS ACCEPTED. IF TOP OF SEPTIC TANK IS DEEPER THAN 3 FEET MANHOLE TO GRADE REQUIRED.

**\*INSTALLER IS RESPONSIBLE FOR OBTAINING FINAL APPROVAL ON THIS PERMIT**

\*CALL 992-2330 FOR INSPECTION OF SEPTIC SYSTEMS.

EH - 2-1082

P 37188  
A Repair

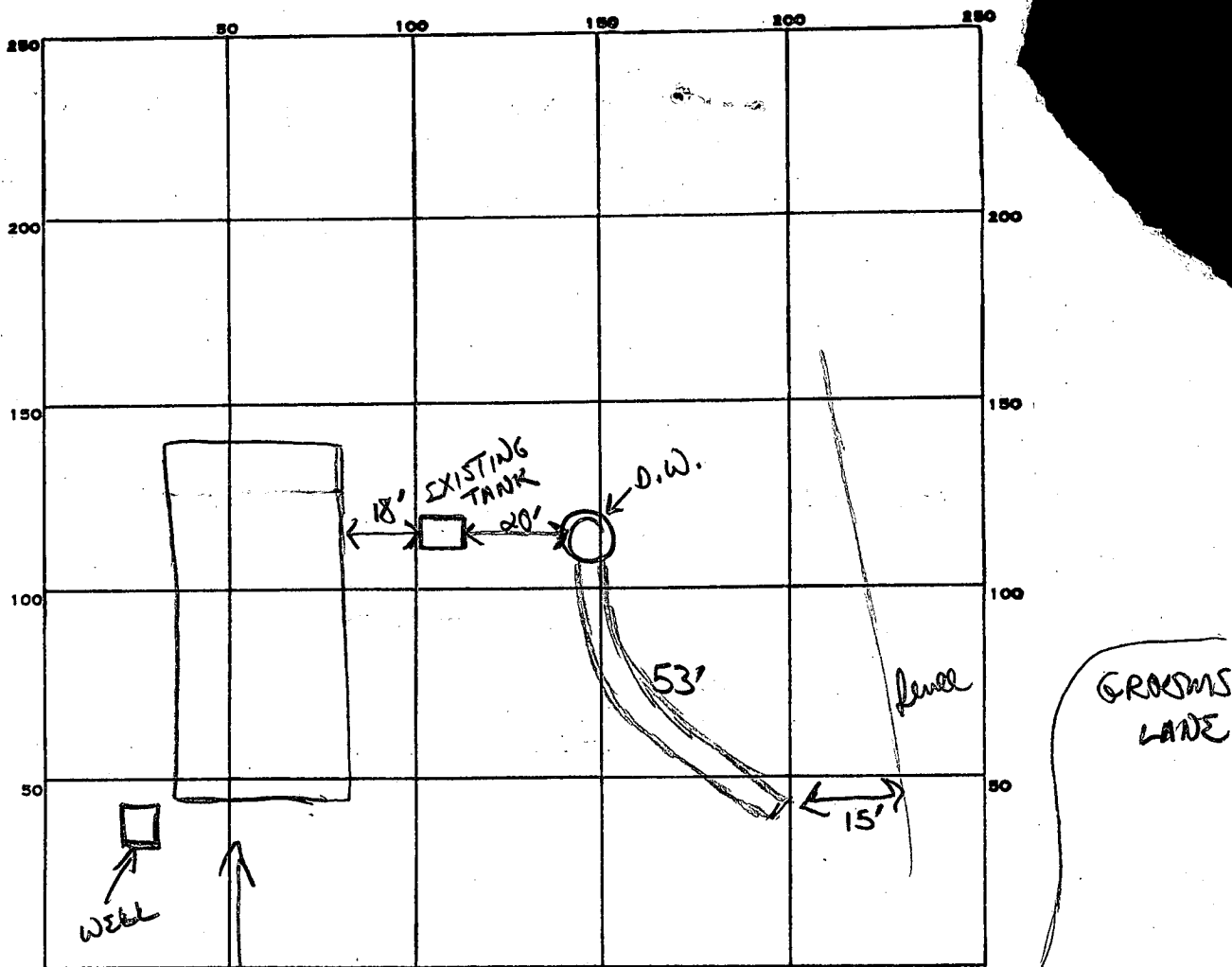

INDICATE NORTH. - NAME ADJOINING ROADWAY AS BASE LINE.

PERMIT CARD final

DRIVEWAY TO HOUSE

SEPTIC TANK, LEVEL Existing

CLEANOUTS (S.T. visible)

DISTRIBUTION BOX, LEVEL \_\_\_\_\_

TILE FIELD, DEPTH 10 FT. TRENCH WIDTH 2 FT.

GRAVEL DEPTH 8 ft IN. TOTAL LENGTH 53 FT.

NUMBER OF TRENCHES 1 TOTAL BOTTOM AREA 424

53  
8  
424

SEEPAGE PITS, INSIDE DIAMETER \_\_\_\_\_ FT. DEPTH BELOW INLET = 10 ft FT.

ABSORBENT AREA 424 SQ. FT.

REMARKS 6/4/86 Soils good from 2' down (sandy loam). OK to go to 10' deep. OK to finish adding stone pipe + paper to trench OK to cover trench

DATE SYSTEM APPROVED

6/4/86

INSPECTOR

B. W. for